

LOS ANGELES COUNTY IMPROVEMENT DRAINAGE DISTRICT NO. 1

of Los Angeles County, Cal.
J. E. Rockhold
County Surveyor.
Scale 1"=600'

This map compiled from L.A. County Records
Traced by Stoddard & Uman
Checked by Macy

1.M.30

NOTE: This district transferred to the jurisdiction of the L. A. Co. Flood Control Dist. Dec. 1, 1917 by order of the Board of Supervisors. Transfer made by U.S. Surveyors. Cf. Mar. 27, 1933, Drainage Dist. tax returns eliminated; obligations assumed by the Flood Control District.

Work completed Feb. 16, 1918.
Bonds issued Feb. 23, 1918.
Duration of bonds - 15 years.
Special assessment district.
Assessments due Oct. 1st each year
delinquent 1st Monday in Oct. of the following year.
Final payment due Oct. 1, 1932.

--- Northern boundary of the City of Long Beach
--- Boundary of drainage District finally established Oct. 2, 1918
--- Division Lines between zones

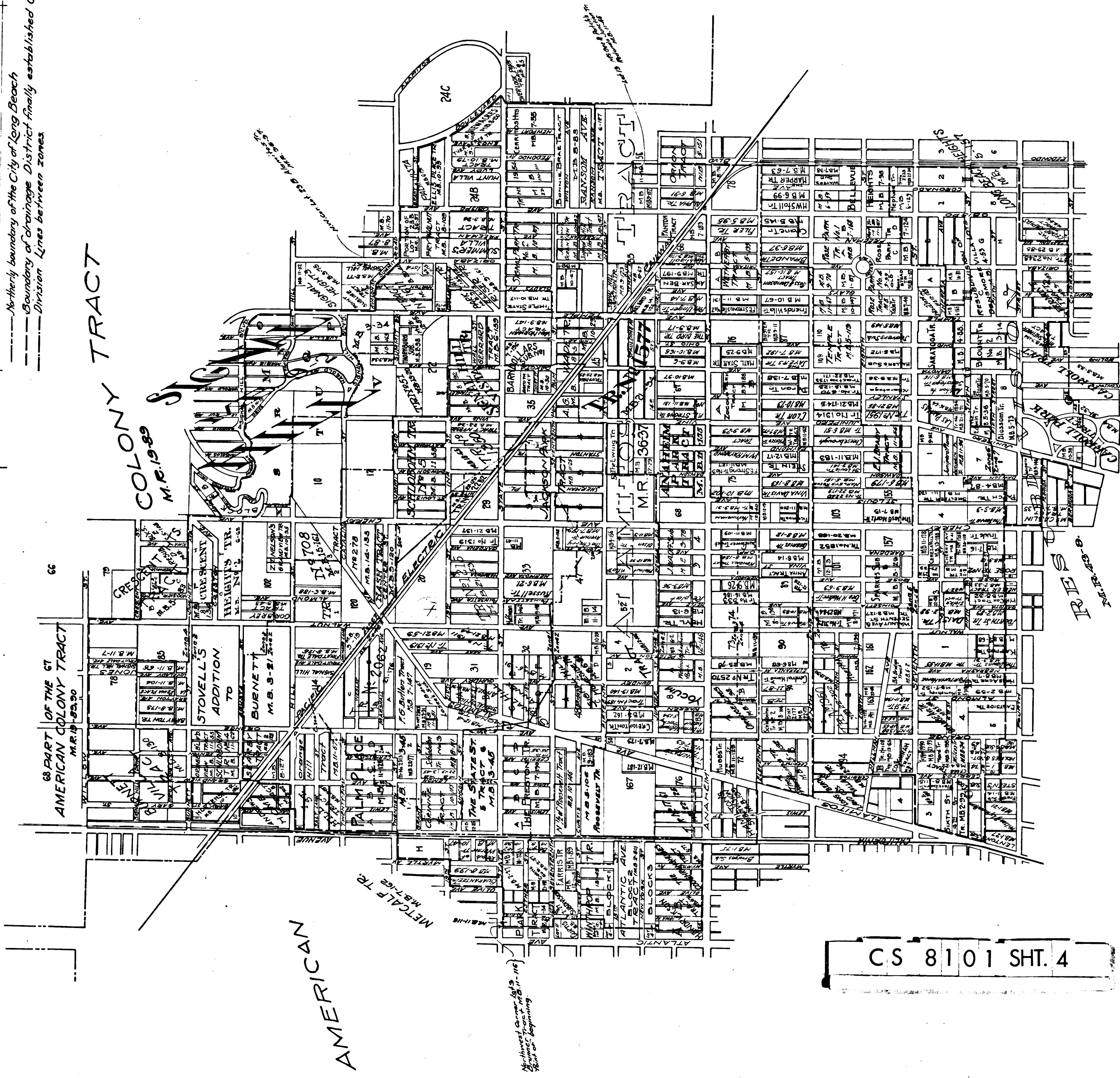

CS 8101 SHT. 4

PACIFIC

OCEAN