

NOTE: THIS MAP IS SUPERSEDED BY C.S. MAP N°8512, SHEET N°10.

C	S	8	5	1	2	S	H	T.	4
A 1 OF A 2									

NOTE: THIS MAP IS SUPERSEDED BY C.S. MAP. N° 8512 SHEET #10

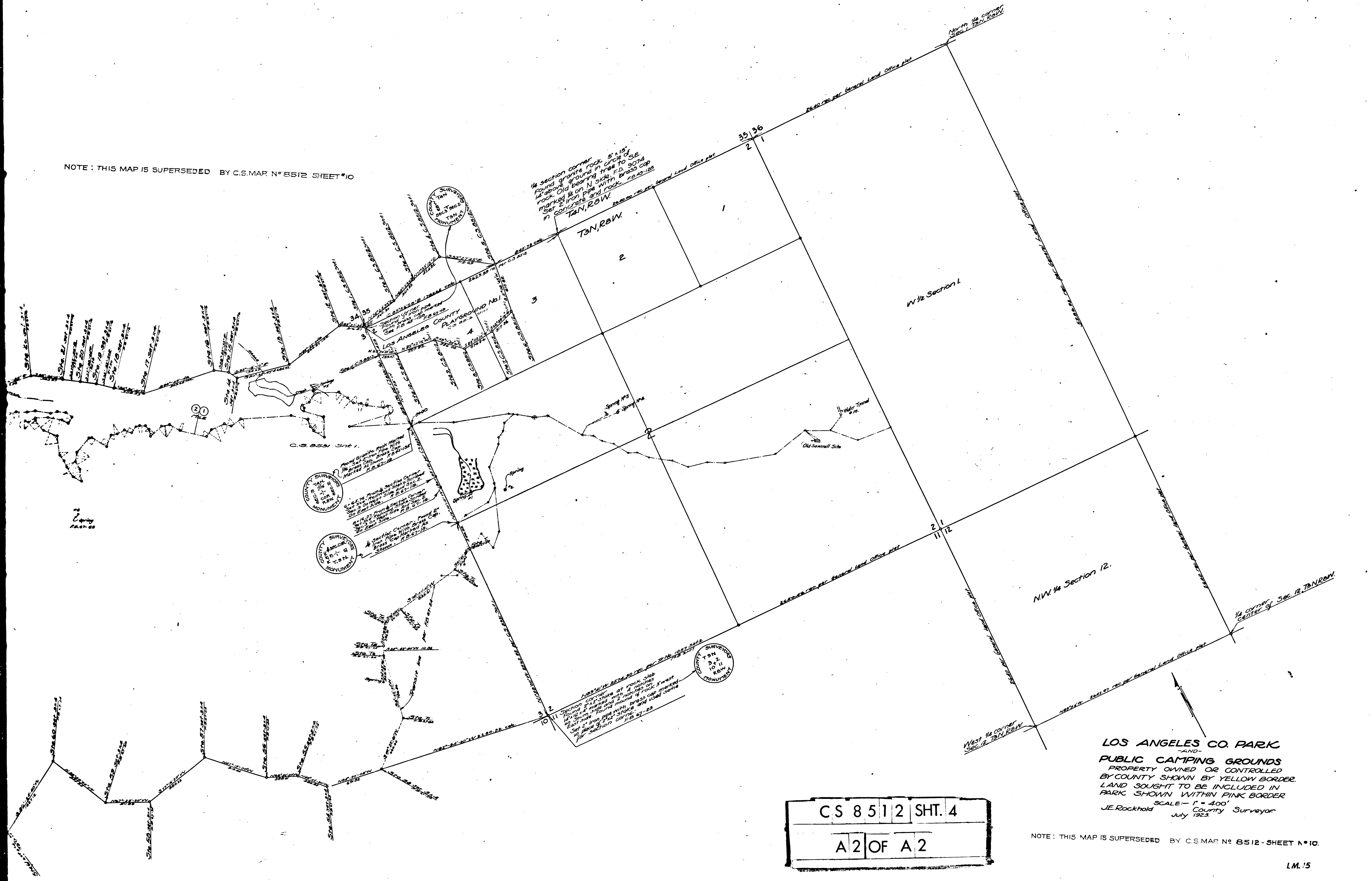

LOS ANGELES CO. PARK
 -AND-
 PUBLIC CAMPING GROUNDS
 PROPERTY OWNED OR CONTROLLED
 BY COUNTY SHOWN BY YELLOW BORDER.
 LAND SOUGHT TO BE INCLUDED IN
 PARK SHOWN WITHIN PINK BORDER
 SCALE - 1" = 400'
 J.E. Rockhold County Surveyor
 July 1923.

CS 8512 SHT. 4
 A 2 OF A 2

NOTE: THIS MAP IS SUPERSEDED BY C.S. MAP. N° 8512 - SHEET N° 10.