

CS	8	5	4	5
A	1	OF	A	6

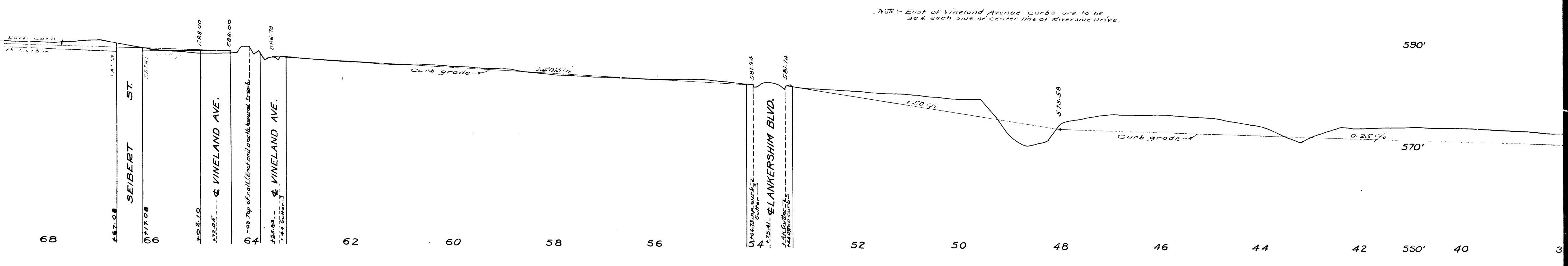





CS	8	5	4	5
A	4	OF	A	6

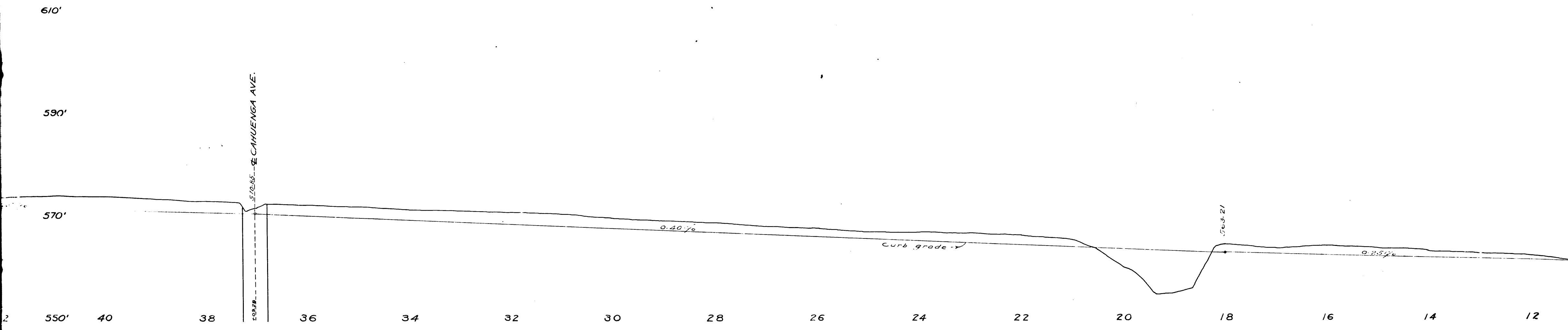

CS	8545
A5	OF A6

PROFILE OF  
**RIVERSIDE DRIVE**  
 FROM  
**WEST LINE OF BURBANK**  
 TO  
**PACOIMA AVENUE**

**COUNTY SURVEYOR'S MAP NO 8545.**

J. E. Rockhold County Surveyor.  
 Surveyed February 1923

Scales Hor. 1 in = 80 Ft.  
 Ver. 1 in = 8 Ft.

L. B. 116 10 to 18 and 22 to 24  
 Field Work by Conly and Dunn  
 Office Work by De Lancey and Overton  
 Checked by Irwin and McKee

**Legend**  
 E. shown thus ———  
 R. N. shown thus - - - -  
 L. S. shown thus - - - -

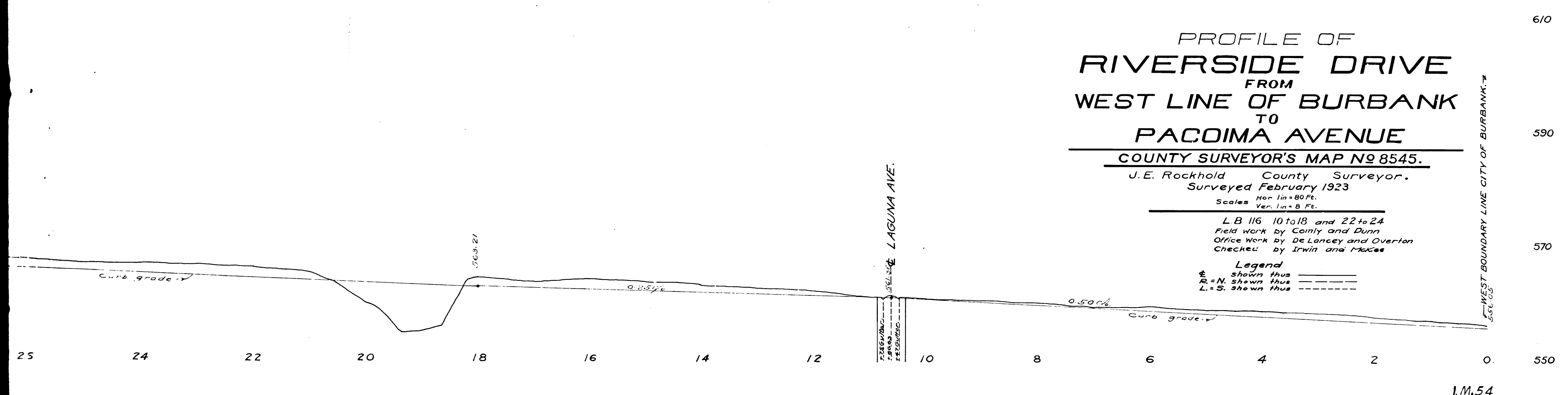

I.M.54

CS	8545
A6	OF A6