

FILED MAP NO. 13409

FILED MAP NO. 13409

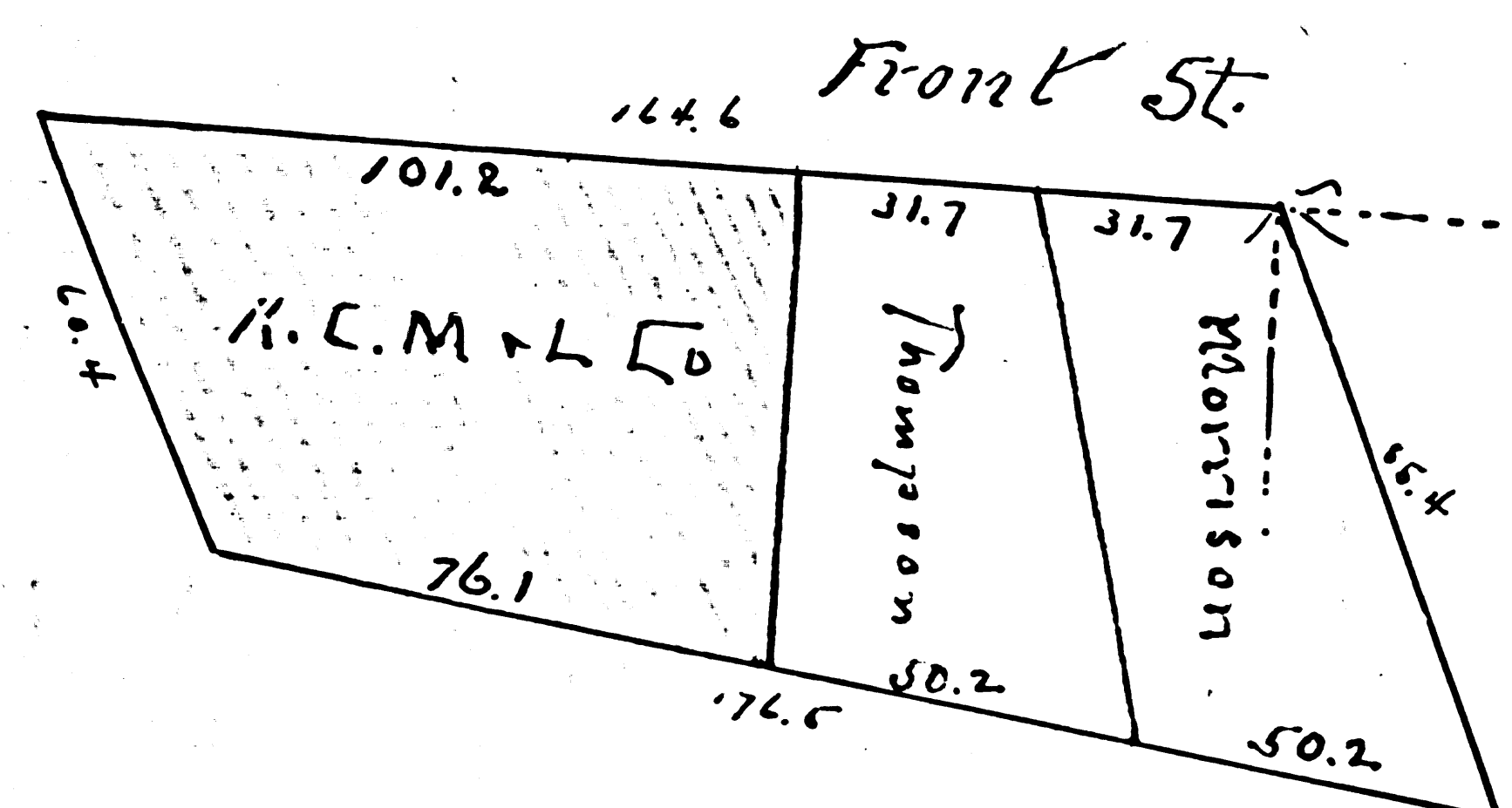

Shaded pieces owned  
Kerckhoff-Corner M & L Co

TRUE COURSE → N.

LANDS OF PACIFIC COAST STEAMSHIP COMPY.  
50 ACRE TRACT  
AT  
SAN PEDRO LOS ANGELES COUNTY,  
CAL.

WAREHOUSE  
of  
Pacific Coast S.S. Co.  
of  
SAN PEDRO

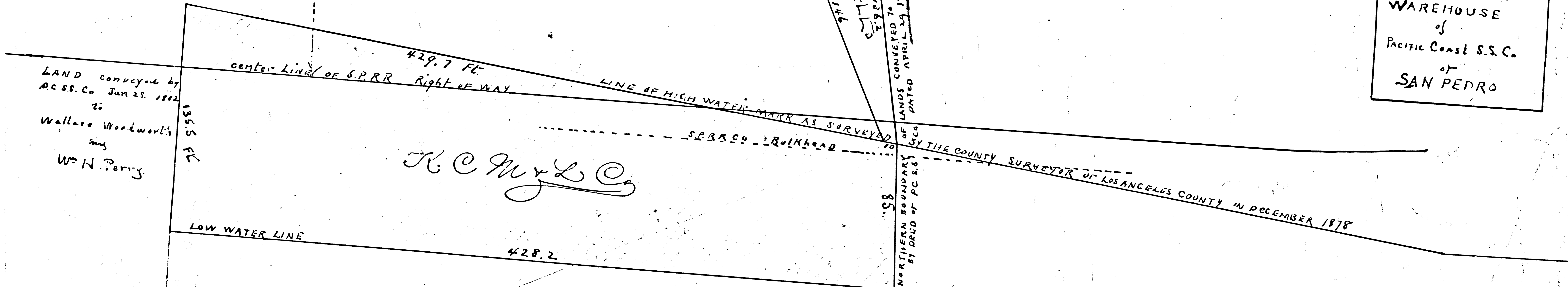

LAND conveyed by  
AC S.S. Co. Jan 25, 1882  
to  
Wallace Woodward's  
and  
W. N. Perry.

SCALE 1/2" = 50 FT - 1-inch  
FILED MAP NO. 13409

FILED MAP NO. 13409

F.M. 13409