

PLAT OF THE
RANCHO
LALIEBRE
finally confirmed to
JOSE MARIA FLORES
 Surveyed under instructions from the
U. S. SURVEYOR GENERAL
 BY
 George H. Thompson Dep. Sur.
 July 1862
 Containing 48,799⁵⁰/₁₀₀ Acres
 Scale 80 Chs to 1 inch
 Variation 14° 15' East

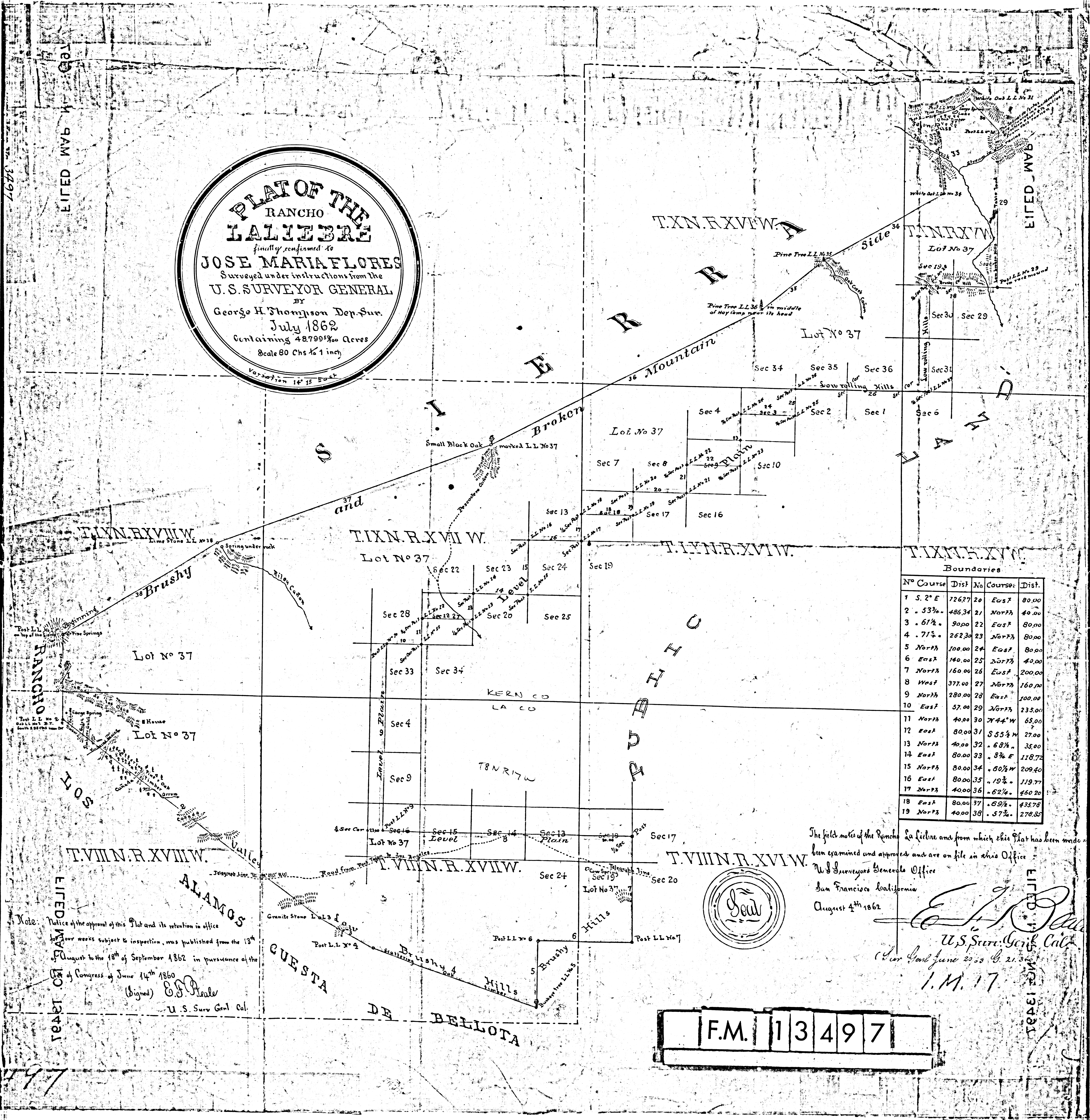

Boundaries

No	Course	Dist	No	Course	Dist.
1	S. 2° E	726.27	20	East	80.00
2	S. 53 1/2° W	486.34	21	North	40.00
3	S. 61 1/2° W	90.00	22	East	80.00
4	S. 71 1/2° W	262.30	23	North	80.00
5	North	100.00	24	East	80.00
6	East	160.00	25	North	40.00
7	North	160.00	26	East	200.00
8	West	377.00	27	North	160.00
9	North	280.00	28	East	100.00
10	East	57.00	29	North	235.00
11	North	40.00	30	S. 44° W	65.00
12	East	80.00	31	S. 55 1/2° W	27.00
13	North	40.00	32	S. 68° W	35.00
14	East	80.00	33	S. 8° E	118.72
15	North	80.00	34	S. 60 1/2° W	209.40
16	East	80.00	35	S. 10° W	119.77
17	North	40.00	36	S. 62 1/2° W	460.20
18	East	80.00	37	S. 69 1/2° W	435.78
19	North	40.00	38	S. 57 1/2° W	278.85

The field notes of the Rancho La Liebre and from which this Plat has been made
 have been examined and approved and are on file in this Office
 U. S. Surveyor General's Office
 San Francisco California
 August 4th 1862

E. J. P. [Signature]
 U. S. Surveyor Genl. Cal.
 (See field June 29th 1862 p. 21, 36)
 I. M. 17

Note: Notice of the approval of this Plat and its intention in office
 for four weeks subject to inspection, was published from the 13th
 of August to the 18th of September 1862 in pursuance of the
 act of Congress of June 14th 1860
 (Signed) E. J. P.
 U. S. Survey Genl. Cal.

F.M. 13497

FILED MAR 18 1862

FILED MAR 18 1862

FILED MAR 18 1862