

C H O

N T O N I O

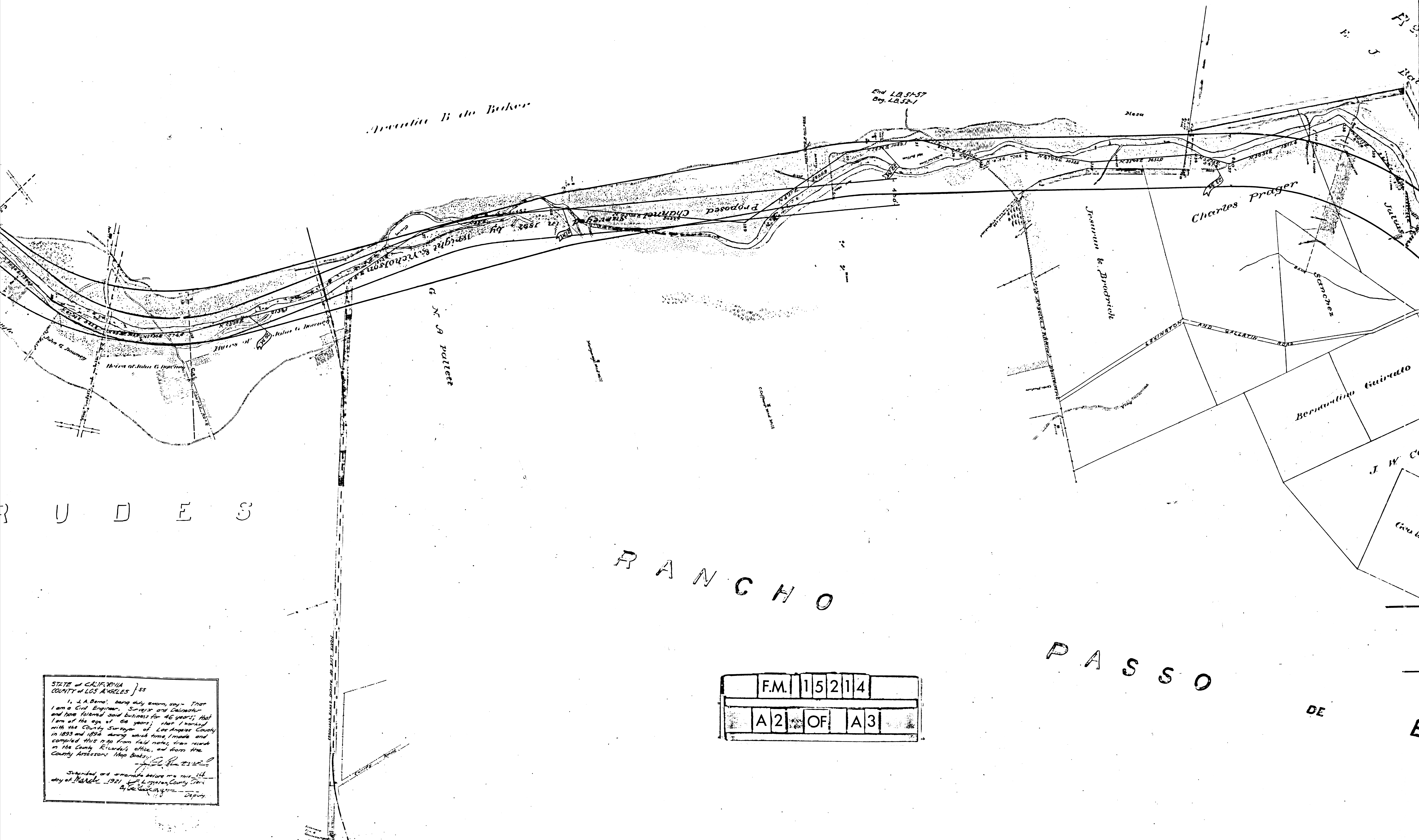

Arceutho B de Baker

End L.B. 51-57
Beg. L.B. 52-1

Charles Proger

Benjamin B. Brundrick

Bernardino Guinaldo

J. W. Co

d N A palletti

Thru of John G. Hutchins

Thru of John G. Hutchins

R U D E S

R A N C H O

D A S S O

DE

STATE of CALIFORNIA }
 COUNTY of LOS ANGELES } ss

I, J. A. Bernal, being duly sworn, say: That I am a Civil Engineer, Surveyor and Calculator and have followed said business for 40 years; that I am of the age of 64 years; that I worked with the County Surveyor of Los Angeles County in 1893 and 1894 during which time I made and compiled this map from field notes, from records in the County Engineer's office, and from the County Assessor's Map Books.

Subscribed and sworn to before me this 14th day of March, 1921 at Los Angeles, County of Los Angeles, State of California.

Deputy

F.M.	15214
A 2	OF A 3



C H O

P A S S O

DE

B A R T O L O

Charles Prager

Julius B. Cohn et al.

F.M.	15214
A3	OF A3

C.S. 5213 F.M. 15213
 C.S. 5217 L.B. 46-47
 F.M. 15217 Old San Gabriel River

T. 1 S. R. 12 W. T. 1 S. R. 11 W.
 T. 2 S. R. 12 W. T. 2 S. R. 11 W.

Sec 1
 R. J.
 Batawin

M E R G E D
 Sec 0

Charles Prager

Benjamin Guinatto

J. W. Cates

Geo. W. Cates

Julius B. Cohn et al.

B. U. Batawin

End L.B. 54-57
 Beg. L.B. 52-53

Mesa

RANGE LINE

LEXINGTON AND SALLATIN

Cohn et al.

3200'

R A N C H O
A N T

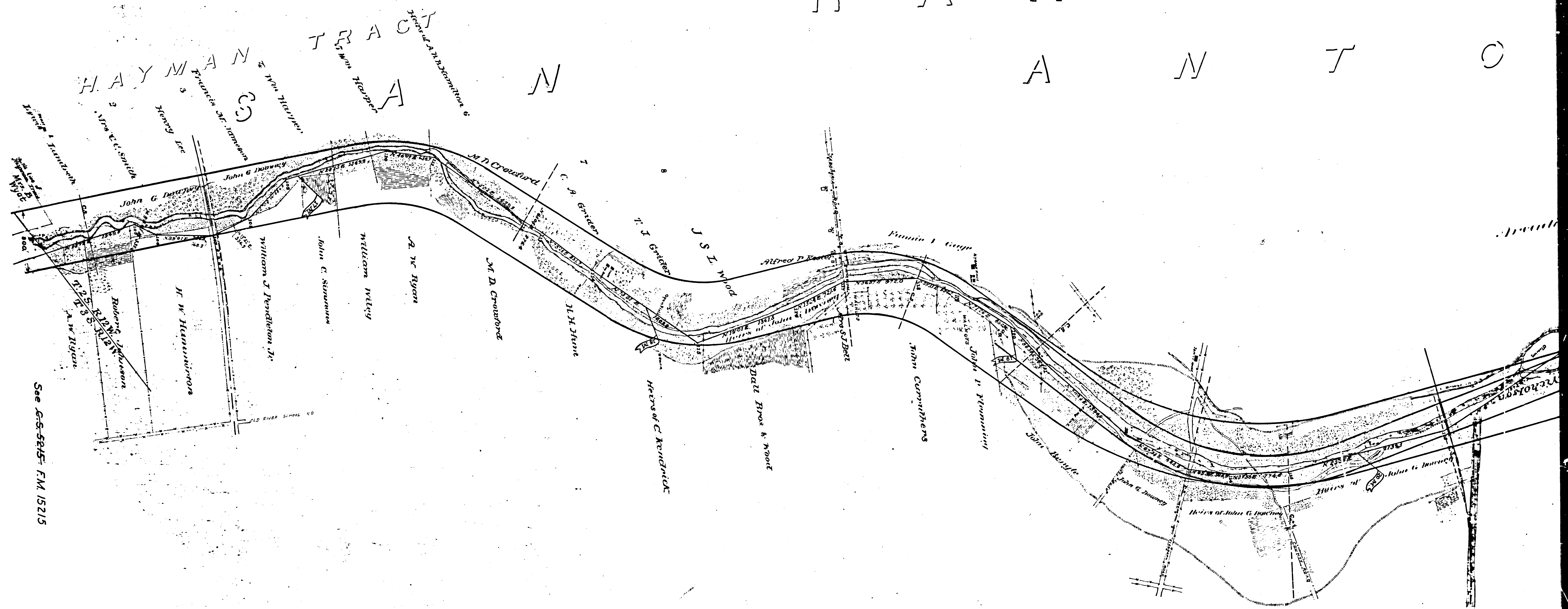

See G.S. 5215 - FM 15215

S A N T A
G E R T R U D E S

OLD SAN GABRIEL RIVER

FILED MAP NO. 15214
 Scale: 1 inch = 500 ft.
 I.M. 32, 36, 4 37
 NEG. 7

F.M.	15214
A1	OF A3

STATE OF CALIFORNIA }
 COUNTY OF LOS ANGELES } ss

I, J. A. Bernel, being duly sworn, say: That I am a Civil Engineer, Surveyor and Calculator and have followed said business for 46 years; that I am of the age of 64 years; that I worked with the County Surveyor of Los Angeles County in 1893 and 1894 during which time I made and compiled this map from field notes, from records in the County Recorder's office, and from the County Assessor's Map Books.

Subscribed and sworn to before me this 1st day of March, 1921, at Los Angeles County, Cal.

J. A. Bernel
 Deputy