

RANCHO

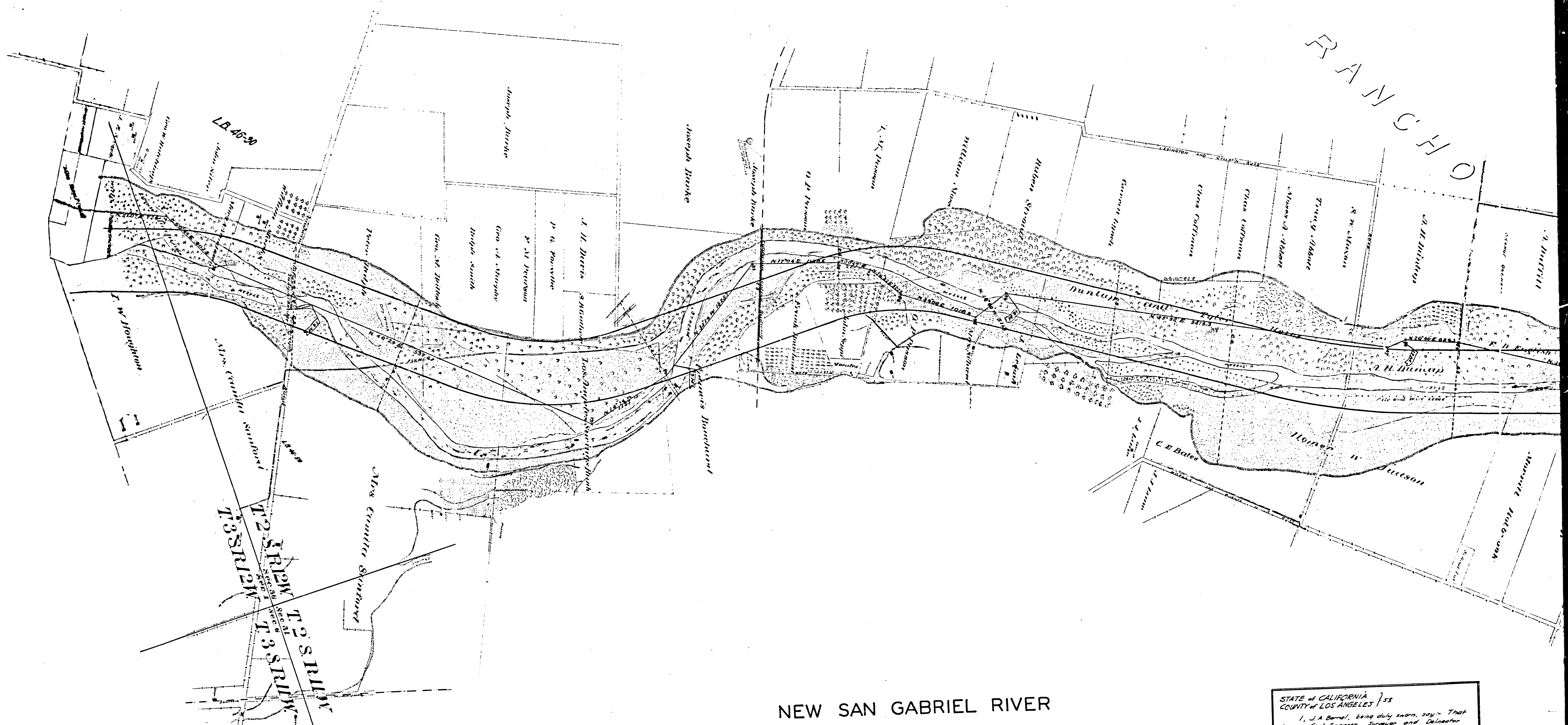

NEW SAN GABRIEL RIVER

FILED MAP NO. 15217

LM. 33, 36, 37  
NEG. 10

F.M. 15217  
A1 OF A2

STATE OF CALIFORNIA }  
COUNTY OF LOS ANGELES }  
I, J. A. Bernal, being duly sworn, say: That  
I am a Civil Engineer, Surveyor and Deedmaker  
and have followed said business for 46 years, and  
I am of the age of 64 years, that I worked  
with the County Surveyor of Los Angeles County  
in 1893 and 1894, during which time I made and  
compiled this map from field notes, from records  
in the County Recorder's Office, and from the  
County Assessor's Map Books.  
J. A. Bernal  
Subscribed and sworn to before me this 31st  
day of March, 1921. E. Lampton, Clerk, County

152  
L-1  
MERCEDES

RANCHO



See C.S. 5213  
C.S. 5214  
F.M. 15213  
F.M. 15214  
L.B. 46-47

|      |       |
|------|-------|
| F.M. | 15217 |
| A2   | OF A2 |

STATE OF CALIFORNIA }  
COUNTY OF LOS ANGELES } ss

I, J. A. Bernal, being duly sworn, say: That I am a Civil Engineer, Surveyor and Deedwriter and have followed said business for 46 years, that I am of the age of 64 years, that I worked with the County Surveyor of Los Angeles County in 1893 and 1894 during which time I made and compiled this map from field notes, from records in the County Recorder's Office, and from the County Assessor's Map Books.

*J. A. Bernal*

Subscribed and sworn to before me this 21st day of March, 1921. E. Lamoreaux, County Clerk.

By *[Signature]* County Clerk