

Poor
Original

MAP OF THE CITY OF LOS ANGELES, CALIFORNIA.

COMPILED FROM SURVEYS MADE BY THE CITY SURVEYOR
AND FROM RECORDS ON FILE IN THE COUNTY RECORDER'S OFFICE.

RING 1886.
OFFICE.

By *U. J. Rowan* and *Theo. G. B.*
SURVEYORS Formerly of the City Surveyors Office.

NOV. 1887.
NEG. 576

F.M.	1	5	3	0	3
A	1	OF	A	2	



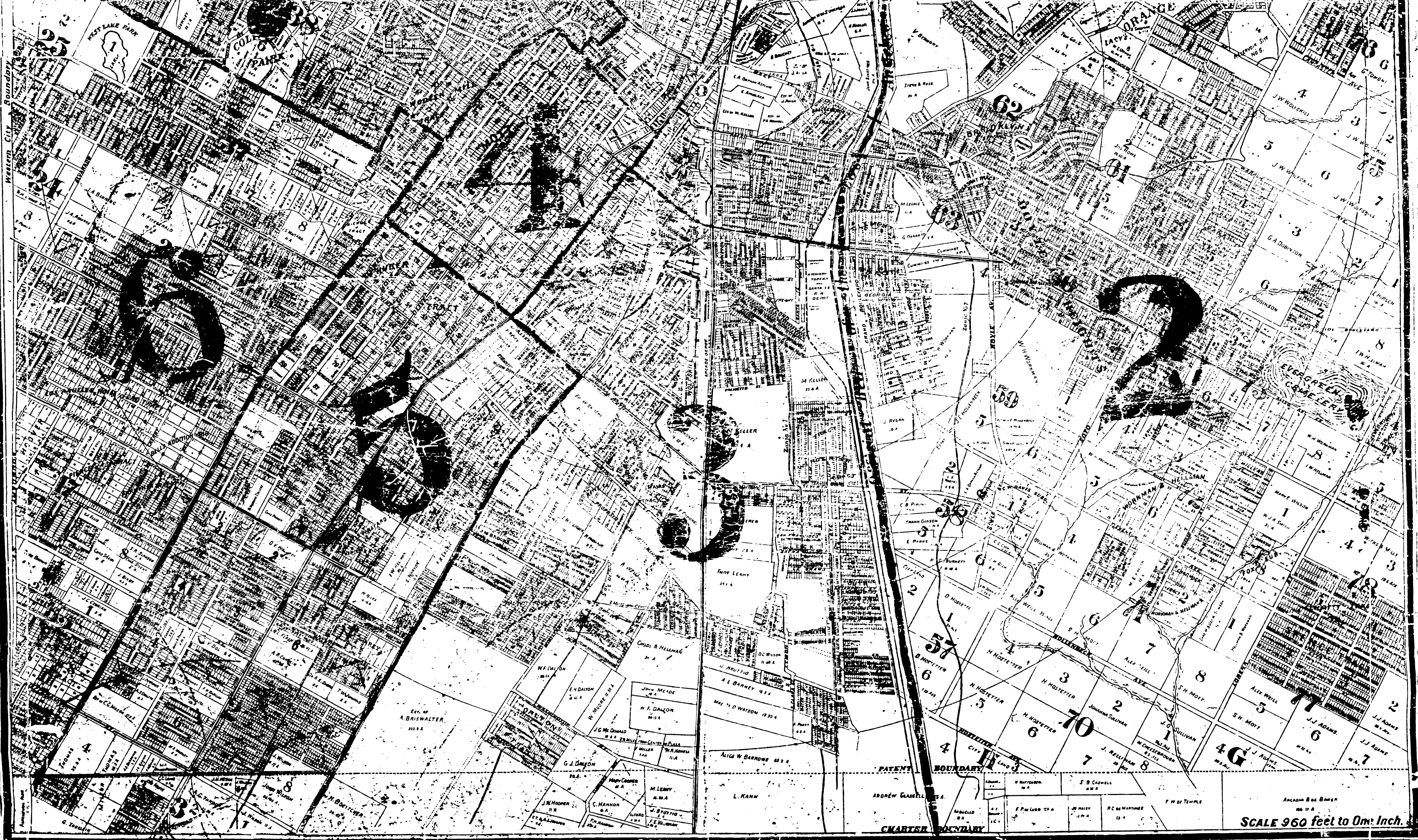

LOS ANGELES LITHOGRAPHIC CO. L.A.

SCALE 960 feet to 0m. Inch.

F.M.	1	5	3	0	3
A	2	OF	A	2	

Poor Original!