

LEGEND OF PROPERTY

PARCEL	AUD. NO.	KIND	DATE	GRANTOR	GRANTEE	RECORDED			PROPERTY RECORD	
						DATE	BOOK	PAGE	VOL.	PAGE
	3085	D.R.S.	May 28, 1889	Pacific Improvement Co.	S.P.R.R. Co.	June 27, 1889	584	128		
	3082	Ordinance	Jan 16, 1893	The Long Beach Land Water	Closing Rescondo Rd.	Jan 23, 1893	339	34		
	173258	Easement	Mar 24, 1913	S.P.R.R. Co. & S.P.Co.	City of Los Angeles					

COLOR SCHEME

- Proprietary Companies Bonds Yellow
- Southern Pacific Co.'s Bonds Scarlet
- Overlapping S. P. Co. with Proprietary Co.'s Bonds Orange
- Proprietary Companies Franchises Green
- Southern Pacific Co.'s Franchises Violet
- Proprietary Co.'s Easements, Condemnations, Agreements and Leases Brown
- Southern Pacific Co.'s Easements, Agreements and Leases Brick Red
- Lands held by Adverse Possession Blue
- Lands lost by Adverse Possession Yellow or Scarlet, Hatched thus
- Right of Way by Act of Congress Red Stripes
- Right of Way reserved by S. P. Land Department Sepia
- Right of Way reserved to Original Owners Yellow or Scarlet, Hatched thus
- Proprietary Companies Lands sold to other parties Yellow, Black Hatching
- Proprietary Co.'s Lands sold to S. P. Co. Yellow, Scarlet Hatching
- Southern Pacific Co.'s Lands sold to Scarlet, Black cross-hatching
- Southern Pacific Co.'s Lands sold to Scarlet, Yellow hatching
- Title acknowledged by Grantees acceptances of Company Bonds Hatching, no Color
- Surface Overhead and Underground Crossings to other parties Thin

FM 16309
AT OF A 2

1M30
 1M28
S. P. R. R. CO.
 Long Beach Branch
THENARD to ALAMITOS BEACH

MAP OF
 Real Estate and Right of Way Properties through
 LOS ANGELES COUNTY, CALIFORNIA
 Scale 400 feet to 1 inch
 1914

M.W.D.	
Drawing	2405
Sheet	1
Drawer	2085

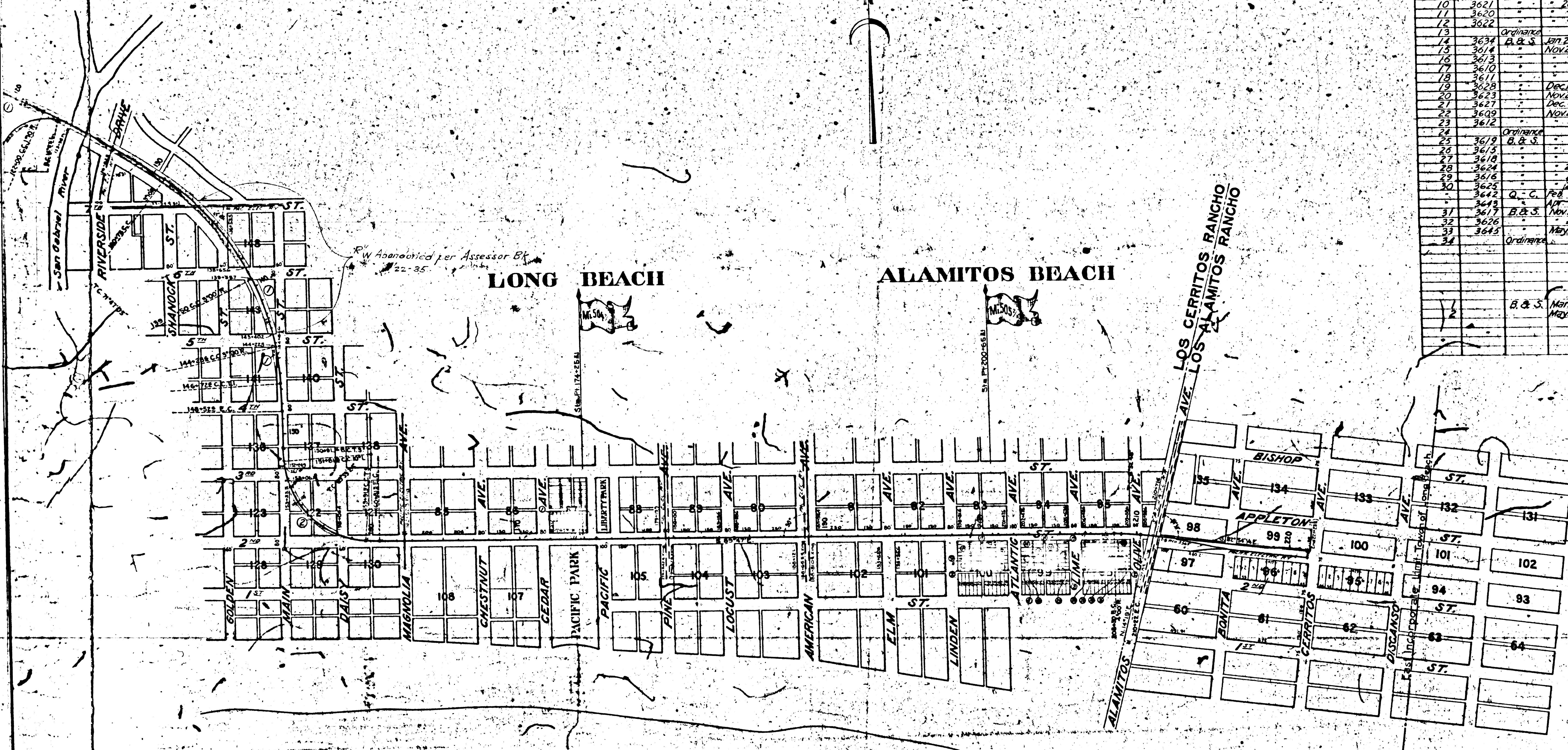

PARCEL	AUDN ^o	KIND	DATE	GRANTOR	GRANTEE	RECORDED			PROPERTY RECORD	
						DATE	BOOK	PAGE	VOL.	PAGE
1	3082	D. & S.	Jan 13, 1899	The Long Beach Land & Water Co.	S. P. R. Co.	Jan 25, 1899	539	34		
2	3083	"	"	"	"	"	"	"		
3	3508	"	June 22, 1899	J. N. Shaffer, et al.	"	July 6, 1899	1904	130		
4	3506	"	July 10	"	"	July 12, 1899	1301	228		
5	3510	"	June 30	"	"	"	"	"		
6	3407	"	"	"	"	"	"	"		
7	3081	Ordinance	May 28, 1899	City of Long Beach	City of Long Beach	June 27, 1899	584	28		
8	3608	"	Nov 25, 1902	G. E. Bruce, et al.	S. P. R. Co.	Dec 20, 1902	1725	11		
9	3627	"	"	"	"	"	"	"		
10	3627	"	"	"	"	"	"	"		
11	3629	"	"	"	"	"	"	"		
12	3622	"	"	"	"	"	"	"		
13	3622	"	"	"	"	"	"	"		
14	3634	B. & S.	Jan 21, 1903	J. B. Fiddick, et al.	S. P. R. Co.	Jan 25, 1903	1776	123		
15	3614	"	Nov 23, 1902	Frank M. Schenck	"	Dec 20, 1902	1725	14		
16	3613	"	"	G. O. Jones, et al.	"	"	"	"		
17	3610	"	"	C. J. Moody, et al.	"	"	"	"		
18	3611	"	"	Julian Woodard, et al.	"	"	"	"		
19	3623	"	Dec 11, 1902	F. J. Crowe, et al.	"	Jan 7, 1903	1734	15		
20	3623	"	Nov 26	W. L. Lambert, et al.	"	Dec 20, 1902	1727	4		
21	3627	"	Dec 4	Ana Eliza Stralton	"	"	"	"		
22	3626	"	Nov 23	Thomas C. Reichel, et al.	"	"	"	"		
23	3612	"	"	Howe & Elough	"	"	"	"		
24	3619	Ordinance	"	City of Long Beach	Abandoning Alley Bldg	"	"	"		
25	3619	B. & S.	"	John H. Elaby, et al.	S. P. R. Co.	"	"	"		
26	3615	"	"	M. Bridges	"	"	"	"		
27	3610	"	"	James G. Cox, et al.	"	"	"	"		
28	3624	"	"	Margaret A. Freeman	"	"	"	"		
29	3616	"	"	Mary J. Carroll, et al.	"	"	"	"		
30	3615	"	"	Mrs. Ruth Wilson	"	"	"	"		
31	3642	Q. C.	Feb 2, 1903	Mrs. Alice Coffin	"	Apr 30, 1903	1784	228		
32	3643	B. & S.	Nov 23	E. B. Wilson	"	"	"	"		
33	3636	"	"	Joseph Allen	"	"	"	"		
34	3645	"	"	Harriet E. Durr	"	"	"	"		
35	3645	"	"	F. O. Cass, et al.	"	May 23, 1903	1824	2		
36	3645	Ordinance	"	City of Long Beach	Abandoning Alley Bldg	"	"	"		

LONG BEACH ALAMITOS BEACH

PACIFIC

OCEAN

COLOR SCHEME

Proprietary Companies Deeds	Yellow
Southern Pacific Co.'s Deeds	Scarlet
Overlap S. P. Co. with Proprietary Co.'s Deeds	Orange
Proprietary Companies Franchises	Brown
Southern Pacific Co.'s Franchises	Violet
Proprietary Co.'s Easements, Condemnations, Agreements and Leases	Brown
Southern Pacific Co.'s Easements, Agreements and Leases	Brick Red
Lands held by Adverse Possession	Blue
Lands lost by Adverse Possession	Yellow or Scarlet, Hatched thus
Right of Way by Act of Congress	Blue Shaded
Right of Way reserved by S. P. Land Department	Sepia
Right of Way reverted to Original Owners	Yellow or Scarlet, Hatched thus
Proprietary Companies Lands sold to other parties	Yellow, Black hatching
Proprietary Co.'s Land sold to S. P. Co.	Yellow, Scarlet hatching
Southern Pacific Co.'s Lands sold to	Scarlet, Black cross-hatching
Southern Pacific Co.'s Lands sold to	Scarlet, Yellow hatching
Title acknowledged by Grantees acceptance of Companies Deeds	Hatching, no color
Surface Overhead and Underground Crossings to other parties	Thin

S. P. R. CO.
 Long Beach Branch
THEWARD to ALAMITOS BEACH
 MAP OF
 Real Estate and Right of Way Properties through
 LOS ANGELES COUNTY, CALIFORNIA
 Scale 400 feet to 1 inch
 1914

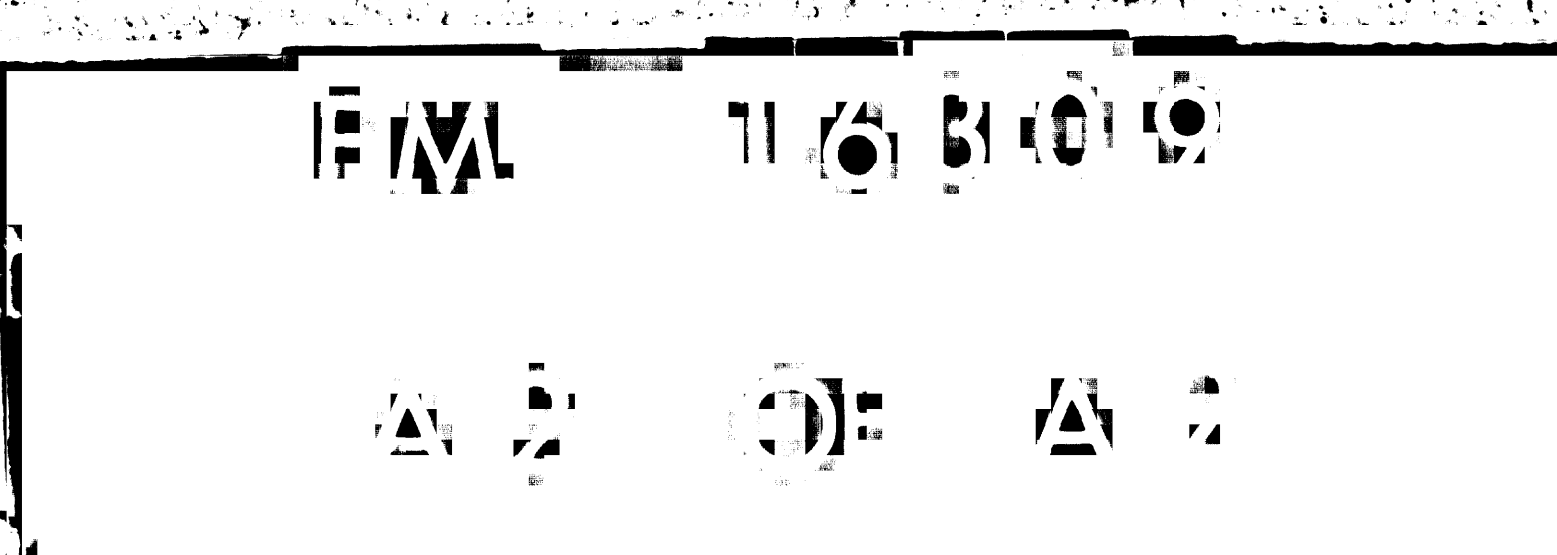

M.W.D.
 Drawing 24
 Sheet 4
 Drawer 10