

MAP  
OF  
RECONSTRUCTED LINE  
AT  
THE PALMS.  
SCALE 100'-1"

Line upon which original Right of Way was granted.  
Line upon which R.R. 1. and R.R. 2. were granted.  
New Line completed July 1894.

F.M. 16316  
A 11 OF A 3



as granted  
re granted

F.V. 11 63 11 6  
A 2 OF A 3

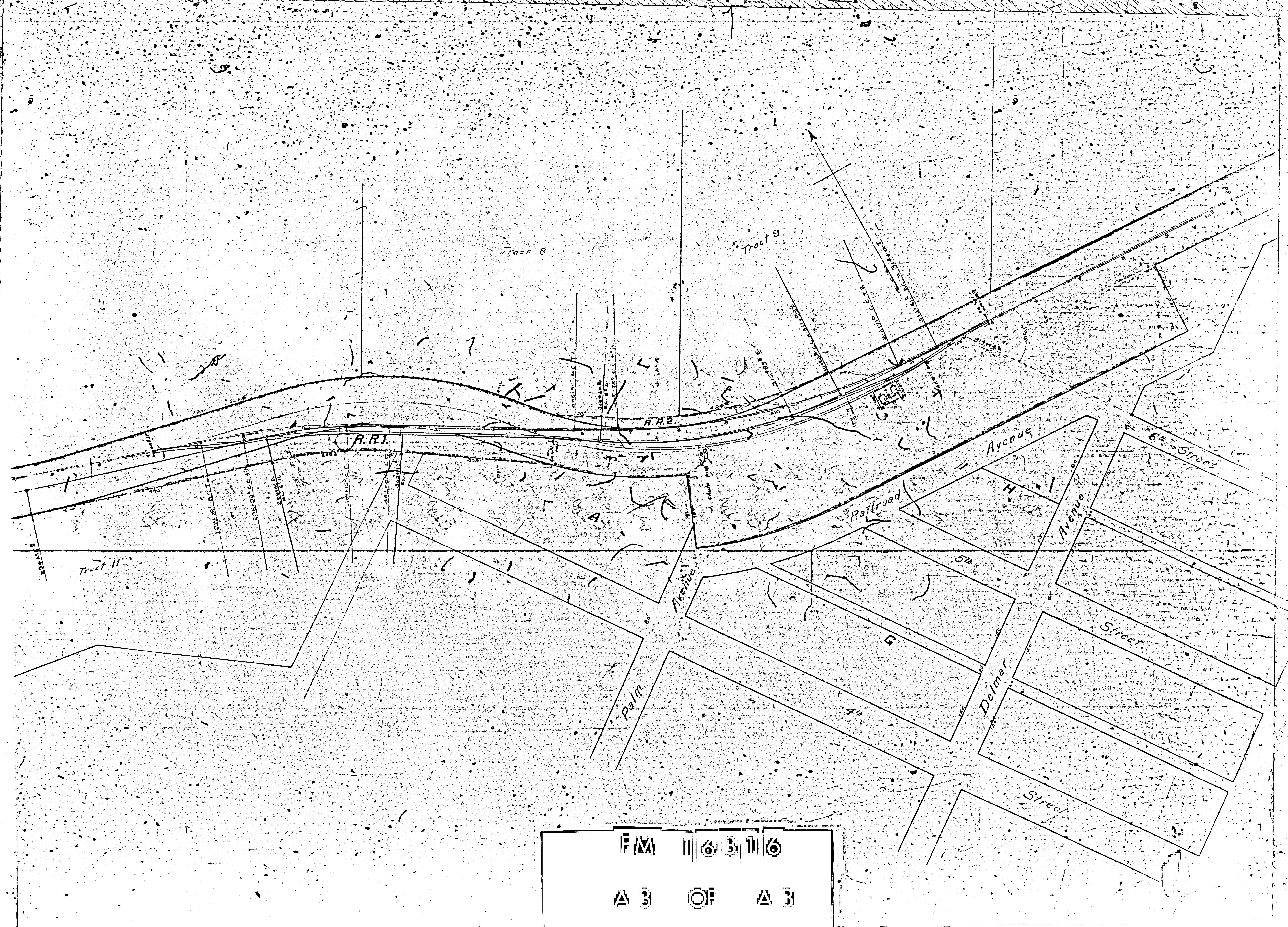

F.M. 11 6 3 11 6  
 A 3 OF A 3