

NOTE:
 ORIGINAL CENTER LINE SHOWN IN BLACK.
 PRELIMINARY RELOCATION RED.
 FINAL NEW R.O.W. ACQUIRED FROM PHELPS, BASED ON RED LINE.

#5

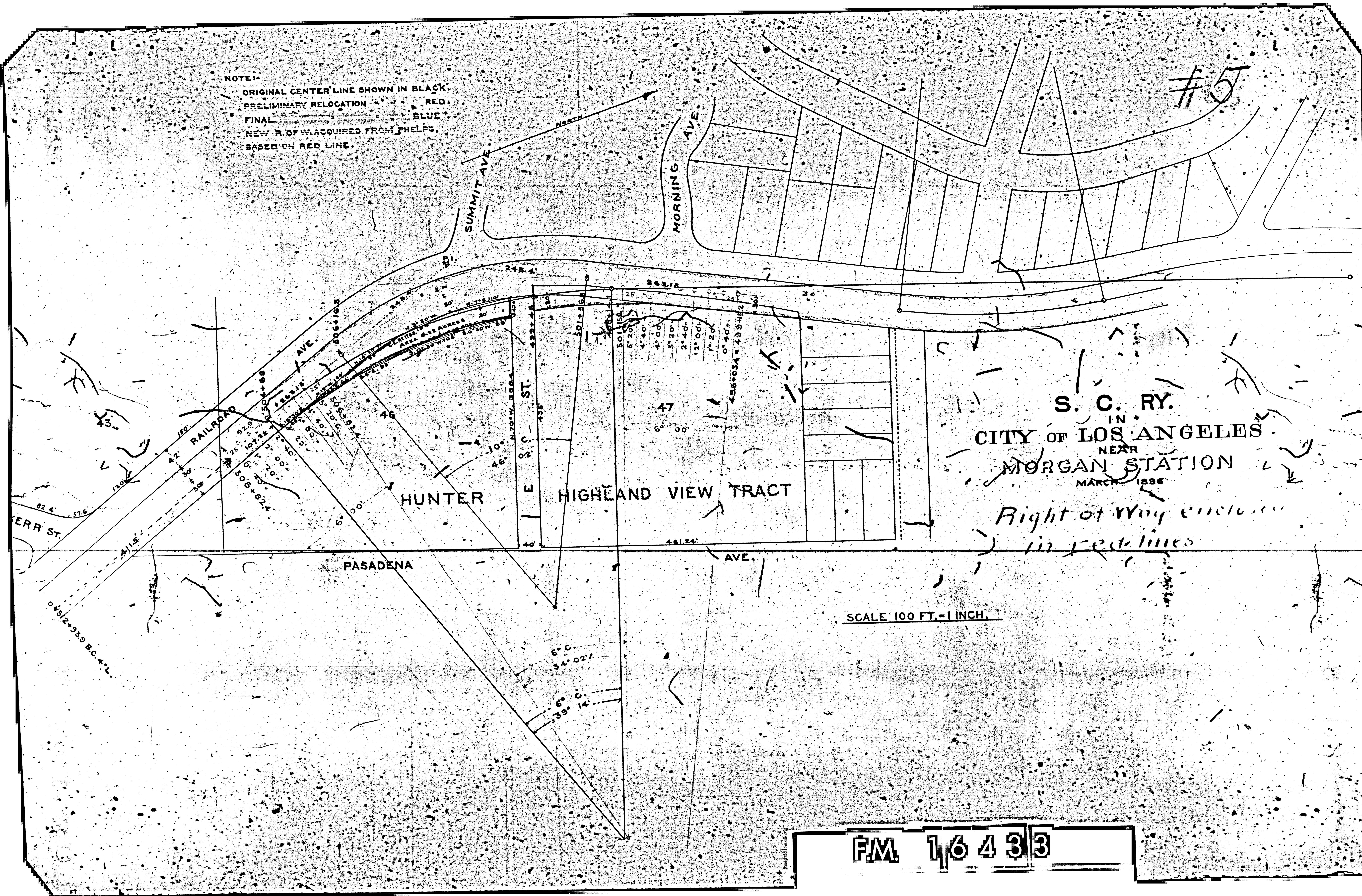

S. C. RY.
 IN
 CITY OF LOS ANGELES
 NEAR
 MORGAN STATION
 MARCH 1896

*Right of Way enclosed
 in red lines*

SCALE 100 FT. = 1 INCH.

FM 16433