

RANCHO LA BALLONA

Mesmer (Owner)

Sou. Cal. Ry. to Los Angeles Pacific R.R. Co.
Spec. Misc. Map No. D-283
Santa Monica Branch Ry.

Scale 400ft = 1 inch

SANTA MONICA JUNCTION

Barron Hankaid & Co. (Lessee)
Mesmer (Lessor)

COUNTY ROAD

RANCH LINE

RANCHO SAUSAL REDON

27 Tractman 10 Acres

25

CENTRAL PACIFIC

Channel



1/4	1/2	3/4	1
1/8	1/4	3/8	1/2



*Bureau of Land & Co. (Lessee)
Thomas (Lessee)*

19

20

21

RANGE LINE BETWEEN T.P.S. R.M. AND T.P.S. R.M.

COUNTY ROAD

RANCHO DE CENTINELA

D. Freeman, Owner

DANVILLE

Cal. Ry. to Los Angeles Pacific R.R. Co.
Sandy Mt. R.R. No. 10-183
Santa Monica Branch Ry.

25

30

23

23

SAL REDONDO

CITY OF INGLEWOOD

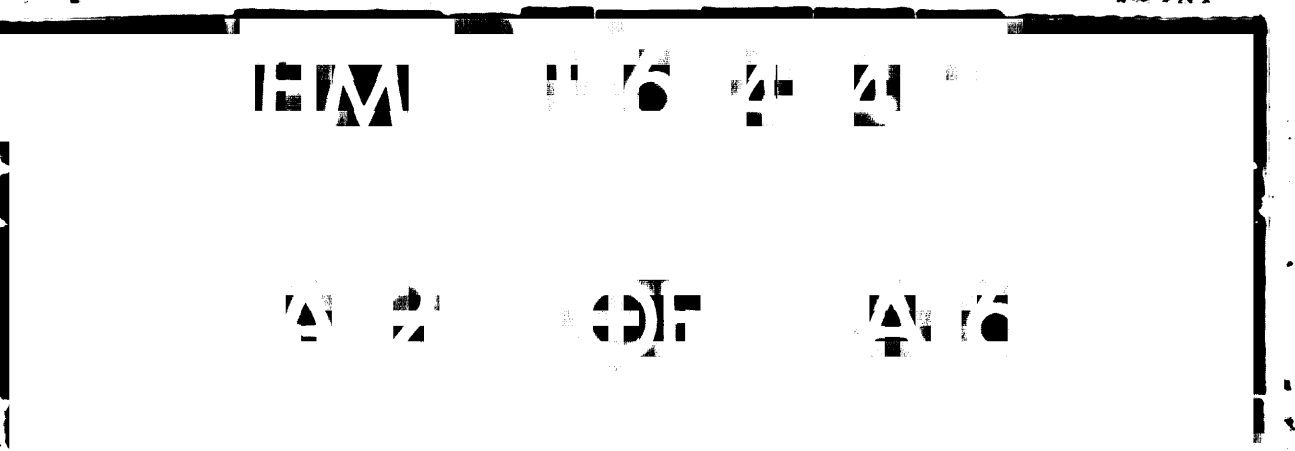

21

D. Freeman

J.J. Lewis

HYDE PARK

LOS ANGELES CITY WEST BOUNDARY LINE OF

23

27

LOCATION SURVEY

OF THE

CALIFORNIA CENTRAL RAILWAY

L.A. and S.M. Div.

FROM LOS ANGELES TO BALLONA HARBOR

STA 490 TO STA 961 400 FT. = 1 INCH
 MARCH 1896

NOTE: COURSES ARE CALCULATED FROM EAST RIVERSIDE BA

RANCHO DE

Sec 29

MEADOW ST
 CYPRESS ST
 MORADO ST
 VIOLA ST
 ORCHARD ST
 REGENT ST
 QUEEN ST
 CITY
 BIMIENTO ST
 OLIVE ST
 NECTARINE ST
 MANGO ST
 LIME ST
 REDONDO ST

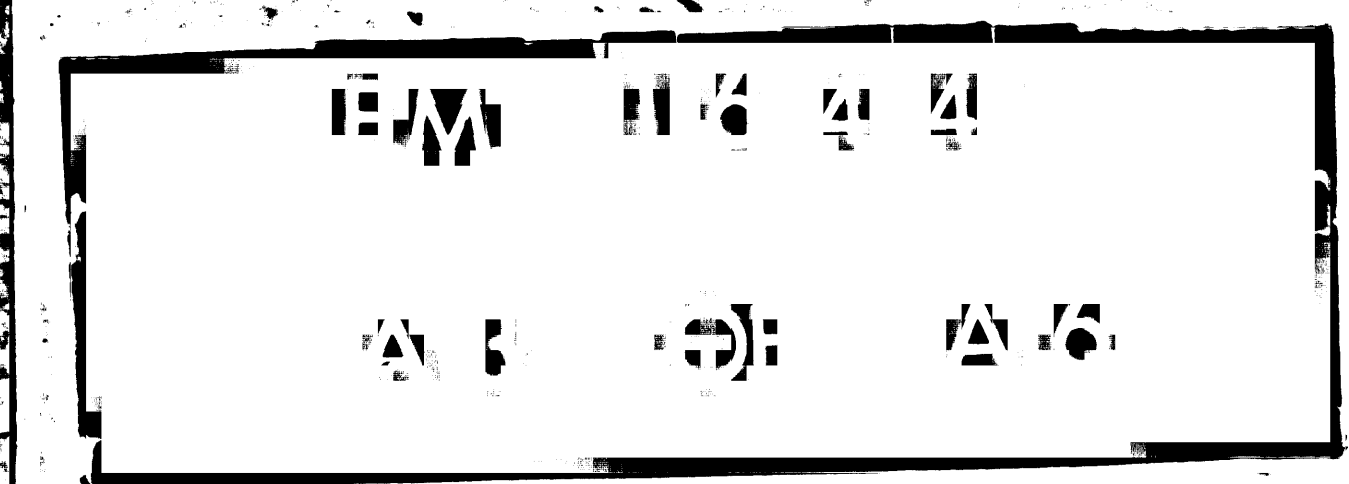



Sec. 21

SEC. 22

SEC. 23

SEC. 27

Sec. 28

CENTINELA

HYDE

PARK

SCHOOL

INGLEWOOD

INGLEWOOD

WOOD

SCHOOL

WOOD

CITY

CITY

OF

12 1/2 11 1/2 2 1/2
2 1/2 10 2 1/2

CITY OF LOS ANGELES - General Plans, 1921-1922
 Showing the proposed street layout in the vicinity of
 the proposed street layout in the vicinity of



116 21 24
 116 21 24

OK

WESTERN

Sec 17

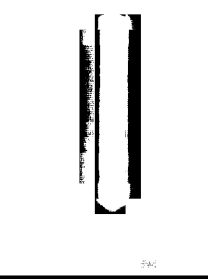



THE ATCHISON TOPEKA & SANTA FE RY CO.
 LOS ANGELES DIVISION
 DRAWING NO. K-32682
 RIGHT OF WAY
 BETWEEN
 REDONDO JUNCTION AND INGLEWOOD
 SCALE 1" = 400 FT.

LOS ANGELES CALIF.
 NOVEMBER 1910
 H.C. PHILLIPS
 CHIEF ENGINEER

NOTE: COURSES ARE CALCULATED AND SET BY INSTRUMENTS

