

CITY OF POMONA

Los Angeles County Highway

BOULEVARD

Esate Louis Phillips  
D 1116

WEST BOUNDARY

228

SCHOOL

FIFTH AVE

JOHN SEITZ  
SUBDIVISION  
MAR 25-48

PART OF LEMOR  
MAR 22-48

TRACT

LE MAR'S  
MAR 25-48

SUBDIVISION

HUGHES  
MAR 25-48

228  
Vocals

LEMON ST

MYRTLE ST

HAMILTON

MONROVIA

WHITE  
CYPRESS  
REBECCA ST

FIRST ST

SECOND ST

THIRD ST

FM 16512-2

A1 OF A4

# CITY OF POMONA



FM 16512-12  
A 2 OF A 4

**MAP**  
 OF THE  
**SAN PEDRO, LOS ANGELES & SALT LAKE RAILROAD**  
 BETWEEN  
**POMONA & ONTARIO**  
 Scale 200 feet to inch.  
 H. Hawgood, Chief Engineer. 1903.



F/M 16512 = 2

A 3 OF A 4

LOS ANGELES & SALT LAKE RAILROAD

**MAP**  
 OF THE  
**SAN PEDRO, LOS ANGELES & SALT LAKE RAILROAD**  
 BETWEEN  
**POMONA & ONTARIO**  
 Scale 200 feet to an inch.  
 H. Hawgood, Chief Engineer, 1903.

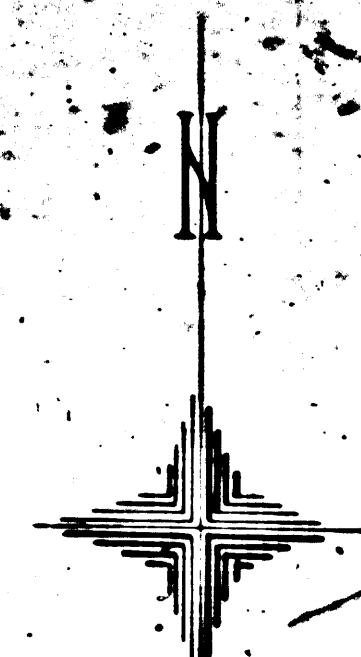

EAST BOUNDARY CITY OF POMONA

LOS ANGELES COUNTY  
SAN BERNARDINO COUNTY

