

MAP
 showing land to be taken
 DISTRICT OF ASSESSMENT
 for the opening of
TWENTY-SEVENTH STREET
 BETWEEN WESTERN AVE AND THE BOULEVARD TH
 CITY OF LOS ANGELES CAL.

J.H. DOCKWEILER City Engineer JULY 1898
 SCALE 60 FEET = 1 INCH ORDINANCES N^o 5096 AND 5192

Land to be taken shown colored red.
 Exterior boundaries of District of Assessment
 shown colored green.

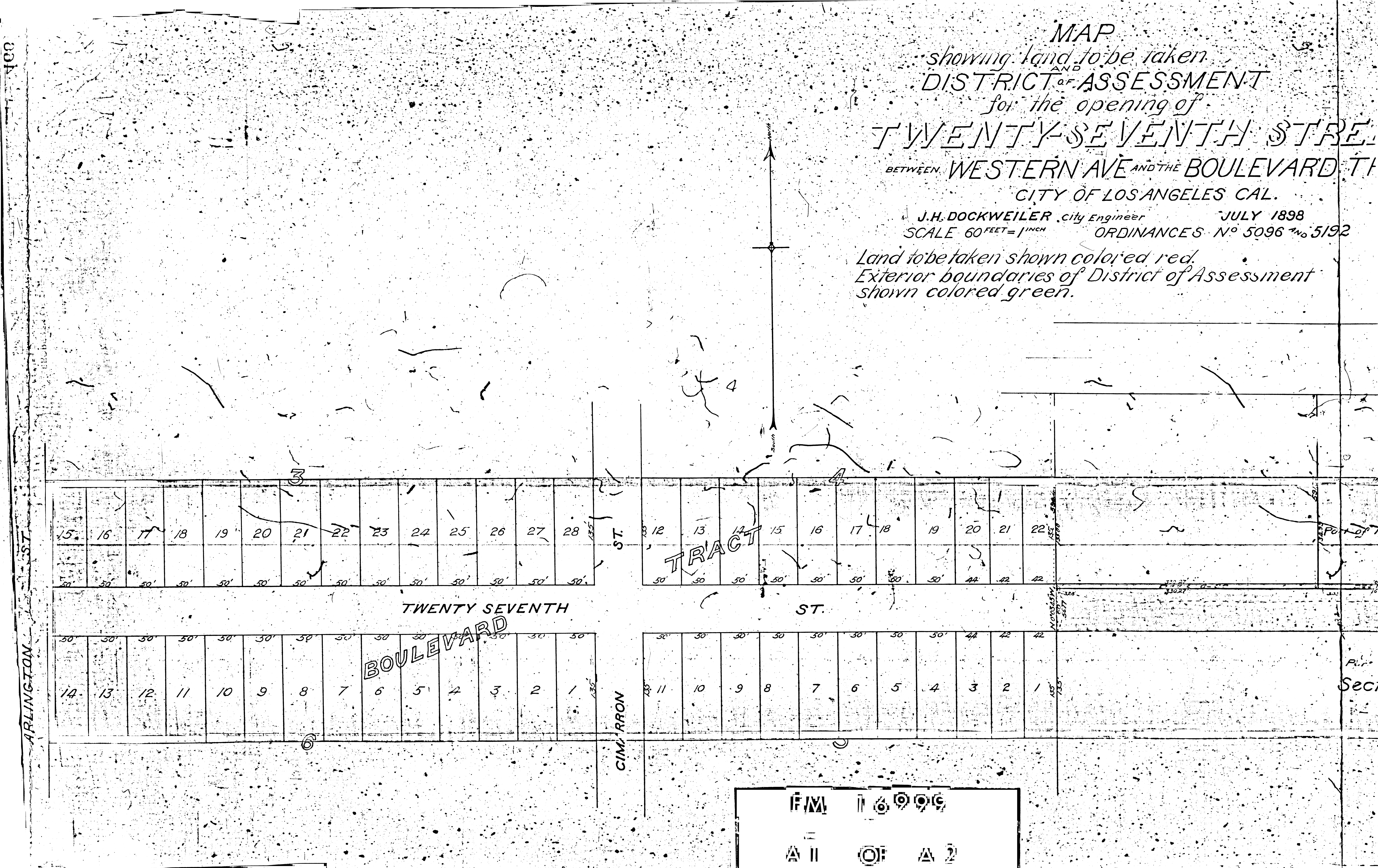

F/M 16099
 A II OI A 2

MAP
 showing land to be taken
 DISTRICT OF ASSESSMENT
 for the opening of
VENTY-SEVENTH STREET
 BETWEEN WESTERN AVE AND THE BOULEVARD TRACT
 CITY OF LOS ANGELES CAL.

J.H. DOCKWEILER City Engineer JULY 1898
 SCALE 60 FEET = 1 INCH ORDINANCES No 5096 AND 5192

Land to be taken shown colored red.
 Boundaries of District of Assessment
 colored green.

All proceedings completed
 under Ord. 5096 & 5192
 Location As shown on this map.
 For Original -

