

MAP  
 SHOWING LAND TO BE TAKEN AND DISTRICT OF ASSESSMENT  
 FOR THE  
 WIDENING AND STRAIGHTENING  
 OF  
**LYON STREET**  
 BETWEEN  
 (ALISO STREET AND MACY STREET)  
 IN THE  
 CITY OF LOS ANGELES

U.S. DOCKET NO. 123, City Engineer, No. 1, 1898.  
 S32° 50' 13" 30" E 122.72' C  
 Ordinances 127, 205 and 3235 (Amended)

Sht. 7

Note: Red lines show original colored and  
 blue lines show proposed widening, district and street colored areas.  
 Blue lines and figures show area of proposed widening to cross  
 cases where the actual roadway and front the record subdivisions.

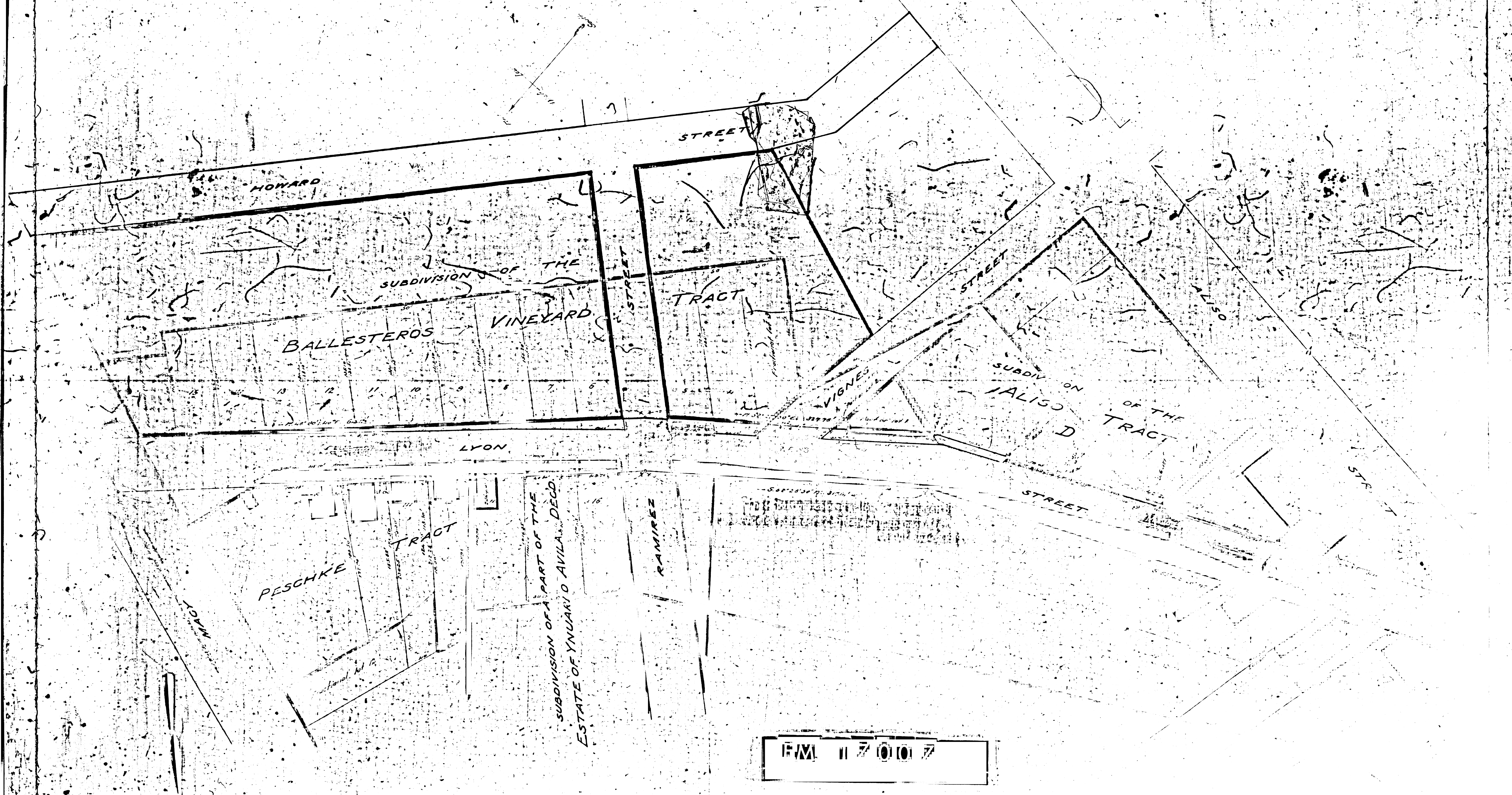

11700