

MOUNTAIN VIEW CEMETERY ADDITION

Being Lots 19 to 20, Block 29, the south 1/2 of Lot 1 & 2, Block 28 of Re-Sub. of certain blocks of Alameda, Map 1 as recorded in Book 4, page 83, Miscellaneous Records of Los Angeles County, and various portions of Alameda Street by Sacramento Street adjoining said lots.

Scale 1 inch = 40 feet

Boundary surveyed April 1905 by T. D. Allen

S. E. COR. 1/4 16 22 WOOD TRACT



ALAMEDA STREET

STREET

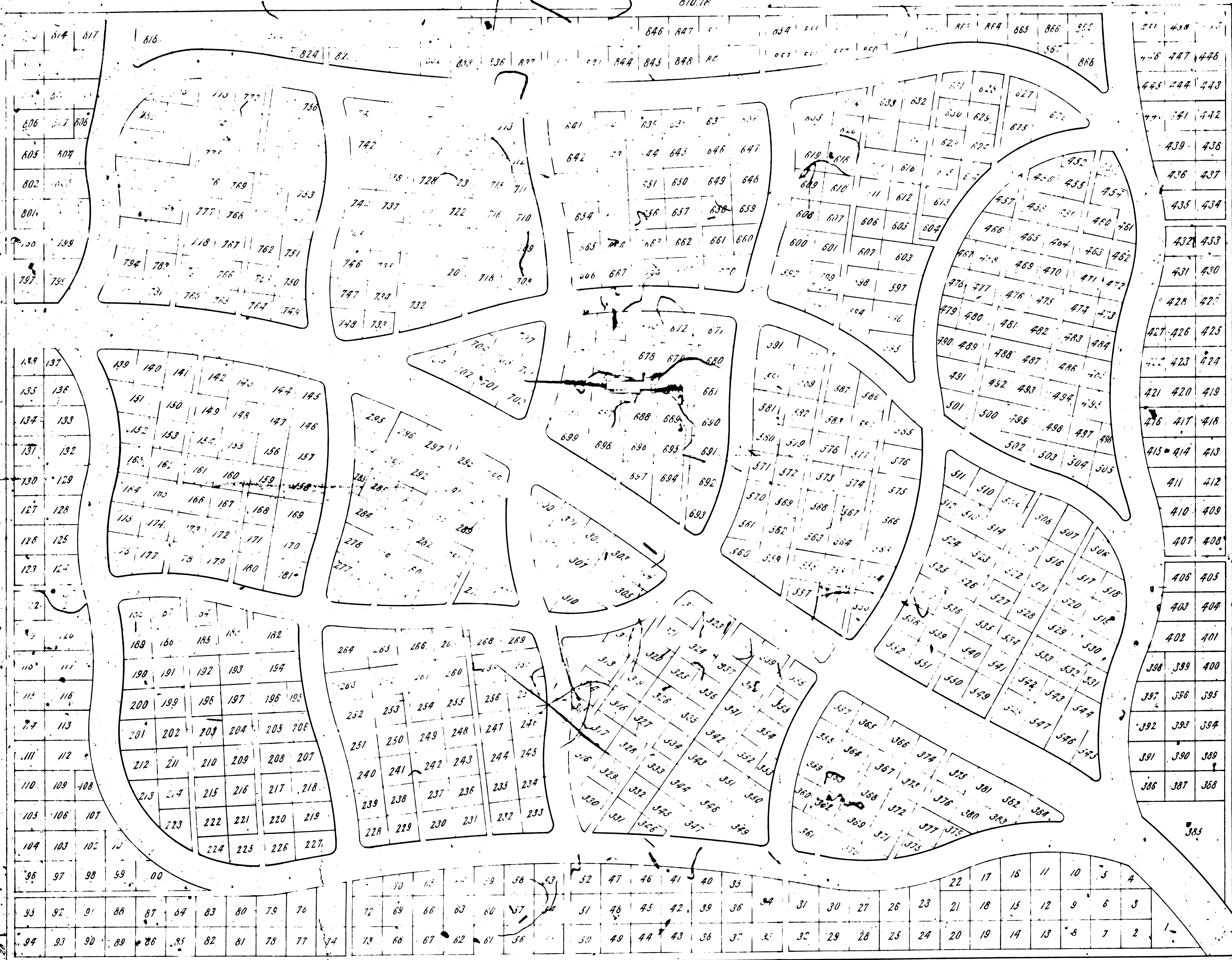

SACRAMENTO STREET

STREET

We hereby certify that the Pasadena Cemetery Association, a Corporation, is the owner of Mountain View Cemetery Addition as shown on this map and that said map has been made in accordance with the instructions of said Association.

By *S. R. ...* President
By *...* Secretary

State of California, County of Los Angeles, ss. On this 20th day of May, in the year One Thousand Nine Hundred and Five, before me, J. H. Woodworth, a Notary Public in and for the County of Los Angeles, personally appeared S. R. ... and James ... both of legal age, and being duly sworn, depose and say that they are the President and Secretary of the Pasadena Cemetery Association, the Association that executed the above certificate and acknowledged to me that said Association executed the same in its corporate capacity.

J. H. Woodworth
Notary Public in and for the County of Los Angeles, State of California.