

Los Angeles Railway
WEST SIXTH ST. DIV.
 Rampart St to Fourth St
 Sta 0+00 to Sta 118+26.90
 FB 120. May 17, 1907.
 Scale 1" = 30'

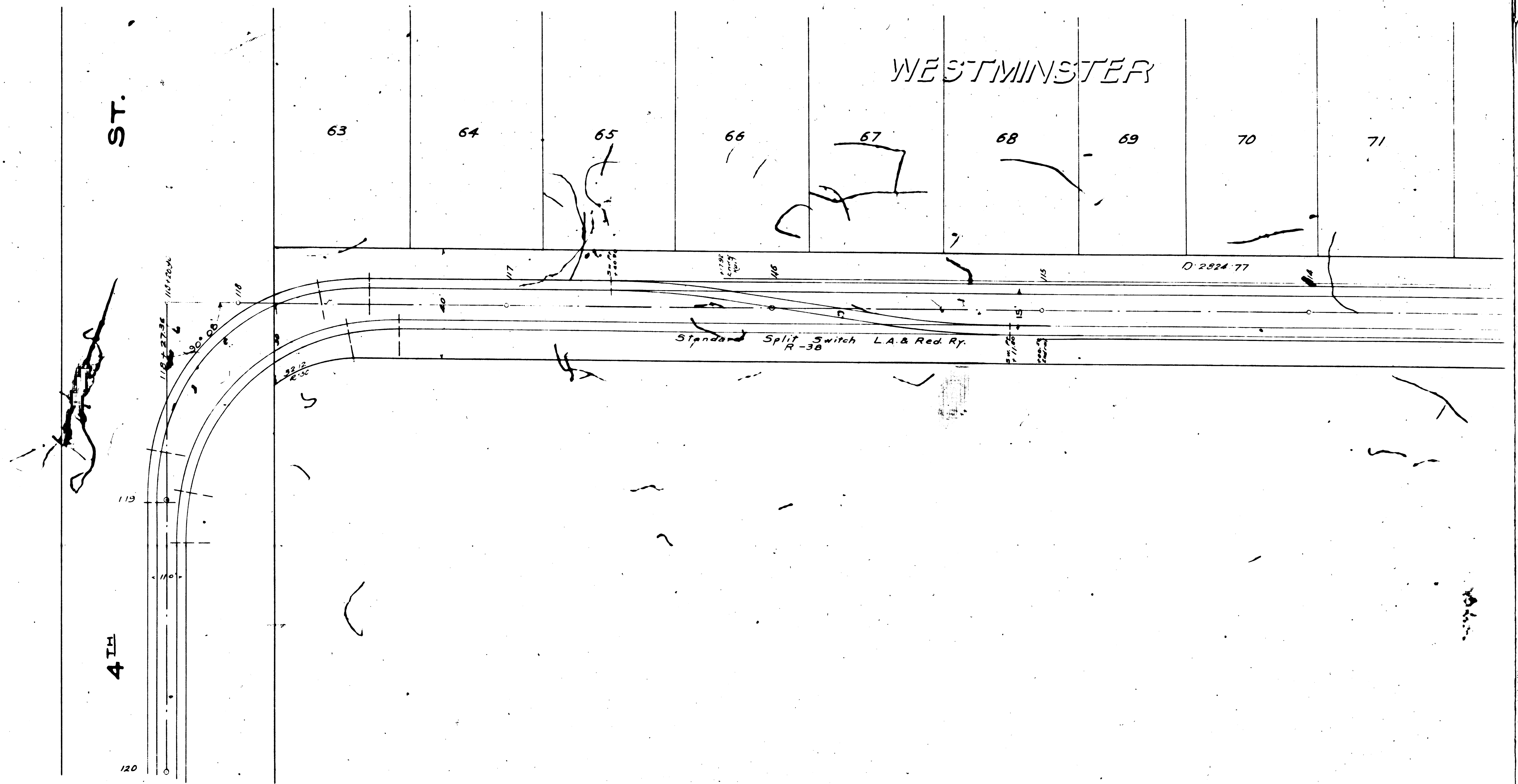

FOR CONTINUATION, SEE #190

FM 17514
A1 OF A16

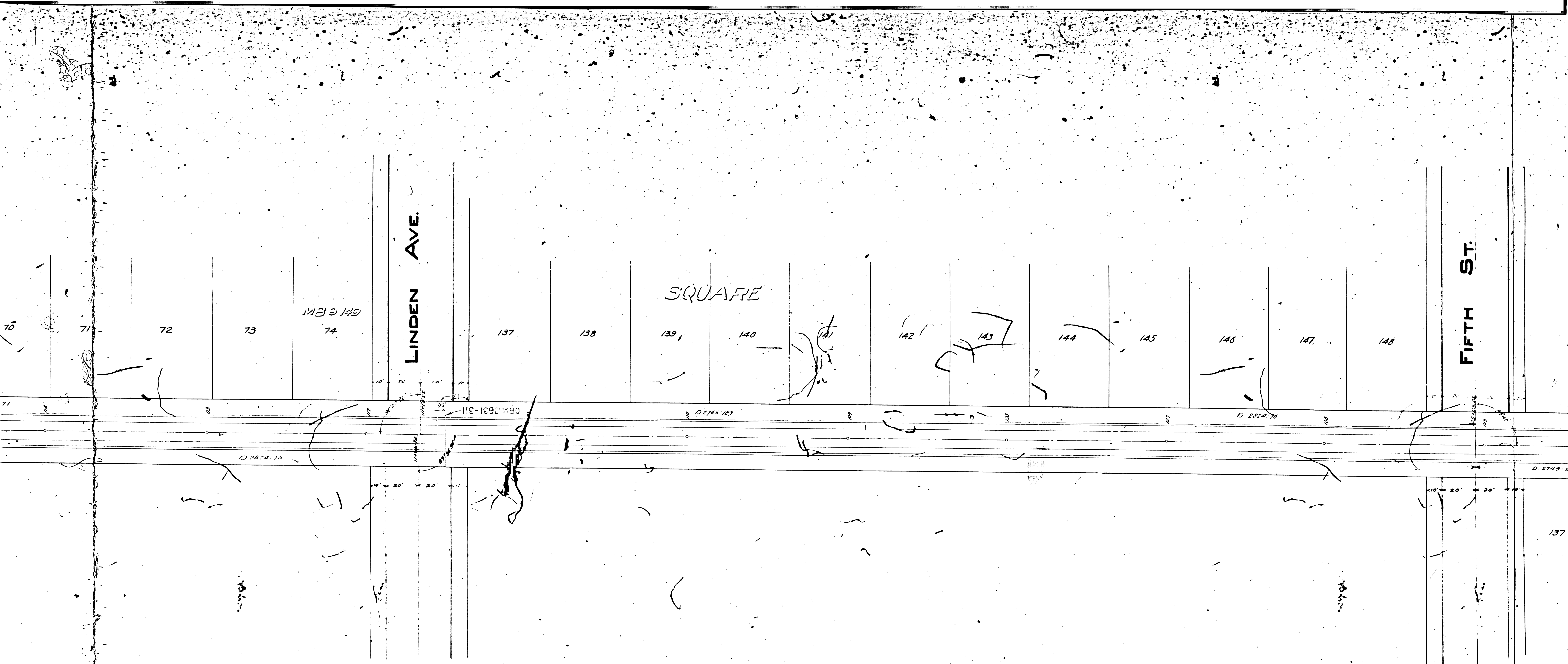

LINDEN AVE.

FIFTH ST.

SQUARE

149 148

72

73

74

137

138

139

140

141

142

143

144

145

146

147

148

ORM:12631-311

D 2165-129

D 2024-78

D 2743-2

D 2674-15

20' 20'

20' 20'

137

FM 17514
A 2 OF A 16

FIFTH ST.

WESTMINSTER PLACE

M.B. 9-157

10

9

8

7

6

5

4

3

129

128

127

D. 2743-245

D. 2743-285

D. 2743-245

D. 2756-200

137

136

135

134

133

132

131

130

129

WILTSHIRE TERRACE

M.B. 8-75

FM 17514

A 3 OF A 16

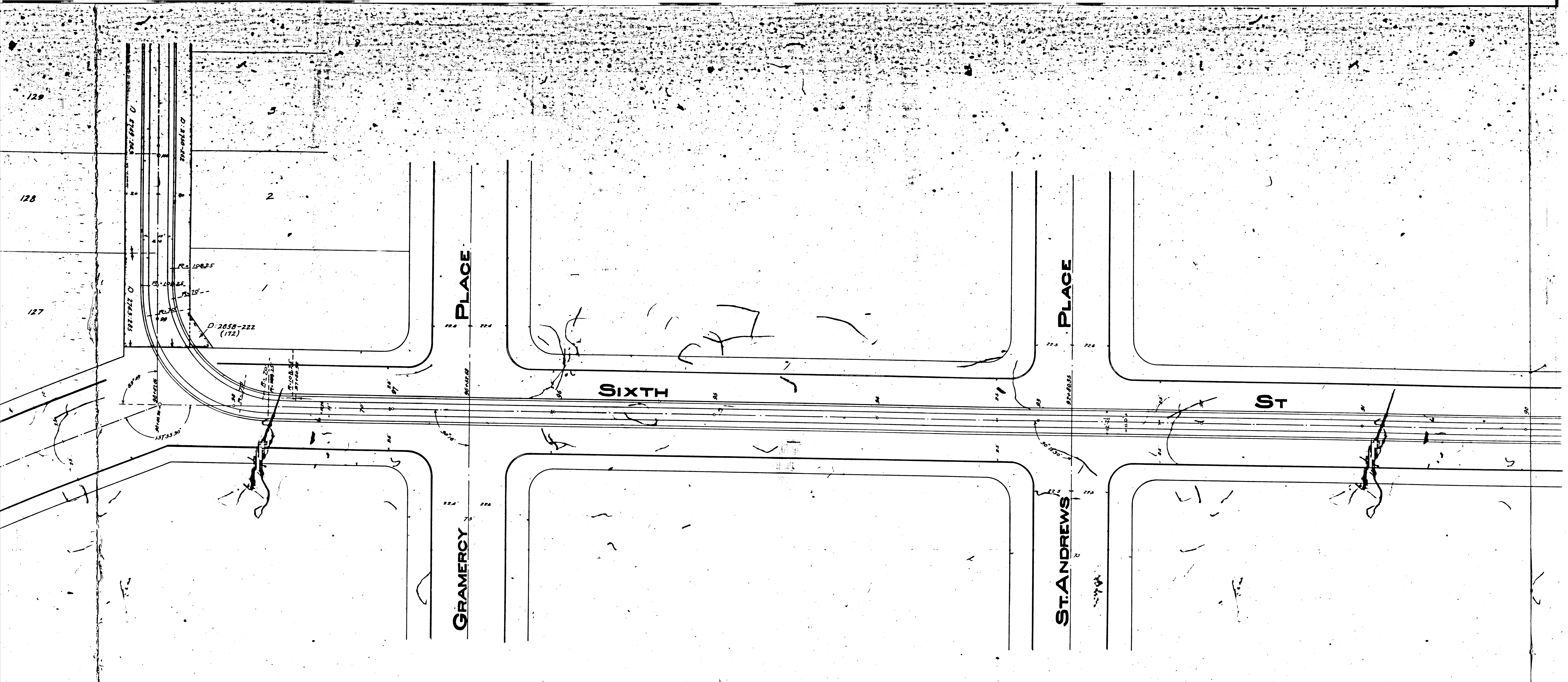

FM 17514
A4 OF A16

PLACE

MANHATTAN

AVE.

WESTERN

BLVD.

OXFORD

FM 17514
A 5 OF A 16

BLVD

BLVD

BLVD

OXFORD

CAHUENGA

HOBART

FM 17514

A 6 OF A 1 6

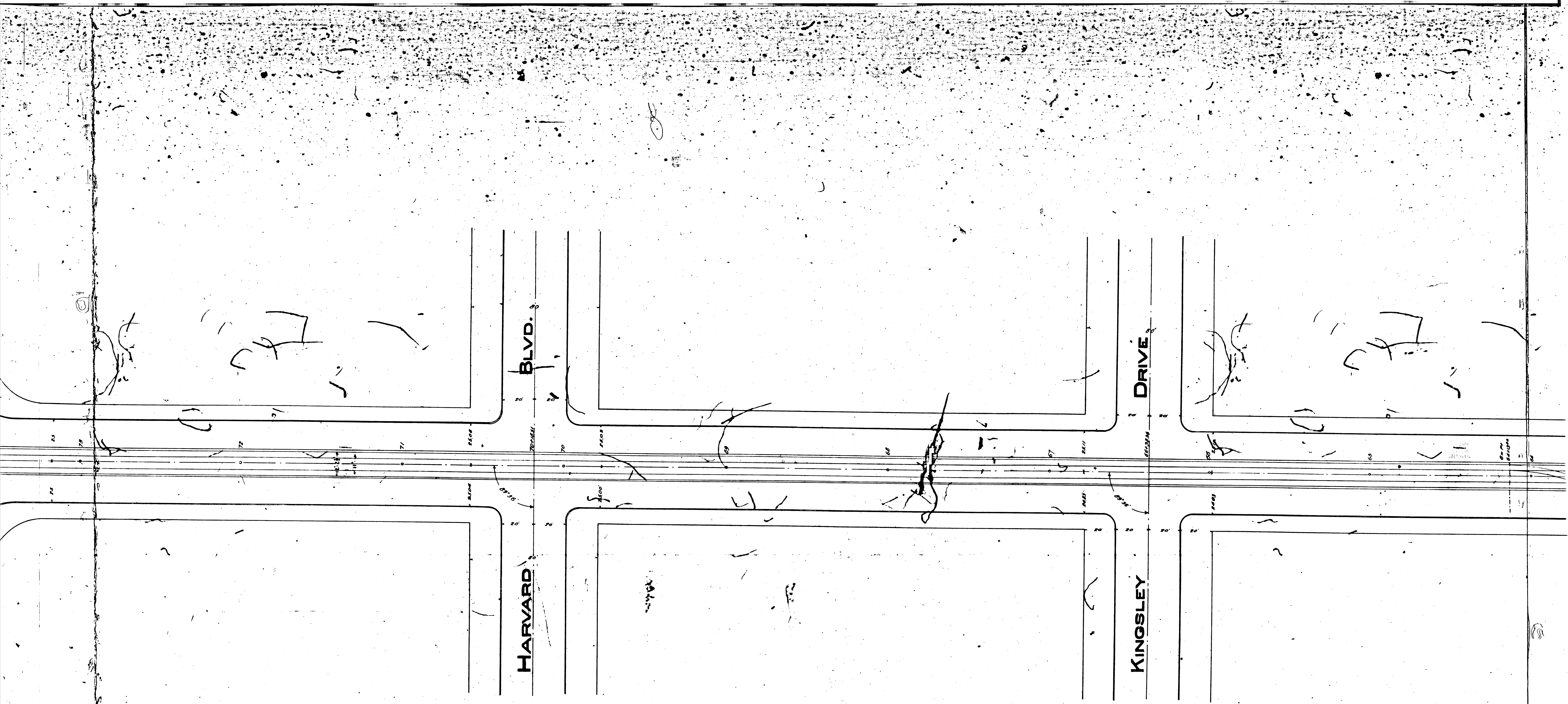

FM 17514
A 7 OF A16

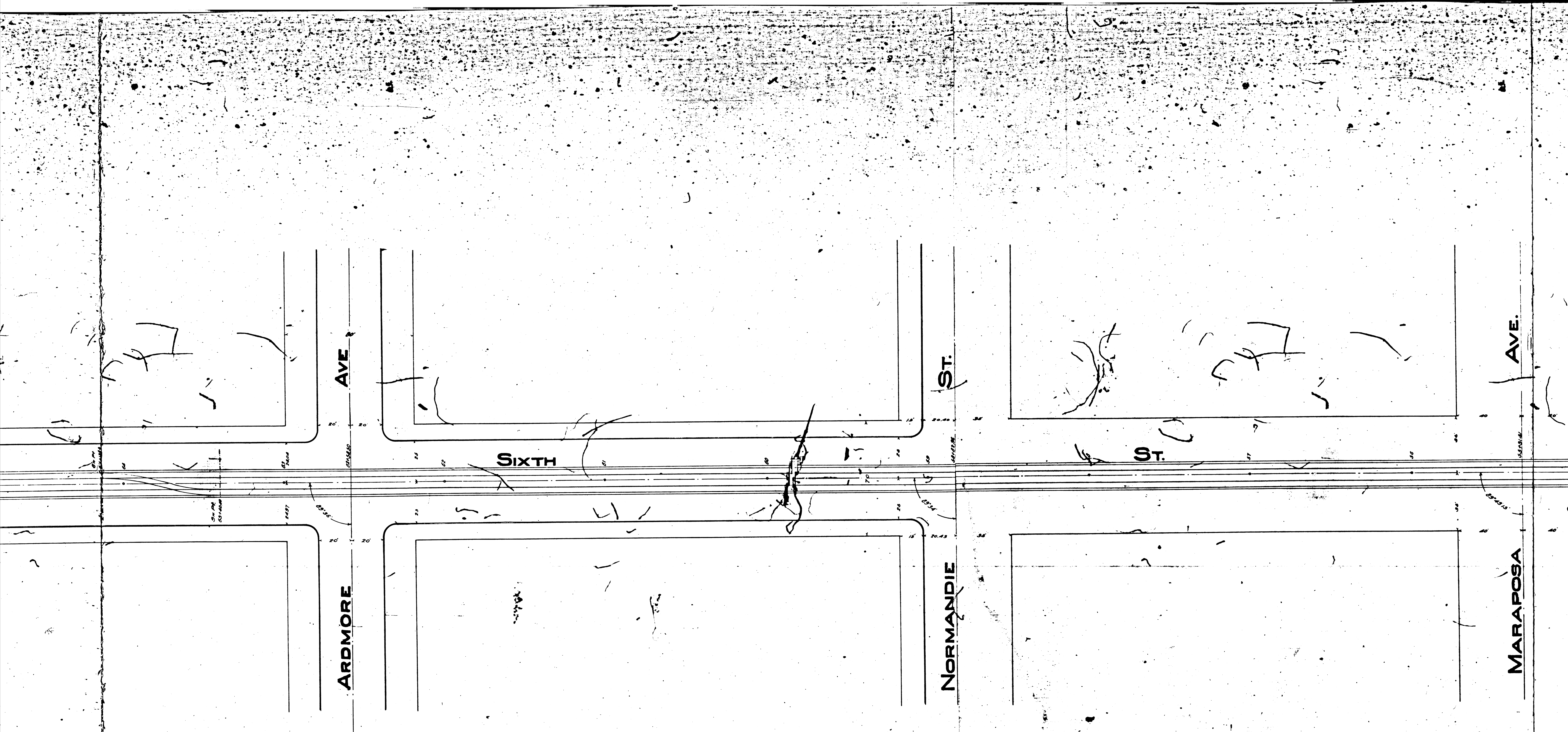

FM 17514
A8 OF A16

MARAPOSA

AVE.

ALEXANDRIA

AVE.

KENMORE

AVE.

FM 17514
A9 OF A16

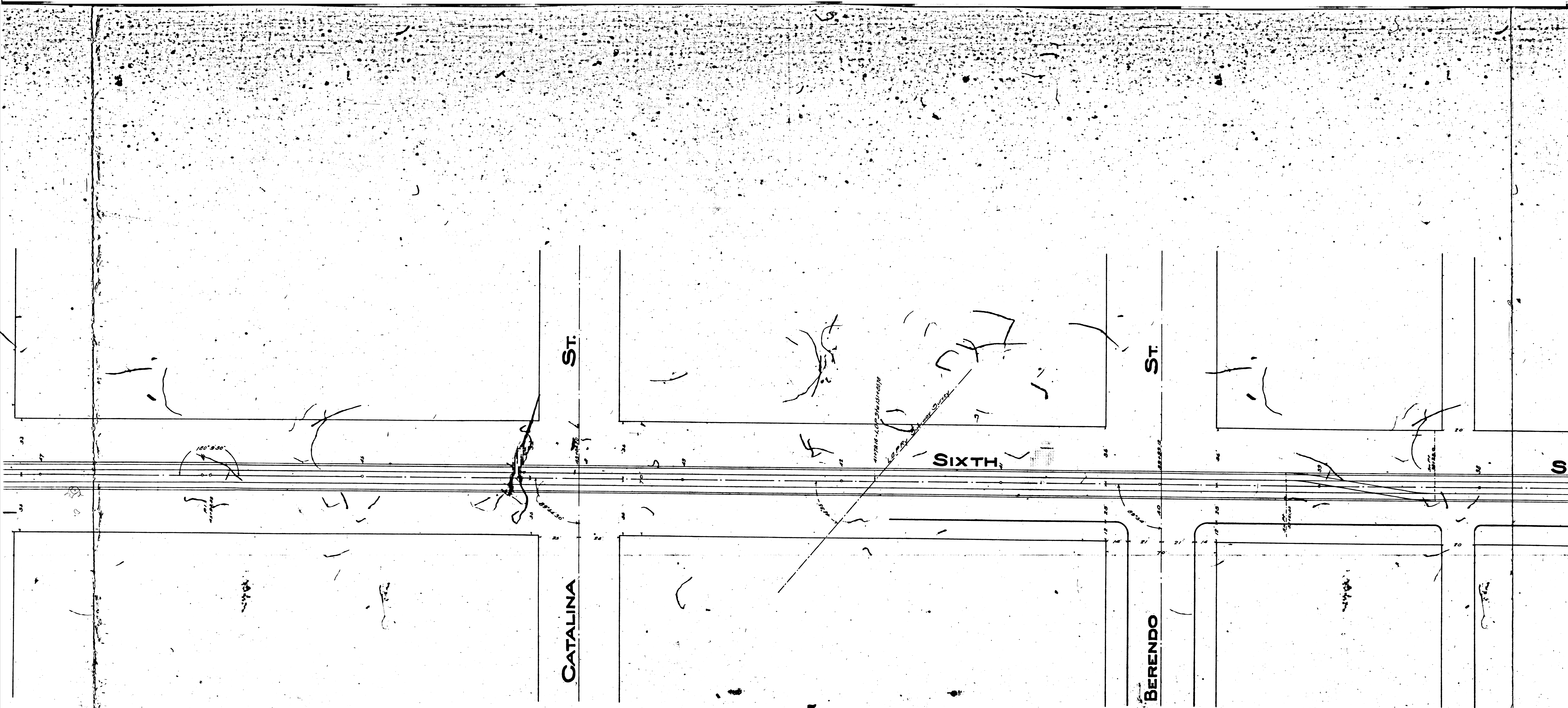

FM 17514
A10 OF A16



F.M. 17514
A 11 OF A 16

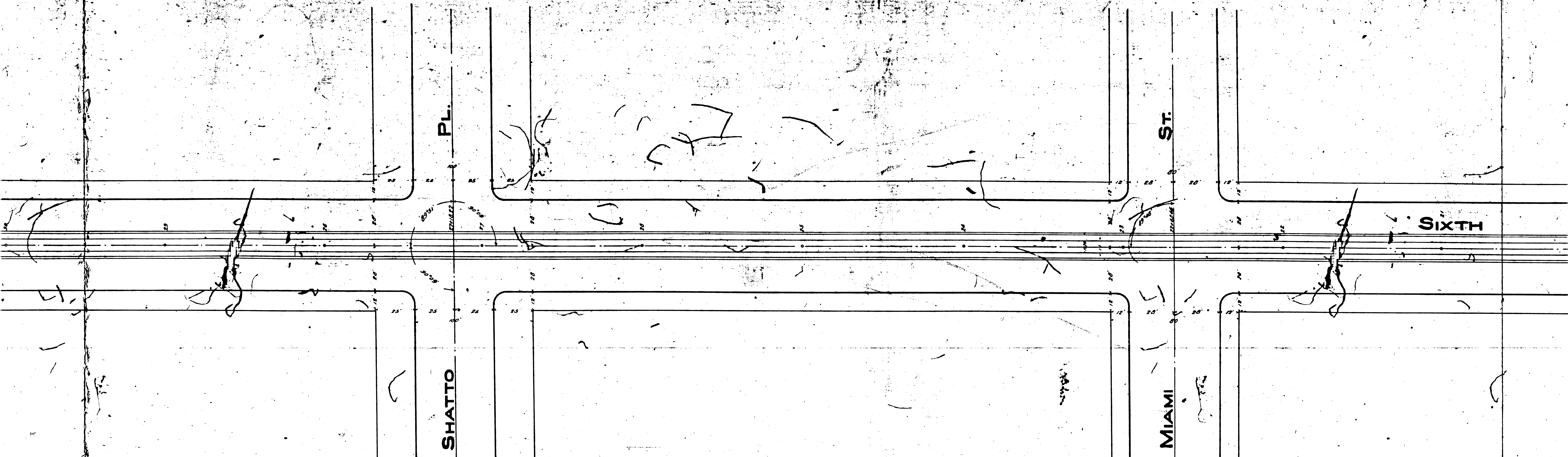

FM 17514
A 12 OF A 16

SIXTH

ST.

AVE.

ST.

VIRGIL

COMMONWEALTH

FM	17514
A13	OF A16



HOVER ST

ANDREWS DIVD.

$\Delta = 28^{\circ} 30'$
 $R = 313.62$ Tan = 81.7

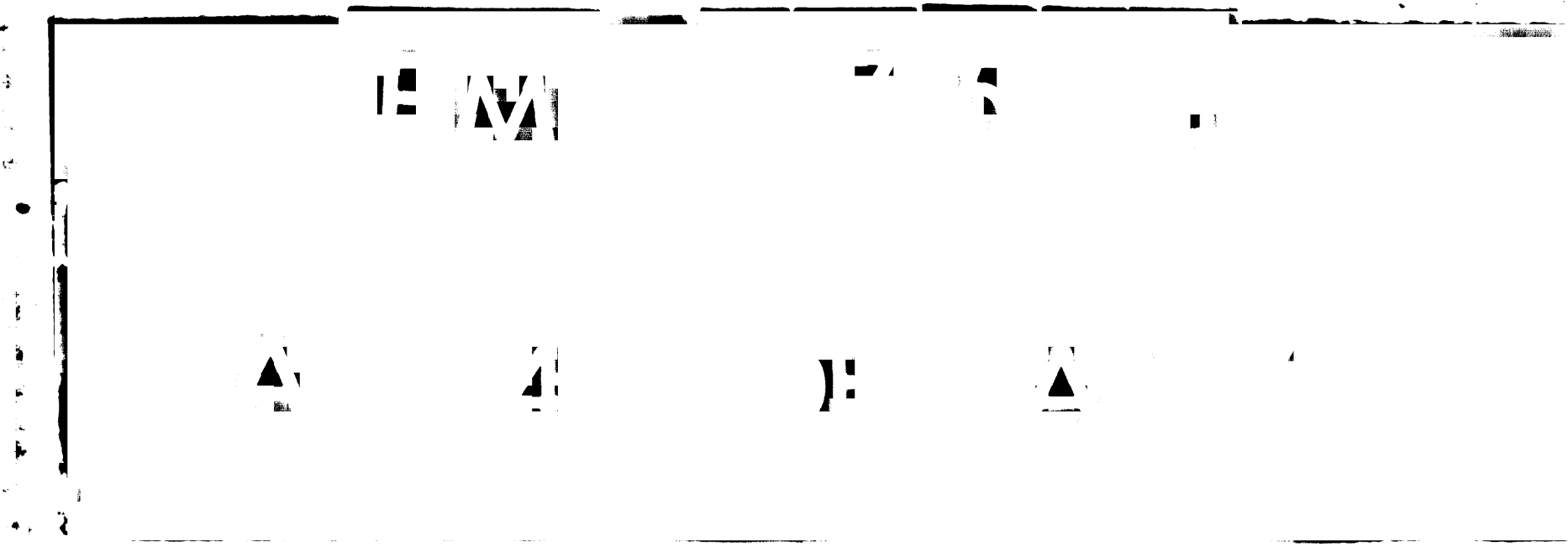

ANDREWS BLVD.

CENTON BLVD.

WILKINSON WAY.

ST.

RAMPART

F/W 11 7 5 11 4

△ 11 5 ○ 11 6 △ 11 6

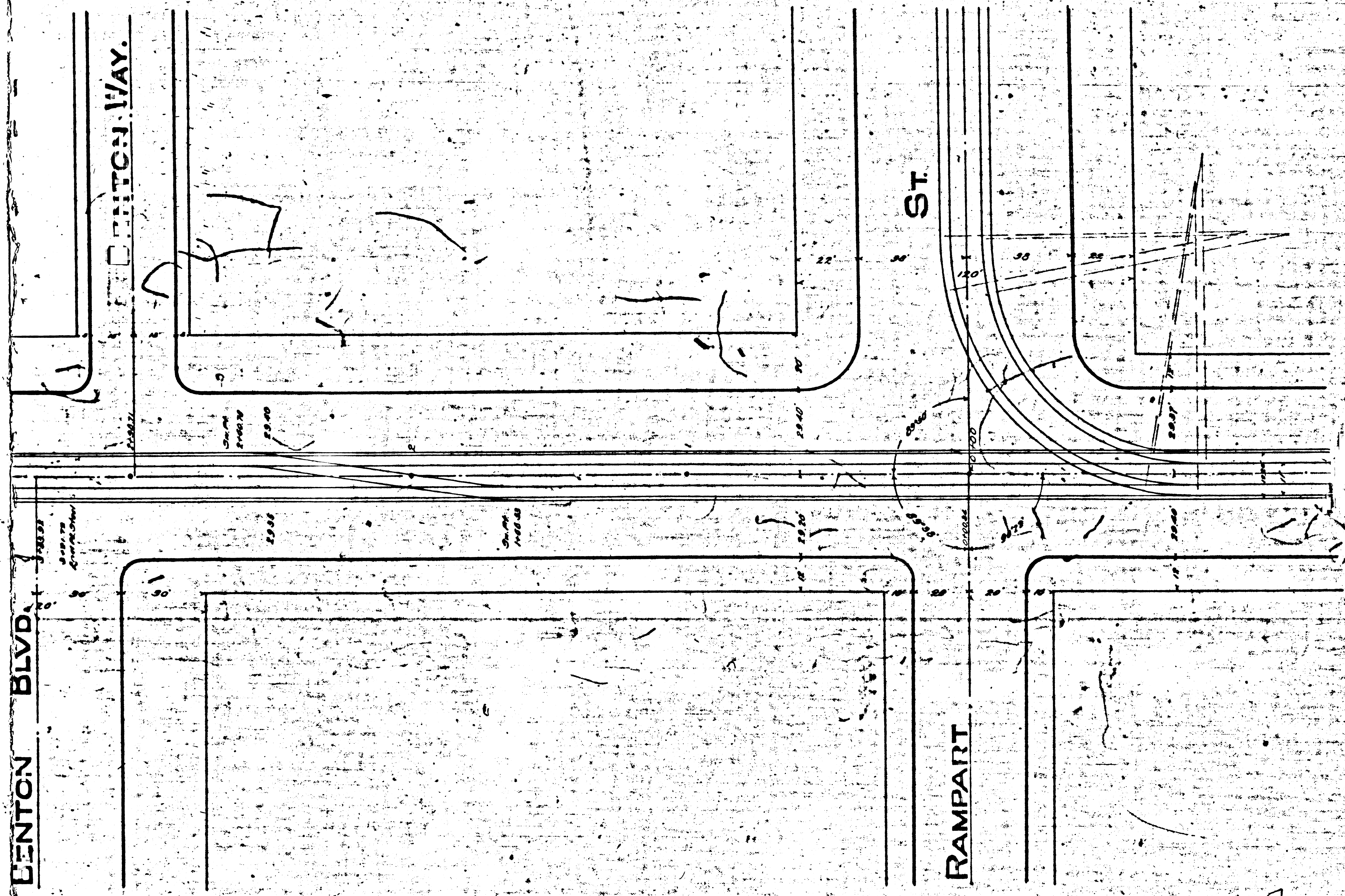

Los Angeles Ry
WEST SIXTH ST. DIV.
 From Rampart St to Fourth St
 Sta 0+00 to Sta 18+26+90
 Scale 1"=30ft
 P.S. 120
 May 17, 1907

F.M. 11 7 5 11 4
 A 11 6 O 11 6