

LOS ANGELES COUNTY HIGHWAY COMMISSION
 DIV. 41
SUNSET BOULEVARD
 AND PROSPECT AVENUE
 FROM STA. 0+00 AT BENEFIT ST. L.A. CITY LIMITS
 TO STA. AT CENTER ST. HOLLYWOOD CITY LIMITS.
 SURVEYED MAY 1909.

Scale 1" = 50'
 Field Work by C.A.S. A.B.K.
 Office F.B. 69
 A.E. LODER
 Chief Engineer

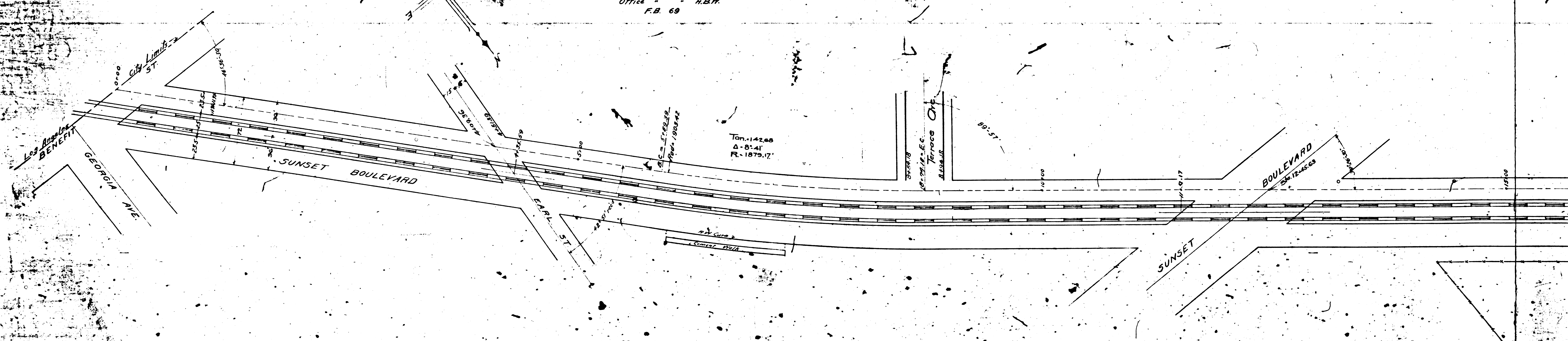

FM 17619
 A1 OF A2

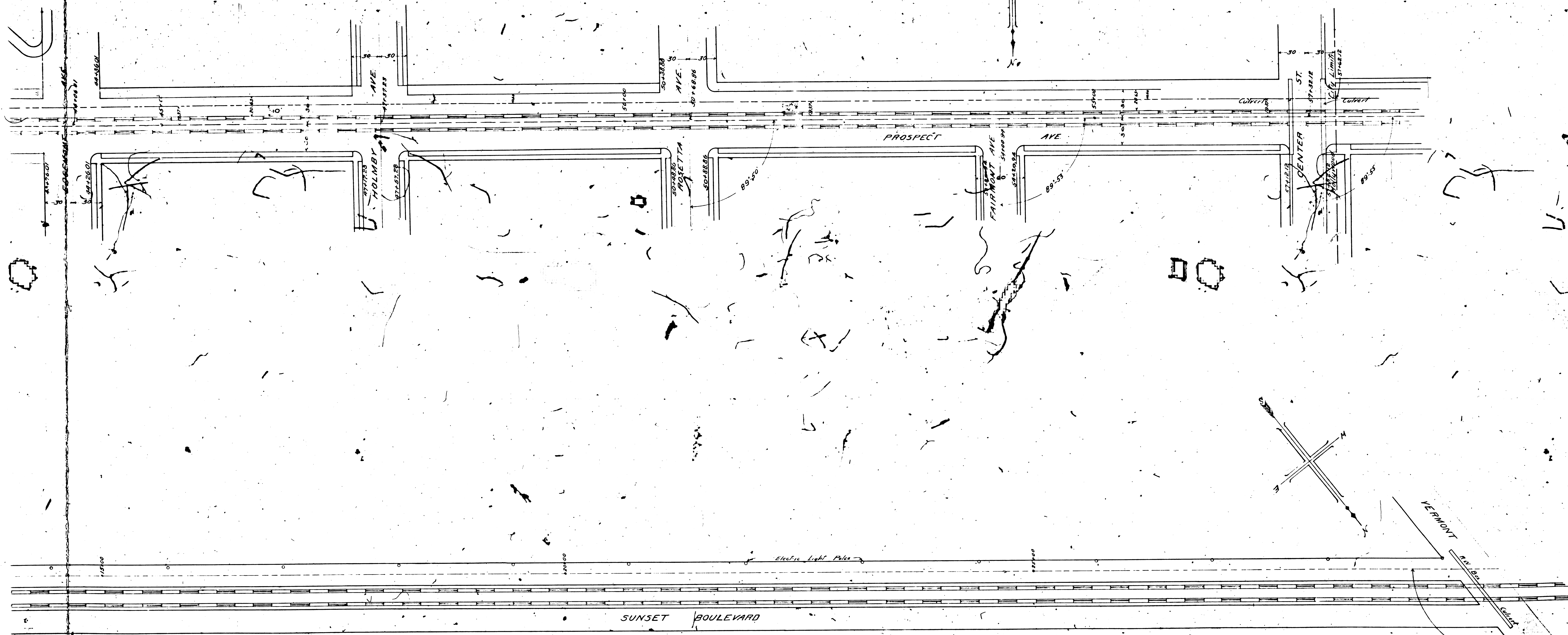

17619
A 2 OF A 2