

085A

085A

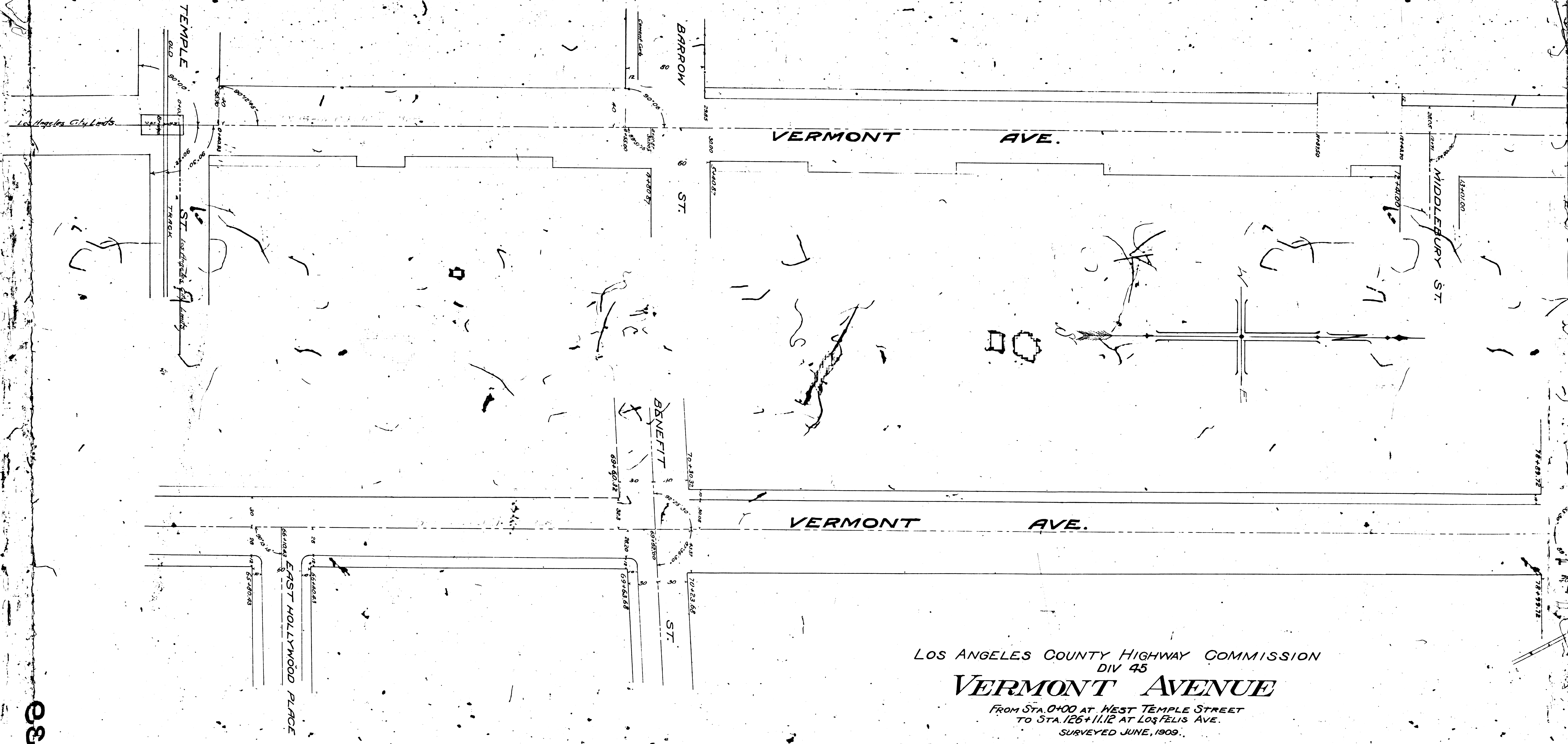

LOS ANGELES COUNTY HIGHWAY COMMISSION  
DIV 45

**VERMONT AVENUE**

FROM STA. 0+00 AT WEST TEMPLE STREET  
TO STA. 126+11.12 AT LOS FELIS AVE.  
SURVEYED JUNE, 1909.

Scale 1" = 50'

Field Work by C.R.S.  
Office A.B.H.  
F.B. N° 49

A.E. LODER  
Chief Engineer

**FILE N° A-239**

PLAN 11 7 6 2 0  
A 11 OF A 5



F/M 11 7 6 20  
A 2 OF A 5

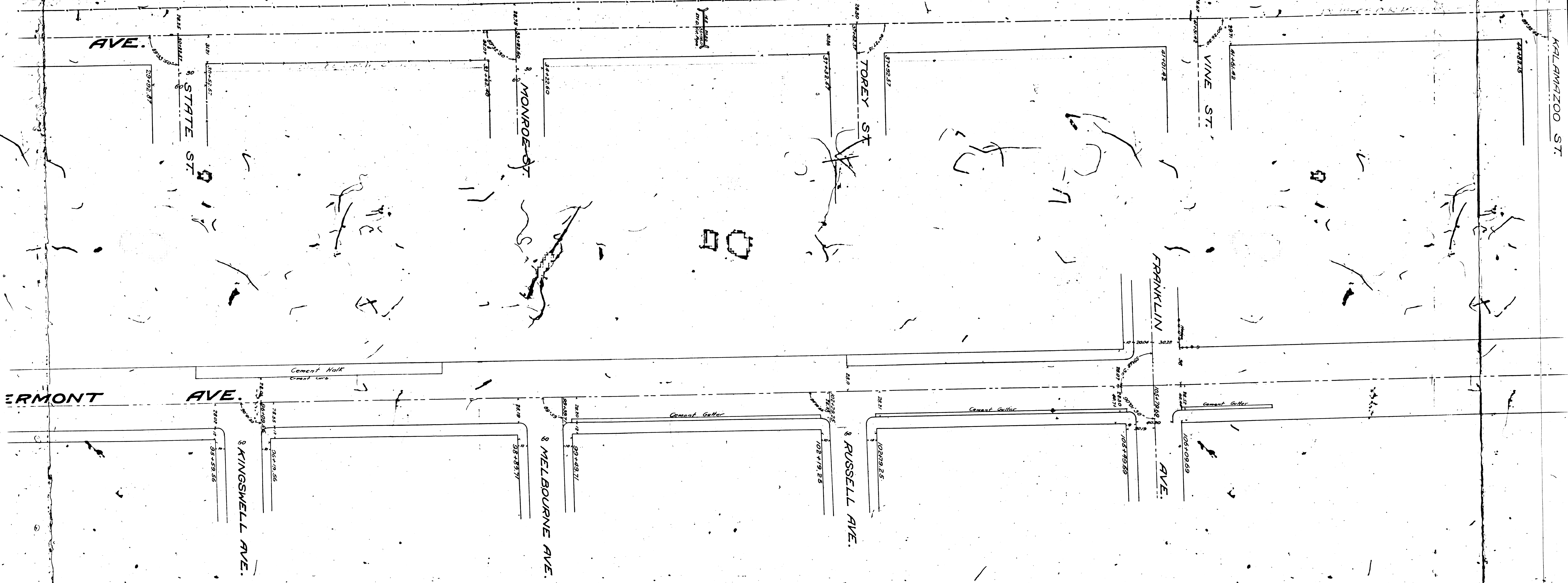

KALAMAZOO ST.

VINE ST.

FRANKLINS

AVE.

RUSSELL AVE.

MELBOURNE AVE.

KINGSWELL AVE.

STATE ST.

AVE.

ERMONT

AVE.

F/M 11 7 6 2 0

A 3 OI A 5



VERMONT AVE.

VERMONT AVE.

WILLOWBROOK AVE.

SANTA MONICA AVE.

VERMONT PLACE

PLEASANT AVES

KALAMAZOO ST.

CANAL ST.

MYRTLE AVE.

GREGORY PLACE

FINLEY AVE.

PLAN 117620  
A 4 OF A 5

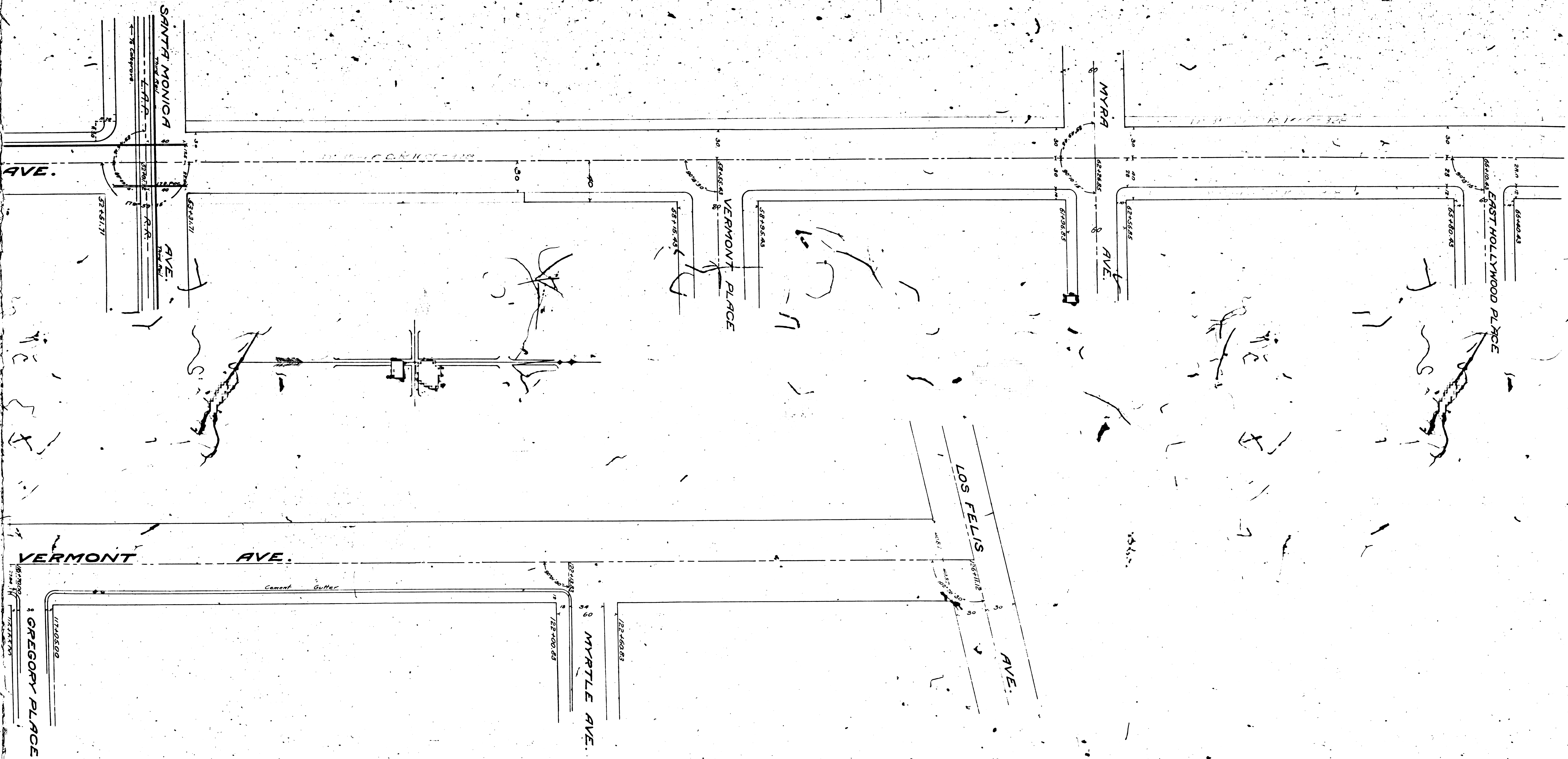

F/M 17620

AS OF AS