

LOS ANGELES COUNTY HIGHWAY COMMISSION
DIVISION 12
COMPTON AVENUE
FROM STA. 0+00 AT SHORB AVENUE
TO STA. 158+7304 AT CENTRAL AVE.
Surveyed June 1909.

Sheet 7

FIELD WORK BY C.A.S.
OFFICE "A.B.W."

Scale 1"=50'

R. E. LODER
Chief Engineer.

F.B. 73.

F/M 17630
A 1 0 F A 5

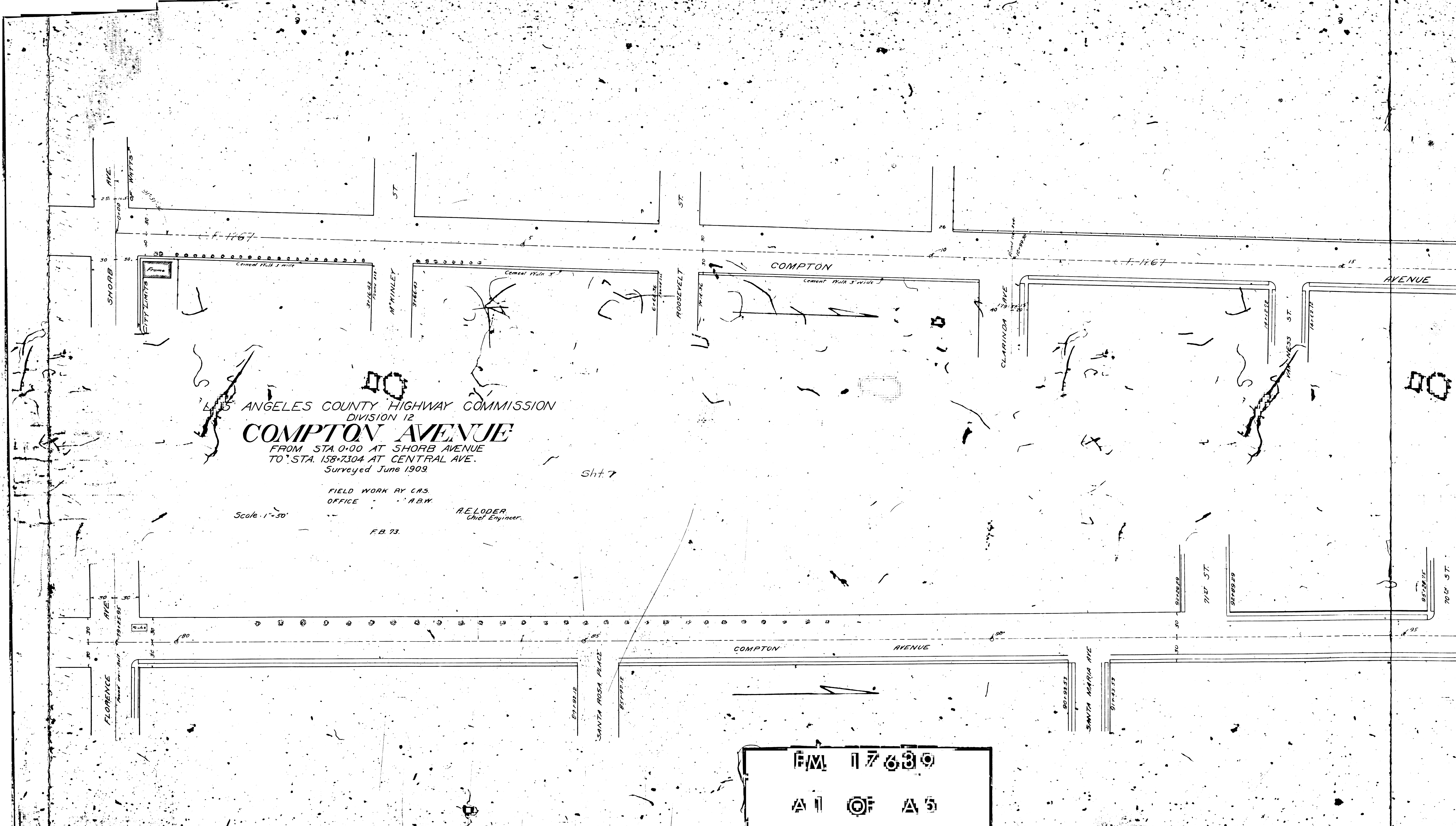



F/M 17689
A 2 OF A 5



F.M. 117639
A 3 OF A 5

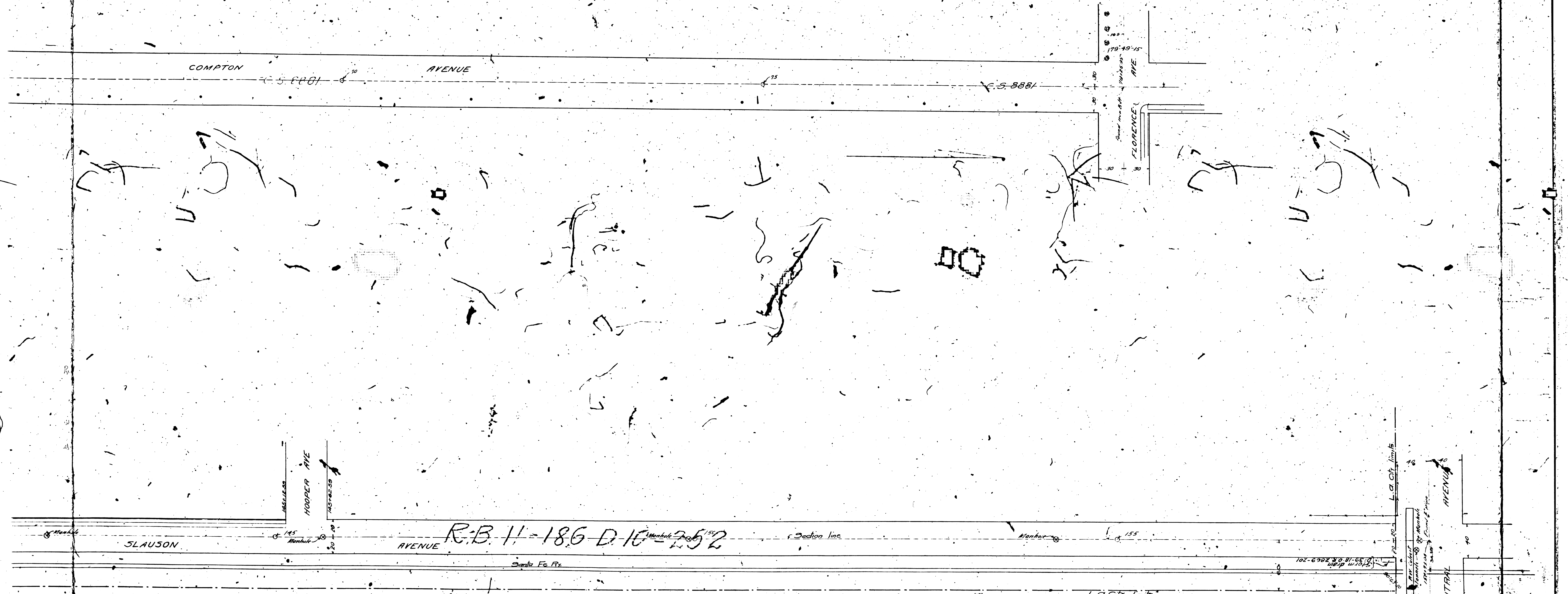

F.M. 17689
A 5 OF A 5