

LOS ANGELES COUNTY HIGHWAY COMMISSION  
DIVISION 13

**FLORENCE AVENUE**  
FROM COMPTON AVE. TO LONG BEACH BLVD.

SURVEYED NOV. 1909

FIELD WORK BY CRS.

OFFICE H.C.H.

FIELD BOOK No 91

A.E. LODER

CHIEF ENGINEER

SCALE 1"=50'

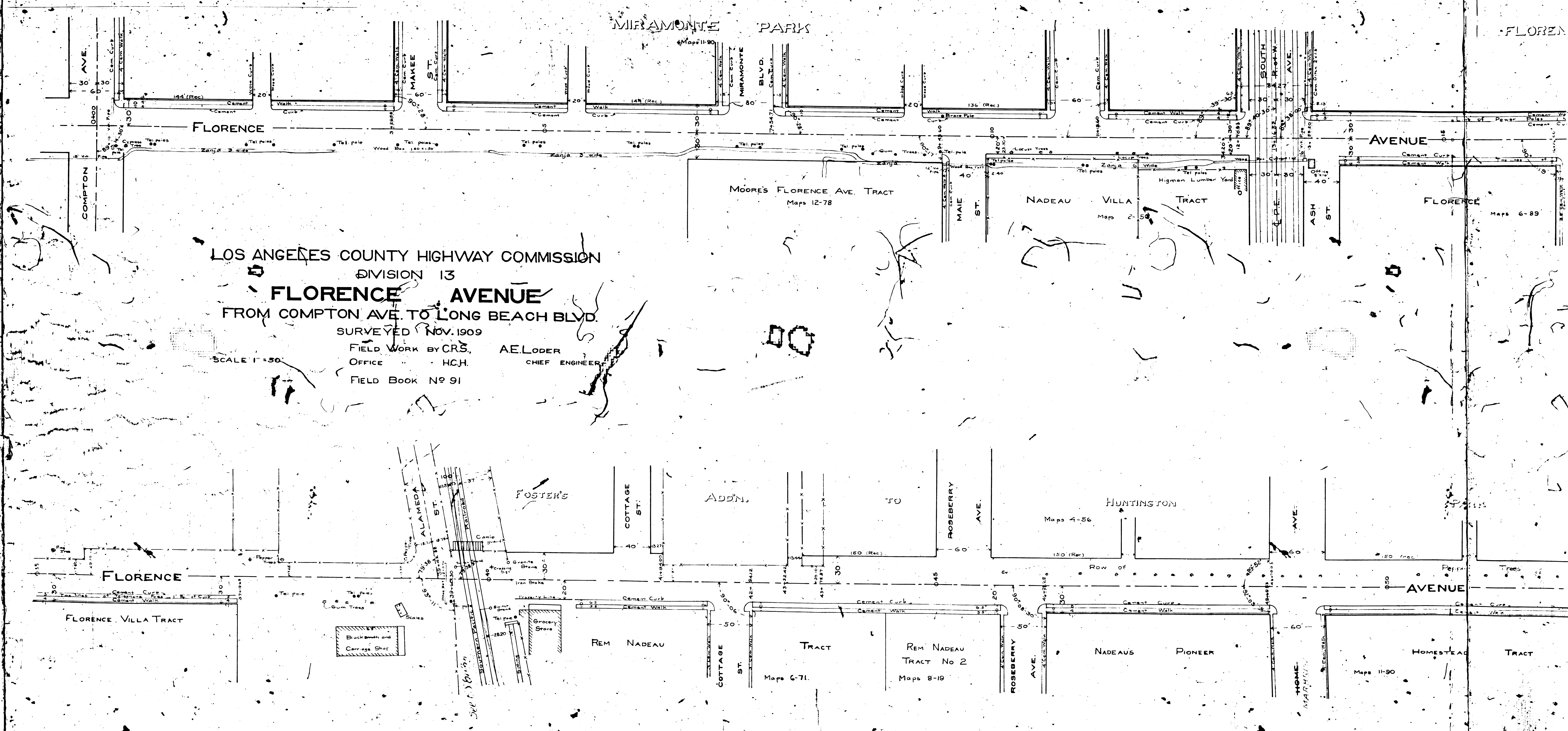

F.M. 17641

A 1 OF A 3





**F M 17641**

**A2**      **Ⓞ**      **A3**



