

LOS ANGELES COUNTY HIGHWAY COMMISSION
Div. No. 17, Sec. 3

VALLEY ROAD

FROM STA. 397+00 TO STA. 424+33.80 STA. 0+00
AND FROM STA. 0+00 TO STA. 70+49.04 CRAWFORD ST. - DOWNEY.

F.B. 101

Surveyed by C.A.S. Jan. 1910.
Platted by T.V.H. April 1910.
Traced by T.V.H. April 1910.

Approved Nov. 26, 1910.

A. E. ...
Chief Engineer

Scale: 1"=50'

FILE NO. A-314

For streets and public highways...

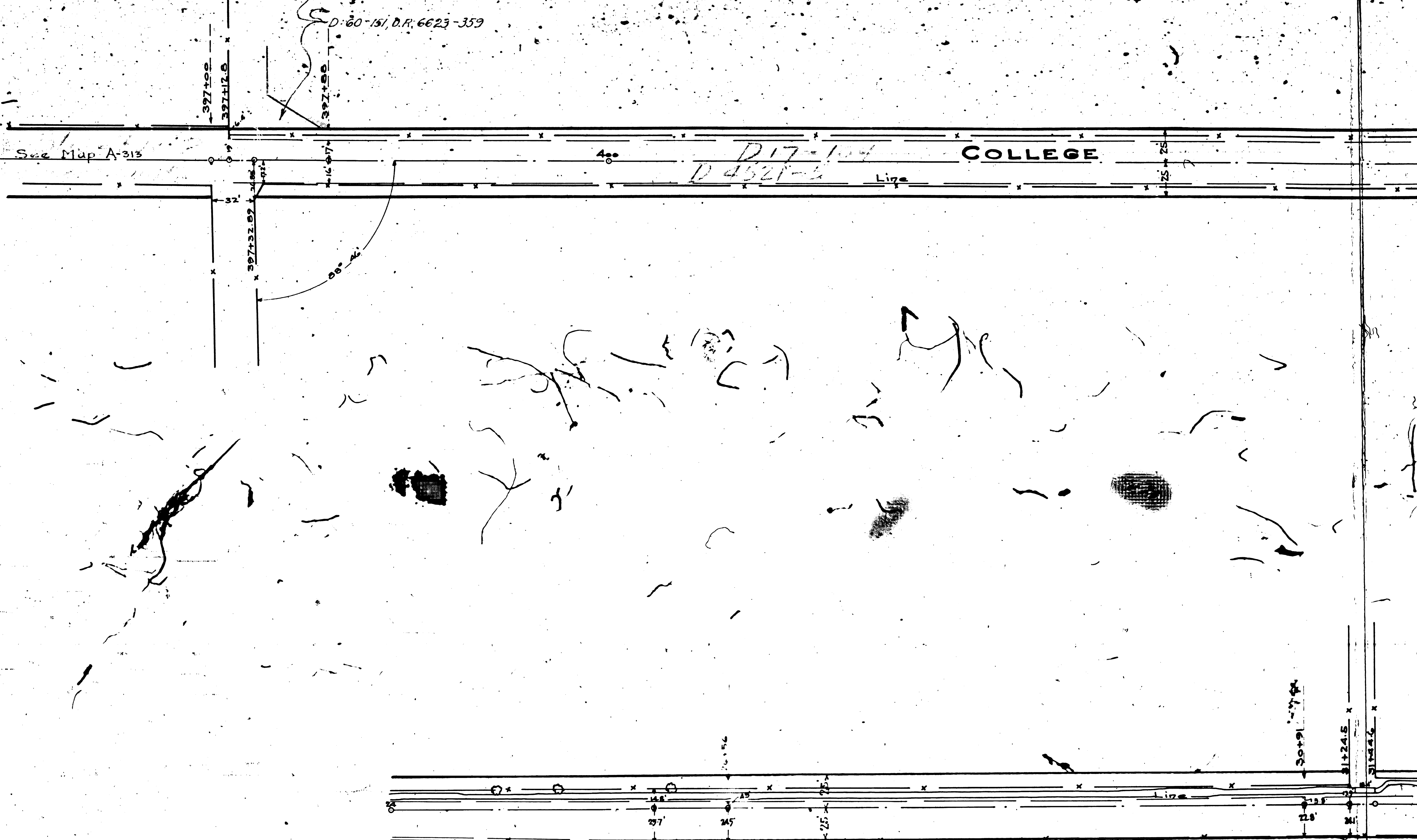

F.M. 117676-3
A1 OF A4



Void - See Map: A-370

COLLEGE

POLE AVENUE

F.M. 17676-3
A 2 OF A 4



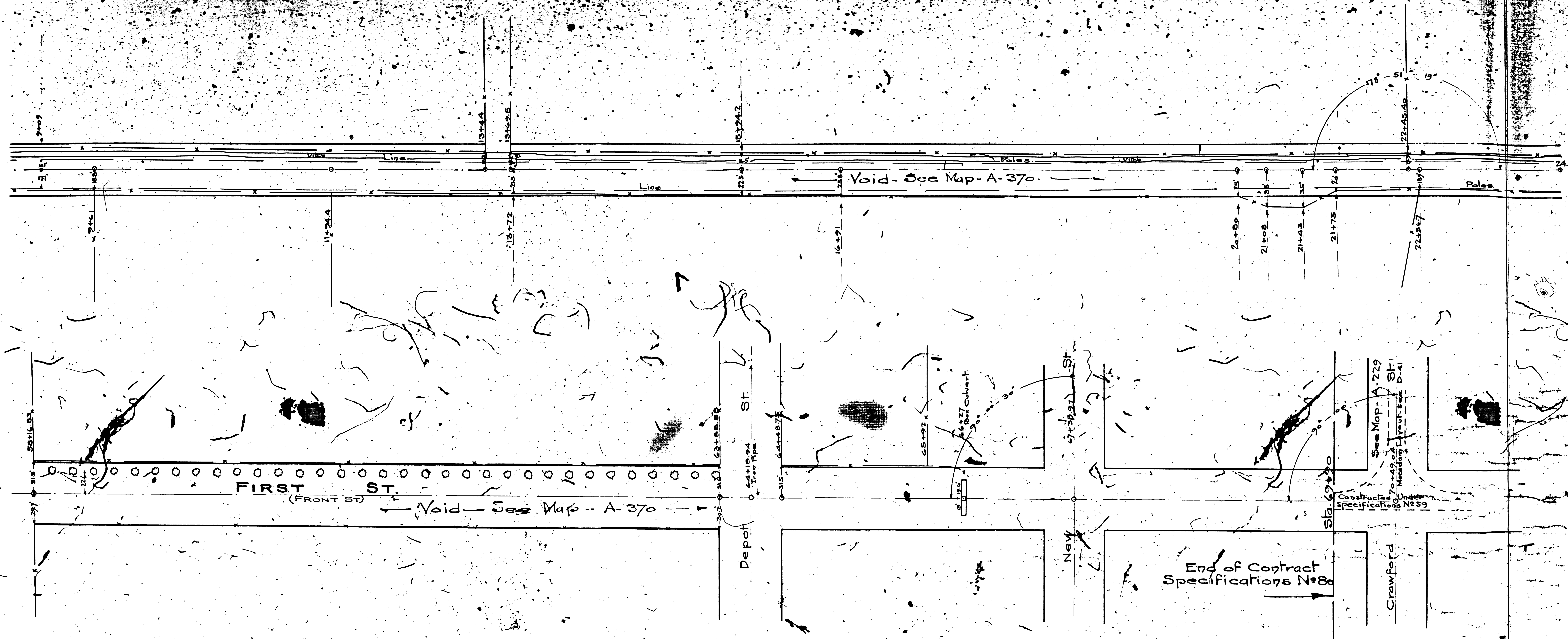

FM 17676-3
 A4 OF A4