

ALIGNMENT  
RIGHT OF WAY PLAN  
DOMINGUEZ - TORRANCE  
PROPOSED S.P.R.R. CO. SPUR TRACK  
Los Angeles, Cal. FEB. 1912. Scale 1" = 400'  
Notes: Partly from A.M. 1000  
and A.M. 1001

□	△	○	○	○
△	○	○	○	○

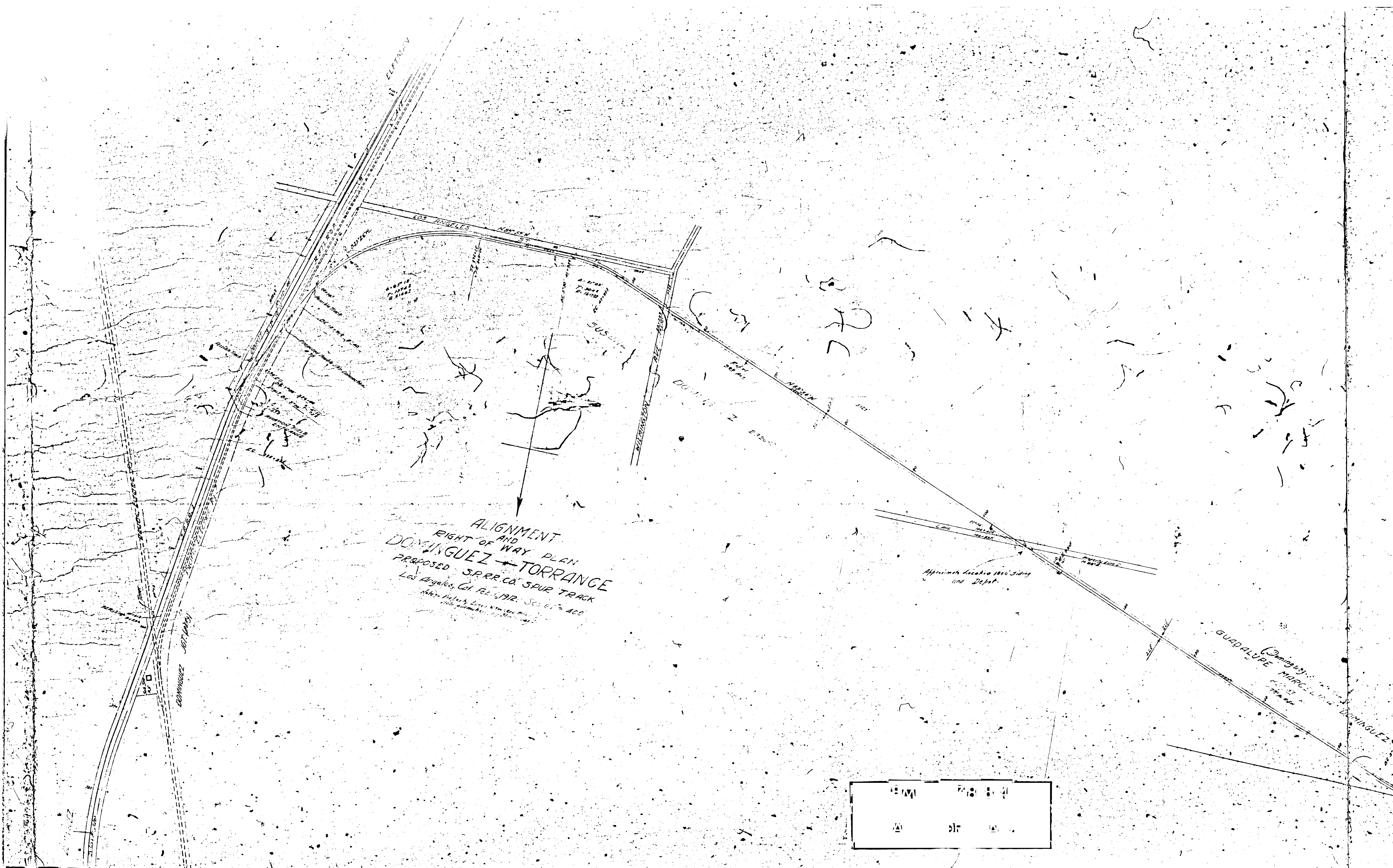

FM 17884  
A 2 OF A 2



TORRANCE  
INDUSTRIAL CITY

LAND CO.

VICTORIA D. DE CARSON  
500' ft.

WIGGER

SLOUGH

DOMINGUEZ

SUSANA

DOMINGUEZ  
370 B

DOMINGUEZ  
3212 ft.

(Dominguez Estak Co.)  
Minimum Section of  
300' Spur Road

GUADALUPE MARCELINO

DOMINGUEZ  
MARC LINA DOMINGUEZ

Easton Park Road

Humboldt

17884

6