

CERTIFICATION  
I, Donald B. Davidson, Reg. Civil Eng. No. 7663,  
certify that these plats were completed under  
my direction and that all monuments shown on  
these plats actually exist and their positions  
are shown correctly.  
June 8, 1964 *Donald B. Davidson*  
Civil Engineer, State Lands Div.

F.M. 20286 1- OF 2

NOTE  
Bearings, distances and coordinates shown on this  
plat conform with the "California Coordinate System  
Zone 7."  
Distances computed from a comparison of the co-  
ordinates of two points and distances shown upon the  
plats are grid distances. The corresponding geodetic  
distance is obtained by multiplying the grid distance by  
1.000038.  
The Mean High Tide Line-1962 is delineated at  
an elevation of 1.30 feet above Sea-level datum of 1929  
of the U.S. Coast and Geodetic Survey, upon this datum  
U.S.C. & G.S. B.M. Y 614 is at an elevation of 27.385  
feet (1960)  
PRC - Refers to "California Public Resources Code"  
Leases

Approved *24 June 1964*  
STATE LANDS COMMISSION  
by *S. H. Curtis*  
Executive Officer

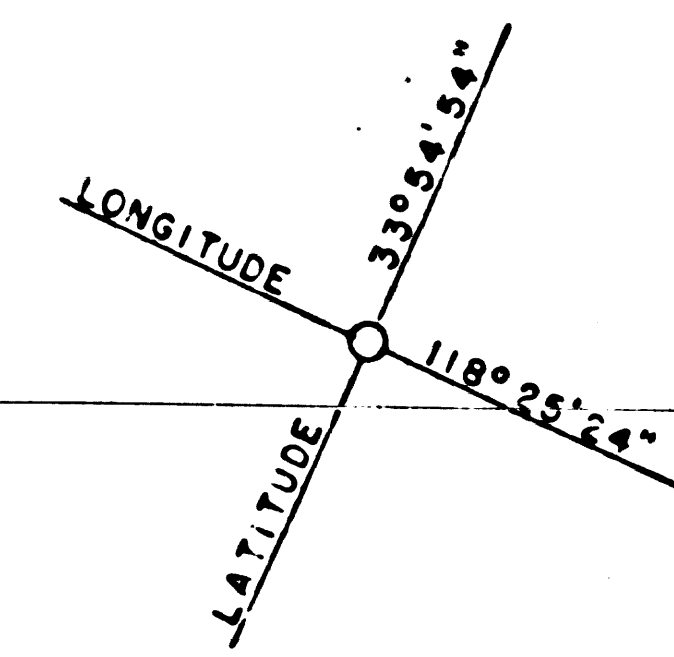

ORDINARY HIGH WATER MARK 1935

STA.	BEARING	COURSES DISTANCE	COORDINATES (7)	
			X	Y
1	S 22°45' 00"E	47.87'	4,158,073.49	4,081,962.15
2	S 28°30' 40"E	184.36'	,092	,918
3	S 20°42' 10"E	1,278.56'	,180	4,081,756
4	S 23°45' 14"E	476.86'	,632	4,080,560
5	S 23°45' 14"E	972.96'	4,158,824.08	4,080,123.54
6	S 21°54' 19"E	511.96'	4,159,216	4,079,233
7	S 21°54' 19"E	511.96'	4,159,407	4,078,758

MONUMENTS

Fd. "VII" L.A. City Hex. bolt in well	4,158,380.16	4,081,962.82
Fd. "N.A. RESET" Std. Oil Co. 2" capped pipe	4,158,301.17	4,081,962.39
Fd. Sta. "O+00" L.A.C. B.H. Curv. B.C. Mon.	4,158,353.91	4,081,839.41
Fd. "P.O. I 0+00-51" Std. Oil Co. Copper nail in pipe	4,158,988.44	4,080,364.16
Fd. "V J11B" L.A. City Hex. bolt 6" below surface	4,153,159.89	4,080,382.79
Fd. "A2" Cross on B.C. Mon.	4,159,632.84	4,079,788.13
Fd. "A3" Cross on B.C. Mon.	4,159,015.36	4,079,788.11
Fd. "A4" 5" off Edison Prop. Line B.C. on 2" pipe	4,158,882.53	4,080,143.23
Fd. "A6" 5" off Edison Prop. Line B.C. Mon.	4,159,247.58	4,080,301.34

MAP OF THE  
ORDINARY HIGH WATER MARK  
ALONG THE SHORE OF SANTA MONICA BAY  
VICINITY OF EL SEGUNDO  
LOS ANGELES COUNTY, CALIFORNIA

SCALE 1 INCH = 200 FEET  
SHEET 1 OF 2 MARCH, 1962  
J.E. DONER, CIVIL ENG. TECHNICIAN F.D. UZES, ASSISTANT CIVIL ENG.  
C.D. ROBERTSON ASSOCIATE CIVIL ENG.

STATE OF CALIFORNIA  
STATE LANDS COMMISSION STATE LANDS DIVISION  
PREPARED UNDER W.O. 5089

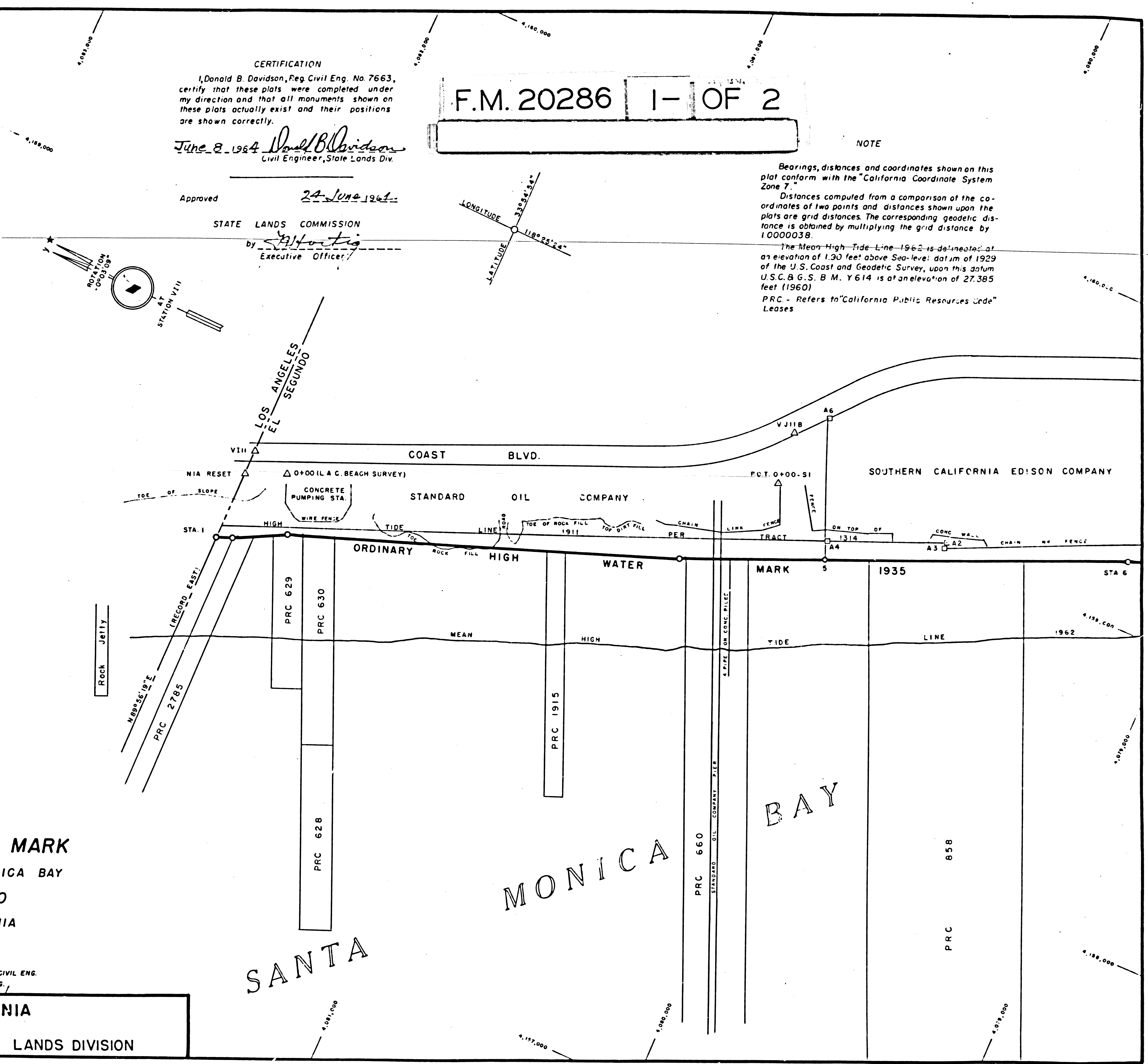

**NOTE**

Bearings, distances and coordinates shown on this plat conform with the "California Coordinate System Zone 7."

Distances computed from a comparison of the coordinates of two points and distances shown upon the plats are grid distances. The corresponding geodetic distance is obtained by multiplying the grid distance by 1.0000030.

The Mean High Tide Line 1962 is delineated at an elevation of 1.90 feet above Sea-level datum of 1929 of the U.S. Coast and Geodetic Survey, upon this datum U.S.C. & G.S. B.M. Y 614 is at an elevation of 27.385 feet (1960)

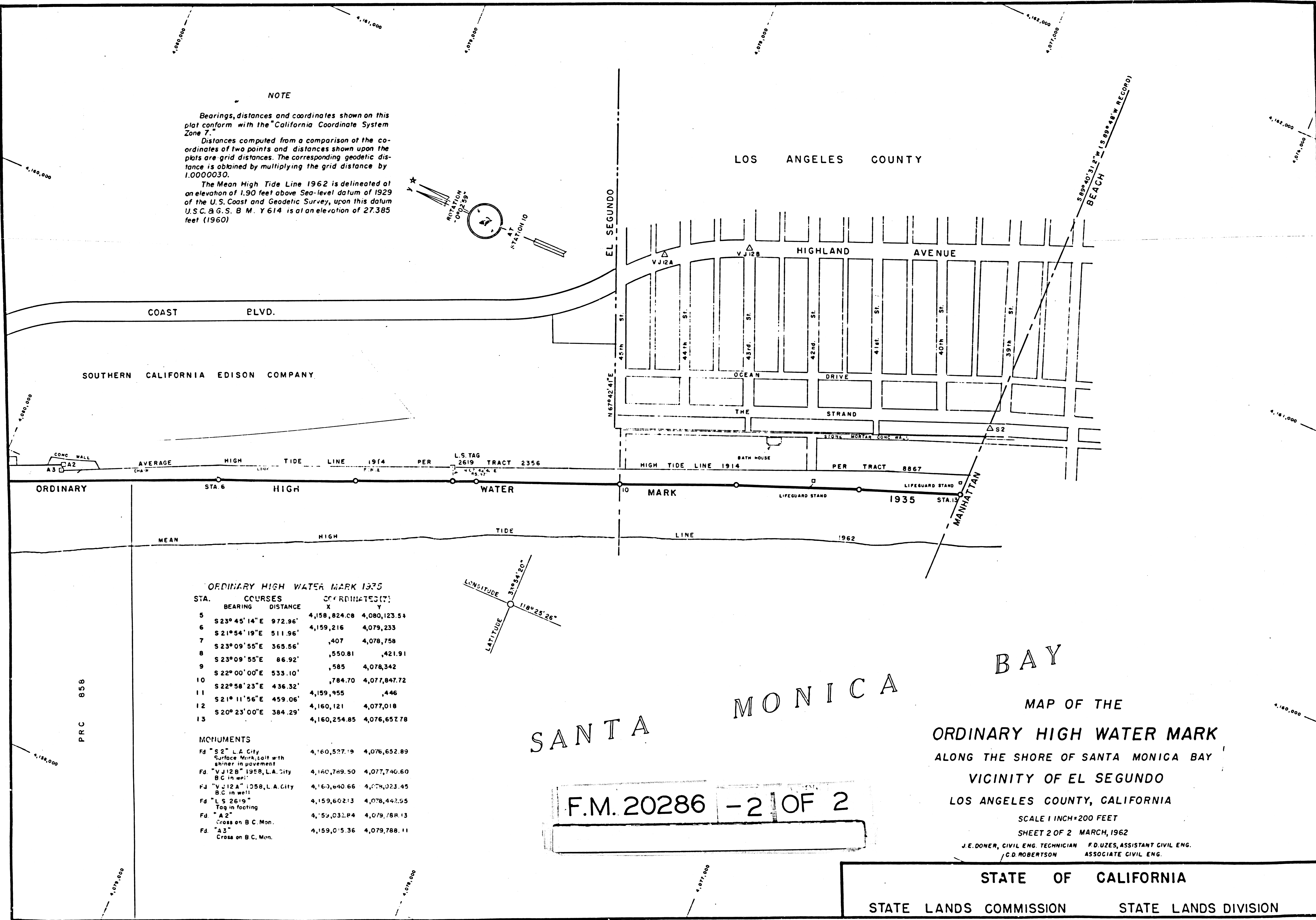
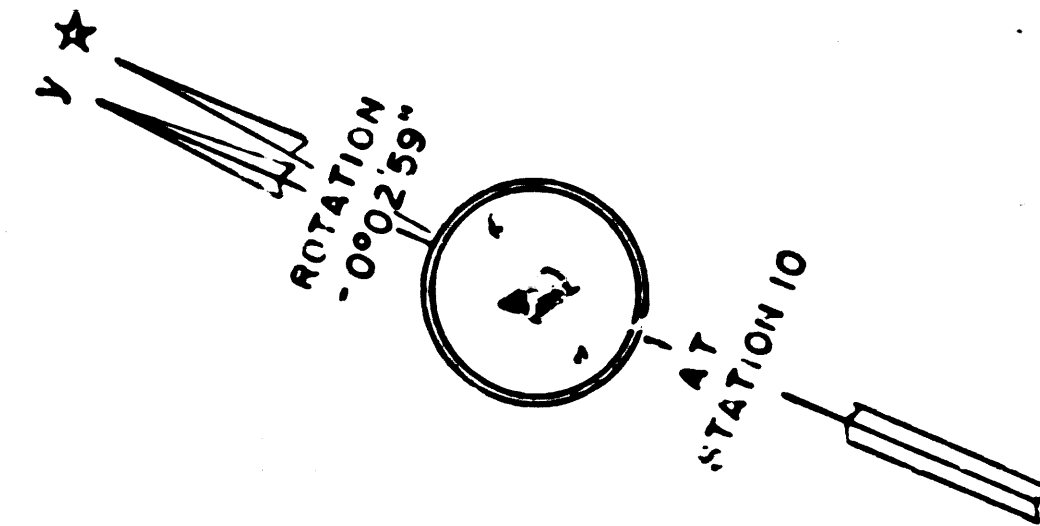

**ORDINARY HIGH WATER MARK 1935**

STA.	BEARING	DISTANCE	COORDINATES (7)
			X Y
5	S 23° 45' 14" E	972.96'	4,158,824.08 4,080,123.54
6	S 21° 54' 19" E	511.96'	4,159,216 4,079,233
7	S 23° 09' 55" E	365.56'	,407 4,078,758
8	S 23° 09' 55" E	86.92'	,550.81 ,421.91
9	S 22° 00' 00" E	533.10'	,585 4,078,342
10	S 22° 58' 23" E	436.32'	,784.70 4,077,847.72
11	S 21° 11' 56" E	459.06'	4,159,955 ,446
12	S 20° 23' 00" E	384.29'	4,160,121 4,077,018
13			4,160,254.85 4,076,657.78

**MONUMENTS**

Fd "S 2" L.A. City Surface Mark, bolt with shiner in pavement	4,160,527.19	4,076,652.89
Fd "V J 12 B" 1958, L.A. City B.C. in well	4,160,789.50	4,077,740.60
Fd "V J 12 A" 1958, L.A. City B.C. in well	4,160,040.66	4,077,023.45
Fd "L S 2619" Tag in footing	4,159,602.13	4,078,442.55
Fd "A 2" Cross on B.C. Mon.	4,159,032.84	4,079,788.13
Fd "A 3" Cross on B.C. Mon.	4,159,015.36	4,079,788.11

SANTA MONICA BAY

F.M. 20286 - 2 OF 2

MAP OF THE  
ORDINARY HIGH WATER MARK  
ALONG THE SHORE OF SANTA MONICA BAY  
VICINITY OF EL SEGUNDO  
LOS ANGELES COUNTY, CALIFORNIA

SCALE 1 INCH = 200 FEET  
SHEET 2 OF 2 MARCH, 1962  
J.E. DOWER, CIVIL ENG. TECHNICIAN F.D. UZES, ASSISTANT CIVIL ENG.  
C.D. ROBERTSON ASSOCIATE CIVIL ENG.

STATE OF CALIFORNIA  
STATE LANDS COMMISSION STATE LANDS DIVISION