

For Right of Way Information Not Shown, See Right Of Way Maps On File In The District Office.

POST MILE	COUNTY	ROUTE	POST MILE - TOTAL PROJECT	SHEET	TOTAL SHEETS
7	LA	10	R. 8.83-14.25	16	21

CITY OF LOS ANGELES

STATE OF CALIFORNIA
HIGHWAY TRANSPORTATION AGENCY
DEPARTMENT OF PUBLIC WORKS
DIVISION OF HIGHWAYS
MONUMENTATION MAP
No. MF-2076-1

W. Bernie
Deputy District Engineer

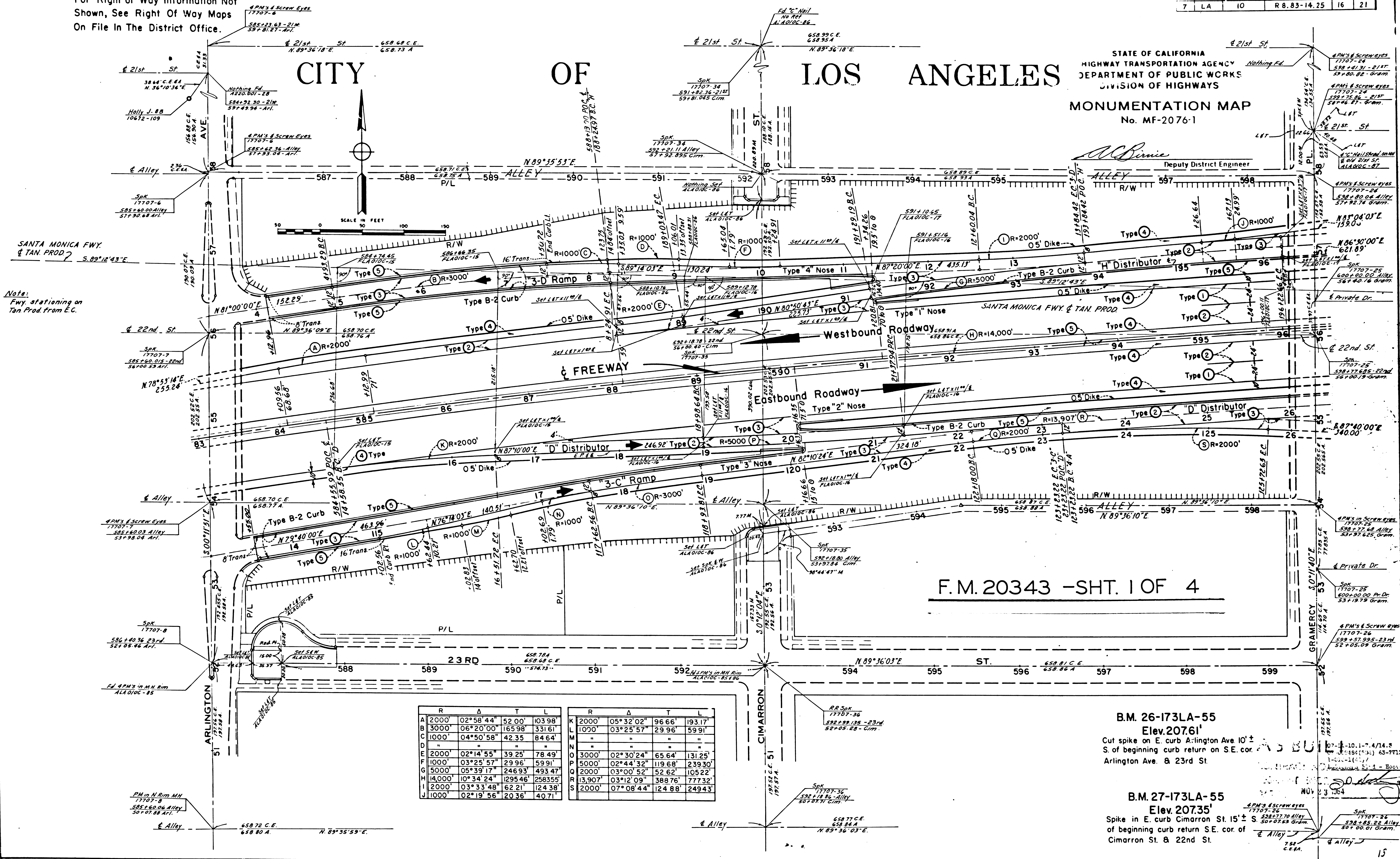

Note:
Fwy stationing on Tan Prod from E.C.

F.M. 20343 - SHT. 1 OF 4

R	Δ	T	L	R	Δ	T	L		
A	2000	02°58'44"	52.00	103.98	K	2000	05°32'02"	96.66	193.17
B	3000	06°20'00"	165.98	331.61	L	1000	03°25'57"	29.96	59.91
C	1000	04°50'58"	42.35	84.64	M	"	"	"	"
D	"	"	"	"	N	"	"	"	"
E	2000	02°14'55"	39.25	78.49	O	3000	02°30'24"	65.64	131.25
F	1000	03°25'57"	29.96	59.91	P	5000	02°44'32"	119.68	239.30
G	5000	05°39'17"	246.93	493.47	Q	2000	03°00'52"	52.62	105.22
H	1000	07°34'24"	293.46	586.95	R	13,907	03°12'09"	388.76	777.32
I	2000	03°33'48"	62.21	124.38	S	2000	07°08'44"	124.88	249.43
J	1000	02°19'56"	20.36	40.71					

B.M. 26-173LA-55
Elev. 207.61'
Cut spike on E. curb Arlington Ave 10' ±
S. of beginning curb return on SE. cor.
Arlington Ave. & 23rd St.

B.M. 27-173LA-55
Elev. 207.35'
Spike in E. curb Cimarron St. 15' ± S.
of beginning curb return SE. cor. of
Cimarron St. & 22nd St.

For Right Of Way Information Not Shown, See Right Of Way Maps On File In The District Office.

CITY

OF

LOS

ANGELES

DIST.	COUNTY	ROUTE	POST MILES - TOTAL PROJECT	SHEET	TOTAL SHEETS
7	LA	10	R8.83-14.25	18	21

STATE OF CALIFORNIA
HIGHWAY TRANSPORTATION AGENCY
DEPARTMENT OF PUBLIC WORKS
DIVISION OF HIGHWAYS
MONUMENTATION MAP
No. MF-2076-3

RET Jellebach
Deputy District Engineer

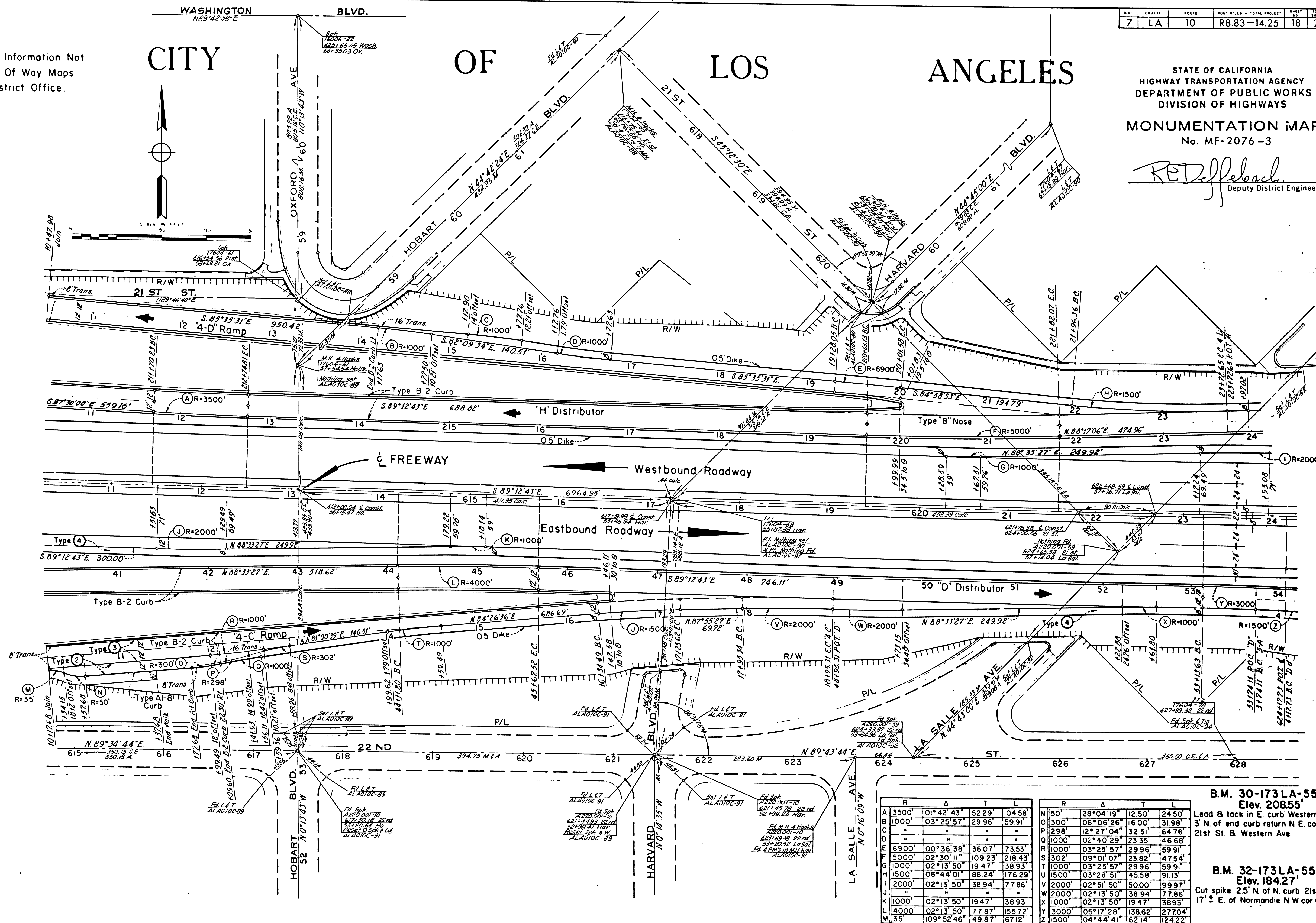

	R	Δ	T	L
A	3500'	01°42'43"	52.29'	104.58'
B	1000'	03°25'57"	29.96'	59.91'
C	"	"	"	"
D	"	"	"	"
E	6900'	00°36'38"	36.07'	73.53'
F	5000'	02°30'11"	109.23'	218.43'
G	1000'	02°13'50"	19.47'	38.93'
H	1500'	06°44'01"	88.24'	176.29'
I	2000'	02°13'50"	38.94'	77.86'
J	1000'	02°13'50"	19.47'	38.93'
K	4000'	02°13'50"	77.87'	155.72'
L	35'	109°52'46"	49.87'	67.12'
M	50'	28°04'19"	12.50'	24.50'
N	300'	06°08'26"	16.00'	31.98'
O	298'	12°27'04"	32.51'	64.76'
P	1000'	02°40'29"	23.35'	46.68'
Q	1000'	03°25'57"	29.96'	59.91'
R	302'	09°01'07"	23.82'	47.54'
S	1000'	03°25'57"	29.96'	59.91'
T	1500'	03°28'51"	45.58'	91.13'
U	2000'	02°51'50"	50.00'	99.97'
V	2000'	02°13'50"	38.94'	77.86'
W	1000'	02°13'50"	19.47'	38.93'
X	3000'	05°17'28"	138.62'	277.04'
Y	1500'	04°44'41"	62.14'	124.22'

B.M. 30-173LA-55
Elev. 208.55'
Lead & tack in E. curb Western Ave
3' N. of end curb return N.E. cor
21st St. & Western Ave.

B.M. 32-173LA-55
Elev. 184.27'
Cut spike 2.5' N. of N. curb 21st St
17' ± E. of Normandie N.W. cor C.B.

For Right Of Way Information Not Shown, See Right Of Way Maps On File In The District Office.

CITY OF LOS ANGELES

STATE OF CALIFORNIA
HIGHWAY TRANSPORTATION AGENCY
DEPARTMENT OF PUBLIC WORKS
DIVISION OF HIGHWAYS
MONUMENTATION MAP
No. MF-2076-4

RED Deffels
Deputy District Engineer

R	Δ	T	L	R	Δ	T	L		
A	2000'	02°13'50"	3894'	7786'	M	3000'	05°17'28"	13852'	27704'
B	1000'	03°25'57"	2996'	5991'	N	3000'	08°06'28"	21262'	42452'
C	"	"	"	"	O	2000'	03°50'33"	6709'	13413'
D	4000'	05°58'59"	20962'	41770'	P	800'	05°18'30"	3709'	7412'
E	3000'	02°51'50"	7499'	14995'	Q	1000'	06°54'29"	6036'	12057'
F	5000'	02°51'50"	12499'	24992'	R	800'	09°44'53"	6822'	13611'
G	4000'	03°28'48"	12151'	24295'	S	2500'	02°50'00"	17376'	34748'
H	1000'	03°25'57"	2996'	5991'	T	3000'	02°49'00"	17376'	34748'
I	"	"	"	"	U	1000'	04°43'42"	4129'	8253'
J	"	"	"	"	V	1000'	03°25'57"	2996'	5991'
K	3000'	03°34'04"	9343'	18681'	W	"	"	"	"
L	1500'	04°44'41"	6214'	12422'	X	"	"	"	"

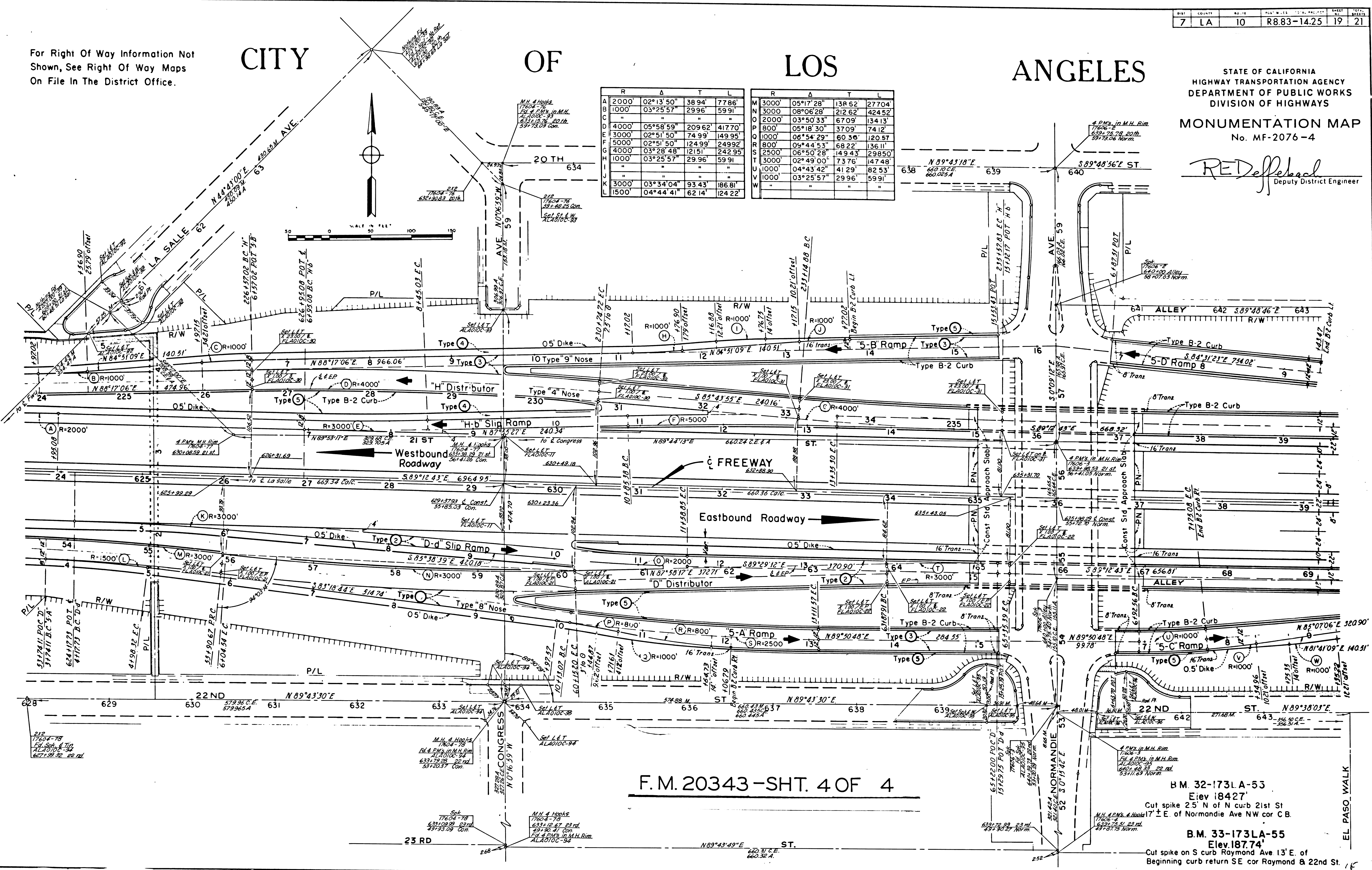

F.M. 20343-SHT. 4 OF 4

B.M. 32-173LA-53
 Elev. 18427'
 Cut spike 25' N of N curb 21st St
 17' E of Normandie Ave NW cor CB.
 B.M. 33-173LA-55
 Elev. 18774'
 Cut spike on S curb Raymond Ave 13' E. of
 Beginning curb return SE cor Raymond & 22nd St.

1484