

CITY OF LOS ANGELES

DAY	COUNTY	ROUTE	POST MILES - TOTAL PROJECT	SHEET NO.	TOTAL SHEETS
7	LA	10	R8.83-14.25	20	21

STATE OF CALIFORNIA
HIGHWAY TRANSPORTATION AGENCY
DEPARTMENT OF PUBLIC WORKS
DIVISION OF HIGHWAYS
MONUMENTATION MAP
No. MF-2077-1

W. J. Irvine
Deputy District Engineer

R	Δ	T	L
A	1000'	03°25'57"	29.96'
B	"	"	59.91'
C	"	"	"
D	5000'	02°42'18"	118.05'
E	2000'	07°23'38"	129.32'
F	2000'	03°49'02"	66.65'
G	5000'	02°42'18"	118.05'
H	1000'	03°01'07"	26.35'
I	2000'	03°49'02"	66.65'
J	2000'	02°13'50"	38.94'
K	1000'	02°51'50"	25.00'

R	Δ	T	L
L	1000'	03°25'57"	29.96'
M	"	"	59.91'
N	2000'	02°48'55"	49.15'
O	5000'	02°44'30"	119.65'
P	5000'	03°50'19"	167.55'
Q	1000'	02°26'57"	21.38'
R	5000'	02°51'50"	124.99'
S	5000'	04°38'40"	202.76'
T	2000'	02°51'50"	50.00'
U	1000'	04°51'44"	42.46'
V	5000'	01°25'29"	62.17'

For Right Of Way Information Not Shown, See Right Of Way Maps On File In The District Office.

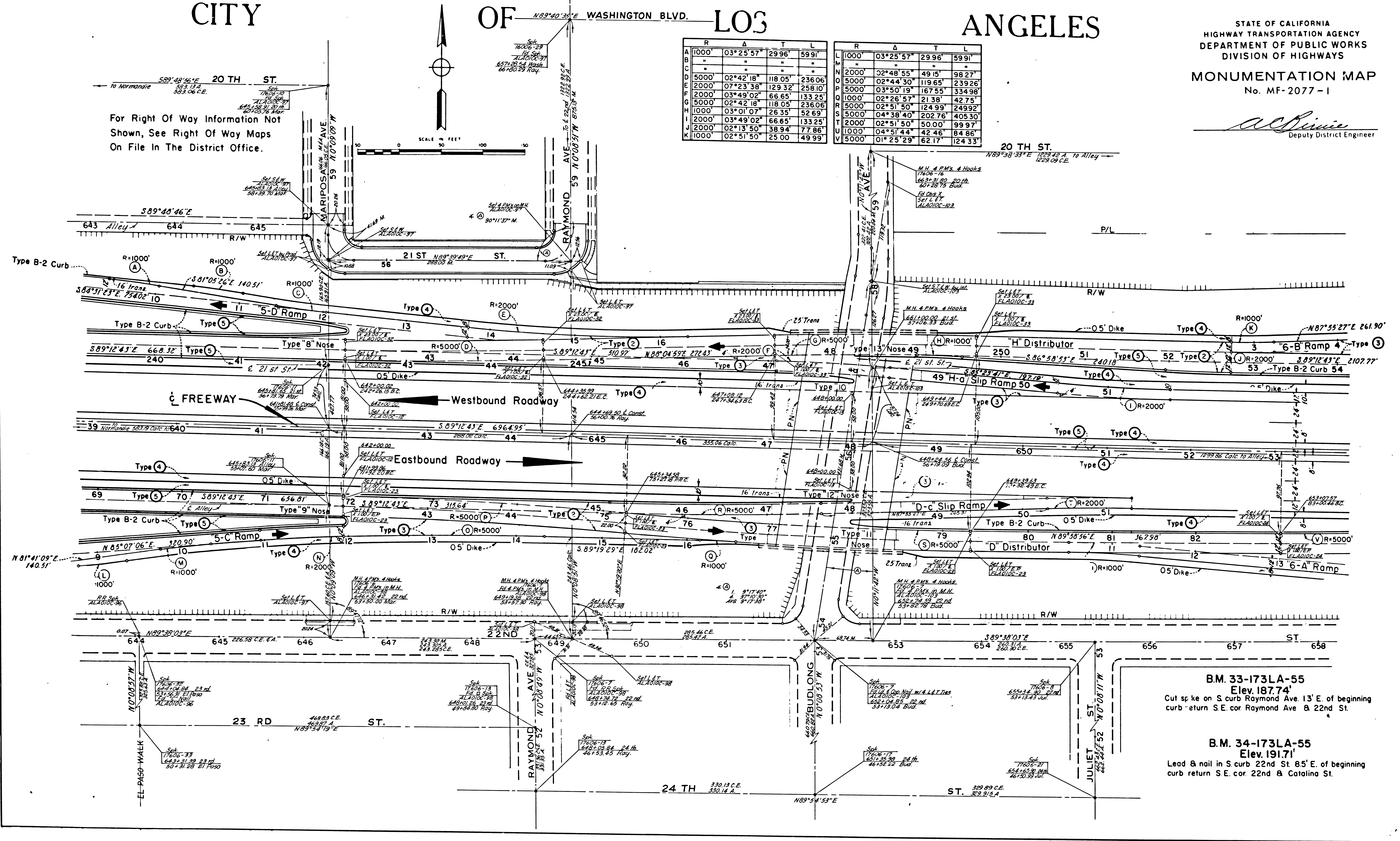

B.M. 33-173LA-55
Elev. 187.74'
Cut spike on S curb Raymond Ave 13' E. of beginning curb return S.E. cor Raymond Ave & 22nd St.

B.M. 34-173LA-55
Elev. 191.71'
Lead & nail in S curb 22nd St 85' E. of beginning curb return S.E. cor 22nd & Catalina St.

1484

SHEET NO.	TOTAL SHEETS
21	21

CITY OF LOS ANGELES

MONUMENTATION MAP No. MF-2077-2

Al Dirvine
Deputy District Engineer

For Right Of Way Information Not Shown, See Right Of Way Maps On File In The District Office.

	R	A	T	L
A	2000'	02°51'50"	38.94'	77.86'
B	1000'	02°51'50"	25.00'	49.98'
C	2000'	02°21'22"	41.13'	82.24'
D	1000'	03°25'57"	29.96'	59.91'
E	500'	07°06'03"	31.15'	62.21'
F	1000'	02°42'13"	23.60'	47.19'
G	500'	06°55'49"	30.28'	60.48'
H	1000'	03°25'57"	29.96'	59.91'
I	498'	11°19'39"	49.39'	98.46'
J	2000'	04°11'28"	73.18'	146.30'
K	50'	28°04'16"	12.50'	24.50'
L	35'	114°41'53"	54.62'	70.07'
M	5000'	01°25'29"	62.17'	124.33'
N	1000'	01°28'00"	12.80'	25.60'
O	1000'	03°25'57"	29.96'	59.91'
P	1000'	01°28'00"	12.80'	25.60'
Q	1000'	03°25'57"	29.96'	59.91'
R	5000'	02°13'50"	97.34'	194.68'
S	1500'	05°05'07"	66.61'	133.13'

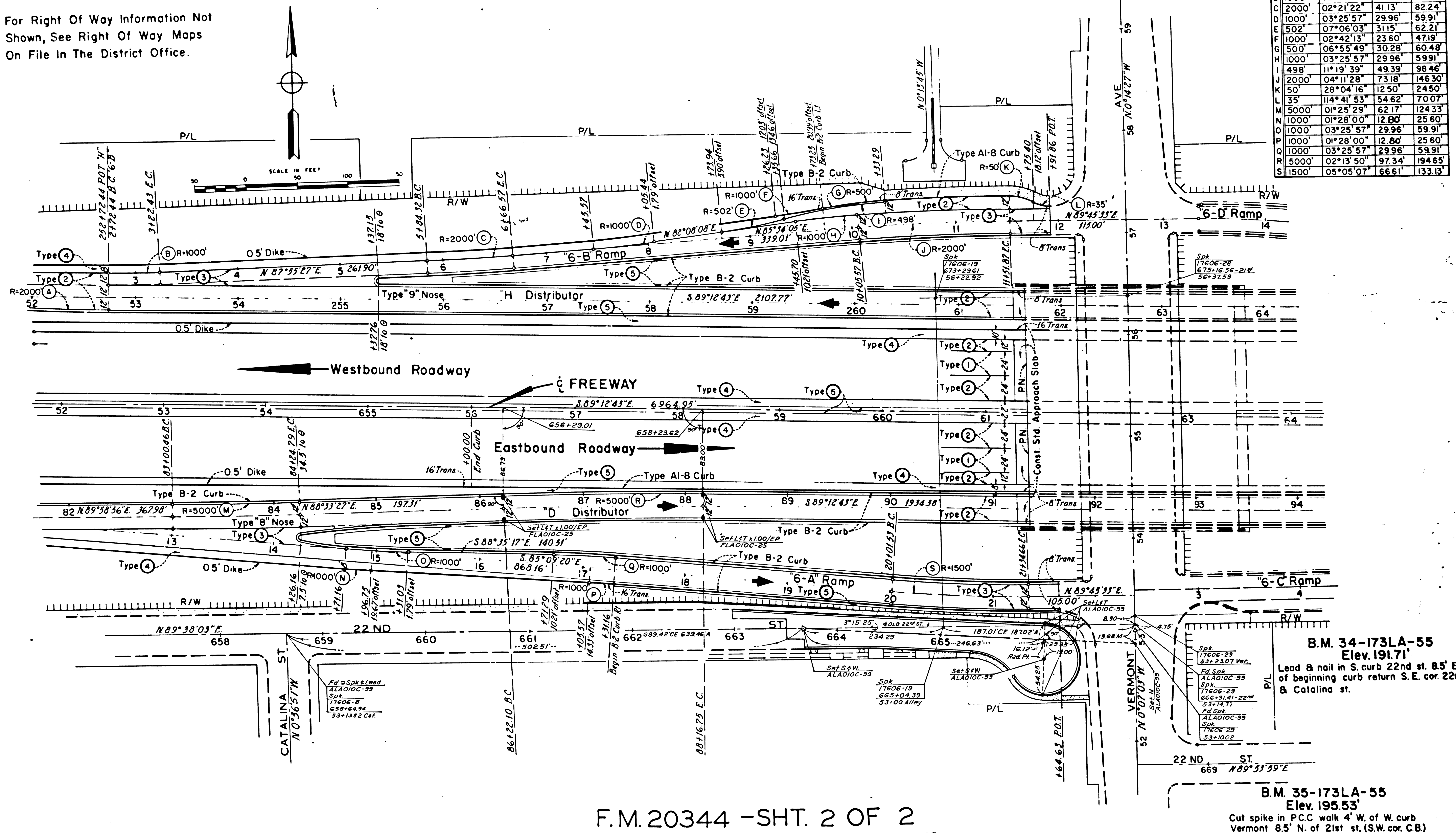

F.M. 20344 -SHT. 2 OF 2