

BLK	COUNTY	SECTION	POST MILES - TOTAL PROJECT	SHEET NO.	TOTAL SHEETS
7	LA	40	19.06 - 19.59	3	8

STATE OF CALIFORNIA
HIGHWAY TRANSPORTATION AGENCY
DEPARTMENT OF PUBLIC WORKS
DIVISION OF HIGHWAYS
MONUMENTATION MAP
No. MF-1919-1

C. W. Hoy
Deputy District Engineer

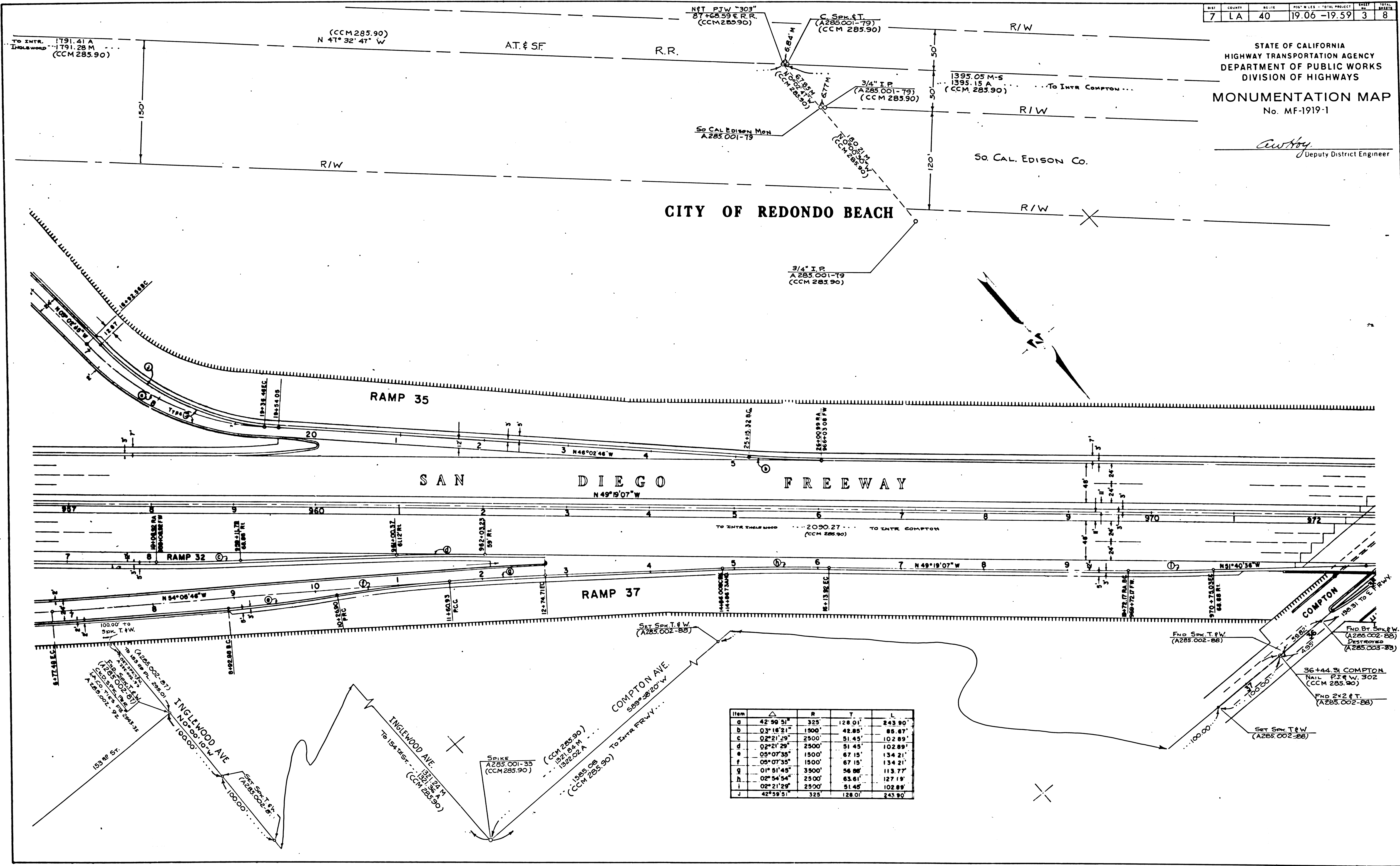

Item	Δ	R	T	L
a	42° 59' 51"	325'	128.01'	243.90'
b	03° 16' 21"	1500'	42.85'	85.67'
c	02° 21' 29"	2500'	51.45'	102.89'
d	02° 21' 29"	2500'	51.45'	102.89'
e	09° 07' 35"	1500'	67.15'	134.21'
f	09° 07' 35"	1500'	67.15'	134.21'
g	01° 51' 45"	3500'	56.96'	113.77'
h	02° 34' 54"	2500'	63.61'	127.19'
i	02° 21' 29"	2500'	51.45'	102.89'
j	42° 59' 51"	325'	128.01'	243.90'

145-5

DIST.	COUNTY	SECTION	POST MILES - TOTAL PROJECT	DATE	SCALE
7	LA	405	1906-19.59	4	8

STATE OF CALIFORNIA
HIGHWAY TRANSPORTATION AGENCY
DEPARTMENT OF PUBLIC WORKS
DIVISION OF HIGHWAYS
MONUMENTATION MAP
No. MF-1919-2

Anthony
Deputy District Engineer

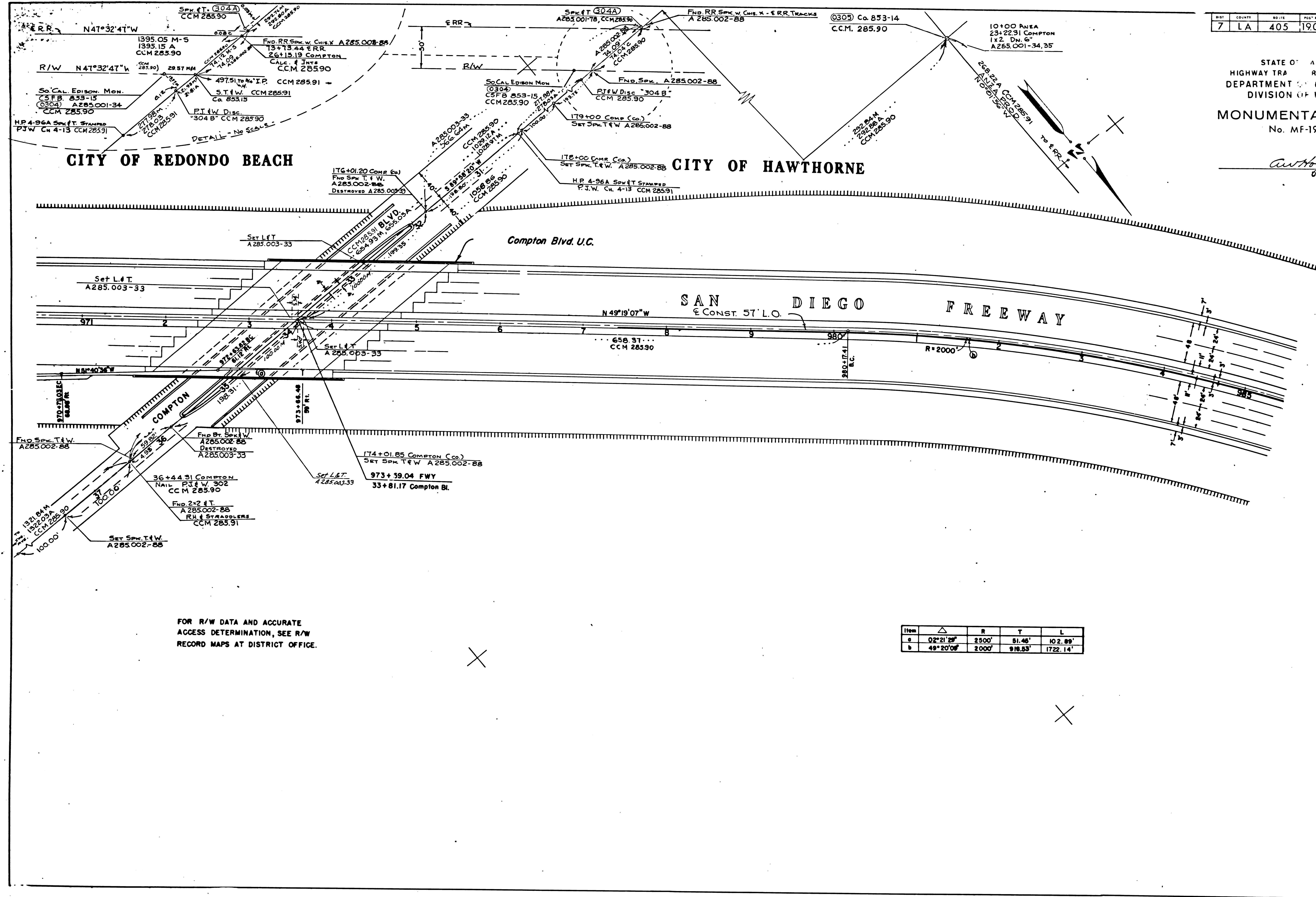

FOR R/W DATA AND ACCURATE
ACCESS DETERMINATION, SEE R/W
RECORD MAPS AT DISTRICT OFFICE.

Item	△	R	T	L
a	02°21'29"	2500'	81.46'	102.89'
b	49°20'06"	2000'	916.83'	1722.14'

145-5

STATE OF CALIFORNIA
HIGHWAY TRANSPORTATION AGENCY
DEPARTMENT OF PUBLIC WORKS
DIVISION OF HIGHWAYS
MONUMENTATION MAP
No. MF-1919-3

C. W. Hoy
Deputy District Engineer

CITY OF HAWTHORNE

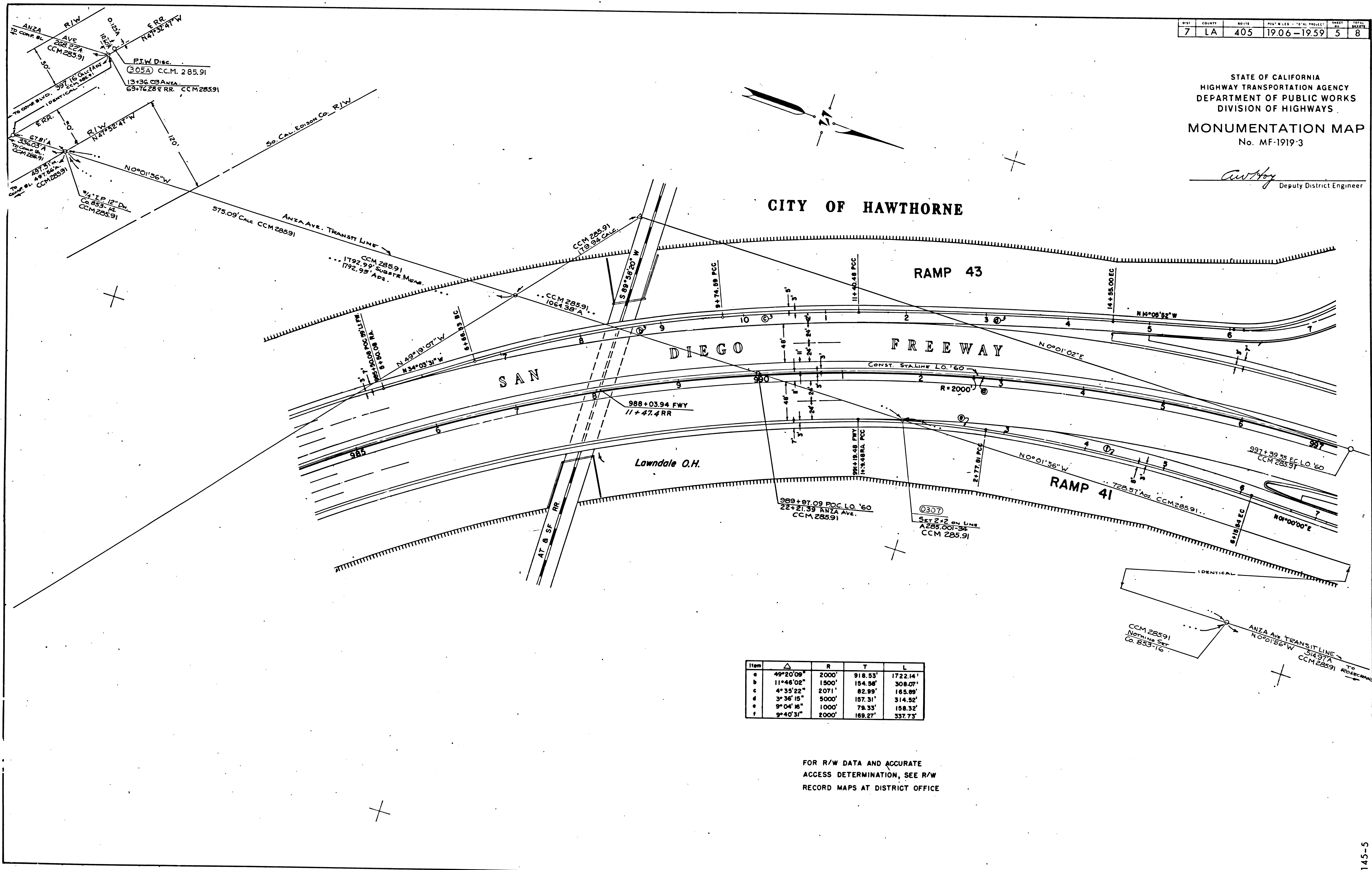

Item	Δ	R	T	L
a	49°20'09"	2000'	918.53'	1722.14'
b	11°46'02"	1500'	154.56'	308.07'
c	4°35'22"	2071'	82.99'	165.89'
d	3°36'15"	5000'	157.31'	314.52'
e	9°04'16"	1000'	78.33'	158.32'
f	9°40'31"	2000'	169.27'	337.73'

FOR R/W DATA AND ACCURATE
ACCESS DETERMINATION, SEE R/W
RECORD MAPS AT DISTRICT OFFICE

145-5

145-5

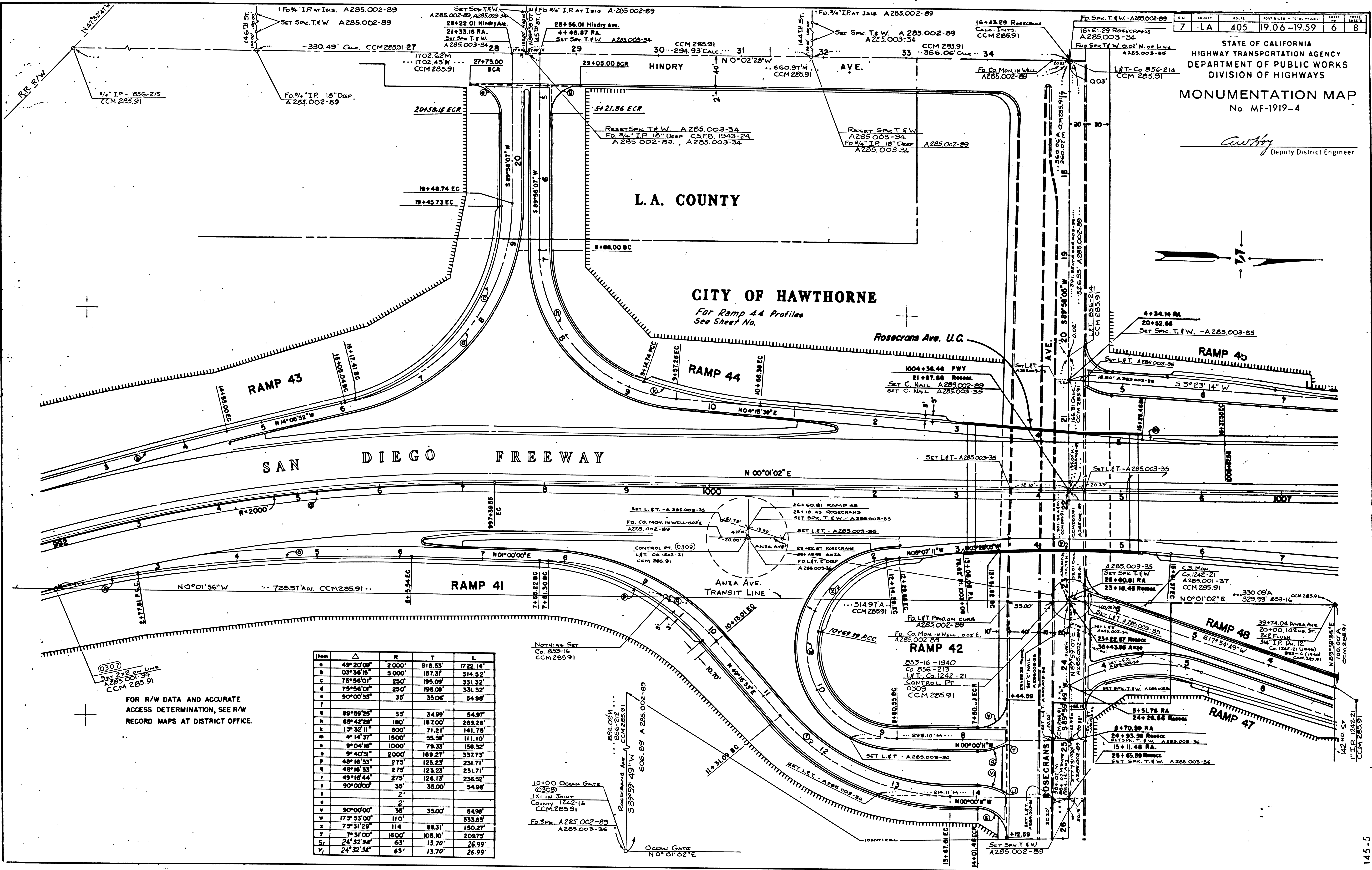

FOR R/W DATA AND ACCURATE
ACCESS DETERMINATION, SEE R/W
RECORD MAPS AT DISTRICT OFFICE.

Item	Δ	R	T	L
a	49°20'06"	2 000'	918.55'	1722.14'
b	03°36'15"	8 000'	157.37'	314.52'
c	75°56'01"	250'	195.09'	331.32'
d	75°56'01"	250'	195.09'	331.32'
e	90°00'36"	35'	35.06'	54.98'
f				
g	89°59'25"	35'	34.99'	54.97'
h	89°42'28"	180'	167.00'	269.26'
i	1°32'11"	600'	71.21'	141.78'
j	4°14'37"	1500'	55.59'	111.10'
k	9°04'16"	1000'	79.33'	158.32'
l	9°40'31"	2000'	169.27'	337.73'
m	48°16'33"	275'	123.23'	231.71'
n	49°18'44"	275'	123.23'	231.71'
o	90°00'00"	35'	35.00'	54.98'
p				
q	90°00'00"	35'	35.00'	54.98'
r	17°53'00"	110'		333.83'
s	79°31'29"	114'	88.31'	150.27'
t	7°31'00"	1500'	105.10'	208.75'
u	24°32'54"	63'	13.70'	26.99'
v	24°32'54"	63'	13.70'	26.99'