

For Right Of Way Information Not Shown, See Right Of Way Maps On File In The District Office.

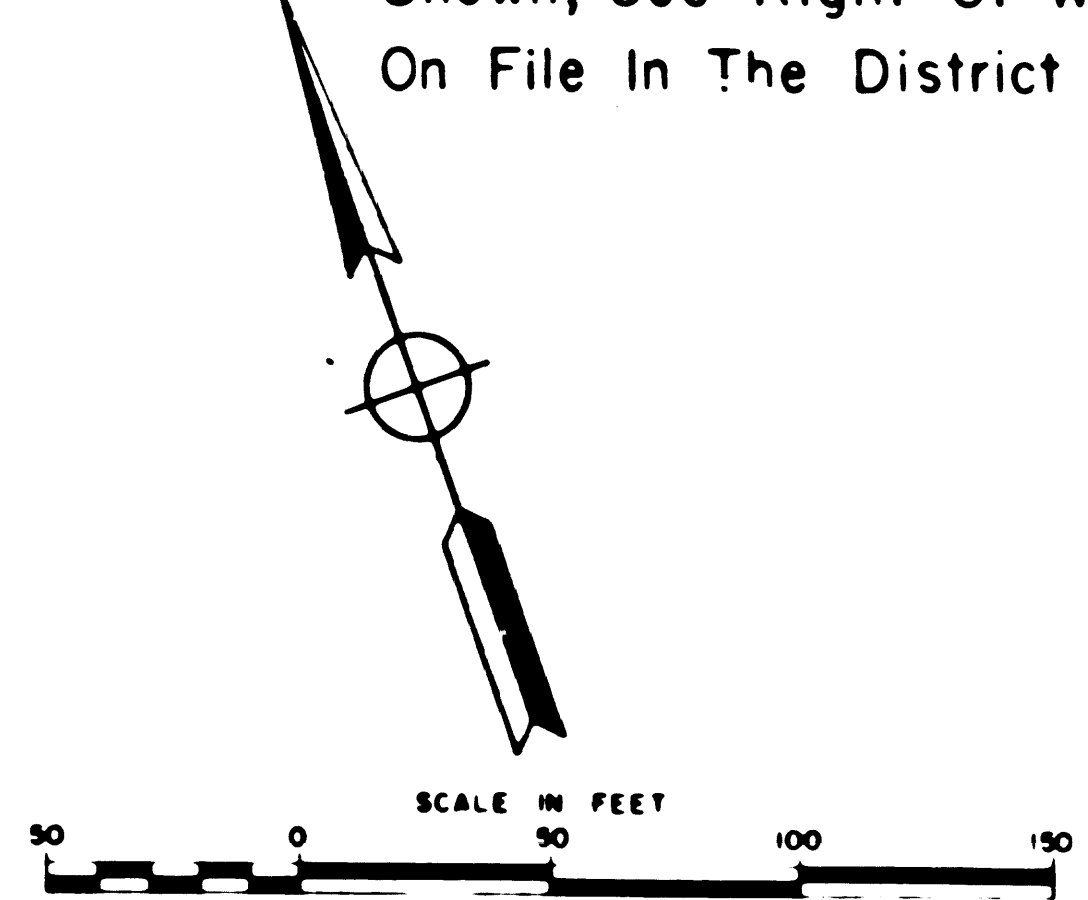

CITY OF LOS ANGELES

DIST	COUNTY	ROUTE	POST MILES - TOTAL PROJECT	SHEET NO.	TOTAL SHEETS
7	LA	10	64 - 88	1	9

STATE OF CALIFORNIA
HIGHWAY TRANSPORTATION AGENCY
DEPARTMENT OF PUBLIC WORKS
DIVISION OF HIGHWAYS
MONUMENTATION MAP
No. MF-2069-1

Carboy
Deputy District Engineer

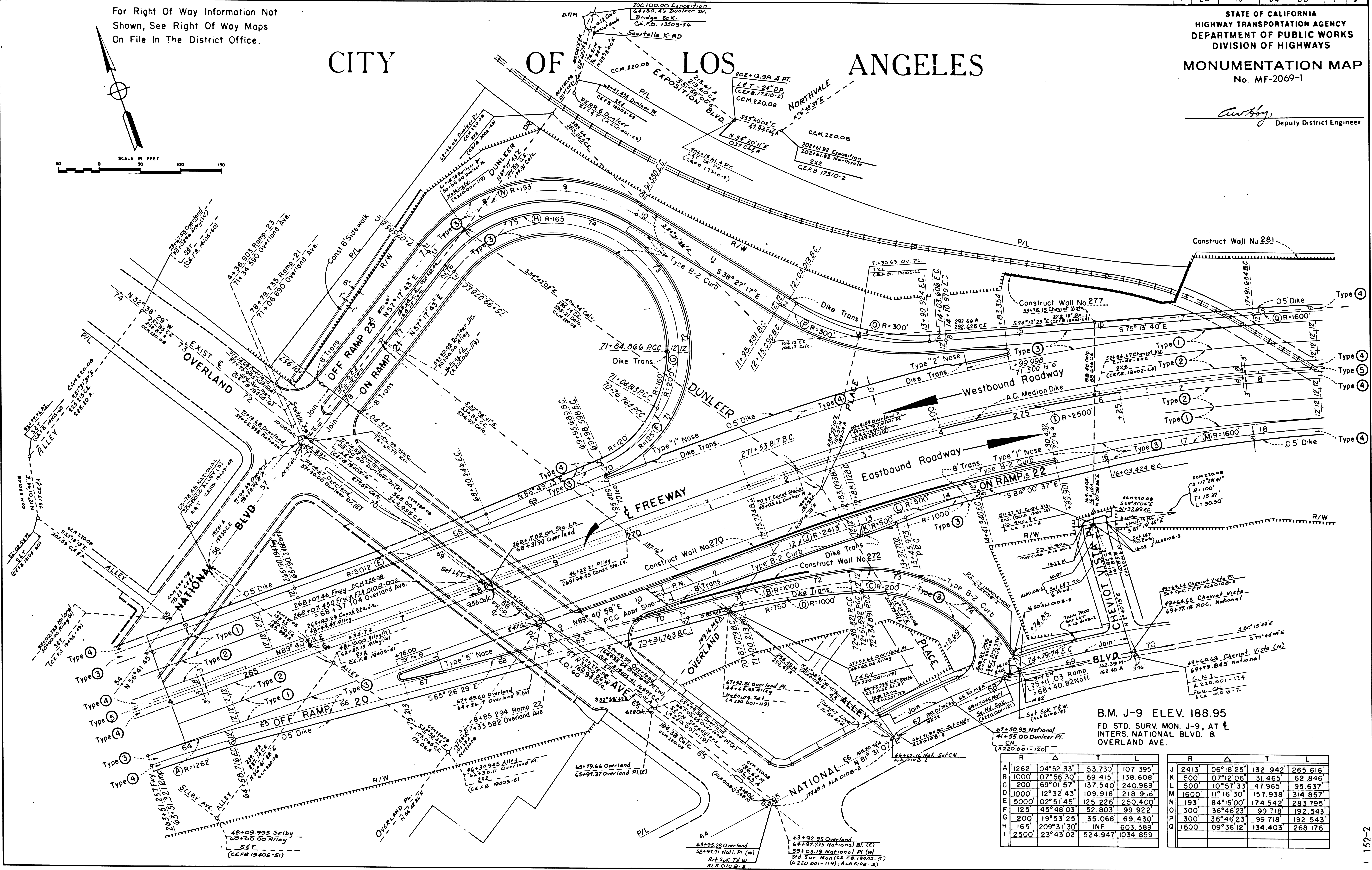

B.M. J-9 ELEV. 188.95
FD. STD. SURV. MON. J-9, AT E
INTERNS. NATIONAL BLVD. &
OVERLAND AVE.

R	Δ	T	L	
A	1262'	04°52'33"	53.730'	107.395'
B	1000'	07°56'30"	69.415'	138.608'
C	200'	69°01'57"	137.540'	240.969'
D	1000'	12°32'43"	109.918'	218.906'
E	5000'	02°51'45"	125.226'	250.400'
F	125'	45°48'03"	52.803'	99.922'
G	200'	19°53'25"	35.068'	69.430'
H	165'	20°31'30"	INF.	603.389'
I	2500'	23°43'02"	524.947'	1034.859'

R	Δ	T	L	
J	2413'	06°18'25"	132.942'	265.616'
K	500'	07°12'06"	31.465'	62.846'
L	500'	10°57'33"	47.965'	95.637'
M	1600'	11°16'30"	157.938'	314.857'
N	193'	84°15'00"	174.542'	283.795'
O	300'	36°46'23"	92.718'	192.543'
P	300'	36°46'23"	99.718'	192.543'
Q	1600'	09°36'12"	134.403'	268.176'

DIST.	COUNTY	NO. 118	POST M. LEE - TOTAL PROJECT	SHEET	TOTAL
7	LA	10	64 - 88	2	9

For Right Of Way Information Not Shown, See Right of Way Maps On File In The District Office.

CITY OF LOS ANGELES

STATE OF CALIFORNIA
HIGHWAY TRANSPORTATION AGENCY
DEPARTMENT OF PUBLIC WORKS
DIVISION OF HIGHWAYS
MONUMENTATION MAP
No. MF-2069-2

awby
Deputy District Engineer

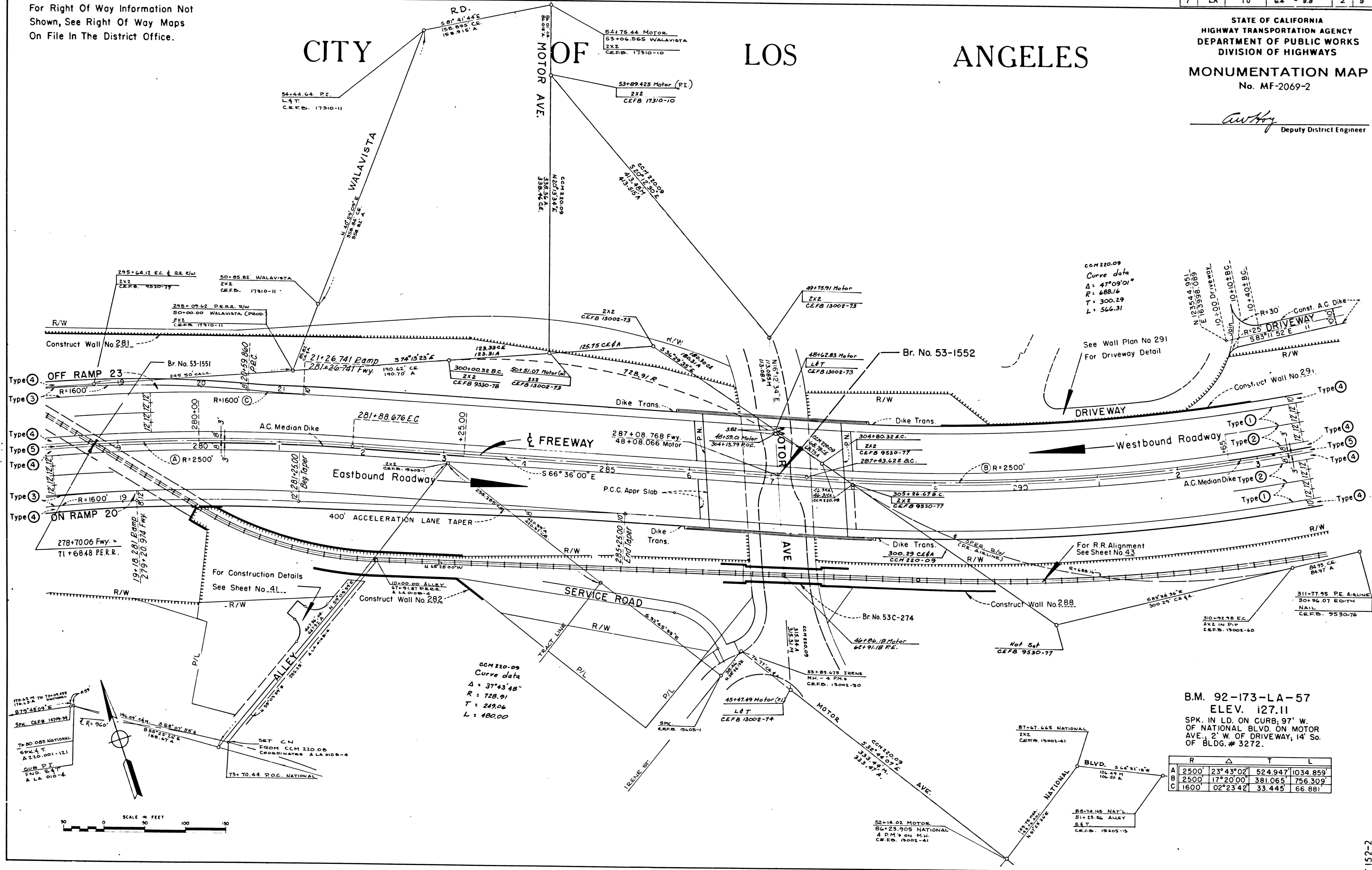

B.M. 92-173-LA-57
ELEV. 127.11
SPK. IN LD. ON CURB; 97' W. OF NATIONAL BLVD. ON MOTOR AVE.; 2' W. OF DRIVEWAY; 14' SO. OF BLDG. # 3272.

	R	Δ	T	L
A	2500	23°43'02"	524.947	1034.859
B	2500	17°20'00"	381.065	756.309
C	1600	02°23'42"	33.445	66.881

152-2

DIST.	COUNTY	NO. IN	POST. MILES - TOTAL PROJECT	SHEET NO.	TOTAL SHEETS
7	LA	10	6.4 - 8.8	3	9

STATE OF CALIFORNIA
HIGHWAY TRANSPORTATION AGENCY
DEPARTMENT OF PUBLIC WORKS
DIVISION OF HIGHWAYS
MONUMENTATION MAP
No. MF-2069-3

C. W. Hays
Deputy District Engineer

For Right Of Way Information Not
Shown, See Right Of Way Maps
On File In The District Office.

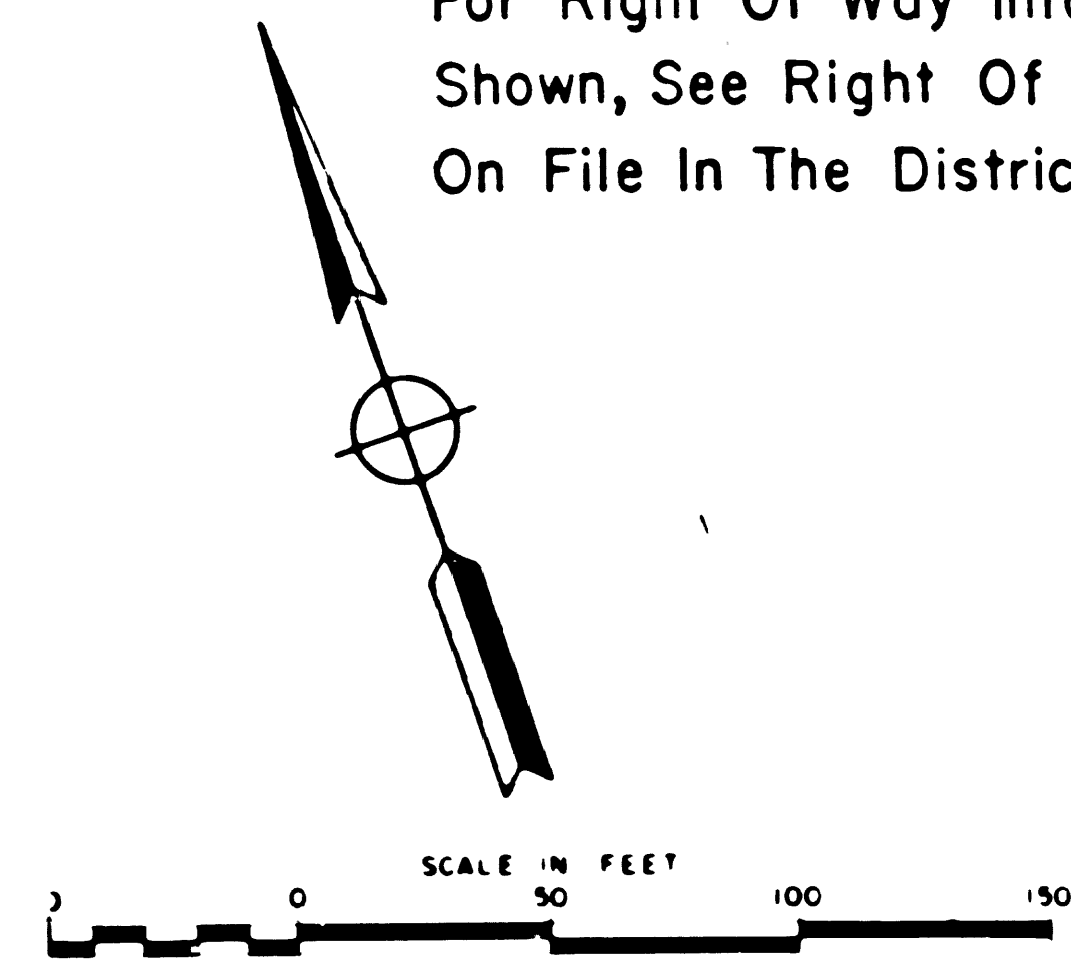

CITY OF LOS ANGELES

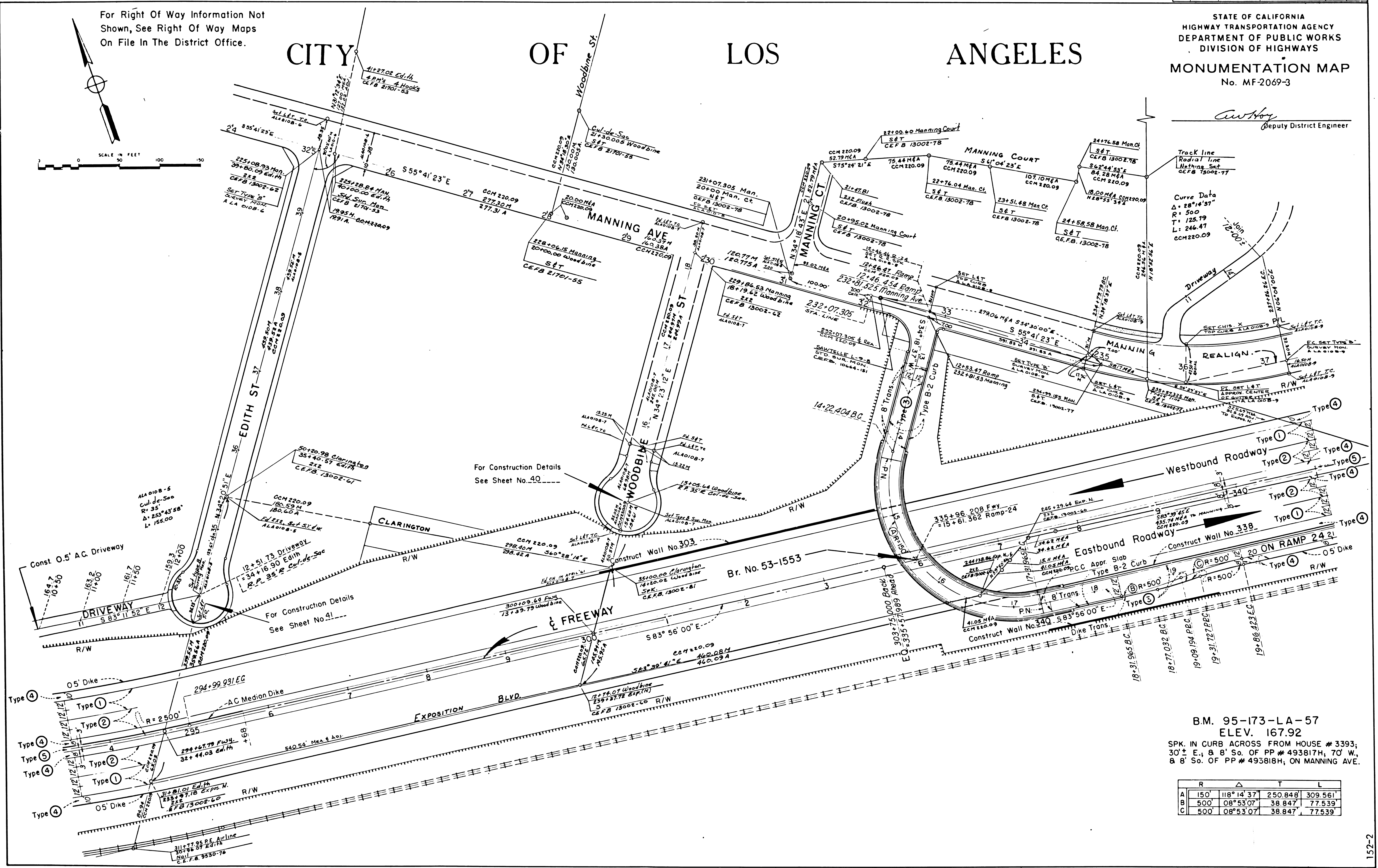

B.M. 95-173-LA-57
ELEV. 167.92
SPK. IN CURB ACROSS FROM HOUSE # 3393,
30' ± E.; & 8' So. OF PP # 493817H, 70' W.,
& 8' So. OF PP # 493818H, ON MANNING AVE.

	R	Δ	T	L
A	150'	118°14'37"	250.848	309.561
B	500'	08°53'07"	38.847	77.539
C	500'	08°53'07"	38.847	77.539

152-2