

DIST.	COUNTY	ROUTE	POST MILES - TOTAL PROJECT	SHEET NO.	TOTAL SHEETS
7	LA	10	6.4 - 8.8	6	9

STATE OF CALIFORNIA
HIGHWAY TRANSPORTATION AGENCY
DEPARTMENT OF PUBLIC WORKS
DIVISION OF HIGHWAYS
MONUMENTATION MAP
No. MF-2071-1

Anthony
Deputy District Engineer

For Right of Way Information Not
Shown, See Right Of Way Maps
On File In The District Office.

CITY OF LOS ANGELES

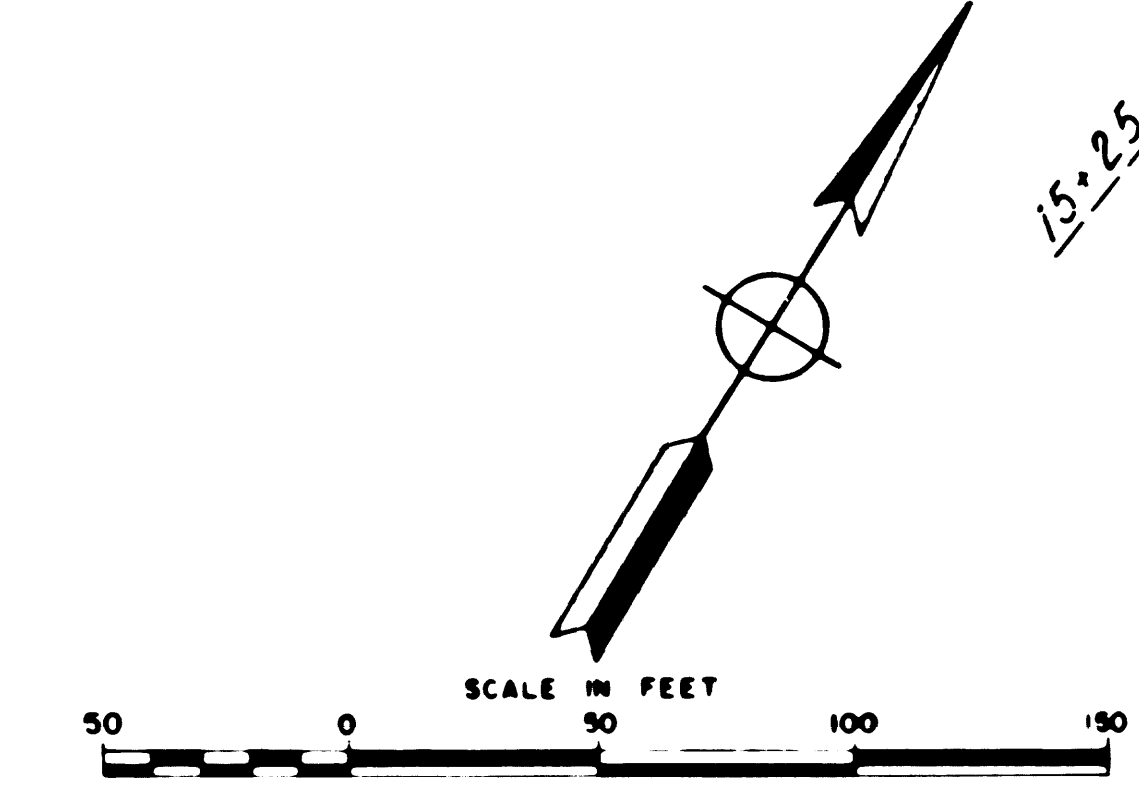
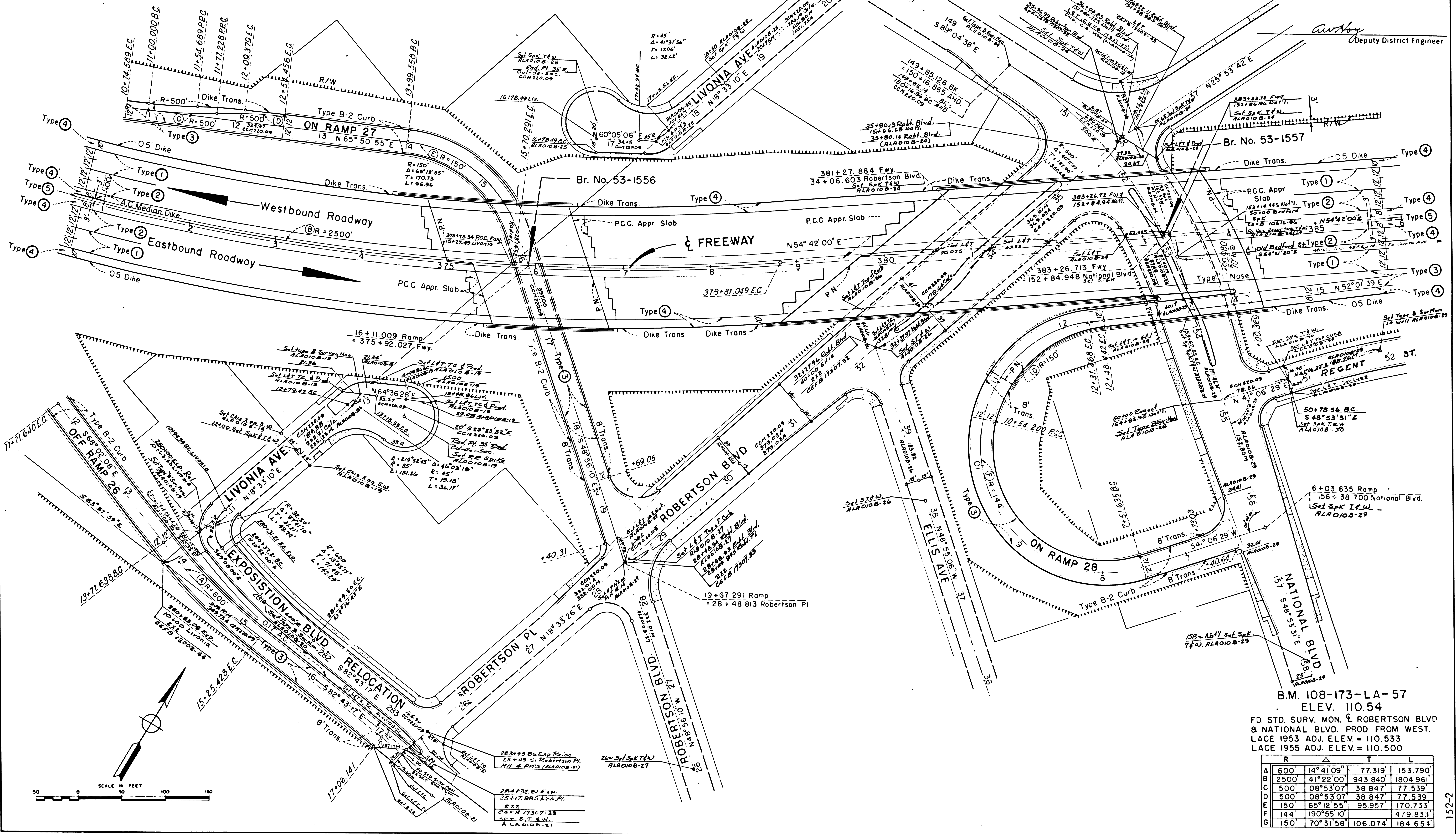

B.M. 108-173-LA-57
ELEV. 110.54
FD STD. SURV. MON. OF ROBERTSON BLVD
8 NATIONAL BLVD. PROD FROM WEST.
LACE 1953 ADJ. ELEV. = 110.533
LACE 1955 ADJ. ELEV. = 110.500

	R	Δ	T	L
A	600'	14°41'09"	77.319'	153.790'
B	2500'	41°22'00"	943.840'	1804.961'
C	500'	08°53'07"	38.847'	77.539'
D	500'	08°53'07"	38.847'	77.539'
E	150'	65°12'55"	95.957'	170.733'
F	144'	190°55'10"		479.833'
G	150'	70°31'58"	106.074'	184.651'

152-2

DIST	COUNTY	NO. 15	POST MILES - TOTAL PROJECT	SHEET NO.	TOTAL SHEETS
7	LA	10	64 - 88	7	9

For Right Of Way Information Not Shown, See Right Of Way Maps On File In The District Office.

STATE OF CALIFORNIA
HIGHWAY TRANSPORTATION AGENCY
DEPARTMENT OF PUBLIC WORKS
DIVISION OF HIGHWAYS
MONUMENTATION MAP
No. MF-2071-2

Anthony
District Engineer

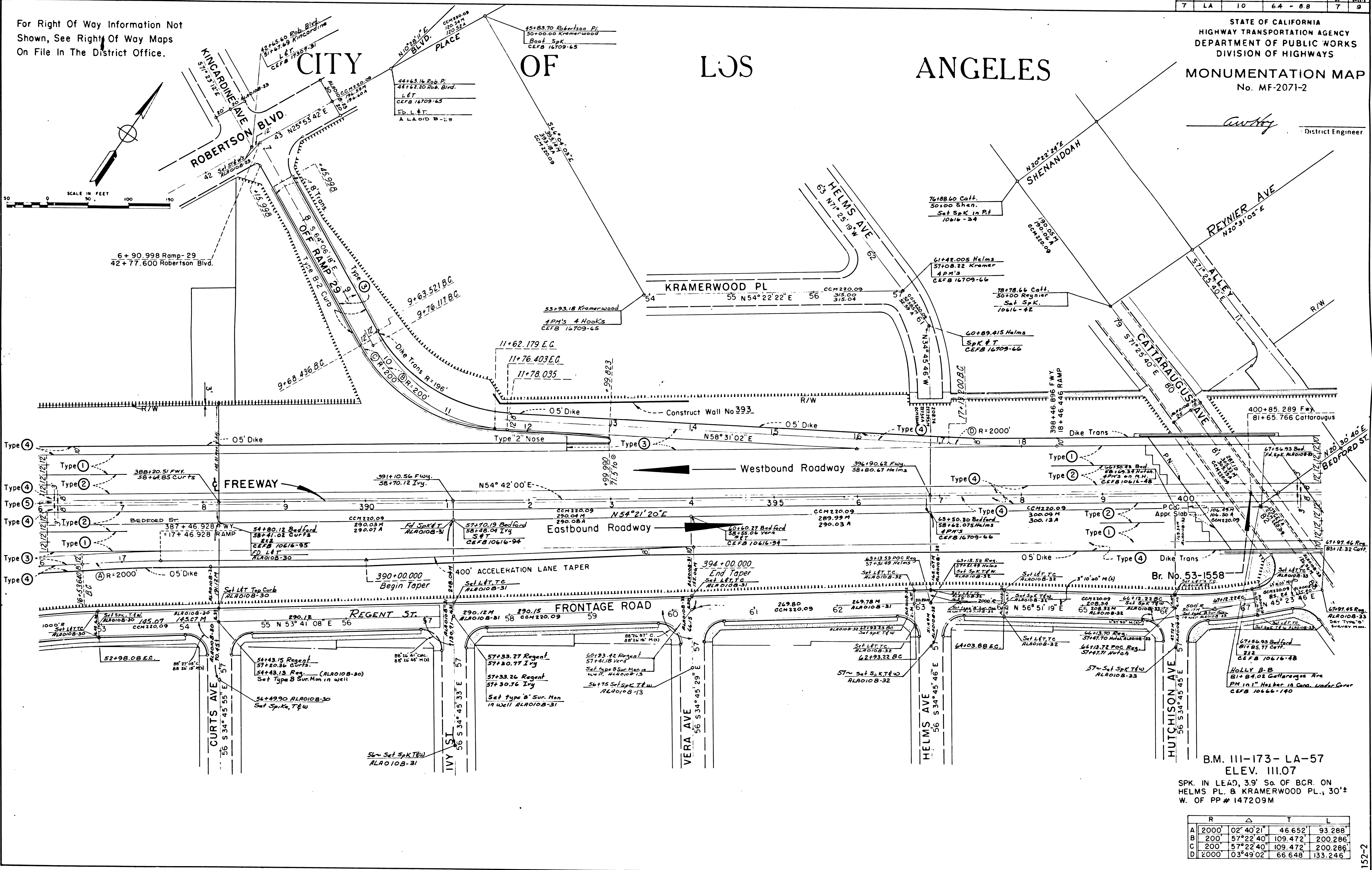

B.M. 111-173-LA-57
ELEV. 111.07
SPK. IN LEAD, 39' So. OF BCR. ON
HELMS PL. & KRAMERWOOD PL., 30'
W. OF PP # 147209M

	R	Δ	T	L
A	2000'	02°40'21"	46.652'	93.288'
B	200'	57°22'40"	109.472'	200.286'
C	200'	57°22'40"	109.472'	200.286'
D	2000'	03°49'02"	66.648'	133.246'

152-2