

CURVE DATA			
DELTA	R	LENGTH	TANGENT
A 38°33'47"	350	235.57	122.44
B 83°56'13"	200	293.00	170.88
C 25°22'57"	130	57.59	29.28
D 230°43'13"	115	463.09	
E 55°27'26"	140	135.57	73.69
F 55°31'34"	142	137.74	74.83
G 12°35'52"	100	25.42	12.87
H 163°59'05"	130	372.07	
I 77°26'05"	140	189.21	112.23
J 29°55'33"	260	135.80	69.49

7 LA 405 0.0-598 6 30

STATE OF CALIFORNIA  
HIGHWAY TRANSPORTATION AGENCY  
DEPARTMENT OF PUBLIC WORKS  
DIVISION OF HIGHWAYS

MONUMENTATION MAP  
No. MF-1900-2

*Anthony*  
County District Engineer

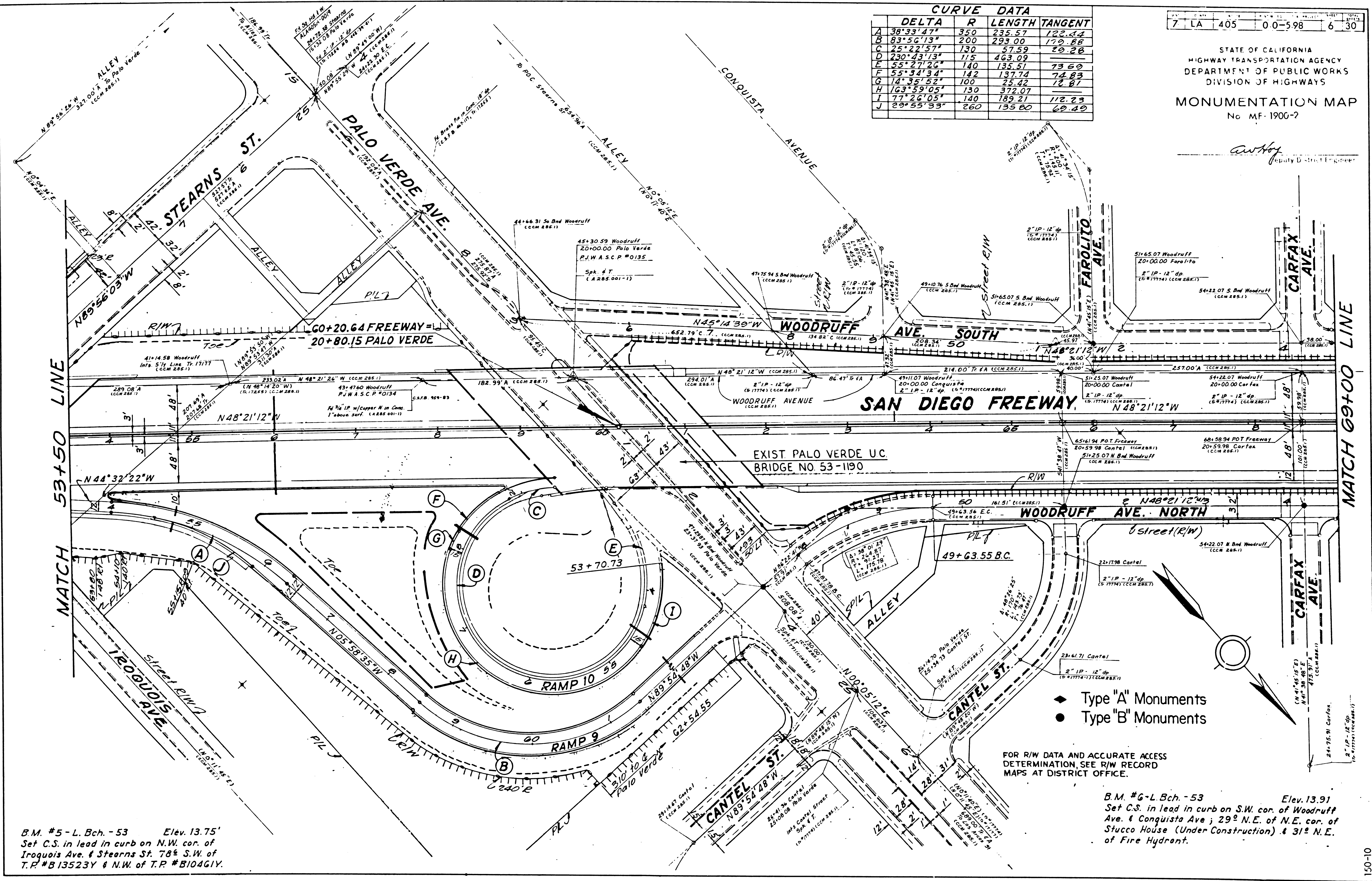

B.M. #5-L. Bch. - 53 Elev. 13.75'  
Set C.S. in lead in curb on N.W. cor. of  
Iroquois Ave. & Stearns St. 78° S.W. of  
T.P. #B13523Y & N.W. of T.P. #B104GIY.

- ◆ Type "A" Monuments
- Type "B" Monuments

FOR R/W DATA AND ACCURATE ACCESS  
DETERMINATION, SEE R/W RECORD  
MAPS AT DISTRICT OFFICE.

B.M. #6-L. Bch. - 53 Elev. 13.91  
Set C.S. in lead in curb on S.W. cor. of Woodruff  
Ave. & Conquista Ave; 29° N.E. of N.E. cor. of  
Stucco House (Under Construction) & 31° N.E.  
of Fire Hydrant.

STATE OF CALIFORNIA  
HIGHWAY TRANSPORTATION AGENCY  
DEPARTMENT OF PUBLIC WORKS  
DIVISION OF HIGHWAYS  
**MONUMENTATION MAP**  
No MF-900-3

*Cawley*  
District Engineer

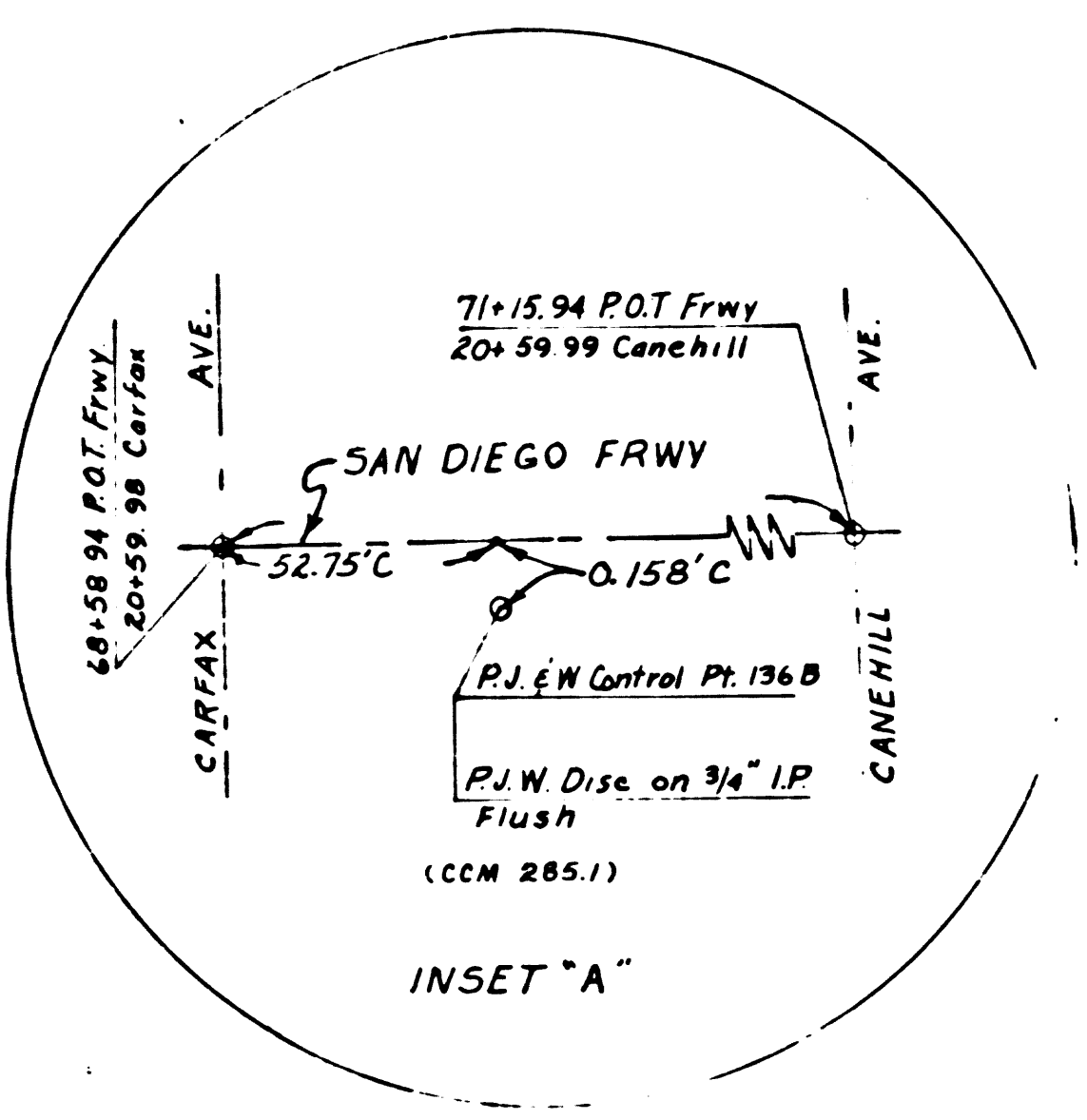
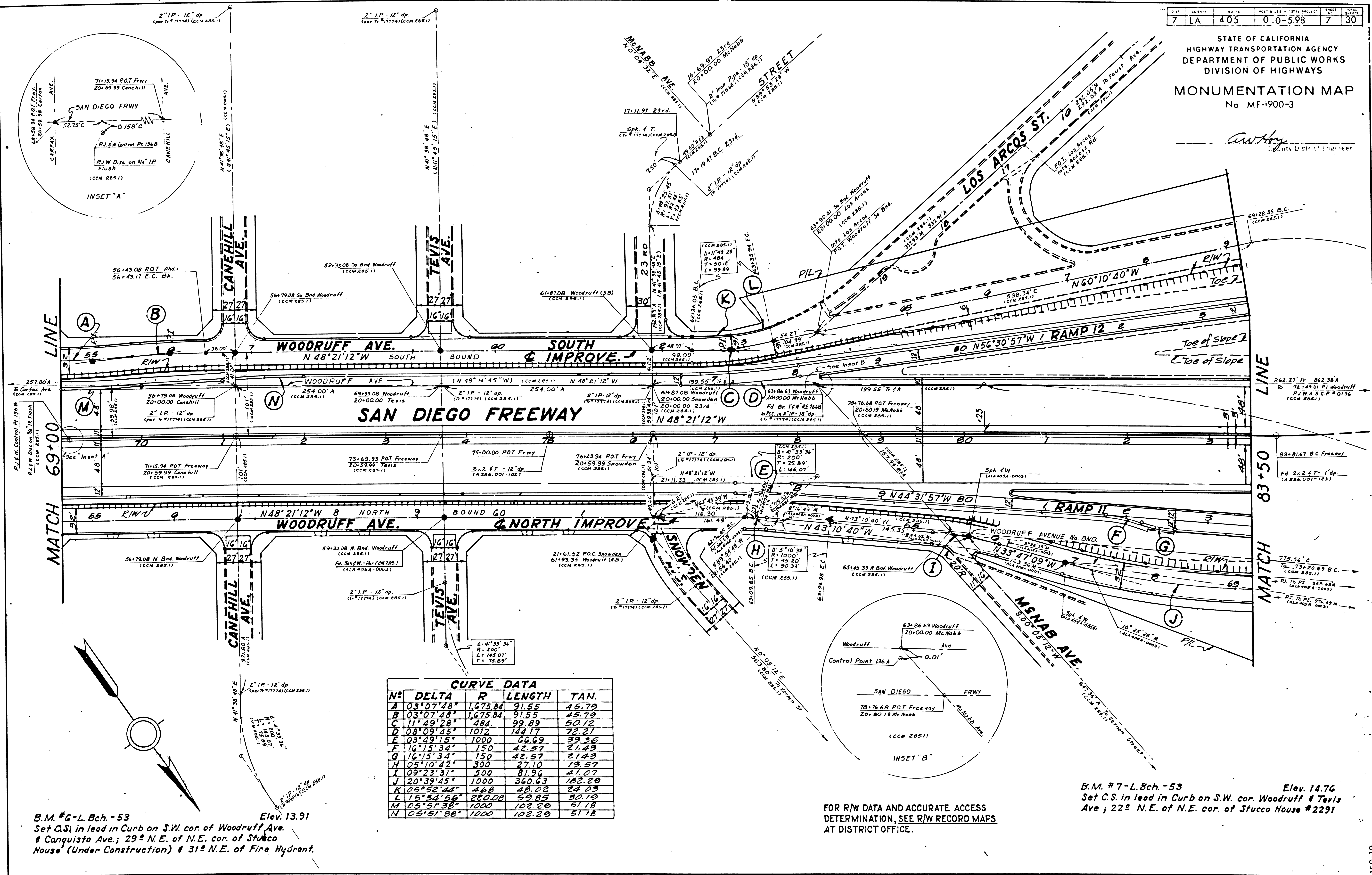

**CURVE DATA**

Nº	DELTA	R	LENGTH	TAN.
A	03°07'48"	1,675.84	91.55	45.79
B	03°07'48"	1,675.84	91.55	45.79
C	11°49'28"	484	99.89	50.72
D	08°09'48"	1012	144.17	72.21
E	03°49'15"	1000	66.69	33.36
F	16°15'34"	150	42.57	21.43
G	16°15'34"	150	42.57	21.43
H	05°10'42"	300	27.10	13.57
I	09°23'31"	500	81.96	41.07
J	20°39'45"	1000	360.63	182.29
K	05°52'44"	468	48.02	24.03
L	15°34'56"	220.08	59.85	30.18
M	05°57'38"	1000	102.29	51.18
N	05°57'38"	1000	102.29	51.18

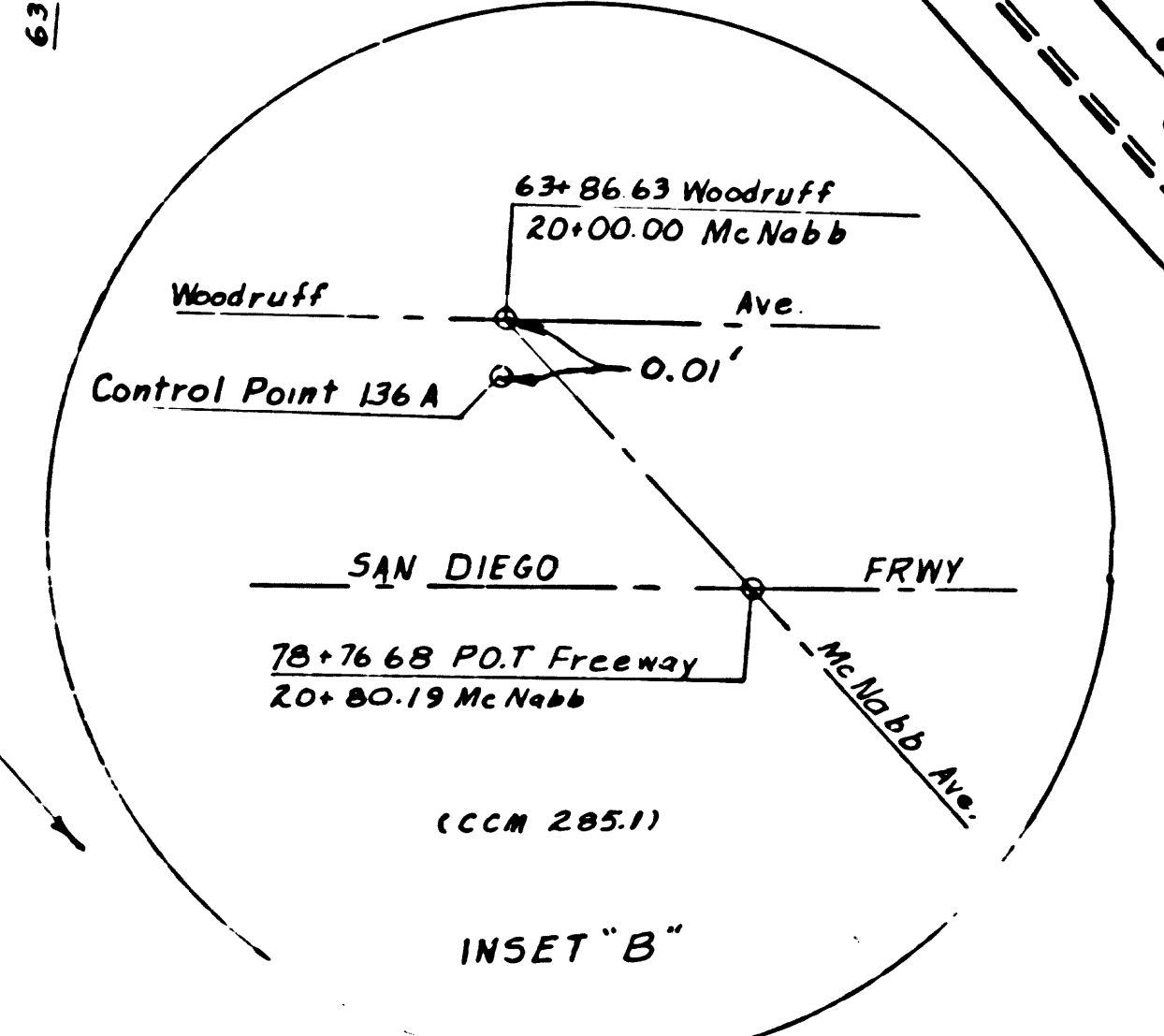

B.M. #G-L.Bch.-53  
Set C.S. in lead in Curb on S.W. cor. of Woodruff Ave.  
& Conquistador Ave.; 29° N.E. of N.E. cor. of Stucco  
House (Under Construction) & 31° N.E. of Fire Hydrant.  
Elev. 13.91

FOR R/W DATA AND ACCURATE ACCESS  
DETERMINATION, SEE R/W RECORD MAPS  
AT DISTRICT OFFICE.

B.M. #7-L.Bch.-53  
Set C.S. in lead in Curb on S.W. cor. Woodruff & Tevis  
Ave; 22° N.E. of N.E. cor. of Stucco House #2291  
Elev. 14.76

150-10

STATE OF CALIFORNIA  
HIGHWAY TRANSPORTATION AGENCY  
DEPARTMENT OF PUBLIC WORKS  
DIVISION OF HIGHWAYS  
MONUMENTATION MAP  
No. MF 1900-4

*awby*  
Deputy District Engineer

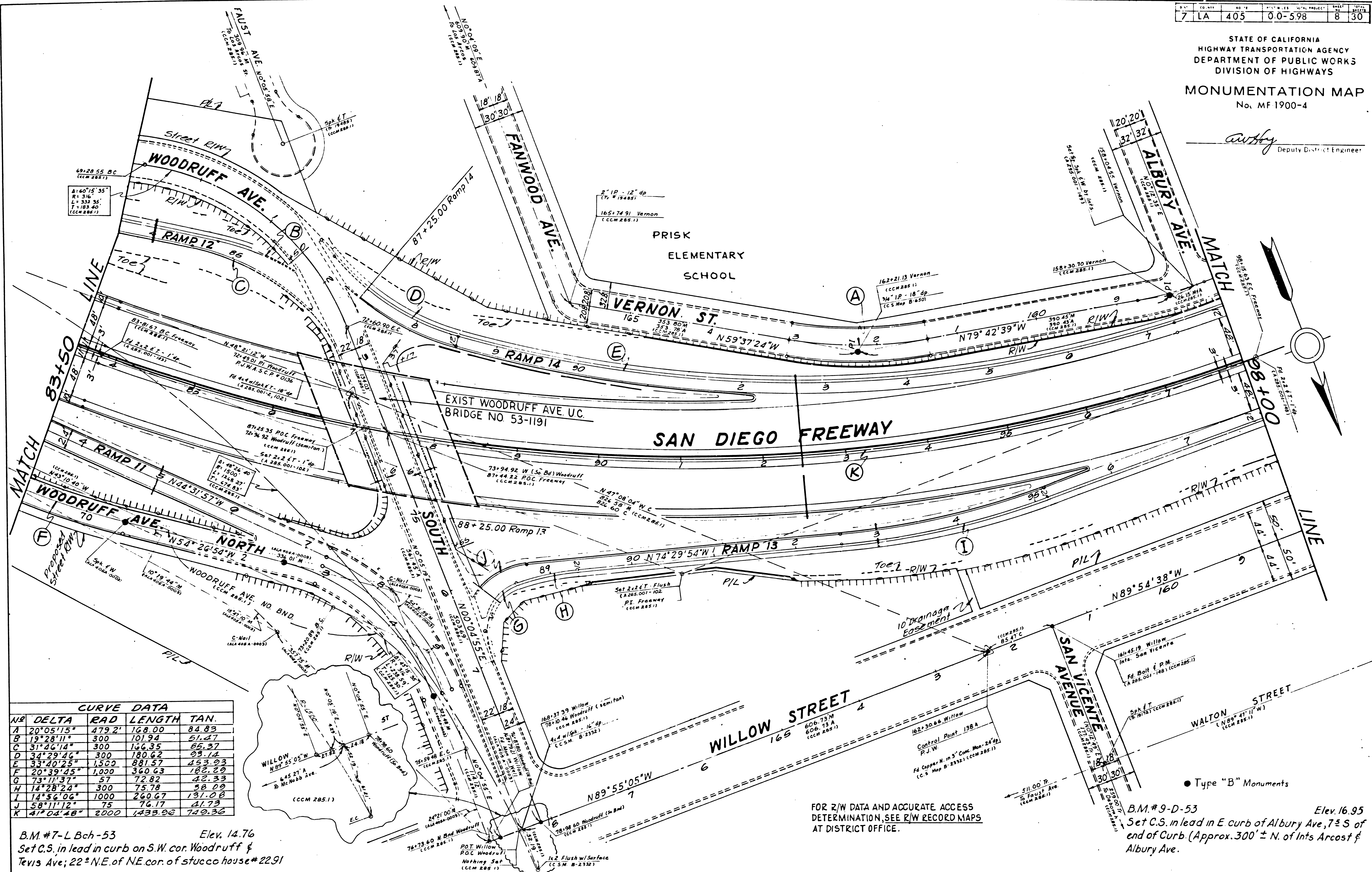

NO	DELTA	RAD	LENGTH	TAN.
A	20°05'15"	479.2'	168.00	84.83
B	19°28'11"	300	101.94	51.47
C	31°46'14"	300	166.35	85.37
D	34°29'46"	300	180.62	93.14
E	33°40'25"	1,500	881.57	453.03
F	20°39'45"	1,000	360.63	182.29
G	73°11'37"	57	72.82	42.33
H	14°28'24"	300	75.78	38.09
J	14°56'06"	1,000	260.67	131.08
K	58°11'12"	75	76.17	41.73
L	41°04'48"	2,000	1,433.96	749.36

B.M. #7-L Bch-53 Elev. 14.76  
Set C.S. in lead in curb on S.W. cor. Woodruff & Tevis Ave; 22° N.E. of N.E. cor. of stucco house # 22.91

FOR R/W DATA AND ACCURATE ACCESS DETERMINATION, SEE R/W RECORD MAPS AT DISTRICT OFFICE.

• Type "B" Monuments  
B.M. #9-D-53 Elev. 16.95  
Set C.S. in lead in E curb of Albany Ave, 7' S of end of Curb (Approx. 300' ± N. of Ints Arcost & Albany Ave.

150-10