

DIST.	COUNTY	NO. 11	DATE	SHEET	TOTAL
07	LA	605	16.85-202	12	19

STATE OF CALIFORNIA  
HIGHWAY TRANSPORTATION AGENCY  
DEPARTMENT OF PUBLIC WORKS  
DIVISION OF HIGHWAYS  
MONUMENTATION MAP  
No. MF-1968-1

CURVE	DATA		
R	L	T	
① 425'	44°20'31"	328.91'	173.19'
② 450'	46°24'50"	364.53'	192.93'
③ 300'	41°01'50"	214.84'	112.26'
④ 145'	27°58'10"	700.93'	
⑤ 200'	34°37'00"	120.83'	62.32'
⑥ 400'	08°19'20"	58.10'	29.08'
⑦ 130'	46°54'51"	151.62'	85.91'
⑧ 115'	58°35'31"	117.80'	64.52'
⑨ 280'	16°40'00"	819.37'	2,591.28'
⑩ 800'	03°08'10"	43.79'	21.90'
⑪ 200'	09°49'42"	34.31'	17.20'
⑫ 2000'	01°54'35"	66.66'	33.33'

NOTE. FOR R/W INFORMATION  
NOT SHOWN. SEE R/W MAPS  
ON FILE IN DISTRICT OFFICE.

B.M. 78-34A  
L.A. Co. F.C. monument stamped  
"Bench Mark No. 78-34A on S.E. corner of  
Valley Blvd bridge over San Gabriel River  
Elev 298.99'

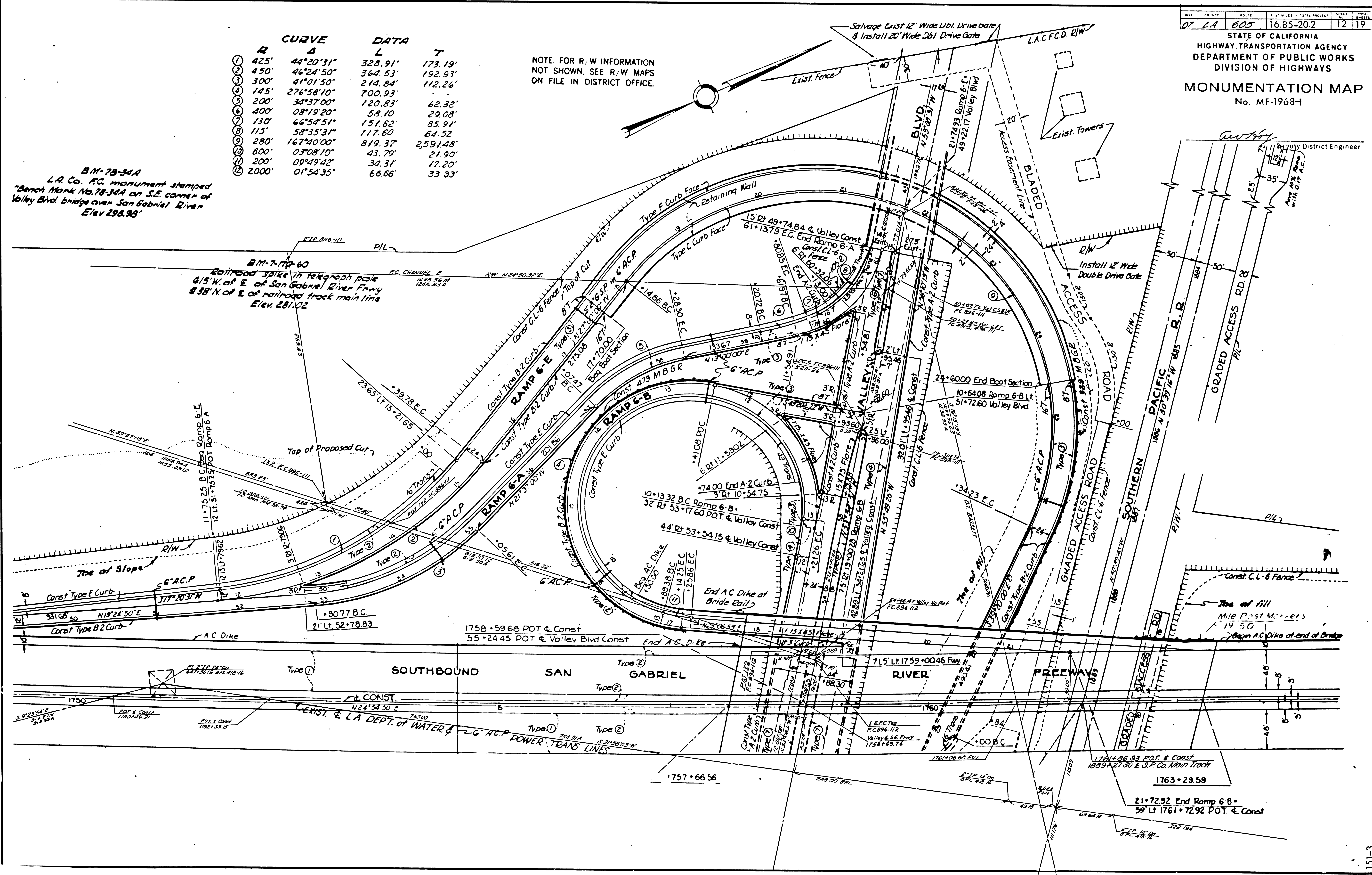

151-3



STATE OF CALIFORNIA  
HIGHWAY TRANSPORTATION AGENCY  
DEPARTMENT OF PUBLIC WORKS  
DIVISION OF HIGHWAYS

**MONUMENTATION MAP**  
No. MF-1968-2  
Deputy District Engineer

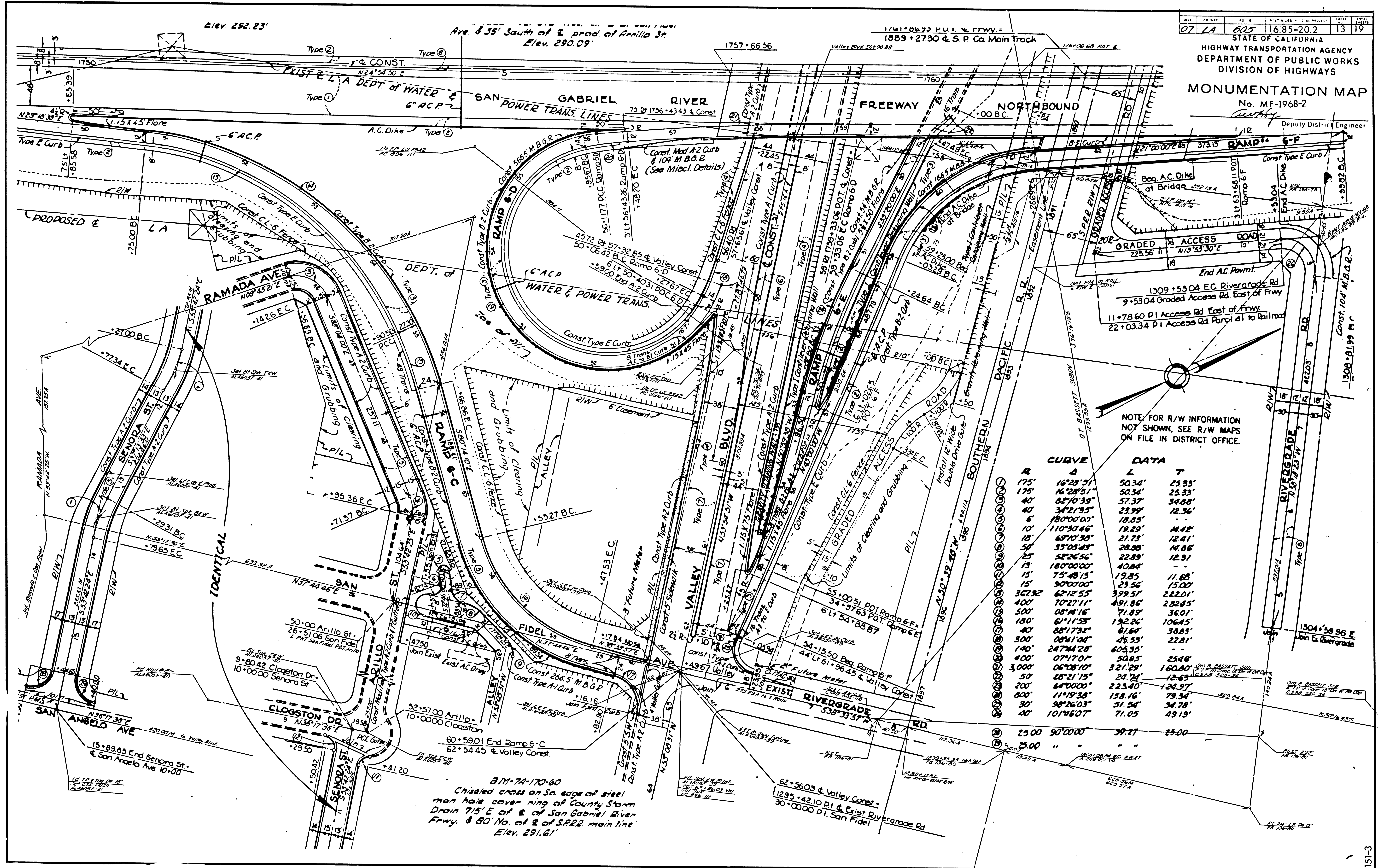

**CURVE DATA**

R	Δ	L	T
175'	16°28'51"	50.34'	25.33'
40'	16°28'51"	50.34'	25.33'
40'	82°0'39"	57.37'	34.88'
40'	34°21'35"	23.99'	12.36'
6'	180°00'00"	18.85'	-
10'	110°30'46"	19.29'	14.42'
18'	69°10'38"	21.73'	12.41'
50'	55°05'45"	28.08'	14.86'
25'	52°26'56"	22.89'	12.51'
13'	180°00'00"	40.84'	-
15'	75°48'15"	19.85'	11.65'
15'	90°00'00"	28.56'	15.00'
367.92'	62°12'55"	399.51'	222.01'
400'	70°27'11"	491.86'	282.65'
500'	08°48'16"	71.89'	36.01'
180'	61°11'53"	192.26'	106.45'
40'	88°17'32"	81.64'	38.85'
300'	08°41'04"	48.55'	22.81'
140'	247°44'28"	603.35'	-
400'	07°17'01"	50.85'	25.46'
3,000'	06°08'10"	321.29'	160.80'
50'	28°21'15"	24.04'	12.63'
200'	64°00'00"	223.40'	124.27'
800'	11°19'38"	138.16'	79.54'
30'	38°26'03"	51.54'	34.78'
40'	101°46'07"	71.05'	49.19'
25.00'	90°00'00"	39.27'	25.00'
200.00'	"	"	"

B11-7A-170-60  
Chialed cross on So. edge of steel  
man hole cover ring of County Storm  
Drain 715' E of & of San Gabriel River  
Fwy. & 80' No. of & of S.P.R.R. main line  
Elev. 291.61'



DIST	COUNTY	NO. IN	POST MILES - TOTAL PROJECT	SHEET	TOTAL SHEETS
07	LA	605	16.85-20.2	14	19

STATE OF CALIFORNIA  
HIGHWAY TRANSPORTATION AGENCY  
DEPARTMENT OF PUBLIC WORKS  
DIVISION OF HIGHWAYS  
**MONUMENTATION MAP**  
No. MF-1968-3

*Anthony*  
Deputy District Engineer

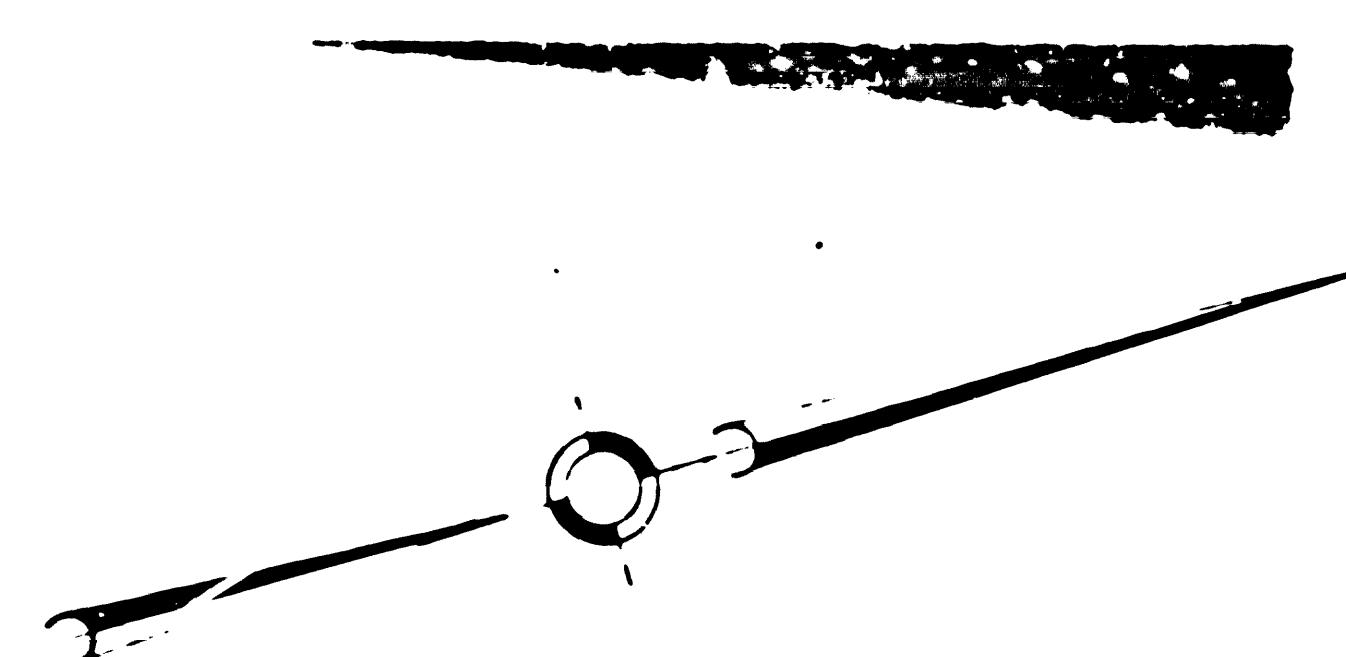

NOTE: FOR R/W INFORMATION  
NOT SHOWN. SEE R/W MAPS  
ON FILE IN DISTRICT OFFICE

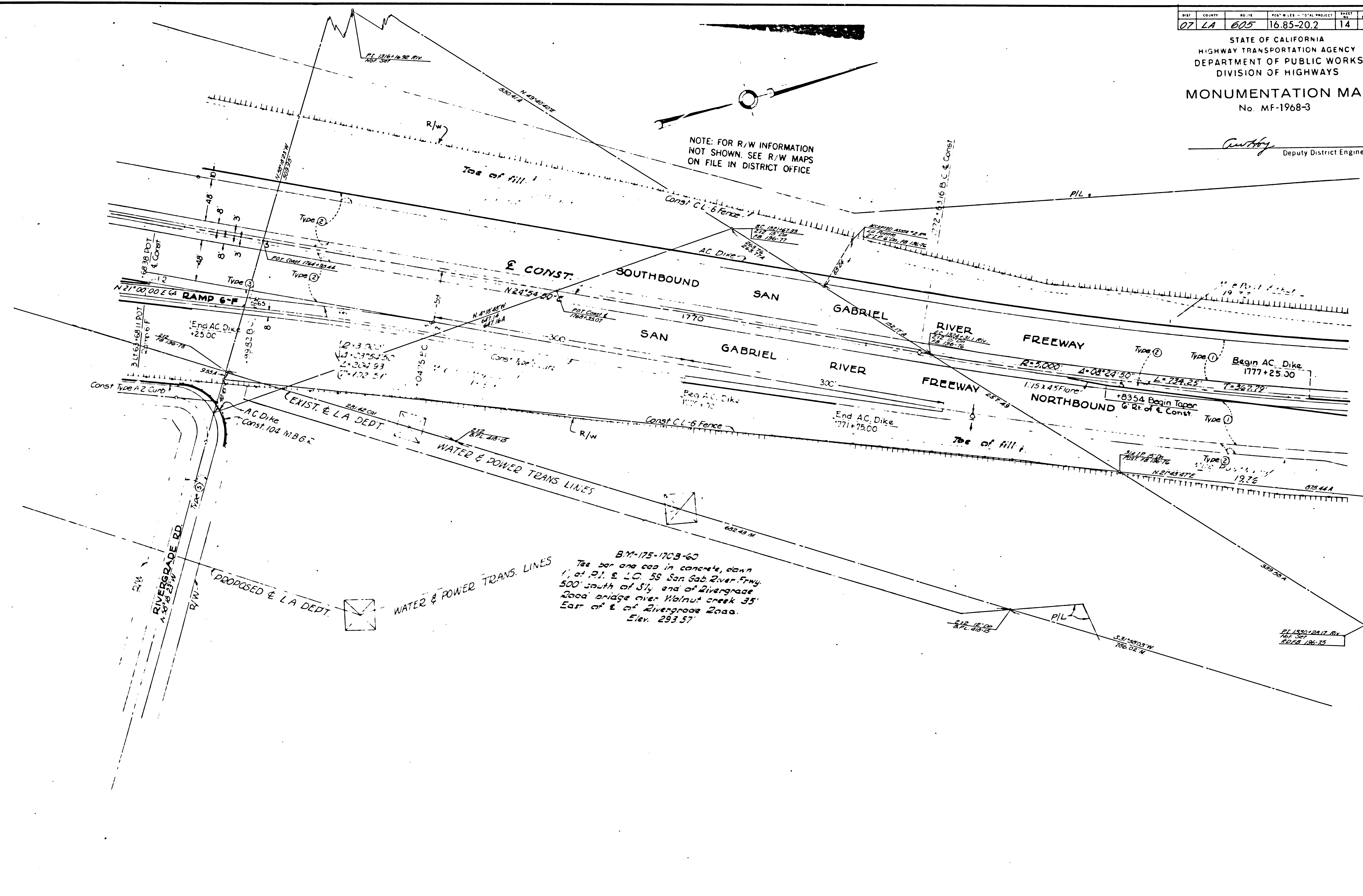

151-3

STATE OF CALIFORNIA  
 HIGHWAY TRANSPORTATION AGENCY  
 DEPARTMENT OF PUBLIC WORKS  
 DIVISION OF HIGHWAYS  
**MONUMENTATION MAP**  
 No. MF-1968-4

*Anthony*  
 Deputy District Engineer

NOTE FOR R/W INFORMATION  
 NOT SHOWN. SEE R/W MAPS  
 ON FILE IN DISTRICT OFFICE.

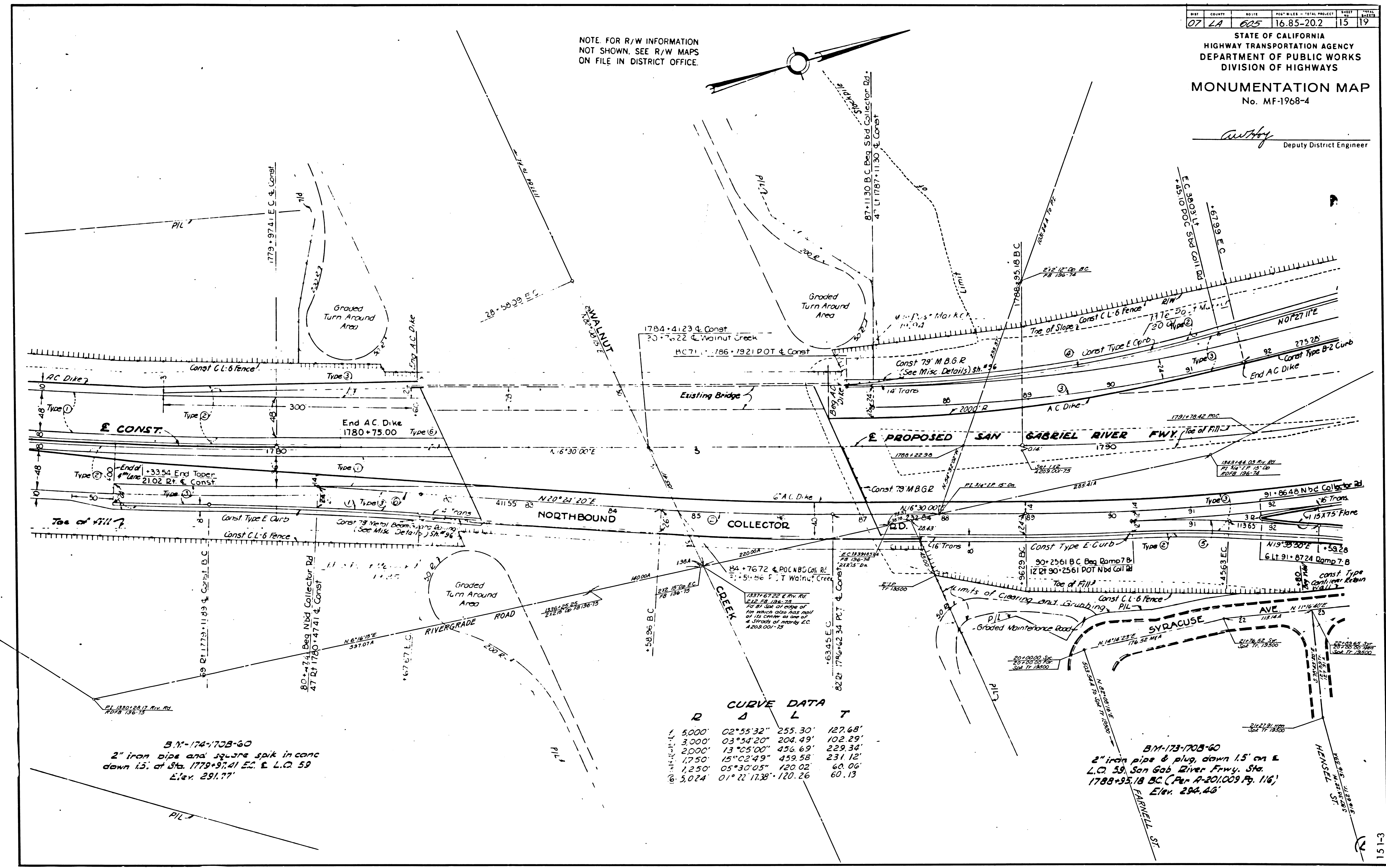

**CURVE DATA**

R	Δ	L	T
5000'	02° 55' 32"	255.30'	127.68'
3000'	03° 54' 20"	204.49'	102.29'
2000'	13° 05' 00"	145.69'	229.34'
1750'	15° 02' 49"	145.58'	231.12'
1250'	05° 30' 05"	120.02'	60.06'
5024'	01° 22' 17.38"	120.26'	60.13'

B.M. 174-1708-60  
 2" iron pipe and square spik in conc  
 down 1.5' at Sta. 1779+97.41 E.C. & L.C. 59  
 Elev. 291.77'

B.M. 173-1708-60  
 2" iron pipe & plug, down 1.5' on E  
 L.C. 59 San Gab River Fwy. Sta.  
 1788+95.18 B.C. (Per A-201009 Pg. 116)  
 Elev. 294.46'