

BY	COUNTY	NO.	DATE	TOTAL PROJECT	SHEET NO.	TOTAL SHEETS
07	LA	605	16.85-20.2		16	19

STATE OF CALIFORNIA  
HIGHWAY TRANSPORTATION AGENCY  
DEPARTMENT OF PUBLIC WORKS  
DIVISION OF HIGHWAYS  
**MONUMENTATION MAP**  
No. MF-1969-1

*C. W. Hays*  
Deputy District Engineer

550	07°56'33"	76.24'	39.18'
750	13°28'58"	176.49	88.25'
3,000	25°52'30"	1,354.81	689.16'
650	16°15'00"	184.35	92.80'
262	134°05'2"	613.15	618.53'
143	273°07'06"	681.65	
3,082	25°52'30"	1,391.84	708.00'
400	99°16'49"	693.11	470.67'
1,000	04°34'38"	79.89	39.97'
400	04°45'21"	33.20	16.61'
250	07°24'23"	32.32	16.14'
500	04°33'13"	39.74	17.5'
3,000	26°21'19"	332.76	166.5
150	26°18'24"	691.95	
100	59°00'31"	102.95	
75	06°11'58"	32.43	13.25'
300	142°03'58"	743.86	872.9'
400	10°51'47"	94.80	47.54'
500	10°51'47"	94.80	47.54'
305	70°00'21"	544.55	210.70'
1,944	31°54'36"	478.7	243.1'

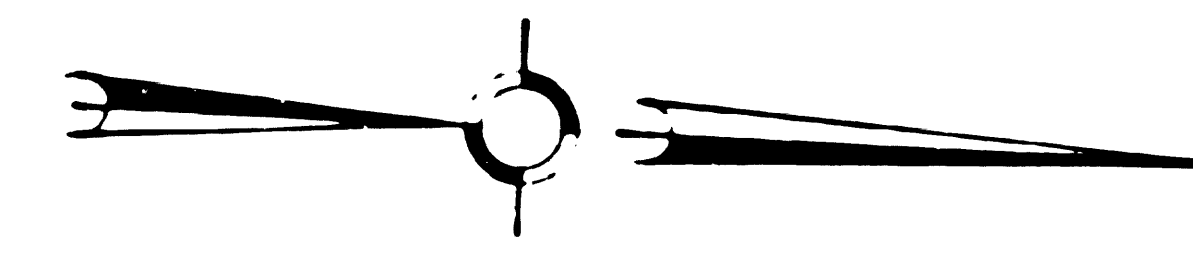

NOTE: FOR R/W INFORMATION  
NOT SHOWN, SEE R/W MAPS  
ON FILE IN DISTRICT OFFICE.

BM-172-1703-60  
The bar and cap with concrete collar, at P.I. & L.C. 59 of San Gabriel River Fwy 400 S'ly of intersection with San Bernardino Fwy 20 north of & south frontage road.  
Elev. 295.75'

66+88.35 E.C. Ramp J  
24' LT 93+77.38 POT Sbd Collector Rd

+45.10 E.C. +67.99 E.C.  
Const Type E Curb  
16 Trans

N01°27'11"E  
273.25  
Const Type B-2 Curb  
End AC Dike

RIVERGRADE ROAD  
Toe of Fill

91+96.48 Nbd Collector Rd  
15 Trans

119.63  
N119°30'2"E  
6' LT 91+87.24 Ramp 7-B

AC Dike  
N15°17'5"Flare

NORTHBOUND COLLECTOR RD

95+32.12 Nbd Coll Rd  
100+27.16 Ramp 7-G

119.63  
N119°30'2"E  
6' LT 91+87.24 Ramp 7-B

SYRACUSE AVE.  
N11°16'40"E to 202517 202314

2' iron pipe & pile on E Sta. 1802+48.99  
E.C. San Gabriel River Fwy. P.I. 1959 L.C.  
Elev. 295.48'

119.63  
N119°30'2"E  
6' LT 91+87.24 Ramp 7-B

SYRACUSE AVE.  
N13°35'57"E

119.63  
N119°30'2"E  
6' LT 91+87.24 Ramp 7-B

119.63  
N119°30'2"E  
6' LT 91+87.24 Ramp 7-B

119.63  
N119°30'2"E  
6' LT 91+87.24 Ramp 7-B

119.63  
N119°30'2"E  
6' LT 91+87.24 Ramp 7-B

119.63  
N119°30'2"E  
6' LT 91+87.24 Ramp 7-B

119.63  
N119°30'2"E  
6' LT 91+87.24 Ramp 7-B

119.63  
N119°30'2"E  
6' LT 91+87.24 Ramp 7-B

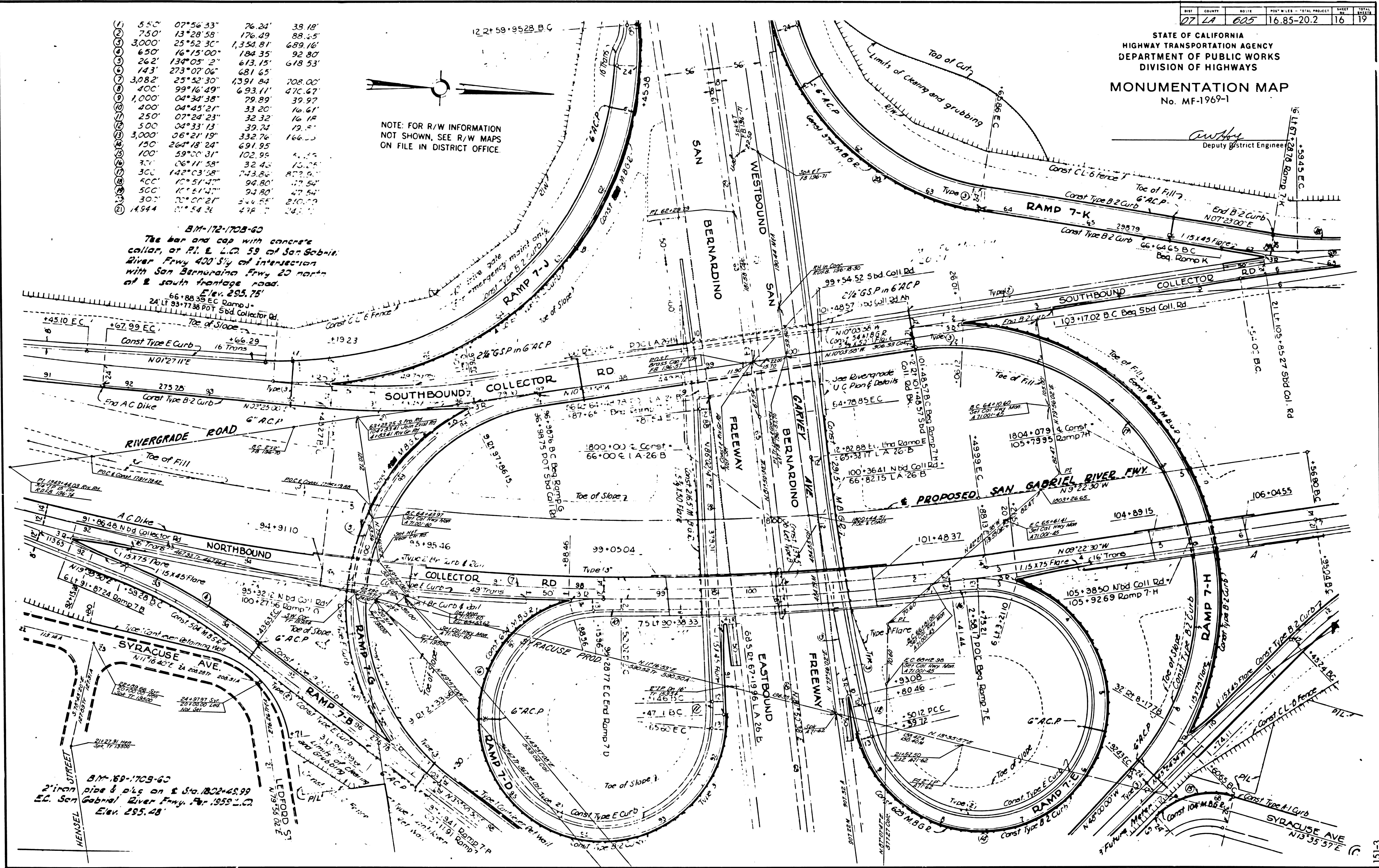



DATE	COUNTY	NO. 12	POST MILES	TOTAL PROJECT	SHEET NO.	TOTAL SHEETS
07 LA	605		16.85-20.2		17	19

STATE OF CALIFORNIA  
HIGHWAY TRANSPORTATION AGENCY  
DEPARTMENT OF PUBLIC WORKS  
DIVISION OF HIGHWAYS

**MONUMENTATION MAP**  
No. MF-1969-2

**CURVE DATA**

R	Δ	L	T
2,000'	02°44'53"	49.51	47.91
2,000'	02°32'47"	39.95	34.47
1,000'	05°31'20"	76.38	38.25
1,000'	04°12'19"	77.35	36.65
50'	32°09'15"	8.56	14.41
50'	32°58'43"	21.80	11.07
3,000'	01°52'20"	101.52	50.76
50'	29°40'54"	25.29	13.29
50'	27°50'11"	23.56	11.57

NOTE: FOR R/W INFORMATION NOT SHOWN, SEE R/W MAPS ON FILE IN DISTRICT OFFICE

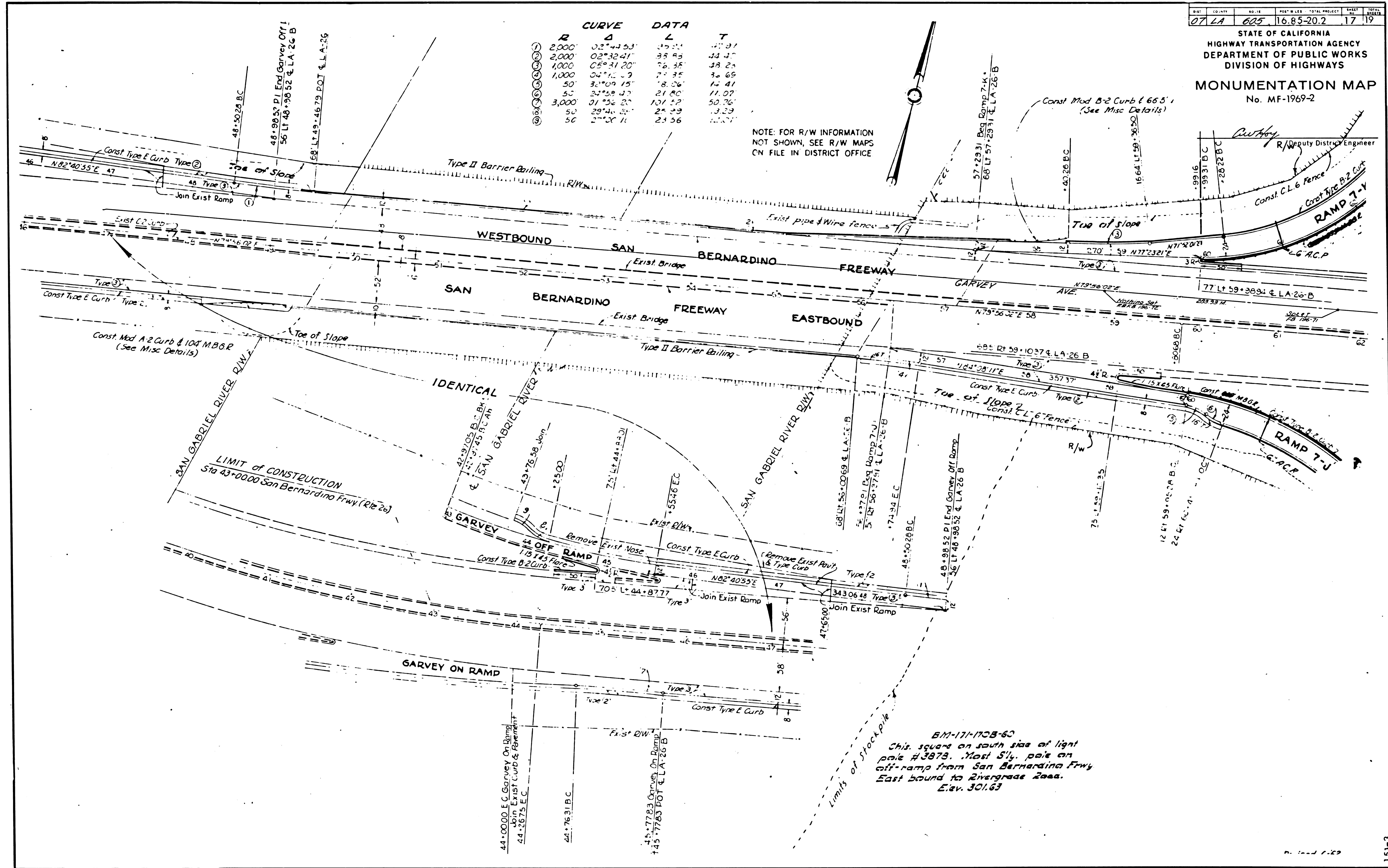
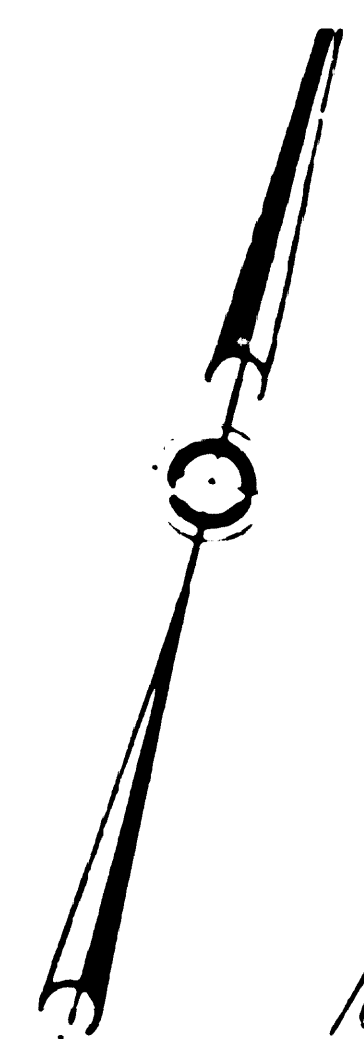

BM-171-170B-60  
This square on south side of light pole #3878. Most 5/4 pole on off-ramp from San Bernardino Fwy East bound to Rivergrade Road. Elev. 301.63



NOTE: FOR R/W INFORMATION  
 NOT SHOWN, SEE R/W MAPS  
 ON FILE IN DISTRICT OFFICE.

**END OF PROJECT**  
 STA. 1819 + 72.33 SAN GABRIEL &

*awh*  
 Deputy District Engineer

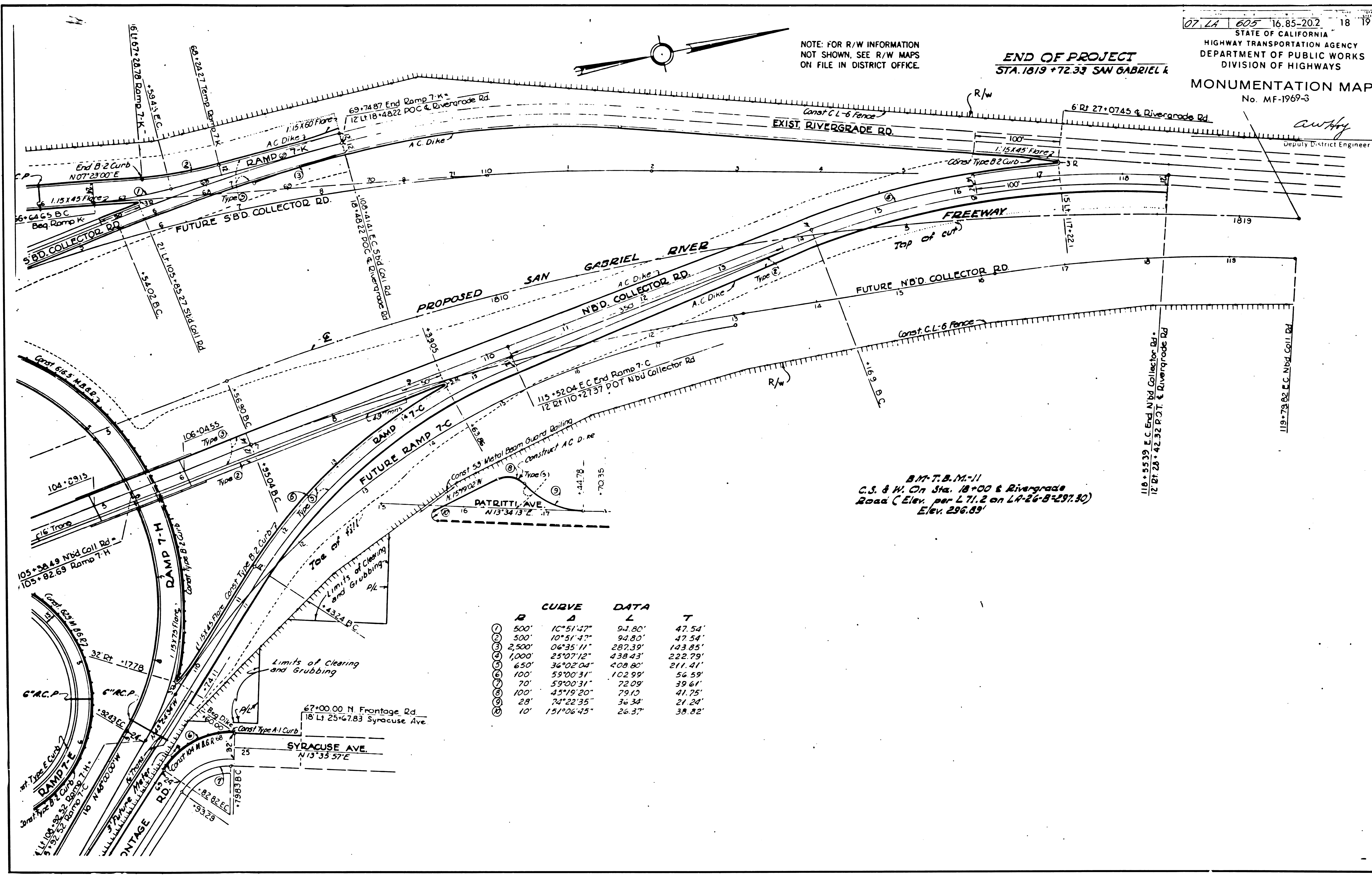

B.M. T.B.M.-11  
 C.S. & W. On Sta. 18+00 & Rivergrade  
 Road (Elev. per L 71.2 on LA-26-B-297.30)  
 Elev. 296.89'

	B	A	L	T
①	500'	10°51'47"	94.80'	47.54'
②	500'	10°51'47"	94.80'	47.54'
③	2,500'	06°35'11"	287.39'	143.85'
④	1,000'	25°07'12"	438.43'	222.79'
⑤	650'	36°02'04"	408.80'	211.41'
⑥	100'	59°00'31"	102.99'	54.59'
⑦	70'	59°00'31"	72.09'	39.61'
⑧	100'	45°19'20"	79.10'	41.75'
⑨	28'	74°22'35"	36.34'	21.24'
⑩	10'	151°06'45"	26.37'	38.82'



DIST.	COUNTY	NO. 111	POST MILES - TOTAL PROJECT	SHEET NO.	TOTAL SHEETS
07	LA	605	16.85-20.2	19	19

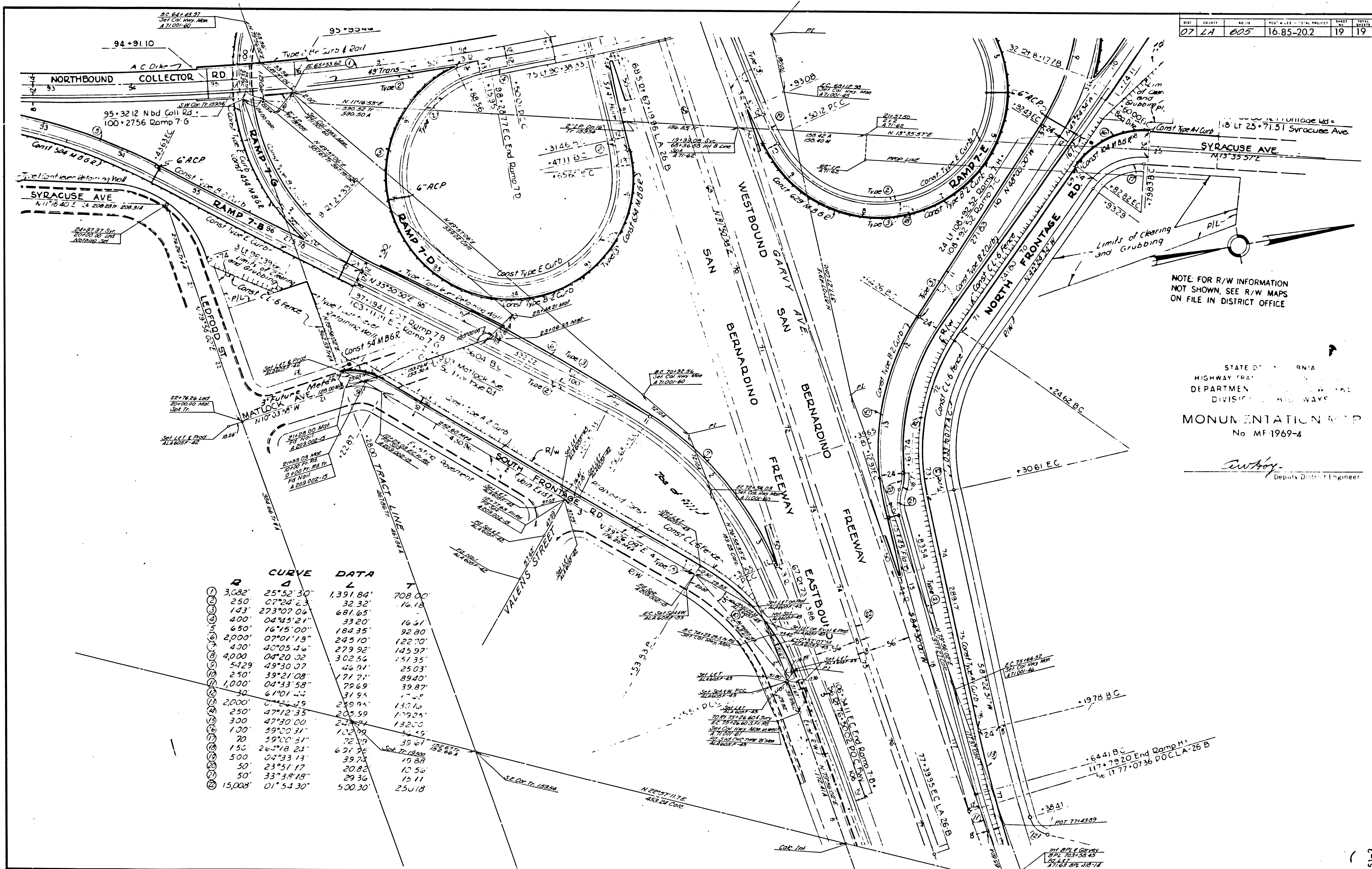

NOTE: FOR R/W INFORMATION NOT SHOWN, SEE R/W MAPS ON FILE IN DISTRICT OFFICE

STATE OF CALIFORNIA  
 HIGHWAY TRANSPORTATION  
 DEPARTMENT  
 DIVISION OF HIGHWAYS  
 MONUMENTATION MAP  
 No. MF-1969-4

*Swaby*  
 Deputy District Engineer

R	Δ	L	T
3,082'	25°52'30"	1,391.84'	708.00'
250'	07°24'23"	32.32'	16.18'
143'	273°07'06"	681.65'	
400'	04°45'21"	83.20'	16.41'
650'	16°15'00"	184.35'	92.80'
2,000'	07°01'13"	245.10'	122.70'
400'	40°05'46"	279.92'	145.97'
4,000'	04°20'32"	302.52'	151.35'
54.29'	49°30'07"	46.01'	25.03'
250'	39°21'08"	171.71'	89.40'
1,000'	04°33'58"	79.69'	39.87'
30'	6°10'14"	31.95'	15.25'
2,000'	07°24'23"	289.94'	137.10'
250'	47°12'35"	209.59'	109.25'
300'	47°30'00"	247.71'	132.20'
100'	59°20'31"	102.89'	64.49'
70'	59°20'31"	72.19'	39.61'
150'	26°18'25"	671.96'	342.80'
500'	04°33'13"	39.74'	19.88'
50'	23°51'17"	20.82'	10.50'
50'	33°38'18"	29.36'	15.11'
15,008'	01°54'30"	500.30'	250.18'