

SHEET	COUNTY	ROUTE	POST MILES - TOTAL PROJECT	SHEET NO.	TOTAL SHEETS
7	LA	11	4.06-7.74	1	14

STATE OF CALIFORNIA  
HIGHWAY TRANSPORTATION AGENCY  
DEPARTMENT OF PUBLIC WORKS  
DIVISION OF HIGHWAYS

### MONUMENTATION MAP

No. MF-1344-1

*C. W. H. H.*  
Deputy District Engineer

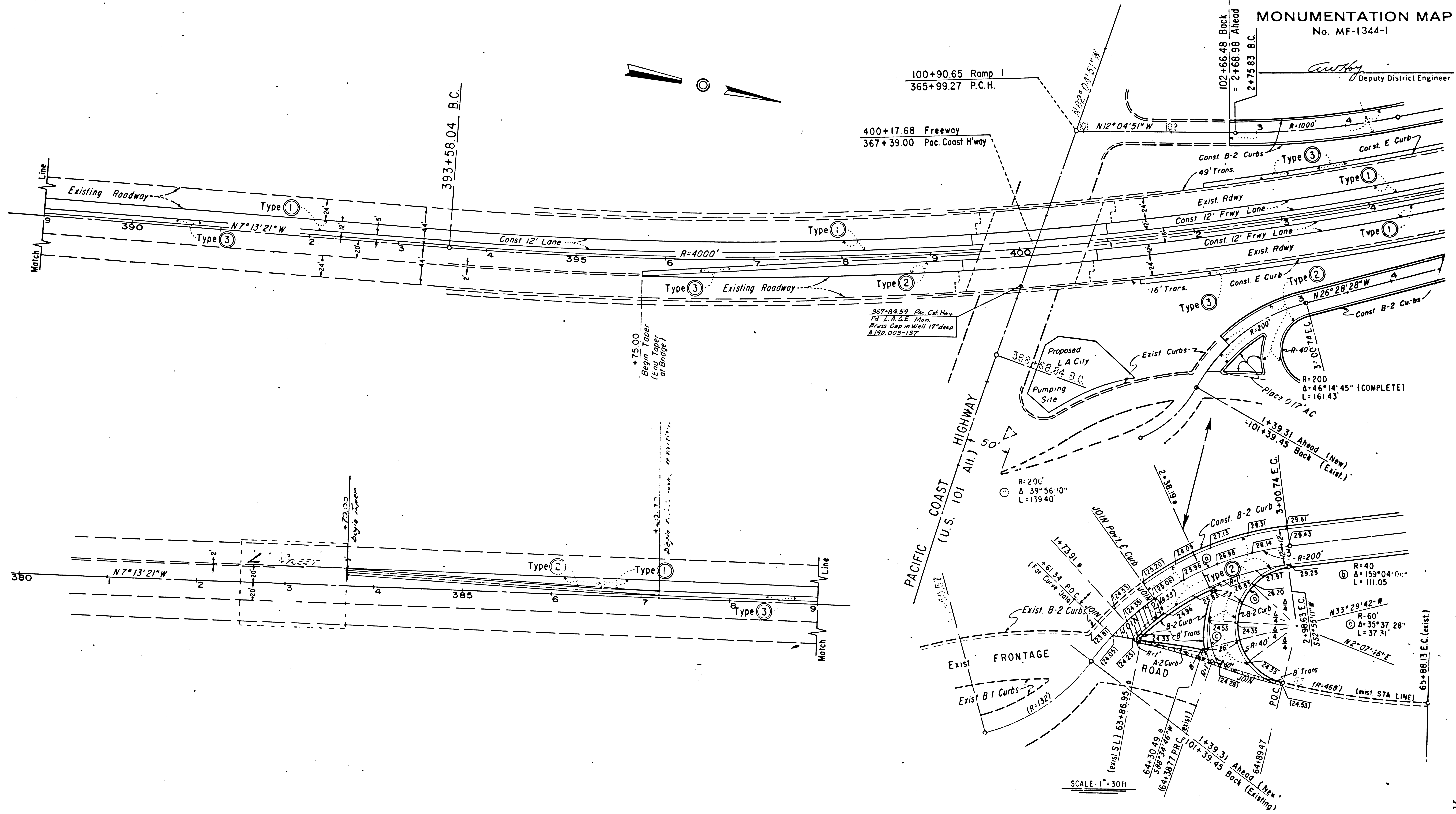

F.M.20426 -SHT. 1

DIST	COUNTY	ROUTE	POST MILES - TOTAL PROJECT	SHEET NO.	TOTAL SHEETS
7	LA	11	4.06-7.74	2	14

STATE OF CALIFORNIA  
HIGHWAY TRANSPORTATION AGENCY  
DEPARTMENT OF PUBLIC WORKS  
DIVISION OF HIGHWAYS  
MONUMENTATION MAP  
No. MF-1344-2

*C. W. Kelly*  
Deputy District Engineer

CITY OF LOS ANGELES

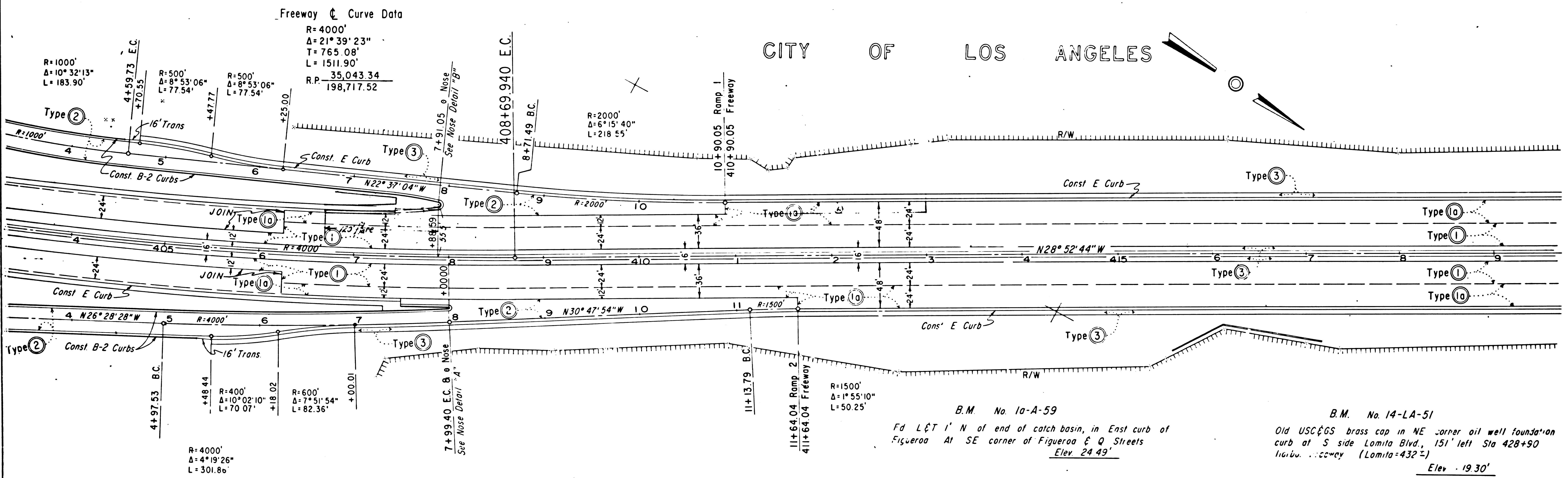

Freeway Curve Data

R=4000'  
Δ=21°39'23"  
T=765.08'  
L=1511.90'  
R.P. 35,043.34  
198,717.52

R=4000'  
Δ=4°19'26"  
L=301.86'

B.M. No. 10-A-59  
Fd L&T 1' N of end of catch basin, in East curb of  
Figueroa At SE corner of Figueroa & Q Streets  
Elev. 24.49'

B.M. No. 14-LA-51  
Old USCGS brass cap in NE corner oil well foundation  
curb at S side Lomita Blvd., 151' left Sta 428+90  
Lomita Ave. (Lomita=432±)  
Elev. 19.30'

SHEET NO.	COUNTY	ROUTE	POST MILES - TOTAL PROJECT	SHEET TOTAL SHEETS
7	LA	11	4.06-7.74	3 14

STATE OF CALIFORNIA  
HIGHWAY TRANSPORTATION AGENCY  
DEPARTMENT OF PUBLIC WORKS  
DIVISION OF HIGHWAYS  
**MONUMENTATION MAP**  
No. MF-1344-3

*Anthony*  
Deputy District Engineer

CITY OF LOS ANGELES

Freeway  $\frac{1}{2}$  Curve Data  
R=2400'  
 $\Delta=11^{\circ}29'23''$   
T=241.45'  
L=481.28'  
RP 37,047.91  
199,439.14

Freeway E.P. Curve Data  
R=2300'  $\Delta=11^{\circ}29'23''$  T=231.39' L=461.23'  
R=2500'  $\Delta=11^{\circ}29'23''$  T=251.51' L=501.33'

Freeway  $\frac{1}{2}$  Curve Data  
R=2400'  
 $\Delta=51^{\circ}00'00''$   
T=1,144.74'  
L=2,136.28'  
RP 40,452.37  
202,845.03

B.M. — 14-LA-51  
Old USC&GS brass cap in NE cor oil well foundation curb at  
S side Lomita Blvd., 151' left Sta 428+90 Harbor Fwy.  
(Lomita = 432' ±).  
Elev = 19.30'

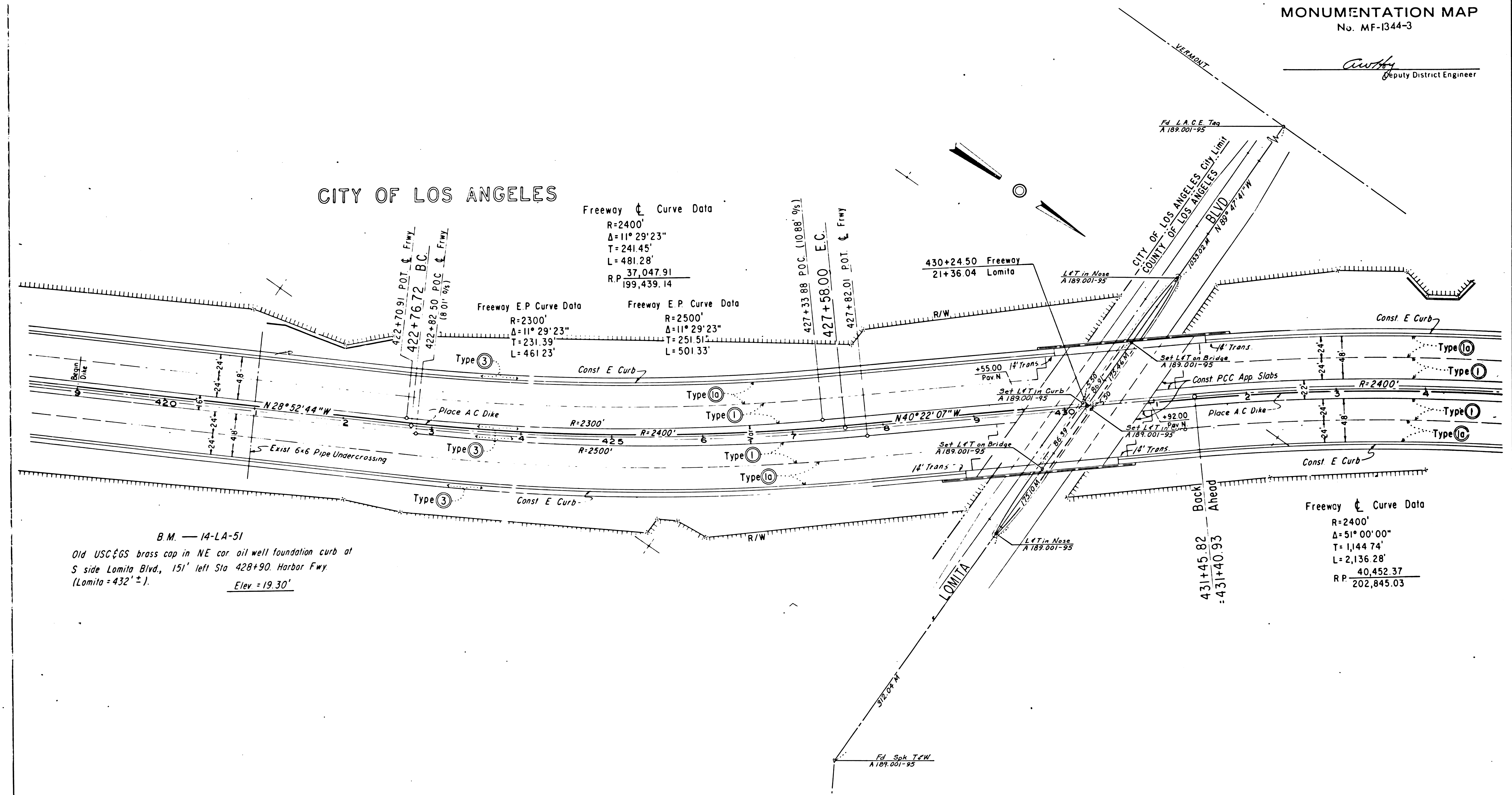

139-15

F.M.20426 -SHT.3