

CITY OF LOS ANGELES

7	LA	2	14.21-15.7	1	11
---	----	---	------------	---	----

STATE OF CALIFORNIA
HIGHWAY TRANSPORTATION AGENCY
DEPARTMENT OF PUBLIC WORKS
DIVISION OF HIGHWAYS

MONUMENTATION MAP No. MF-1264-1

C. W. H. H.
Deputy District Engineer

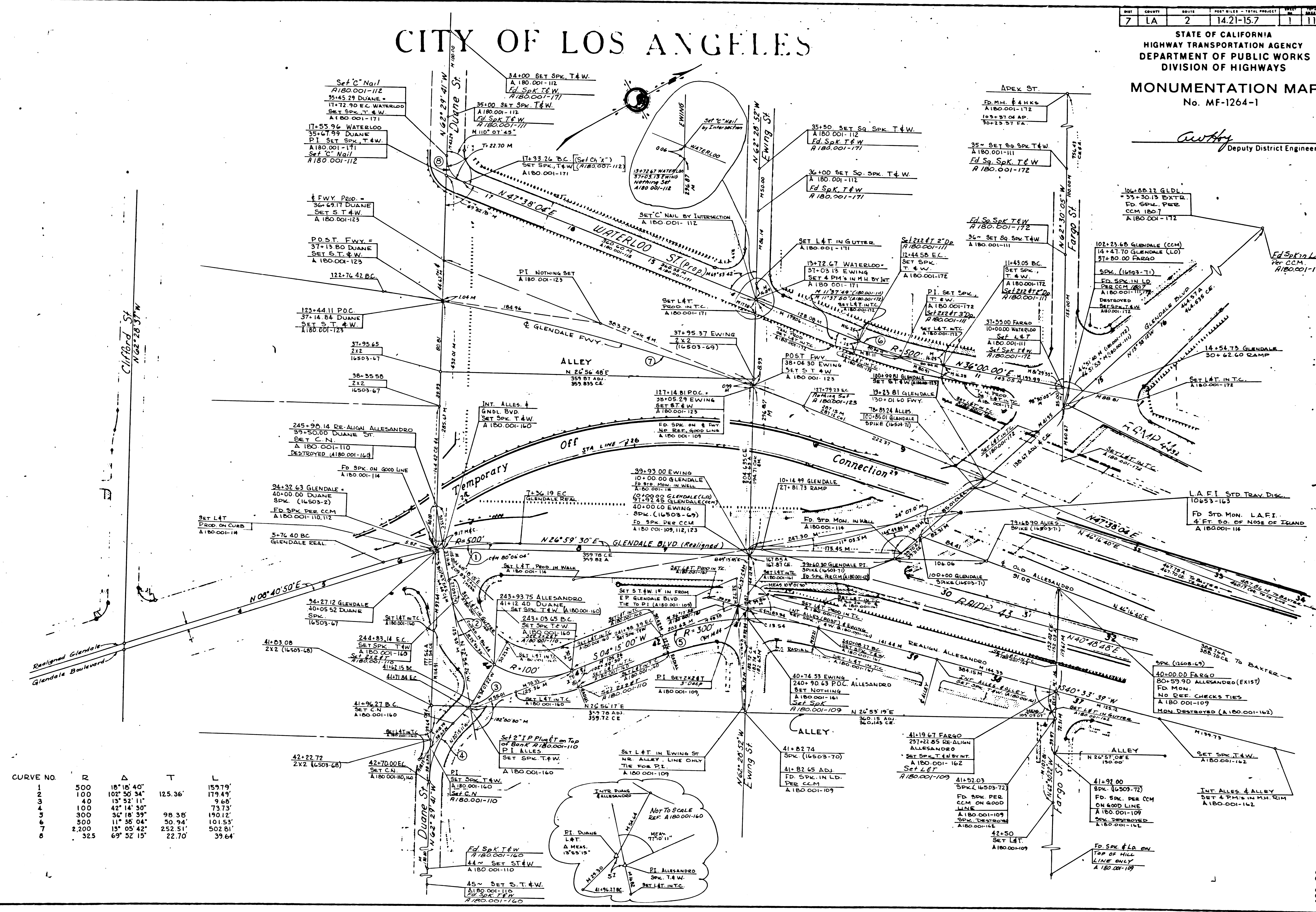

CURVE NO.	R	Δ	T	L
1	500	18° 15' 40"		159.79'
2	100	102° 50' 34"	125.36'	179.49'
3	40	13° 52' 11"		9.68'
4	100	42° 14' 30"		73.73'
5	300	34° 18' 39"	98.38'	190.12'
6	500	11° 56' 04"	50.94'	101.53'
7	2,200	13° 05' 42"	252.51'	502.81'
8	325	69° 32' 15"	22.70'	39.64'

SHEET	COUNTY	ROUTE	POST MILES - TOTAL PROJECT	SHEET	TOTAL SHEETS
7	LA	2	14.21-15.7	2	11

STATE OF CALIFORNIA
HIGHWAY TRANSPORTATION AGENCY
DEPARTMENT OF PUBLIC WORKS
DIVISION OF HIGHWAYS
MONUMENTATION MAP
No. MF-1264-2

Anthony
Deputy District Engineer

CITY OF LOS ANGELES

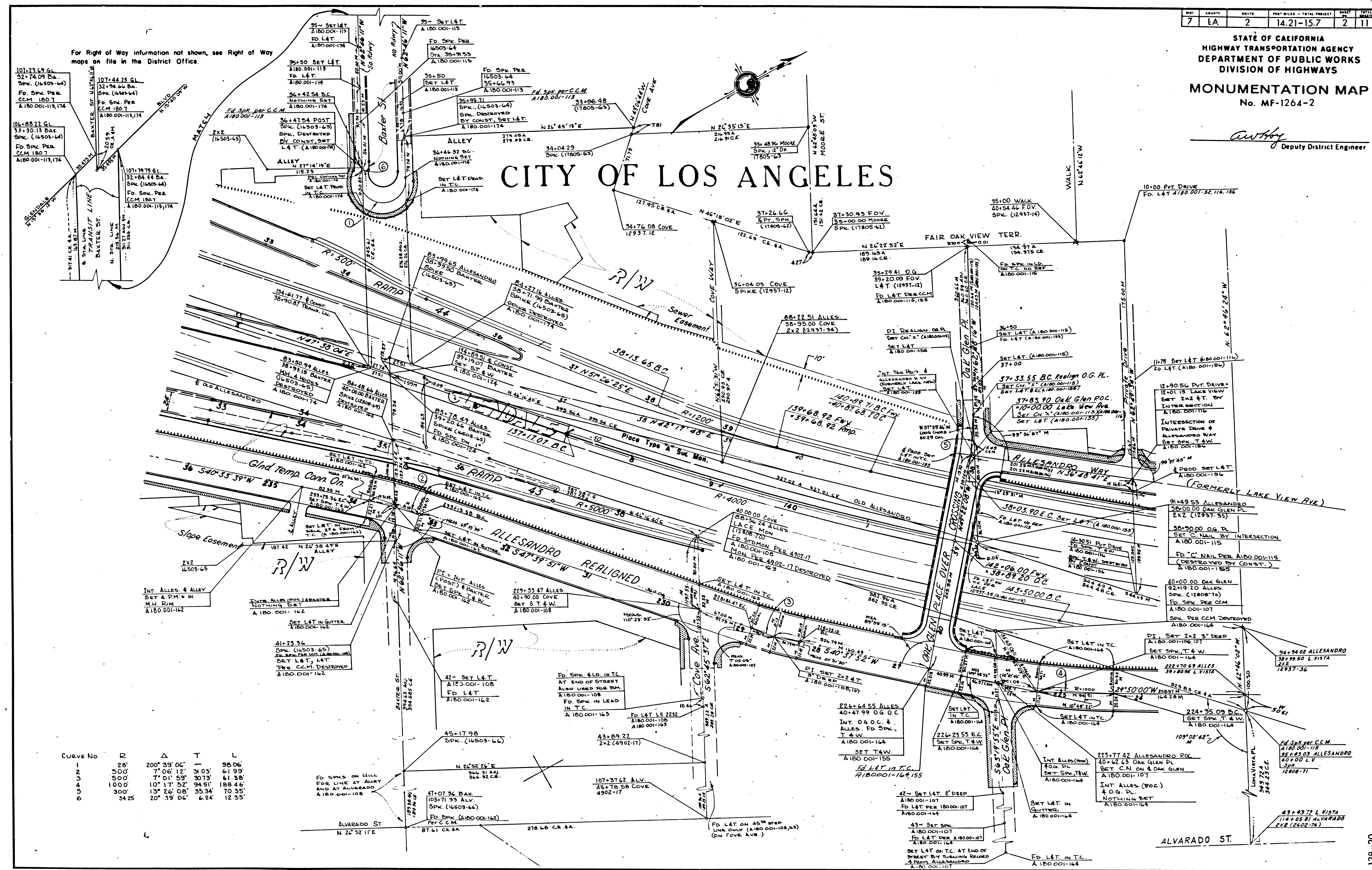

For Right of Way information not shown, see Right of Way maps on file in the District Office.

CURVE NO.	R	Δ	T	L
1	28'	200° 39' 06"	—	98.06'
2	500'	7° 06' 12"	31.03'	61.99'
3	500'	7° 01' 59"	30.79'	61.38'
4	1000'	10° 17' 52"	94.51'	188.46'
5	300'	13° 26' 08"	35.34'	70.35'
6	3425'	20° 39' 06"	6.24'	12.35'