

**LEGEND**  
 Existing Fence  
 Const. Freeway Fence  
 (Type BW except where noted Type CL-5 or 36"CL)

B.M. 188-2LAC-58  
 Fd brass in conc. 187+95.53 E.C.  
 188+05.53 E.C. x 80.0 So. of Ventura  
 ELEV 782.450

B.M. 191-2LAC-58  
 Fd chis sq on N.E. cor of D.I.  
 83' ± E. of P.I. of Ventura &  
 Las Virgenes Rd.  
 ELEV 775.70

Deputy District Engineer  
 191 83 86 POT P\*  
 E.D. CASEY (A13001-83)  
 R.N. 106-38  
 50077 Highway 101  
 City of Newport Beach  
 (L-131-3)  
 E.I. 77240

7	LA	101	30.94	31.20	2	2
---	----	-----	-------	-------	---	---

STATE OF CALIFORNIA  
HIGHWAY TRANSPORTATION AGENCY  
DEPARTMENT OF PUBLIC WORKS  
DIVISION OF HIGHWAYS  
**MONUMENTATION MAP**  
No. MF-2216-2

*awh*  
Deputy District Engineer

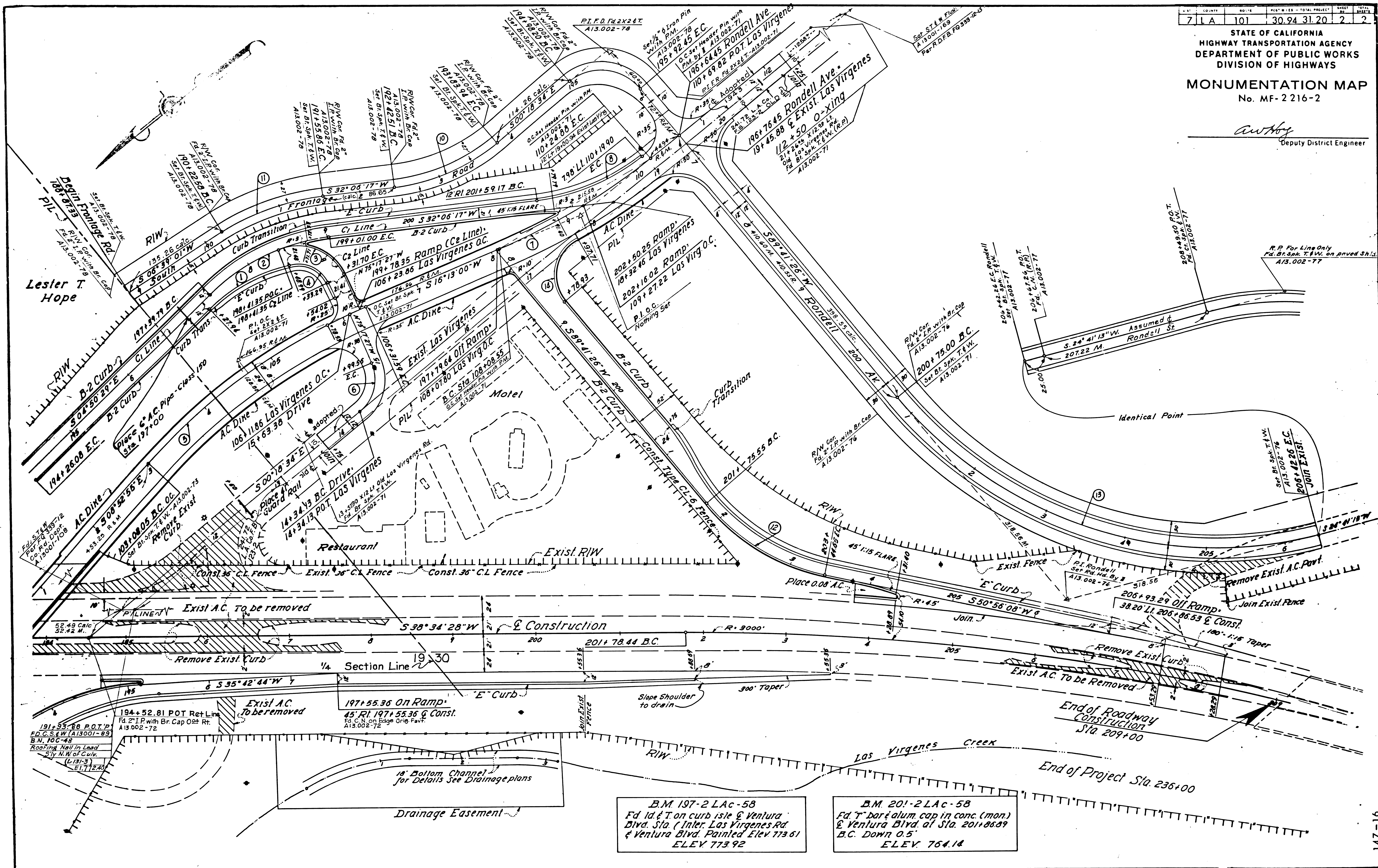

B.M. 197-2 L.A.C.-58  
Fd. Id. & T. on curb isle & Ventura  
Blvd. Sta. (Inter. Las Virgenes Rd.  
& Ventura Blvd. Painted Elev 773.61  
ELEV 773.92

B.M. 201-2 L.A.C.-58  
Fd. T-bar & alum. cap in conc. (mon)  
& Ventura Blvd. at Sta. 201+66.9  
B.C. Down 0.5'  
ELEV 764.14