

DIST.	COUNTY	ROUTE	POST MILES - TOTAL PROJECT	SHEET NO.	TOTAL SHEETS
7	LA	23	43.29-47.34	5	7

STATE OF CALIFORNIA
HIGHWAY TRANSPORTATION AGENCY
DEPARTMENT OF PUBLIC WORKS
DIVISION OF HIGHWAYS
MONUMENTATION MAP
No. MF-1065-1

C. W. H. J.
Deputy District Engineer

NOTE
For continuation of monumentation
see Inset Sh. et 4.

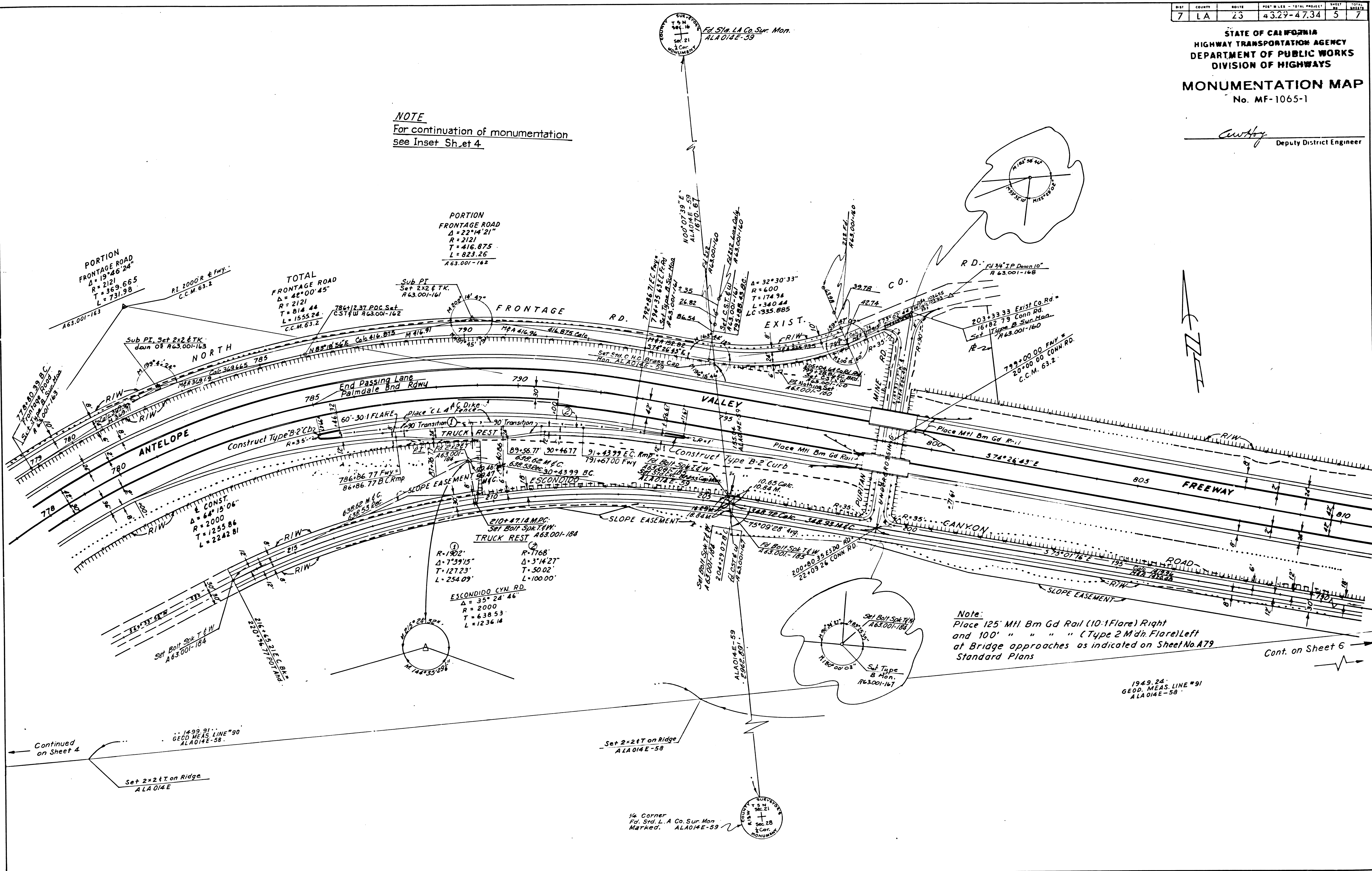

Note:
Place 125' M.H. Bm Gd Rail (10:1 Flare) Right
and 100' " " " (Type 2 M'dh Flare) Left
at Bridge approaches as indicated on Sheet No. A79
Standard Plans

1949.24
GEOD. MEAS. LINE #91
ALA 014E-58

DIST	COUNTY	ROUTE	POST MILES - TOTAL PROJECT	SHEET	TOTAL SHEETS
7	LA	14	43.29-47.34	6	7

STATE OF CALIFORNIA
HIGHWAY TRANSPORTATION AGENCY
DEPARTMENT OF PUBLIC WORKS
DIVISION OF HIGHWAYS

MONUMENTATION MAP
No. MF-1065-2
1065 2

C. W. H. H.
Deputy District Engineer

NOTE
For continuation of monumentations
see Insets Sheets 4 and 7

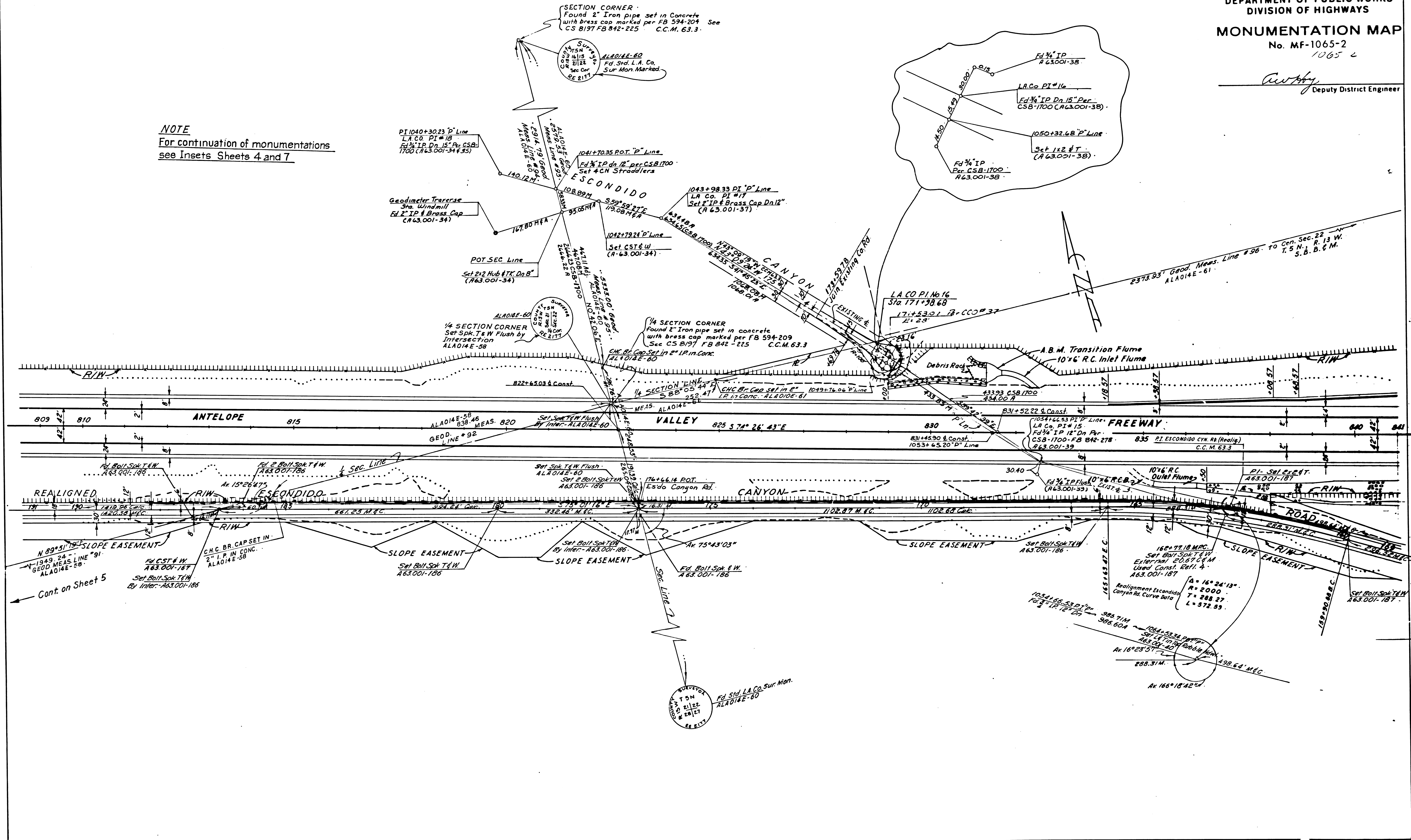

F.M.20826 -SHT. 2

145-18

STATE OF CALIFORNIA
HIGHWAY TRANSPORTATION AGENCY
DEPARTMENT OF PUBLIC WORKS
DIVISION OF HIGHWAYS
MONUMENTATION MAP
No. MF-1065-3

Anthony
Deputy District Engineer

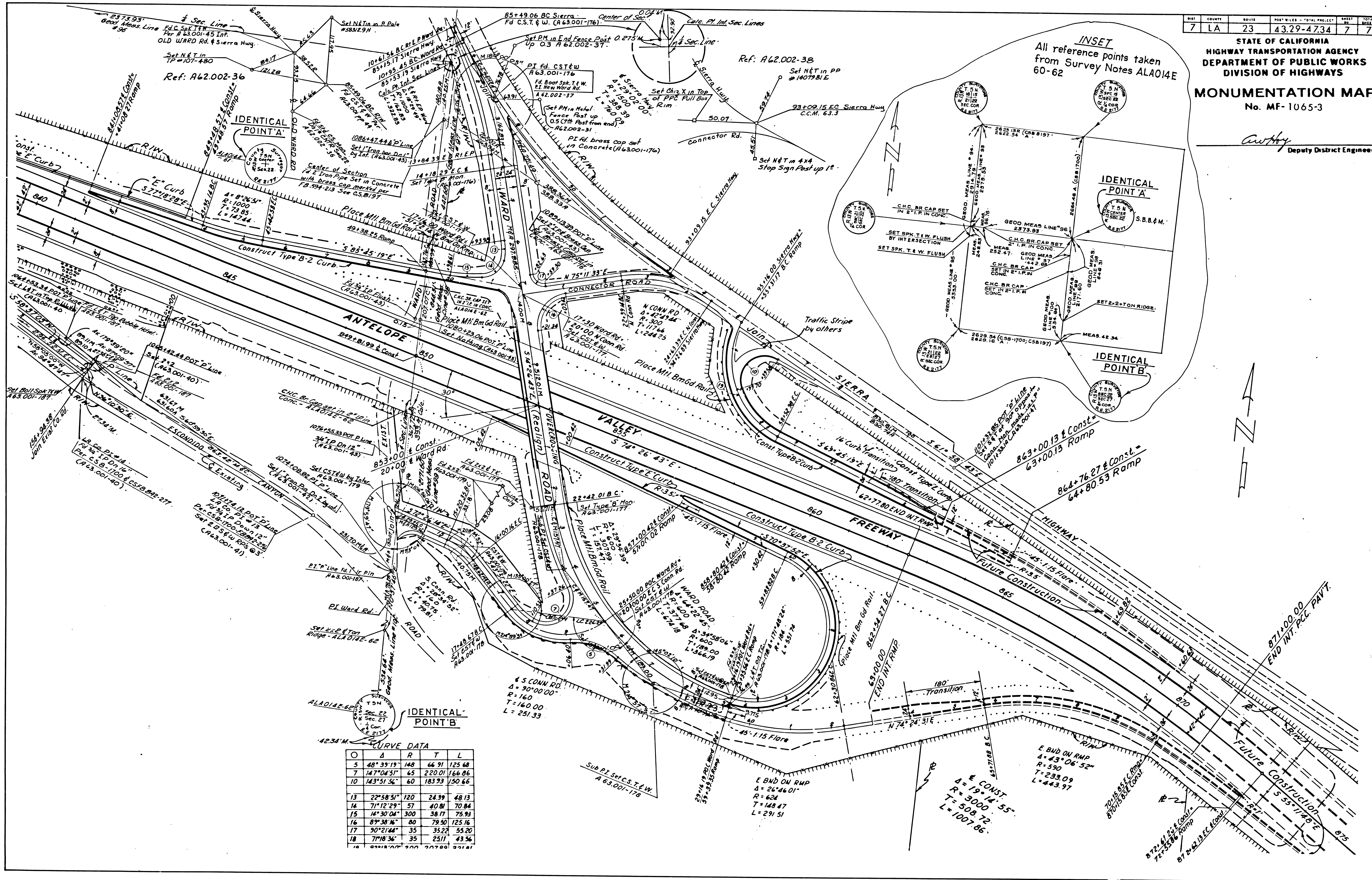

12.34' M.

Station	Δ	R	T	L
5	48° 39' 19"	148	66.91	125.68
7	147° 04' 51"	65	220.01	166.86
10	143° 51' 36"	60	183.93	150.66
13	22° 58' 51"	120	24.39	48.13
14	71° 12' 29"	57	40.81	70.84
15	14° 30' 04"	300	38.77	75.93
16	89° 38' 16"	80	79.50	125.16
17	90° 21' 44"	35	35.22	55.20
18	71° 18' 36"	35	25.17	43.56