

DIST.	COUNTY	NO. IN	PLAN NO.	TOTAL PROJECT	SHEET	TOTAL SHEETS
7	LA	14	4304	5458	1	26

STATE OF CALIFORNIA
 TRANSPORTATION AGENCY
 DEPARTMENT OF PUBLIC WORKS
 DIVISION OF HIGHWAYS
MONUMENTATION MAP
 No. MF-1066 1

Anthony
 Deputy District Engineer

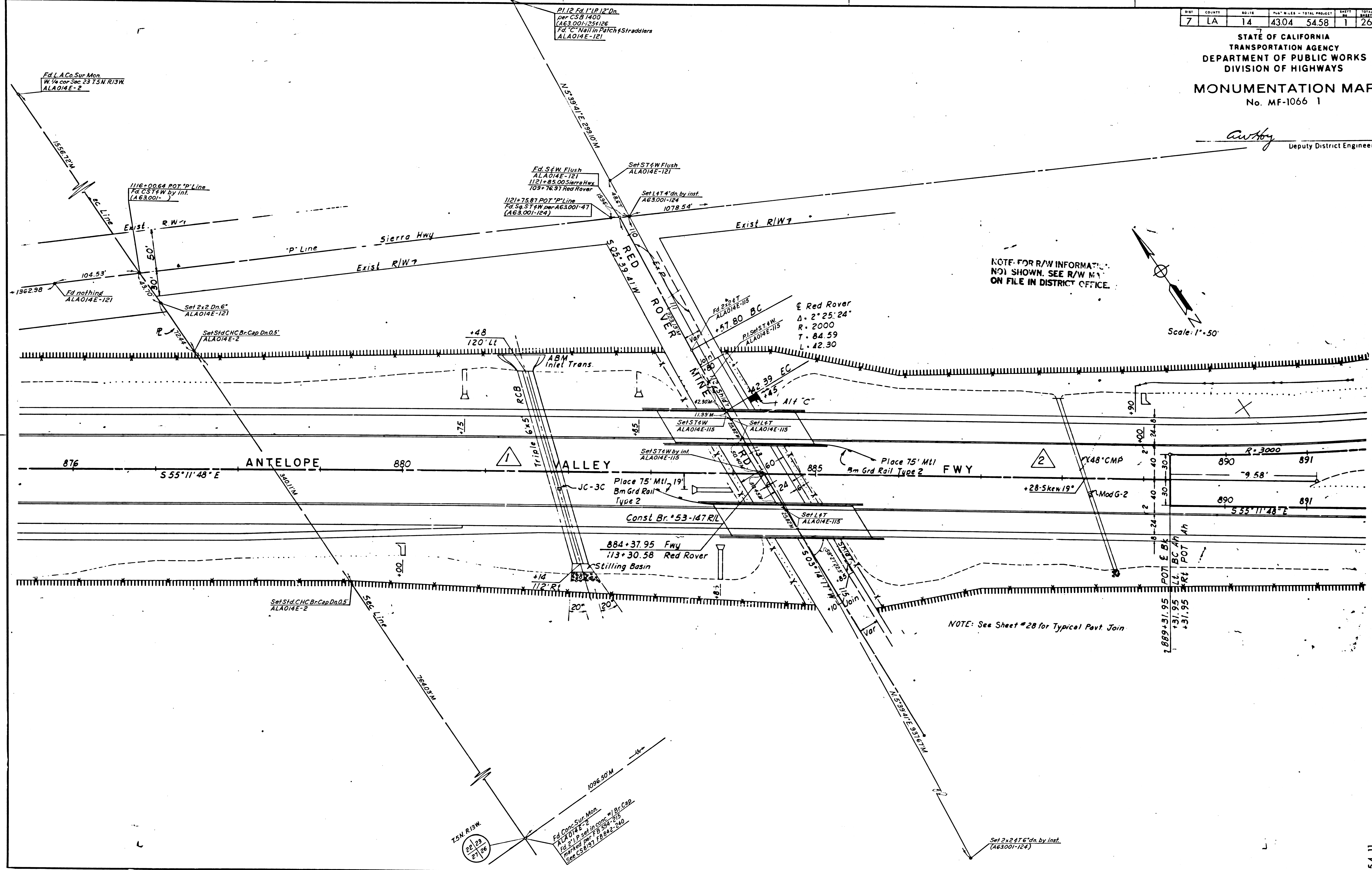

F.M. 20873 SHT. 1

154 11

SHEET NO.	COUNTY	ROUTE	POST MILES	TOTAL PROJECT	SHEET NO.	TOTAL SHEETS
7	LA	14	43.04	54.58	2	26

STATE OF CALIFORNIA
 TRANSPORTATION AGENCY
 DEPARTMENT OF PUBLIC WORKS
 DIVISION OF HIGHWAYS
MONUMENTATION MAP
 No. MF-1066 2

Anthony
 Deputy District Engineer

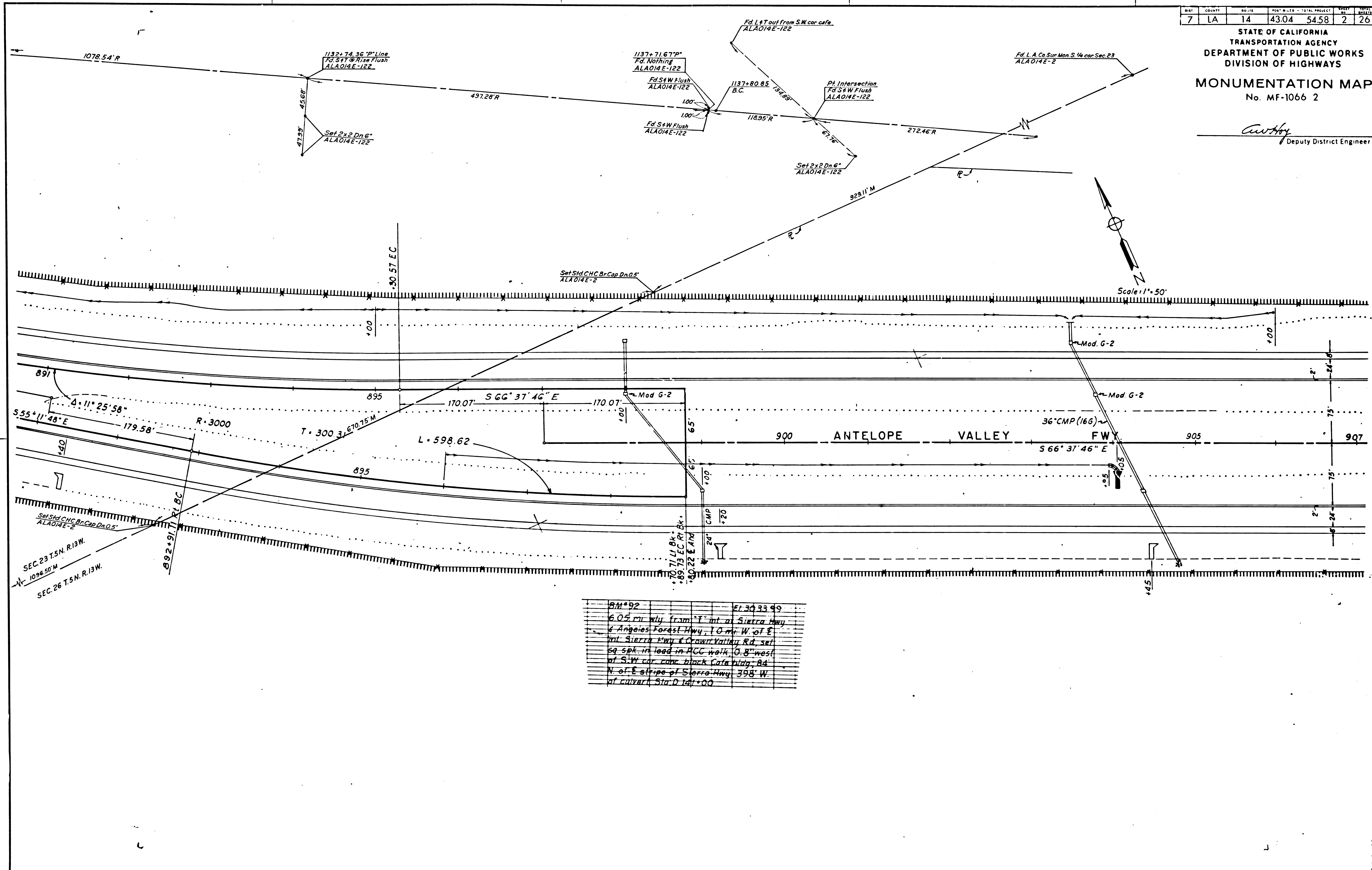

BM#92
 6.05 mi wly from Int at Sierra Hwy
 & Angeles Forest Hwy, 10 mi W of E
 mt Sierra Hwy & Crown Valley Rd, set
 sq spk in load in ACC walk 0.8' west
 of S.W. cor. conc block Cota hdy, Bd
 N. of E stripe of Sierra Hwy, 398' W
 of curv. Sierra Hwy +00

DIST	COUNTY	ROUTE	POST MILES	TOTAL PROJECT	SHEET	TOTAL SHEETS
7	LA	14	43.04	54.58	3	26

STATE OF CALIFORNIA
 TRANSPORTATION AGENCY
 DEPARTMENT OF PUBLIC WORKS
 DIVISION OF HIGHWAYS
MONUMENTATION MAP
 No. MF-1066 3

Anthony
 Deputy District Engineer

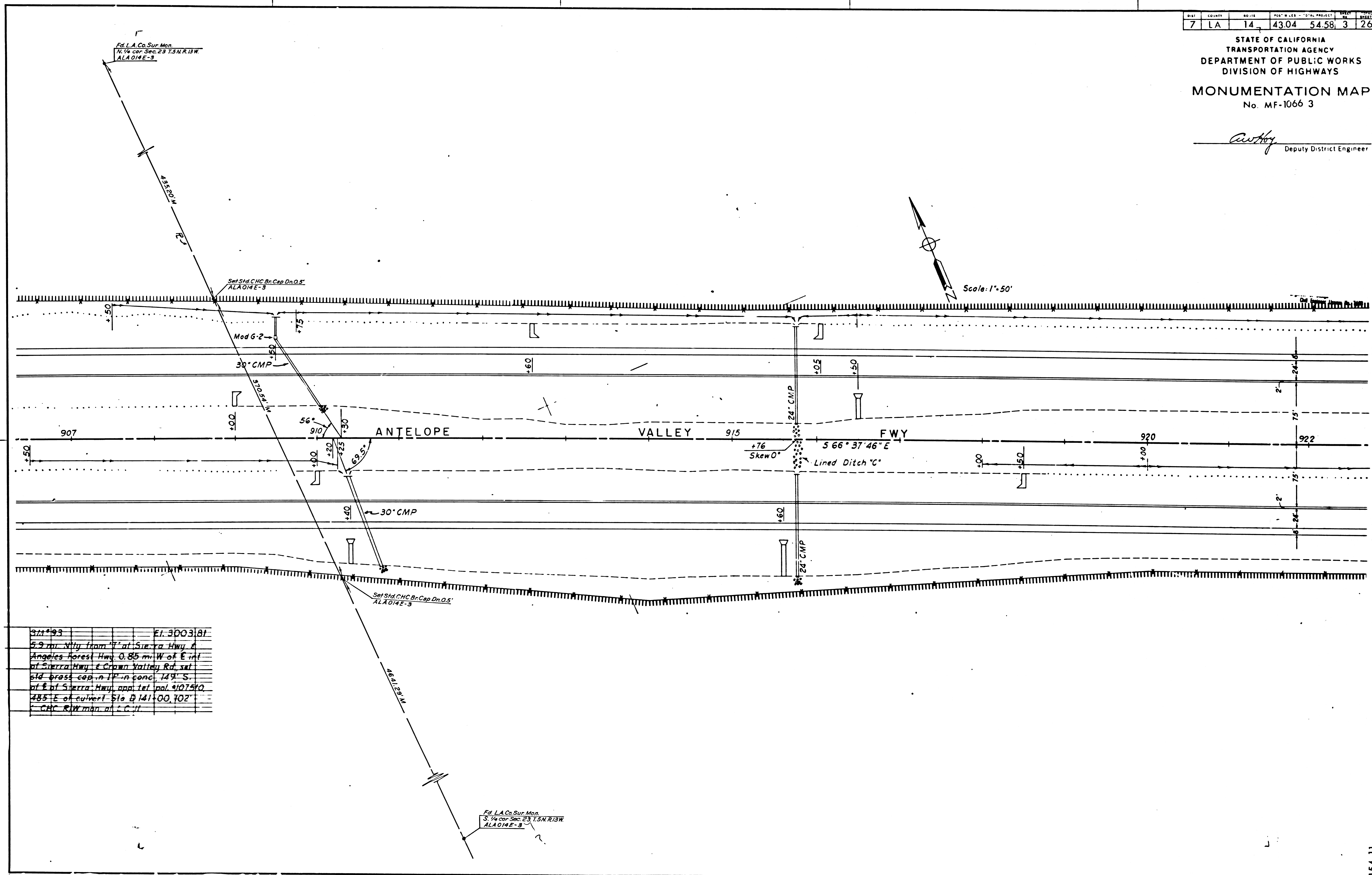

SM 193
 5.9 mi N.W. from "T" at Sierra Hwy. &
 Angeles Forest Hwy. 0.85 mi W of E int
 of Sierra Hwy. & Crown Valley Rd. set
 sta. brass cap. in 1" in conc. 149' S.
 of E of Sierra Hwy. app. 1st. pol. 107510
 485' E of culvert Sta D 141+00, 702'
 C.H.C. R/W man at C.H.

Set Sta. C.H.C. Br. Cap. Dn. O.S.
 ALA 014 E-3

154 11

BLK	COUNTY	ROUTE	POST MILES - TOTAL PROJECT	SHEET NO.	TOTAL SHEETS
7	LA	14	4304 5458	4	26

STATE OF CALIFORNIA
HIGHWAY TRANSPORTATION AGENCY
DEPARTMENT OF PUBLIC WORKS
DIVISION OF HIGHWAYS

MONUMENTATION MAP
No. MF-1066 4
Deputy District Engineer

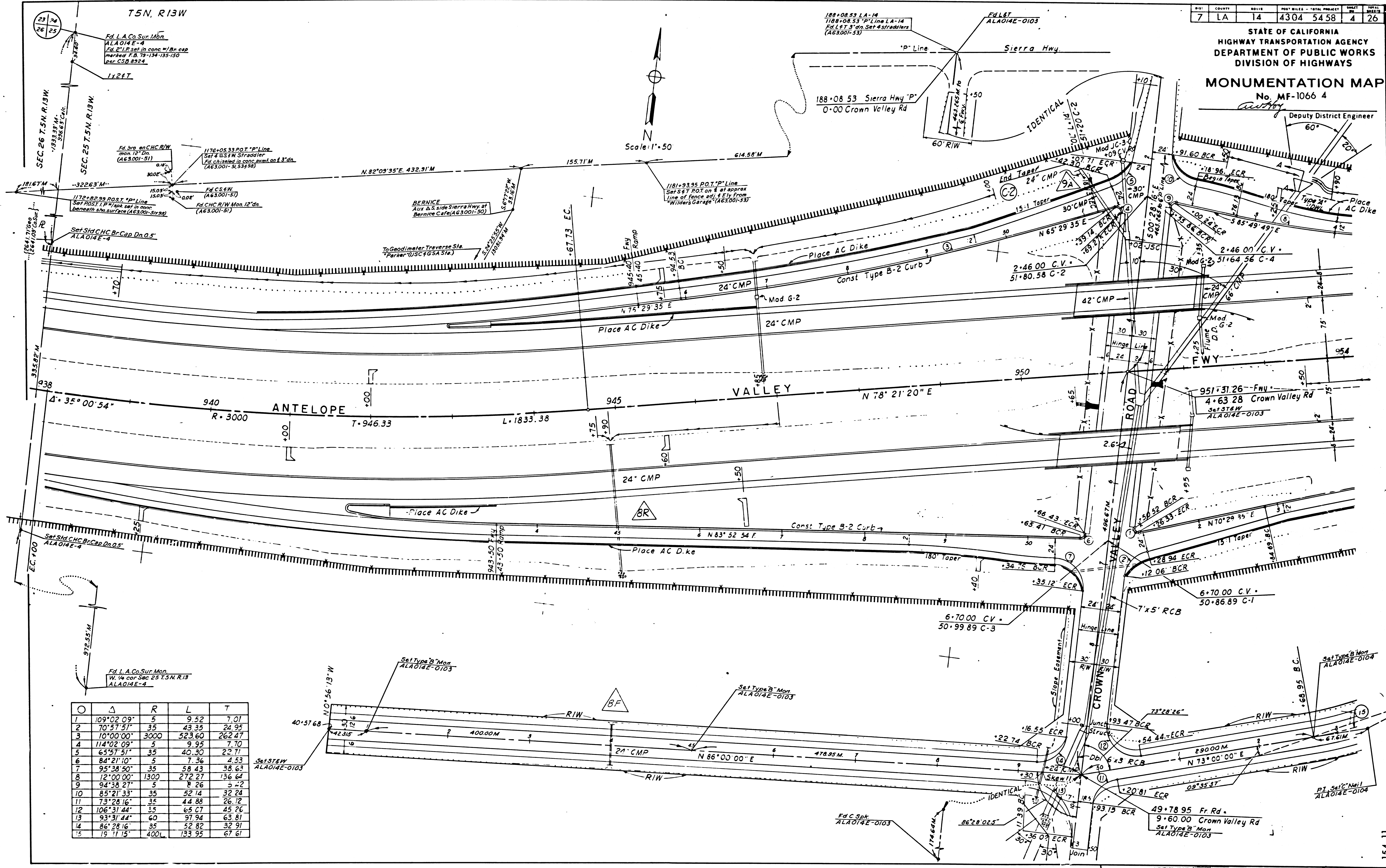

Station	Δ	R	L	T
1	109°02'09"	5	9.52	7.01
2	70°57'51"	35	43.35	24.95
3	10°00'00"	3000	523.60	262.47
4	114°02'09"	5	9.95	7.70
5	65°57'51"	35	40.30	22.71
6	84°21'10"	5	7.36	4.53
7	95°58'50"	35	58.43	38.63
8	12°00'00"	1300	272.27	136.64
9	94°58'21"	5	8.26	5.42
10	85°21'33"	35	52.14	32.24
11	73°28'16"	35	44.88	26.12
12	106°31'44"	35	65.07	45.26
13	93°31'44"	60	97.94	63.81
14	86°28'16"	35	52.82	32.91
15	19°11'15"	400L	133.95	67.61

F.M. 20873 | SHT. 4

154 11