

STATE OF CALIFORNIA
 TRANSPORTATION AGENCY
 DEPARTMENT OF PUBLIC WORKS
 DIVISION OF HIGHWAYS

MONUMENTATION MAP
 No MF-1958-1

Anthony
 Deputy District Engineer

CURVE DATA				
No	R	Δ	T	L
1	10,132.00'	04°53'26"	432.93	865.34'
2	10,000'	14°15'14"	1250.34	2,487.77'
3	200'	04°23'55"	7.68	15.35'
4	2,000'	02°51'45"	49.97	99.92'
5	2,000'	04°23'49"	76.78	153.48'
6	2,000'	03°20'11"	58.25	116.46'
7	200'	68°33'20"	136.32	239.30'
8	207.39'	68°33'20"	141.35	248.15'
9	400'	47°40'28"	176.73	332.83'
10	400'	47°40'28"	176.73	332.83'
11	200'	07°04'54"	12.38	24.72'
12	10,000'	05°06'34"	466.18	891.77'

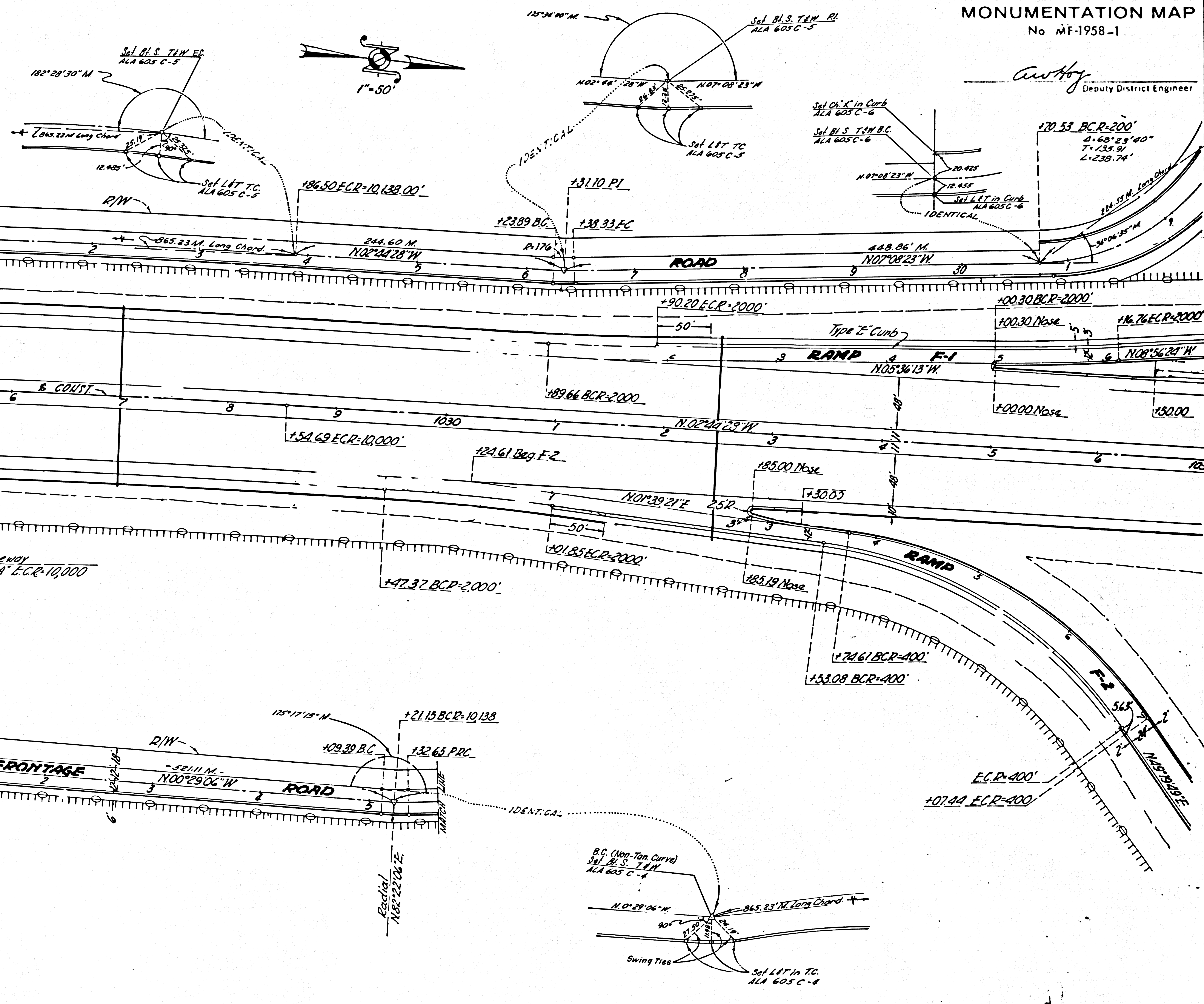

7	LA	605	5.03	8.75	2	18
---	----	-----	------	------	---	----

STATE OF CALIFORNIA
TRANSPORTATION AGENCY
DEPARTMENT OF PUBLIC WORKS
DIVISION OF HIGHWAYS
MONUMENTATION MAP
No. MF-1958-2

Anthony
Deputy District Engineer

CURVE DATA				
No	R	Δ	T	L
1	200'	75°13'39"	154.10'	262.58'
2	35'	81°45'58"	30.30'	49.95'
3	35'	95°12'19"	38.33'	58.16'
4	400'	10°11'23"	35.66'	71.14'
5	83'	36°00'00"	26.97'	52.15'
6	120'	30°07'58"	32.30'	63.11'
7	100'	76°19'21"	78.58'	133.21'
8	900'	11°42'52"	92.33'	184.01'
9	2,000'	02°51'45"	49.97'	99.92'
10	400'	05°00'00"	17.46'	34.91'
11	137'	244°36'16"	-	584.87'
12	150'	259°39'32"	-	679.79'
13	35'	86°43'15"	33.05'	52.98'
14	35'	90°00'00"	35.00'	54.98'
15	150'	30°31'59"	40.94'	79.94'
16	236'	30°31'59"	64.41'	125.77'
17	200'	45°03'58"	82.98'	157.31'
18	134'	35°48'12"	43.29'	83.70'
19	224'	14°31'59"	28.56'	56.82'
20	5'	50°20'11"	2.35'	4.39'
21	150'	35°48'12"	48.45'	93.73'
22	150'	35°48'12"	48.45'	93.73'
23	50'	134°39'01"	120.66'	177.51'
24	30'	99°01'12"	35.14'	51.85'
25	376'	19°08'46"	63.41'	125.65'
26	400'	48°08'52"	178.71'	336.14'
27	200'	07°53'04"	13.80'	27.56'
28	200'	24°53'23"	44.14'	86.88'
29	120'	24°20'22"	25.85'	50.98'
30	200'	18°18'02"	32.24'	63.92'

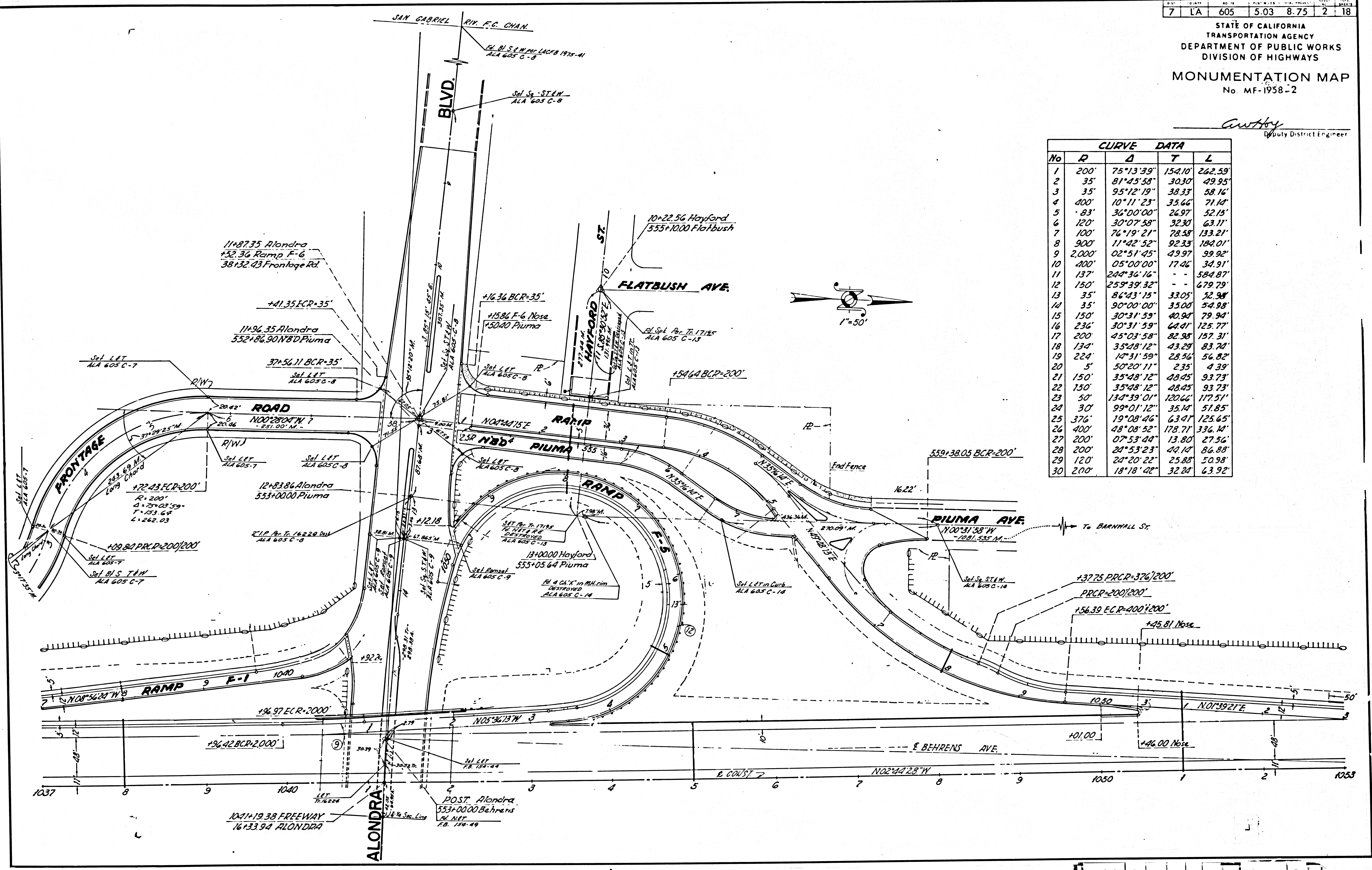
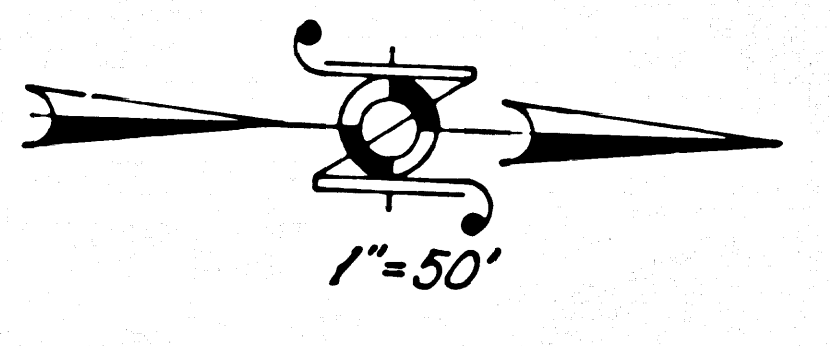

F.M. 20888 SHT. 2

162-9

DIST.	COUNTY	SECTION	POST MILES	TOTAL PROJECT	SHEET NO.	TOTAL SHEETS
7	LA	605	5.03	8.75	3	18

STATE OF CALIFORNIA
TRANSPORTATION AGENCY
DEPARTMENT OF PUBLIC WORKS
DIVISION OF HIGHWAYS
MONUMENTATION MAP
No. MF-1958-3

Anthony
Deputy District Engineer

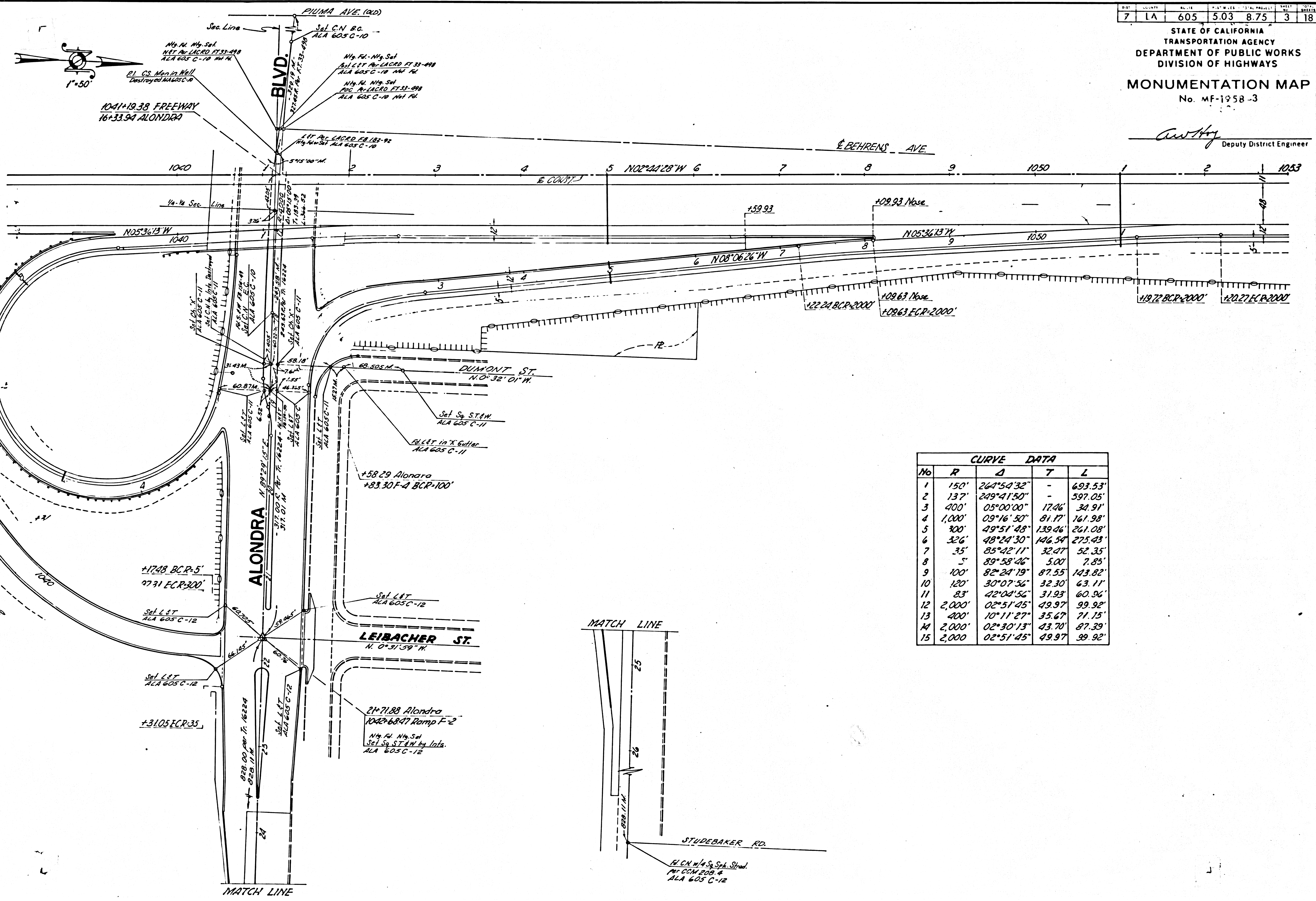

CURVE DATA				
No	R	Δ	T	L
1	150'	26°54'32"	-	693.53'
2	137'	249°41'50"	-	597.05'
3	400'	05°00'00"	17.46'	34.91'
4	1,000'	09°16'50"	81.77'	161.98'
5	300'	49°51'48"	139.46'	261.08'
6	326'	48°24'30"	146.54'	275.43'
7	35'	85°42'11"	32.47'	52.35'
8	5'	89°58'46"	5.00'	7.85'
9	100'	82°24'19"	87.55'	143.82'
10	120'	30°07'56"	32.30'	63.11'
11	83'	42°04'56"	31.93'	60.96'
12	2,000'	02°51'45"	49.97'	99.92'
13	400'	10°11'27"	35.47'	71.15'
14	2,000'	02°30'13"	43.70'	87.39'
15	2,000'	02°51'45"	49.97'	99.92'

6-291

SHEET	COUNTY	NO. 15	POST MILES - TOTAL PROJECT	SHEET NO.	TOTAL SHEETS
7	LA	6057	503 - 0.75	4	18

STATE OF CALIFORNIA
 TRANSPORTATION AGENCY
 DEPARTMENT OF PUBLIC WORKS
 DIVISION OF HIGHWAYS

MONUMENTATION MAP

No. MF-1958-4

Cawley
 Deputy District Engineer

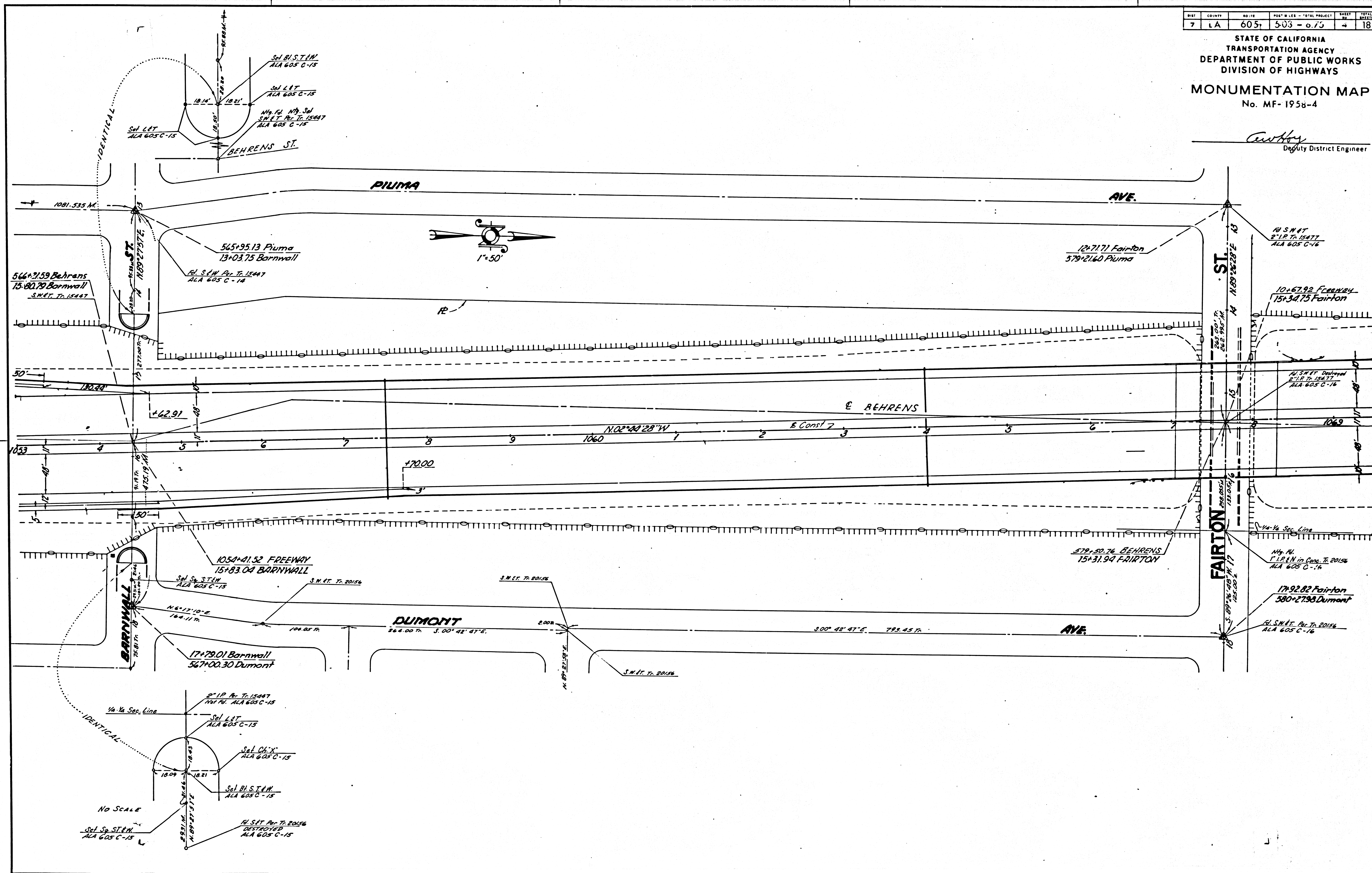

F.M. 2 0 8 8 8 | SHT. 4

DIST	COUNTY	NO. 17	POST MILES - TOTAL PROJECT	SHEET NO.	TOTAL SHEETS
7	LA	605	503 8.75	5	18

STATE OF CALIFORNIA
 TRANSPORTATION AGENCY
 DEPARTMENT OF PUBLIC WORKS
 DIVISION OF HIGHWAYS

MONUMENTATION MAP

No. MF-1958-5

Anthony
 Deputy District Engineer

