

1/4 SECT. COR.
N 2° 15' 30" E 100.00 FT.
S 89° 45' 00" W 100.00 FT.
ALAO 106-021

1/4 SECT. COR.
N 2° 15' 30" E 100.00 FT.
S 89° 45' 00" W 100.00 FT.
ALAO 106-021

1/4 SECT. COR.
N 2° 15' 30" E 100.00 FT.
S 89° 45' 00" W 100.00 FT.
ALAO 106-021

ANGELES FOREST HIGHWAY TO AVE. P-8 IN PALMDALE
L.A.-14 P.M. 54.3 TO P.M. 60.8
L.A.-138 P.M. 43.4 TO P.M. 44.3
Construction Contract 07-035704
Completed 11-1-66

- County Engineer's Field Books
84-4-9, 141; 85-118, 119, 124; 92-41, 82, 83, 84; 1684-124-126, 135
1216-262; 2391-152-156; 163-170
- Road Department Field Books 295-29A-29A-30A
- Tract Maps - 16992; 18150, 18623
- County Surveyors Map (Series B) 395
- Division of Highways Coordinate Control Maps
C.C.M. 64.2 Dec. 1957 Revised Sept. 1963 C.C.M. 65.3 Nov. 1957 Revised June 1963
C.C.M. 86.1 JULY 1957 Revised Sept. 1957
- Division of Highways Field Books
A 64 001-15, 50, 53, 67, 68, 69, 70, 154, 155, 156, 157, 158, 159, 160,
A 65 001-16, 43, 105, 105 A,
A 86 001-44
- ALAO 106 (1966) pages 0210-0246
AUX ALAO 106 (1966) pages 0012-0024
- Division of Highways Map Information.
1. Bearings are taken from C.C.M. 85.3 and are based on the California Coordinate System Zone VII, Sec. 8909 of the Public Resources Code.
- 2. Division of Highways survey information is available from the Engineering Services Department located at 550 South Vermont Ave., Los Angeles, California.
- 3. Division of Highways Right-of-Way information is available from the Right-of-Way Department located at 120 So. Spring St., Los Angeles, California.
- 4. Distances given as "field" can be converted to ground distances by multiplying by 1.00011927.
- 5. Record distances are taken from Division of Highway Right-of-Way maps.

F.M. 21050
A 11 OF A 21

STATE OF CALIFORNIA
 TRANSPORTATION AGENCY
 DEPARTMENT OF PUBLIC WORKS
 DIVISION OF HIGHWAYS
MONUMENTATION MAP
 No. MF-4012-1
 A. C. Birnie Deputy District Engineer Date

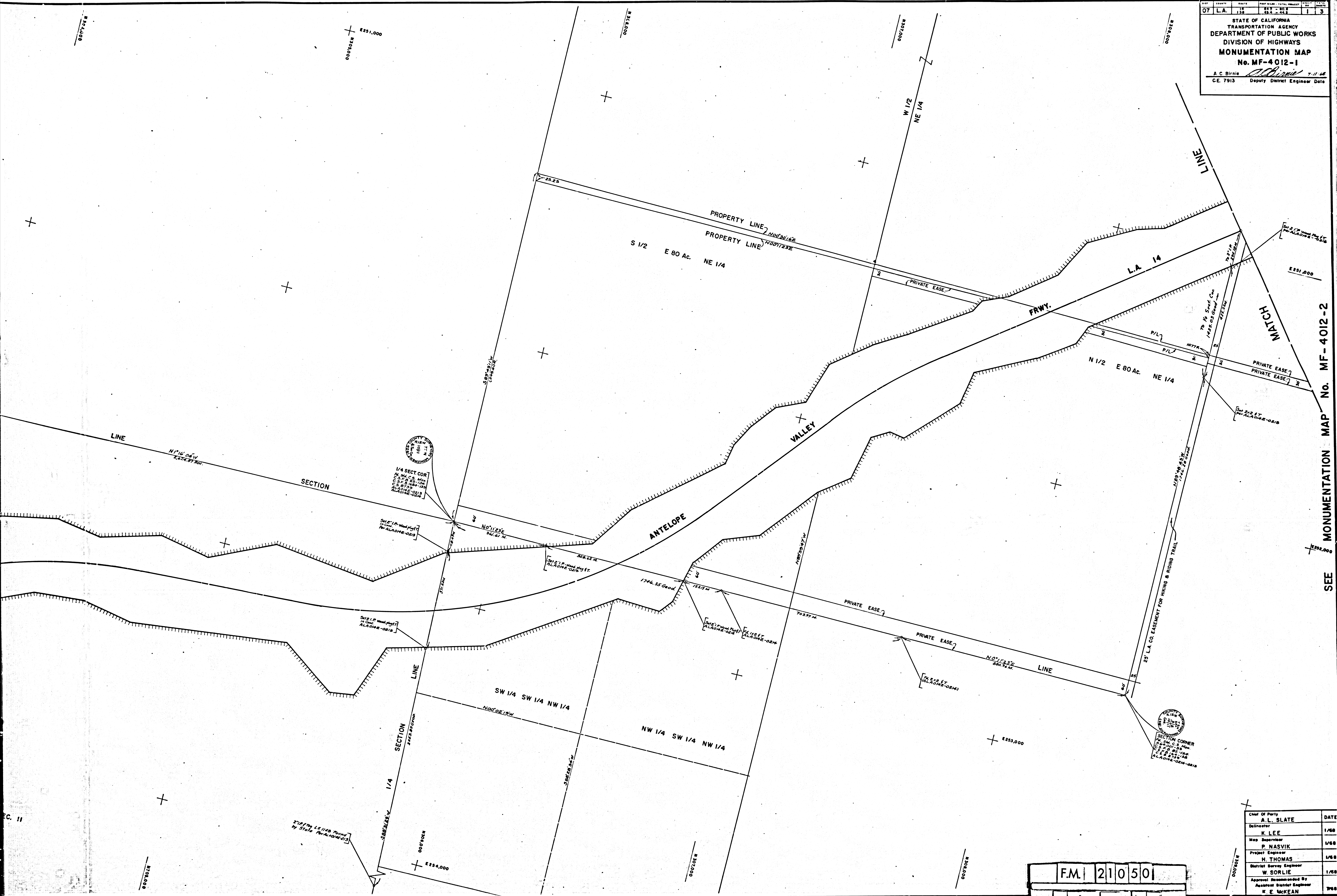

SEE MONUMENTATION MAP No. MF-4012-2

Chief Of Party	DATE
A. L. SLATE	1/68
Delineator	
K. LEE	1/68
Map Supervisor	
P. NASVIK	1/68
Project Engineer	
H. THOMAS	1/68
District Survey Engineer	
W. SORLIE	1/68
Approved & Recommended By	
K. E. MCKEAN	1/68

F.M. 21050
 A2 OF A2

F.M. 21050