

NO.	DESCRIPTION	REFERENCE
100	SET PK NAIL	AL1348-61
101	SET 80 SPK & W	AL1348-66
102	SET SPK	AL1348-66
103	SET SPK & M & BATHY CAP	73-018-37
104	FD 80 SPK & W	AL1348-61
105	FD 80 SPK & W	73-018-37
106	FD 4 PH'S ON PH RIM	73-018-37
107	FD BR CAP MON (PH 5.2)	AL1348-126
108	SET SPK & BATHY CAP	73-018-37
109	FD 4 SPK TAN OFFSET STRADS	73-018-38
110	SET SPK & BATHY CAP	73-018-37
111	SET SPK & BATHY CAP	73-018-38
112	SET STD BR CAP MON	AL1348-65
113	SET SPK & BATHY CAP	73-018-38
114	SET SPK & BATHY CAP	73-018-38
115	FD 4 SPK TAN OFFSET STRADS	73-018-39
116	FD 4 SPK STRADS	73-018-39
117	SET L & T	AL1348-126
118	SET 50 SPK & W	AL1348-64
119	SET 50 SPK & W	AL1348-64
120	FD RIM CUT ON PH	AL1348-130
121	NOTH FD OR SET	AL1348-130
122	FD M, T & W	AL1348-130
123	FD BR CAP MON (PH 5.2)	AL1348-126
124	FD 4 C NL STRADS	AL1348-128
125	NOTH FD & NOTH SET	AL1348-128
126	FD 4 CHIS "X" ON PH RIM	AL1348-130
127	FD L & T (NO REF)	AL1348-130
128	FD L & T	AL1348-128
129	SET CHIS "X" IN S SHLK	AL1348-130
130	NOTH FD, NOTH SET	AL1348-130
131	FD NAIL	AL1348-130
132	FD PH BOLT	AL1348-128
133	FD 4 CUTS ON PH	AL1348-128
134	FD CHC BR CAP MON (PH 6.4)	FLA0051-17
135	SET S & W	AL1348-128
136	FD 50 SPK & W	AL1348-130
137	FD 4 CUTS ON PH (NO REF)	AL1348-126
138	FD CHIS "A" ON PH RIM	AL1348-126
139	FD S & W	73-018-39
140	SET 50 SPK & W	AL1348-64

F.M. 21136

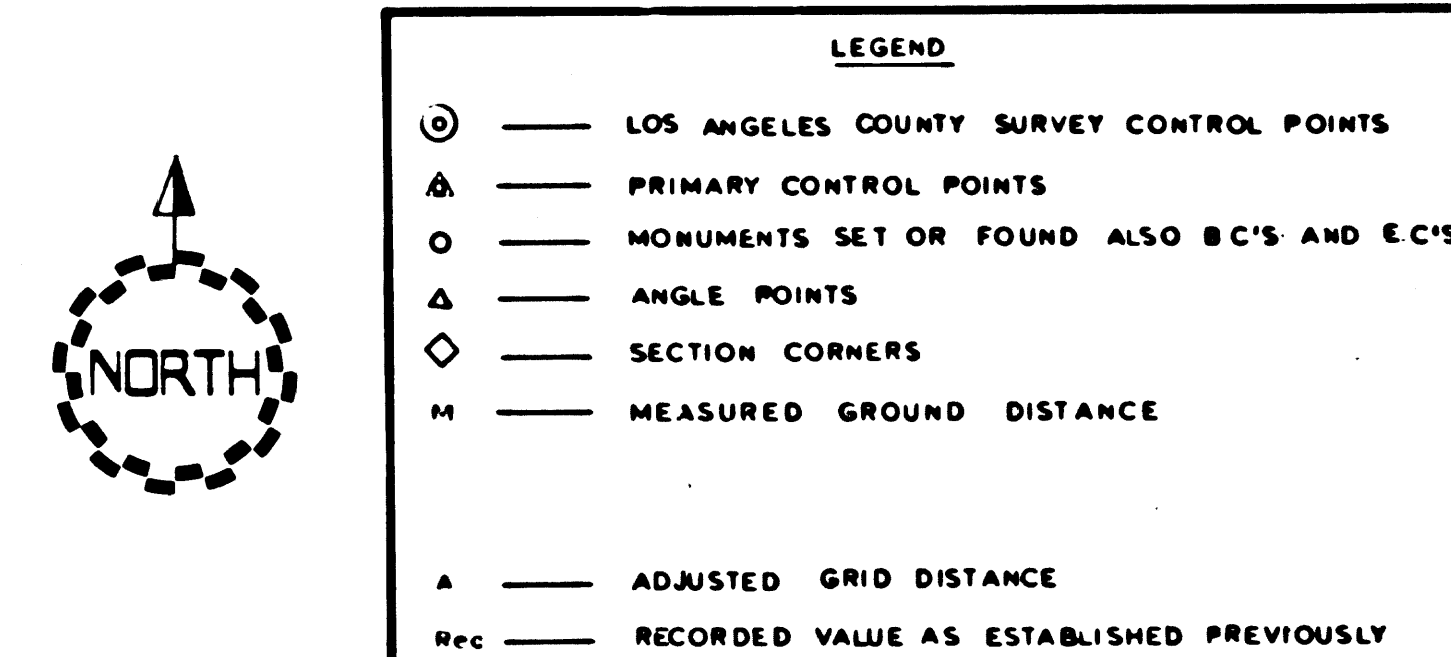

NOTE:
 1. BEARINGS ARE BASED ON THE CALIFORNIA COORDINATE SYSTEM, DIVISION 8, SECTION 8809 OF THE 1953 PUBLIC RESOURCES CODE, AND ARE DERIVED FROM THE 1971 VALUE OF THE LOS ANGELES COUNTY SURVEY CONTROL POINTS AS SHOWN.
 2. DIVISION OF HIGHWAYS SURVEY INFORMATION IS AVAILABLE FROM THE ENGINEERING SERVICES DEPARTMENT, LOS ANGELES, CALIFORNIA.
 3. DIVISION OF HIGHWAYS RIGHT OF WAY INFORMATION IS AVAILABLE FROM THE RIGHT OF WAY DEPARTMENT, LOS ANGELES, CALIFORNIA.
 4. STATIONING SHOWN ON THIS MAP IS FOR REFERENCE ONLY.
 5. THIS MAP PARTIALLY SUPERSEDES MAP MF 4055-1.

IN LOS ANGELES COUNTY
 BLK. _____ MOD. _____

CONSTRUCTION CONTRACT NO. 020844
 COMPLETION DATE: MAY 2, 1969

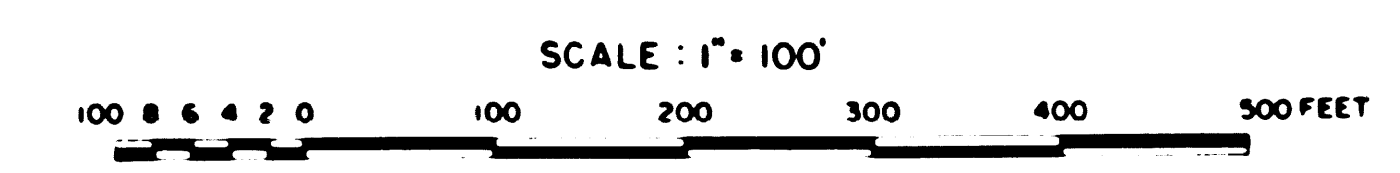

LOS ANGELES COUNTY FILE NO.					
DISTRICT	COUNTY	ROUTE	POST MILES - TOTAL PROJECT	SHEET NO.	TOTAL SHEETS
07	LA	134	5.8 - 6.6	1	6
DRAWN BY: RW HENDRICKS					
CHECKED BY: G. SULAITIS, M. HOVEY					
DESIGNED BY: M. HOVEY, M. YOUNG					
DATE: APRIL, 1974					

FM 21136