

SEE MF - 4058 - 1

F.M.	2	1	3	3	6	-	2
A	1	OF	A	2			

DIST	COUNTY	ROUTE	POST MILES-TOTAL PROJECT	SHEET	TOTAL
07	L.A.	5/210	42.4-45.0, 0.0-23	1	2

STATE OF CALIFORNIA  
TRANSPORTATION AGENCY  
DEPARTMENT OF PUBLIC WORKS  
DIVISION OF HIGHWAYS  
PRE-MONUMENTATION MAP  
NO. MF-4058-2

F.A. MAAS  
L.S. 3819 District Survey Engineer Date 12-4-72

L.A. COUNTY FILE NO. F.M.

MEASUREMENTS MADE PRIOR TO  
FEB 9, 1971 EARTHQUAKE

NOTE: THIS INCOMPLETE MAP WAS  
FILED TO SHOW PRE-EARTHQUAKE  
MEASUREMENTS.

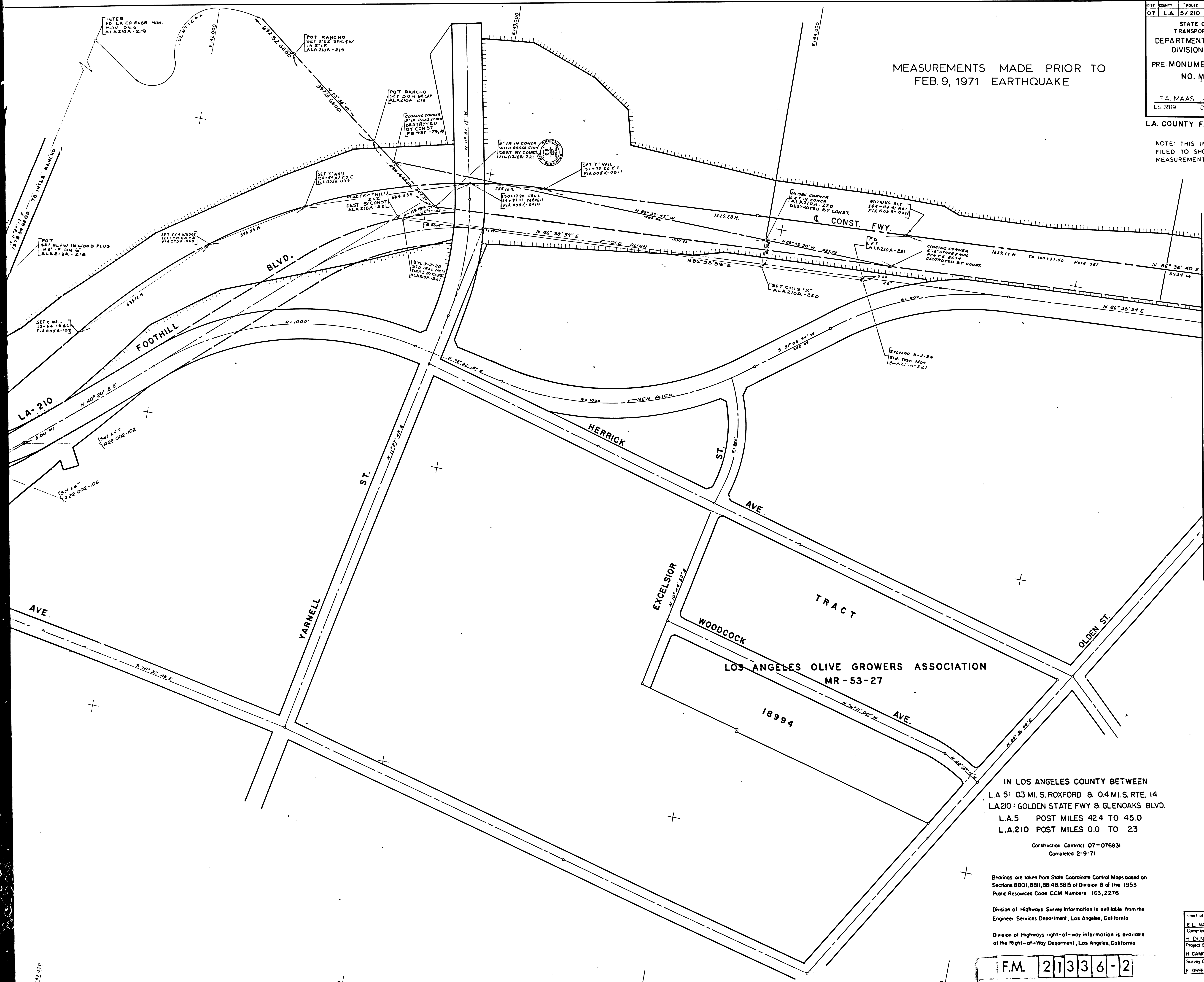

LINE  
MATCH

SEE MF 4059-1

IN LOS ANGELES COUNTY BETWEEN  
L.A. 5: 0.3 MI. S. ROXFORD & 0.4 M.I.S. RTE. 14  
L.A. 210: GOLDEN STATE FWY & GLENOAKS BLVD.  
L.A. 5 POST MILES 42.4 TO 45.0  
L.A. 210 POST MILES 0.0 TO 23

Construction Contract 07-076831  
Completed 2-9-71

Bearings are taken from State Coordinate Control Maps based on Sections 8801, 8811, 8814 & 8815 of Division 8 of the 1953 Public Resources Code GCM Numbers 163, 2276

Division of Highways Survey information is available from the Engineer Services Department, Los Angeles, California

Division of Highways right-of-way information is available at the Right-of-Way Department, Los Angeles, California

Sheet of Party	DATE
E.L. MAAS	
Compiled by	Drawn by
R. DUNCAN	B. LANCE
Project Engineer	Checked by
H. CAMPBELL	G. NOICE
Survey Office Supervisor	
F. GRENGARD	3/72

F.M. 21336-2  
A1 OF A2

E 144,000

N 227,000

E 144,000

E 144,000

E 144,000