

The preparation of this map was financed in part through a comprehensive planning grant from the Department of Housing and Urban Development, under provision of Section 701 of the Housing Act of 1954, as amended, April 1973, County of Los Angeles.



LOCATION OF BORING DATA AND CROSS SECTIONS

SEE PLATES 16 THROUGH 19 FOR CROSS SECTIONS

- SOURCES:
- CALIFORNIA STATE WATER RIGHTS BOARD REFEREE'S REPORT (1973)
 - METROPOLITAN WATER DISTRICT (PROCTOR ET AL., 1972)
 - ▲ CALIFORNIA DIVISION OF MINES AND GEOLOGY (UNPUBLISHED COMPILATION)

SEISMIC CONSIDERATIONS FOR LAND USE PLANNING
LOS ANGELES COUNTY

Woodward-McNeill & Associates
2140 W Olympic Blvd., Los Angeles, Calif. 90006
proj B116S
March 1973
Drafting by Los Angeles County Engineer

PLATE 4

F. M. 21477-4

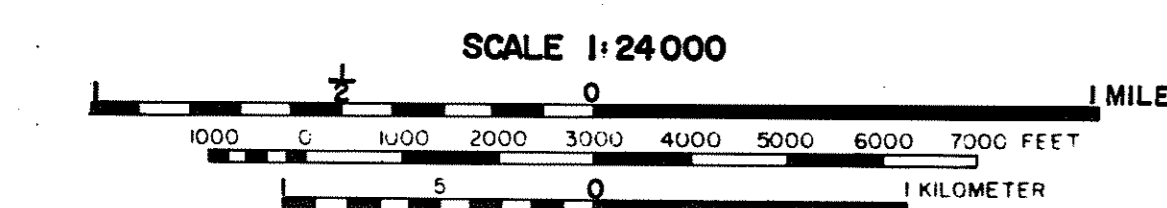

Bedrock
Saugus Formation
and older rocks

THE INFORMATION ON THIS MAP IS BASED ON INTERPRETATIONS OF INSUFFICIENT DATA, AND IS INTENDED ONLY FOR LAND-USE PLANNING. THIS MAP SHOULD BE UPDATED AS BETTER DATA BECOME AVAILABLE. THE INFORMATION ON THIS MAP SHOULD NOT BE USED FOR DESIGN, CONSTRUCTION, OR ANY PURPOSE OTHER THAN LAND-USE PLANNING.

CONTOUR INTERVAL 40 FEET
DOTTED LINES REPRESENT 10-FOOT CONTOURS
DATUM IS MEAN SEA LEVEL

