

FULLERTON ROAD ALIGNMENT MAP

JUNE, 1908 V.O. 061-43732-FN

NOTES:
 A INDICATES AERIAL CONTROL POINT (2x2 W/ WIRE)
 B INDICATES SURVEY CONTROL POINT (2x2 W/ TACK)
 DATA SHOWN IN PARENTHESES () IS PER P.W.B. 0930 & 0931, UNLESS OTHERWISE NOTED.

COORDINATE NUMBERS USED HEREON:
 40011, 40009 THROUGH 40011, 40021, 40024, 40026,
 54154 THROUGH 54174

58104 THROUGH 58110, 58113, 58116 THROUGH 58123,
 58146, 58150, 58155 THROUGH 58158, 58171, 58178,
 58178, 58180, 58182, 58185, 58186, 58187, 58178,
 58500 THROUGH 58502, 58504, 58505,
 158220, 158227, 158238, 158242 THROUGH 158244,
 158244, 158246,
 180172 THROUGH 180187, 180227 THROUGH 180229,
 185262 THROUGH 185271.

PREPARED BY:
 HANNAH & ASSOCIATES, INC.
 THREE MAPES
 LOS ANGELES, CALIFORNIA 90010

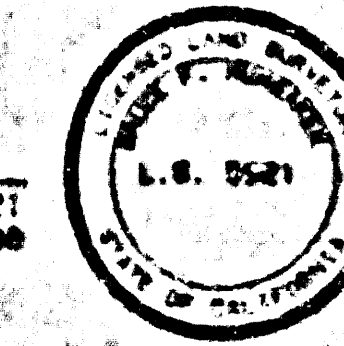

PREPARED FOR:
 LOS ANGELES COUNTY, DEPARTMENT OF PUBLIC WORKS

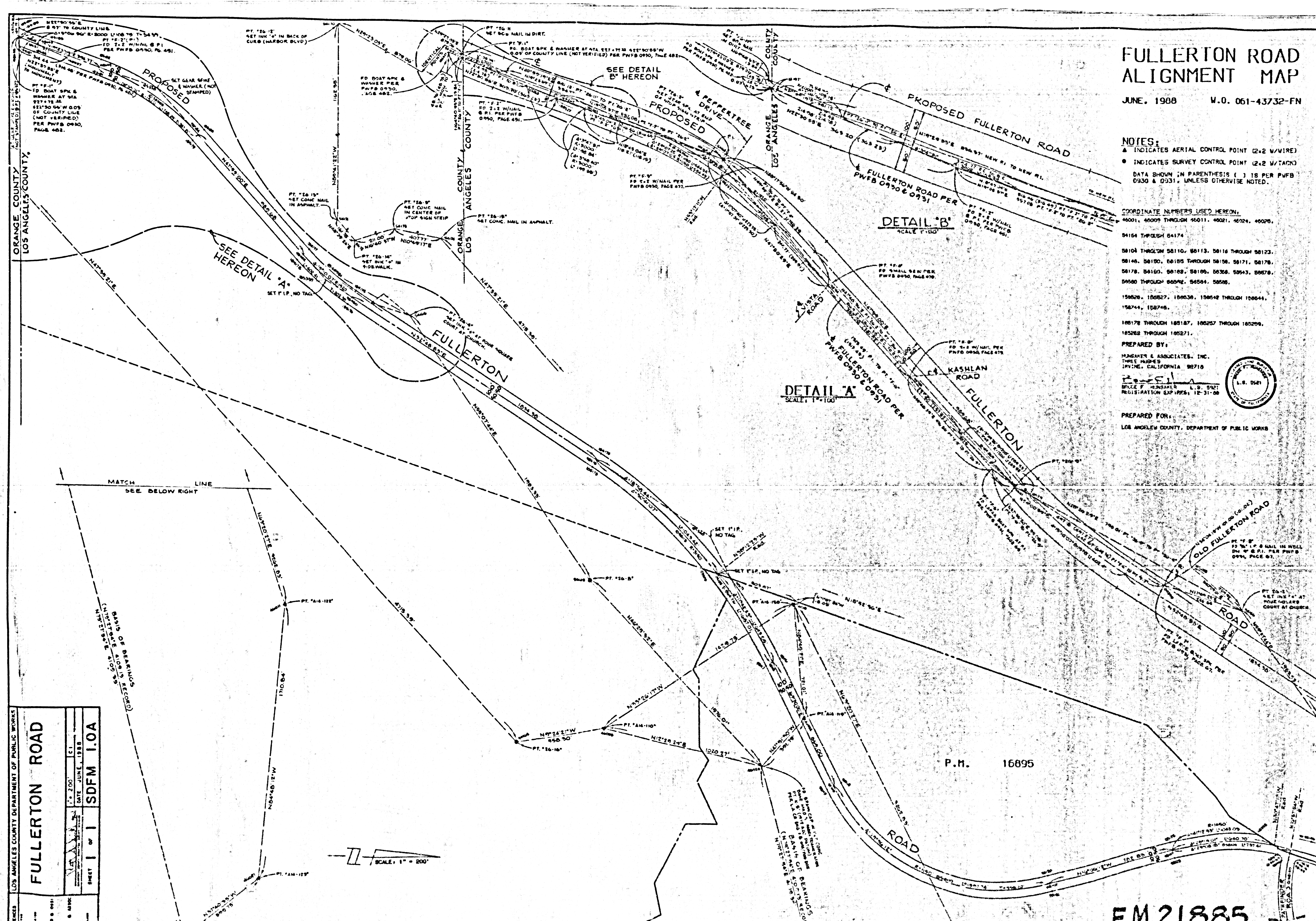

DETAIL 'B'
 SCALE 1" = 100'

DETAIL 'A'
 SCALE 1" = 100'

LOS ANGELES COUNTY DEPARTMENT OF PUBLIC WORKS		
FULLERTON ROAD		
DATE	JUNE, 1908	
BY	SDFM I.O.A.	
SHEET 1 OF 1		
REVISIONS		
NO.	DATE	DESCRIPTION
1		
2		
3		
4		
5		
6		
7		
8		
9		
10		
11		
12		
13		
14		
15		
16		
17		
18		
19		
20		
21		
22		
23		
24		
25		
26		
27		
28		
29		
30		
31		
32		
33		
34		
35		
36		
37		
38		
39		
40		
41		
42		
43		
44		
45		
46		
47		
48		
49		
50		
51		
52		
53		
54		
55		
56		
57		
58		
59		
60		
61		
62		
63		
64		
65		
66		
67		
68		
69		
70		
71		
72		
73		
74		
75		
76		
77		
78		
79		
80		
81		
82		
83		
84		
85		
86		
87		
88		
89		
90		
91		
92		
93		
94		
95		
96		
97		
98		
99		
100		