

FIELD NOTES OF SECTION 22 of TOWNSHIP 2 NORTH
 RANGE 13 WEST, SAN BERNARDINO BASE AND
 MERIDIAN, CALIFORNIA

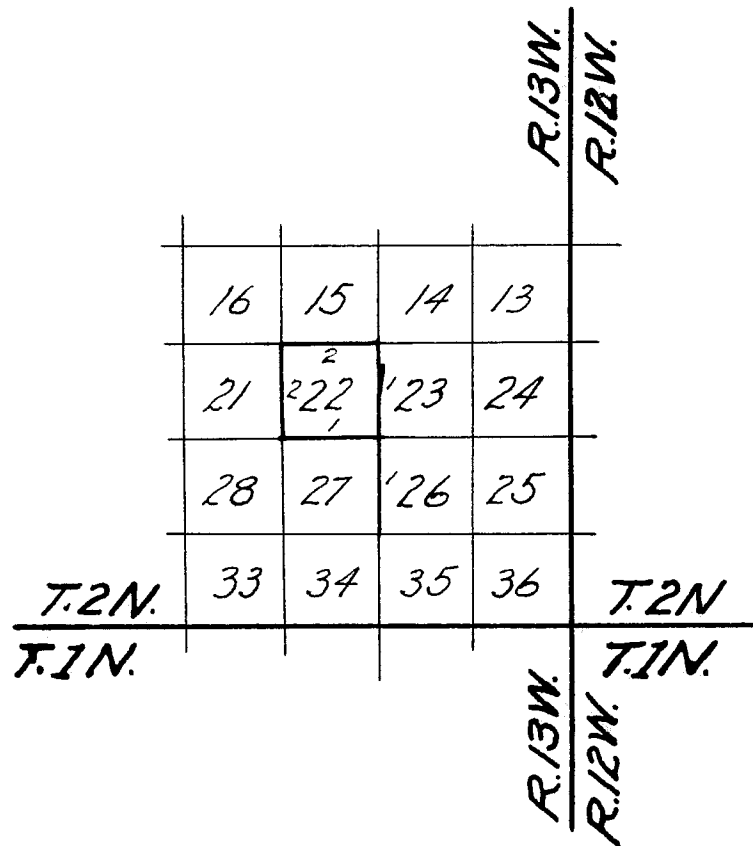

North bet. Secs. 26 and 27.

Var. $14\frac{1}{2}^{\circ}$ E.

80.00 Set a sand rock 6x6x10 in. in a mound of rocks, as instructed for cor. to Secs. 22, 23, 26 and 27.

Land south $\frac{1}{2}$ valley 1st rate.

N. $\frac{1}{2}$ mountainous 2nd rate.

Bee ranges.

North bet. Secs. 22 and 23.

Var. $14\frac{1}{2}^{\circ}$ E.

Ascending

8.00 Summit of spur, bearing NE and SW and descend

17.50 Cross near head of gulch, 50 lks. wide, course SW ascend

32.50 Summit of spur, bearing NE and SW

Descend.

40.00 Set a redwood post 3x3 in., 3 ft. long in a mound of rocks, as instructed on side hill, facing SW for $\frac{1}{4}$ sec. cor.

58.00 Cross deep gulch 100 lks. wide, course SW and ascend

80.00 Set a sand rock 10x16x20 in. in a mound of rocks, as per instructions on side hill facing SE for cor. to Secs. 14, 15, 22 and 23.

Land high rolling mountains.

2nd rate with scattering timber.

Good bee range.

From the cor. to Secs. 22, 23, 26, 27, I run

West on a true line bet. Secs. 22 and 27.

Var. $14\frac{1}{2}^{\circ}$ E.

Descending.

10.50 Cross creek, .06 lks. wide course south.

18.00 Ascend to high table land.

40.00 Inst. the northern boundary of the Rancho La Canada 13.18

Set a redwood scantling 2x4 ins. 3 ft. long in a mound of rocks, as instructed for $\frac{1}{4}$ sec. cor. and cor. to fractional secs. 22 & 27 Pickings House, bears NE about 15.00 chs.; thence continuing through said Rancho.

48.50 Cross gulch 50 lks. wide, course south.

80.00 Set a redwood post 4x4 in. $3\frac{1}{2}$ ft. long in a mound of rocks, as instructed for cor. to Secs. 21, 22, 27 and 28 inside the Rancho La Canada.

Land mostly level 1st and 2nd rate.

Covered with low brush, very dry gravelly soil.

North bet. Secs. 21 and 22.

Var. $14\frac{1}{4}^{\circ}$ E.

17.03 Inst. the northern boundary of the Rancho La Canada, 43.50 chs. north 67° W. of the cor. to fractional Secs. 27 and 28. Set an oak post 3x3 ins. 3 ft. long in a large mound of rocks as instructed, for cor. to fractional Secs. 21 and 22. Price's house NW about 12.00 chs.

Thence

North bet. Secs. 21 and 22.

31.00 Leave brushy table land and ascend.

39.50 Summit of spur, bearing E. and W. and descend.

40.00 Point for $\frac{1}{4}$ sec. cor. falling on steep side hill not a suitable place to build a mound, I set a manzanita post 3x3 in., 3 ft. long in mound of rocks, as instructed on top of ridge, 77 lks. south for witness to $\frac{1}{4}$ sec. cor. Descend.

60.00 Ascending.

80.00 Set a redwood post 4x4 in. $3\frac{1}{2}$ ft. in a mound of rocks as instructed for cor. to Secs. 15, 16, 21 and 22.

Land south $\frac{1}{2}$ level, mostly 1st rate.

N. $\frac{1}{2}$ mountainous 2nd rate.

Along south slope of mountains.

- 20.00 Descending.
- 40.00 Set a post for temp. $\frac{1}{4}$ sec. cor.
- 49.50 Cross gulch 75 lks. wide, course SE ascend.
- 55.00 Summit of spur, bearing N and S. Descend.
- 62.50 Cross gulch, 50 lks. wide, course SW ascend.
- 80.10 Inst. the N & S line 20 lks. north of the cor. to Secs. 14,
15, 22 and 23, from this cor. I run
North $89^{\circ}51'$ W. on a true line bet. Secs. 15 and 22.
Var. $14\frac{1}{4}^{\circ}$ E.
- 40.05 Set a fir post 3x3 in. 3 ft. long in a mound of rock on side
hill facing SE as instructed for $\frac{1}{4}$ sec. cor.
- 80.10 The cor. to Secs. 15, 16, 21 and 22.
Land high mountainous 2nd rate.
Timber pine and oak in places.

Surveyed by W. H. Norway, Deputy Surveyor
Contract dated July 31, 1875.