

TRANSCRIPT OF FIELD NOTES

Section 22, T.1 N., R.10 W., S. B. M.

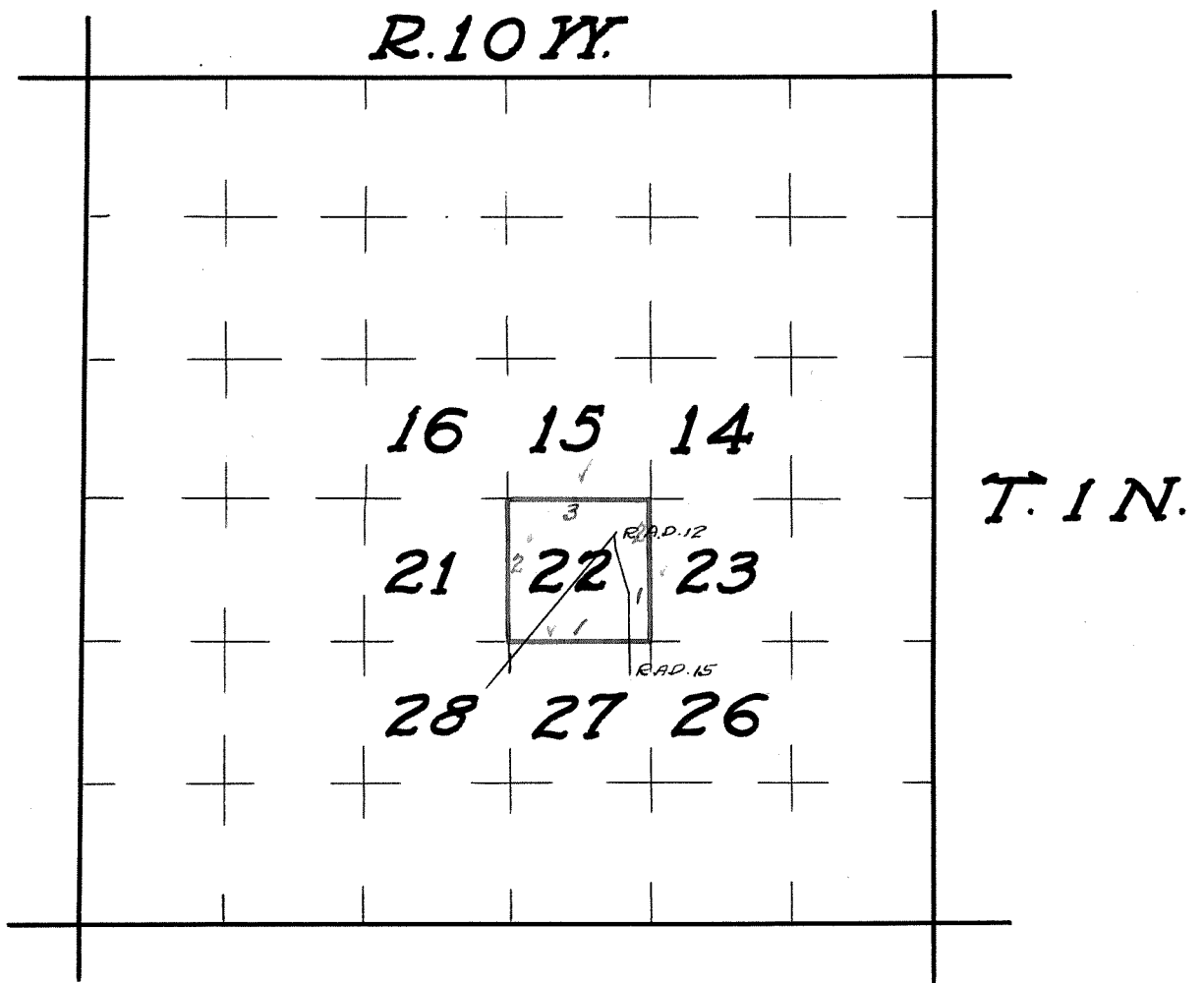

T. 1 N., R. 10 W., S. B. M.

From the cor. to secs. 22, 23, 27 and 26, I run
West on true line bet. secs. 22 and 27.

Var. $14\frac{1}{4}^{\circ}$ E.

4.99 Int. the E. bound. of the Rancho Azusa, 21.49 chs. N. 4° W., of
Corner No. 15 of said Rancho. Set an alder post 4 x 4 in. 3 ft.
long in md. of rocks as inst. for cor. to frac. secs. 22 and 27,
thence continuing W. bet. secs. 22 and 27, through Rancho Azusa.

8.50 Cross Sanja course S.

40.00 Set alder post 3 x 3 in. 3 ft. long in md. of rocks in brushy bed
of San Gabriel River, inst. for $\frac{1}{4}$ sec. cor.

65.00 Enter wash of river co. N. & S.

73.23 Int. W. bound. of Rancho Azusa, 86.09 chs. S. $46\frac{1}{2}^{\circ}$ W. of cor. No. 12
of said rancho.

Set cedar post 4 x 4 in. 3 ft. long in large md. of rock as inst.
for cor. to frac. secs. 22 and 27.

78.50 San Gabriel River. No water as it runs in zanja.

79.50 Over river co. SW.

80.00 Set oak post in md. of rocks as inst. for Cor. to secs. 21, 22,
27, 28.

Land mostly through dry bushy land of San Gabriel River.

2nd and 3rd rate.

Dec. 2, 1875

(W. H. Norway)

From the cor. to secs. 22, 23, 26 and 27.

North bet. secs. 22 and 23.

Var. $14\frac{1}{4}^{\circ}$ E.

19.00 To edge of high rocky point too rough to measure. Offset W.

West 5.00 chs. to valley thence

North 15.00 chs. Henry Robert's house W. of line 31.22 chs.

to N. point of hill thence

East 5.00 chs. to line bet. secs. 22 and 23., 10.22 chs. N. of $\frac{1}{4}$ sec.

cor. set an alder tree 2 ft. in dia. I mark for witness to $\frac{1}{4}$ sec. cor. on NE. edge of sanja co. SW. thence continue North bet. secs. 22 and 23.

50.50 Counting the distance from the cor. to secs. 22, 23, 26 and 27, cross wagon road co. SW. & NE.

55.30 Cross San Gabriel River 50 lks. wide co. SW.

62.50 Leave river W. and ascend steep side hill co. E. & W.

77.40 Edge of steep side hill, I set an alder post 4 x 4 ins. and $3\frac{1}{2}$ ft. long, in md. of rocks, as inst. for witness to cor. to secs. 14, 15, 22 and 23, as the true cor. will fall on steep side hill, not a suitable place to build a monument.

80.00 Point for cor. to secs. 14, 15, 22 and 23.

Land along river 2nd and 3rd rate.

(Norway, Bet. Nov. 29 & Dec. 2, 1875) Mitchell

From the cor. to secs. 21, 22, 27 and 28, I run North bet. secs. 21 and 22.

Var. $14\frac{1}{4}^{\circ}$ E.

15.40 Cross zanja co. SW.

31.00 Leave river bottom and ascend.

37.00 Foot of rocky ridge; as the $\frac{1}{4}$ sec. cor. will fall on rocky ledge not a suitable place to build a mound, I set at this point a toyon post 3 x 3 x 3 ft. long in mound of rocks on steep side hill facing S. as inst. for witness to $\frac{1}{4}$ sec. cor.

L. M. Rosmussen's house brs. NE. about 7.00 chs. dist.

40.00 The true point for $\frac{1}{4}$ sec. cor. on rocky ledge. Course E. & W.

59.00 Summit of ridge and descend, course E. & W.

80.00 Set redwood post 4 x 4 in. 3 ft. long in mound of rocks as inst. for cor. to secs. 15, 16, 21 and 22.

Land S. $\frac{1}{2}$ level, mostly river bottom, N. $\frac{1}{2}$ Mts. Good Bee rancho. Soil all 3rd rate.

East on a random line bet. secs. 15 and 22.

Var. $14\frac{1}{4}^{\circ}$ E.

- 7.50 Cross gulch with timber, S. 10° E. and ascend.
10.00 Summit of spur course N. & S. and descend.
20.00 Cross a ravine 50 lks. wide. Course SE. and descend.
40.00 Set temp. $\frac{1}{4}$ sec. cor. post.
54.50 Summit of spur NW. & SE. and descend.
79.90 Int. the N. & S. line 21 lks. S. of cor. to secs. 14, 15, 22
and 23,
From this cor. I run
S. $89^{\circ} 51'$ W. on a true line bet. secs. 15 and 22.

Var. $14\frac{1}{4}^{\circ}$ E.

- 39.95 Set an oak post 3 x 3 in. 3 ft. long in a large mound of rocks
on SW. slope of Mts. as inst. for $\frac{1}{4}$ sec. cor.
79.90 The cor. to secs. 15, 16, 21 and 22.
Land rough, Mts. 3rd rate. Timber in canadas.
Good Bee rancho.

Dec. 2, 1875

(Norway)
