

FIELD NOTES

of

Certain lines in T. 1 S., R. 14 W., SBM

and

S. B Sections 34, 35 & 36.

Between Sections 35 & 36) W.B. Ro. Los Feliz  
25 & 26)  
26 & 27  
26 & 35  
27 & 34

T. 1 N., R. 14 W., S.B.M.

and

Retrace of S B. Ro. La Providencia.

Copied from Notes loaned by Mr. L. Friel.

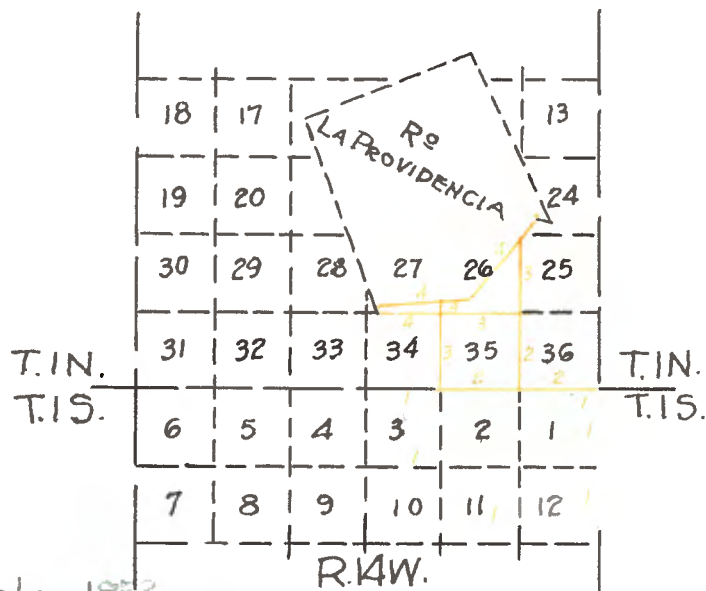

Washington 1852  
Reynolds 1878

S B T. 1 N., R. 14 W., S.B.M.

West 1st mile on S B. of T. 1 N., R. 14 W. January 4, 1853.  
Var. 13°43' E.

- 15.00 To small valley, valley mostly to the south.  
29.00 Crossed valley to rugged hills.  
31.75 Set charred stake and elder post from which bears an evergreen scrub.  
Red oak, S. 26° W. 155 lks. 18 ins. dia.  
No other tree found.  
E.B. and offset. Last 31.75 chs. 3rd rate mostly broken scrub hills.  
Owing to the extreme roughness of the mountain range to the west  
it is deemed impracticable to continue the base line any further  
with the requisite degree of accuracy.

Returned therefore to the SE corner of T. 1 N., R. 14 W., being also  
the SW corner of T. 1 N., R. 13 W., and ran south.

SOUTH on Range line between Ranges 13 & 14 W.

Township 1 south.

- 8.50 To small brushy valley, and down it.  
16.00 To spur of mountains, bears NW  
35.00 To valley.  
40.00 Temporary stake.  
62.00 Passed about 100 lks. west of spring.  
80.00 Temporary stake, thence continue south.

SOUTH 2nd mile.

- 55.00 Cross wagon road, leading from Los Angeles to Santa Barbara, course  
NW. & SE  
60.00 Set stake. In prairie. Thence due west.

WEST through T. 1 S., R. 14 W.

- 101.50 Cross road leading from Los Angeles to Santa Barbara, course S. 50° E.  
205.00 2nd mile, 45 chs. Set stake in prairie thence due north thru prairie.

San Bernardino Base Line.

T. 1 S., R. 14 W.

{ C.S. 9049 does not  
show this.

- 61.00 Crossed branch 5 lks. wide course SE to hills, from level prairie.  
67.00 To small valley, stake, 4th January 1853.  
70.80 Crossed branch same as noted at 61 chs. course SW.  
96.00 To high hills, mountain range and leave valley.  
111.00 Crossed road leading from Los Angeles to Santa Barbara. Course N. 5° W.  
111.50 Crossed branch 5 lks. wide, general course S. 5° E.  
127.50 Set stake on side of hill and compelled to run to the narrow pass at  
road N. 39° W.  
2.00 From rough hills (to narrow pass) foot of hills.  
3.50 Cross road, course SW.  
3.80 To branch 4 lks. wide, course SW.  
12.50 Crossed same branch (having crossed it 5 times and the road alter-  
nately), course SW.  
16.09 Set post on the San Bernardino Base line being 215 chs. 13 lks. west  
of (2nd mile 55 chs. 13 lks.) corner to Ranges 13 and 14 on the San  
Bernardino Base line, from which bears three trees, to wit:  
Sycamore S. 41° E. 556 lks. T. 1 S., R. 14 W. S. 3 28 ins. dia.  
Sycamore N. 53° E. 105 lks. T. 1 N., R. 14 W. S. 34. 5 ins. dia.  
Evergreen red oak N. 74° W. 205 lks. T. 1 N., R. 14 W. S 34  
18" dia.  
From the last post set, ran EAST on San Bernardino Base Line, east  
.70 Cross road from Los Angeles to Santa Barbara, course SW.

1.93 To small branch, course SW at the foot of a very rough mountain, Rocky scrub hills and found it utterly impracticable to continue the Line so as to measure it correctly to the east and for the same reason cannot extend the San Bernardino Base line to the West. Returned to the last post on the San Bernardino Base Line and ran N. 39° W. through T. 1 N., R. 14 W.

---

Surveyed by H. Washington, Deputy Surveyor.  
Contract dated October 4, 1852.

---

S B. T. 1 N., R. 14 W., S.B.M.  
WEST on the South boundary of Section 36. Var. 15°05' E.

80.00 Set a sandrock 18x14x9 and raised a mound of sandrock with a base of 3 ft. and 30 ins. high for corner to sections 35 and 36, on the W. boundary of Rancho Los Feliz.  
Land broken, mountainous and heavily timbered with scrub and chaparral oak. Soil 3rd rate.

---

WEST on the S. boundary of Section 35. Var. 15° 05' E.

1.00 To a dry wash 10 lks. wide S. 80° W.  
3.00 Leave a canyon and run along the south slope of hills.  
17.00 Foot of ridge and ascend.  
22.00 Top of ridge S. 25° W. and descend.  
30.00 Foot of ridge and to road N & S.  
32.20 Cross dry ravine 20 lks. wide bearing S.  
34.50 Cross point of ridge bearing NW.  
35.00 Enter dry ravine 80 lks. wide runs S. 85° E. and up same.  
38.80 Set a sand rock 14x10x6 on the S. and left bank of ravine and raised a mound of sand rock 30 ins. high and 2 ft. base at the foot of a steep ridge for  $\frac{1}{4}$  section witness corner.  
45.00 To summit of ridge bearing N & S  
46.00 Cross summit and descend.  
50.50 Foot of ridge and enter a narrow valley bearing S.  
51.60 The SW corner of Honey refining house, H. Clausen, N. 2 lks.  
58.00 Leave valley and ascend a spur of ridge, bearing W.  
70.50 Summit of main ridge, N & S.  
77.00 Descend steep west slope of main ridge.  
80.00 Set a sand rock 20x14x10, 10 ins. deep and raised a mound of sand rock 30 ins. high and 3 ft. base for corner to secs. 34 and 35.  
Land broken and hilly with thick scrub and chaparral oak. Soil 3rd rate

---

Subdivisions T. 1 N., R. 14 W.

Commenced at the corner to secs. 35 and 36, on the S. bdy. of Tp.

NORTH between sections 35 and 36. Var. 15°05' E.

Along the west boundary of the Rancho Los Feliz.

2.00 Cross ravine 10 lks. wide course S. 80° W.  
Ascend chaparral hills.  
24.00 Top of ascent, ridge brs. SW by W. descend.  
40.00 Set a sandstone rock 6x9x16 ins. 8 ins. deep and raised a mound of sandstone rock 3 ft. sq. 2 ft. high for  $\frac{1}{4}$  sec. cor. on the N. slope of hill.  
46.00 Cross ravine, and ascend south slope of the Cahuenga Mountains.  
80.00 Set a sandstone rock 16x16x20 ins. 10 ins. deep in ground, raised mound of rock 30 ins. sq. 2 ft. high for cor. to secs. 25, 26, 35 & 36.  
Land, rough, broken. Soil 3rd rate.

NORTH between sections 25 and 26.

Var. 15°05' E.

Along west boundary of the Rancho Los Feliz.

Ascending steep south slope of the Cahuenga Mountains.

Top of ascent, descend across NW slope of same.

10.50 Leave mountain slope and descend steep north slope of same, set a mound of rock.

21.80 Foot of steep descent and thence along the summit of a spur.

30.00 Raised a mound of rock 3 ft. sq. 20 ins. high for  $\frac{1}{4}$  sec. corner.

40.00 To foot of spur and to ravine 60 lks. wide, course N. 76° W.

43.00 Cross point of spur bearing NE. Set a mound of rock. Ascend.

46.50 Top of ascent, ridge bears N. 78° W. and S. 80° E. Descend.

57.50 Foot of descent, cross a ravine 20 lks. wide, course N. 10° W.

63.00 Point for intersection with the lines of the Rancho La Providencia. as per Patent.

63.88 Intersect Rancho La Providencia, as I find it on the ground from which my temporary stake set by me while retracing the lines from Station No. 5 to Station No. 6 of La Providencia, bears S. 20 $\frac{1}{4}$ ° W. 4 chs. 72 lks. distant, making the entire distance from Station No. 5 of the last mentioned Rancho to this point of intersection 67 chs. 58 lks.

This is on the right and east bank of a ravine, running N. 22° W. and from this point I run

NORTH 20 lks. and set a sandstone rock 8x10x16 ins. and raise a mound of stone 3 ft. dia. 2 ft. high, from which

A live oak 22 ins. dia. brs. N. 83° E. 25 lks. dist.

Land broken and covered with chaparral. Soil 3rd rate.

---

Commence at the corner to sections 34 and 35 on the S.B. of Tp. NORTH between secs. 34 and 35. Var. 15°05' E.

80.00 Top of west slope of ridge. Set a sandstone rock 7x12x18 ins. for corner to secs. 26, 27, 34 and 35, raised a mound of stone 4 ft. sq. 20 ins. high.

Land rough and broken.

Mountains covered with chaparral brush. Soil 3rd rate.

---

EAST on a random line between sections 26 and 35.

Var. 15°15' E.

40.00 Set temp.  $\frac{1}{4}$  sec. stake.

80.00 Intersect N & S line at the corner to secs. 25, 26, 35 and 36.

WEST on a true line between secs 26 and 35. Var. 15° 15' E.

.60 Cross a ravine 50 lks. wide, course S. 5° E. Ascend.

3.00 Top of ascent, ridge bears S.

5.00 Descend.

12.00 Fork of descent and to ravine.

12.50 Cross ravine, course S. and ascend.

18.00 Top of ascent. Ridge bears S. and descend.

25.00 Fork of descent and cross ravine 20 lks. wide, course S. 10° W. Ascend.

35.00 Top of ascent, ridge bears S. Descend.

40.11 Set a sandstone rock 12x16x24 ins. for  $\frac{1}{4}$  sec. cor. and raised a mound of sandstone rock, 3 ft. sq. and 20 ins. high.

43.00 Foot of descent and ascend.

56.00 Top of ascent and along summit of ridge.

67.50 Descend along S. slope of ridge.

70.00 To summit again.

72.00 Leave summit and descend to W. slope.

80.22 To the cor. to secs. 26, 27, 34 and 35.

Land, broken, mountains, covered with chaparral. Soil 3rd rate.

NORTH between sections 26 and 27.

Var. 15°15' E.

2.00 Foot of descent, cross ravine 6 lks. wide, course SW. Ascend.  
7.00 Top of ascent, ridge bears SW and at foot of steep mountain.  
12.50 Intersect the S. boundary of the Rancho La Providencia, 69 chs.  
90 lks. N. 88° E. of Station No. 4 of said Rancho.  
Set a large rock 8x10x16 ins. at the point of intersection,  
~~raised~~ a mound of stone, 3 ft. dia. 20 ins. high.  
Land, rough and broken. Soil 3rd rate.

---

Commenced at the corner to secs. 26, 27, 34 and 35.

WEST between sections 27 and 34.

Var. 15°15' E.

Descend from corner.  
2.00 Foot of descent, enter ravine.  
5.00 Leave ravine course S. Ascend.  
25.00 Top of ascent. Ridge bears N & S. Descend.  
30.00 Foot of descent. Ascend.  
35.00 Top of ascent. Descend.  
40.00 Set  $\frac{1}{4}$  sec. post 3 ins. dia. 4 ft. long, 18 ins. in the ground, raised  
mound of stone 3 ft. sq. 20 ins. high.  
45.00 Foot of descent and in canyon bearing west.  
66.00 Leave canyon now bearing NW and ascend on north slope of hill.  
71.16 Intersect the east boundary of the Rancho Ex-Mission San Fernando,  
9 chs. 84 lks. S. 7°18' W. of Station No. 1.  
Set a stone 8x10x14 ins. at point of intersection, raised stone  
mound 3 ft. sq. 20 ins. high.  
Land, rough and broken. Soil 3rd rate.

---

I now commence at the Station No. 1, Rancho Ex-Mission de San Fernando  
and retrace the southern boundary of the Providencia, N. 88° E.  
Var. 15°00' E.

N. 88° E.

126.00 To the mound of rock Station No. 5 of said Rancho. Thence  
N. 20 $\frac{1}{4}$ ° E.  
Still retracing the boundary of La Providencia.  
62.86 Set temporary post for intersection with Rancho Los Feliz.  
114.00 To the oak post 6, Oak 30 ins. dia. and as called for in the official  
survey of the same.

---

Surveyed by W. P. Reynolds, Deputy Surveyor.  
Contract dated October 30, 1878.