

FIELD NOTES

T 1 N, R 12 W, S.B.M.

N. B. Sections 2, 3, 4, 5, 6, 12, 11 (part)

E. B. Sec 12.

Offset N. through Sec 2.

Between Sections 4 & 5. (part)

" " " 5 & 6. "

Retracing lines of Rancho San Pascual (Part)

Additional notes along N.B. and E.B. of T1N, R12W.

T 2 N, R 12 W.

W. B. Sections 30 & 31

~~and~~

~~Retracing lines of~~

~~Rancho San Pascual.~~

Copied from Notes loaned by Mr. L. Friel.

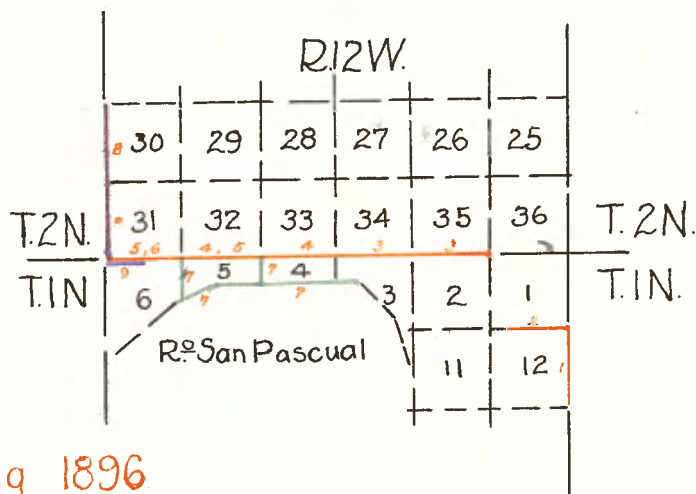

Cutting 1896
Goldsworthy 1875
--- 1896-7

Boundary line of San Gabriel Forest Reserve.

L. H. Cutting, Contract 126, 1896.

Sept 11, at 7 h. 00 m. A.M. l.m.t. I set off $34^{\circ} 40'$ N. on the Lat. arc, $4^{\circ} 15'$ N. on the Decl. arc, and determine a true meridian with the solar at the corner to secs. 7, 12, 13 and 18, on E. B., T 1 N, R 12 W. previously described.

From the corner to sections 7, 12, 13 & 18 on E. B. of Tp. 1 N, R 12 W. I run NORTH on a RANDOM line between sections 7 & 12.

40 25 To a point 12 lks. E. of old $\frac{1}{4}$ section corner where I found a portion of an old stone mound but no other trace of corner. To remark same I set a post 3 ft long 3 ins. sq. with marked stone 24 ins. in the ground marked S.G.F.R. on E. and $\frac{1}{2}$ S. on W. faces and raised a mound of stone 2 ft base $1\frac{1}{2}$ ft high W. of corner. Pits impracticable. Thence I run

S. $0^{\circ} 10'$ E. on a TRUE line between sections 7 & 12.

Descend through dense chaparral.

10 25 Gulch 10 lks. wide 200 ft below $\frac{1}{4}$ section corner, course SW. Ascend.
 12 25 Top of spur 75 ft above gulch bears NE & SW. Descend.
 15 75 Center of canyon 100 lks. wide, 125 ft below top of spur, course SW. Ascend.
 19 00 Pipe line bears NE & SW.
 20 45 An old stake in stone mound. No marks.
 20 75 Top of spur 200 ft above canyon bears NE & SW. Descend.
 22 75 Leave chaparral and enter vineyard bears E & W.
 20 00 Leave vineyard and continue descent.
 30 50 Enter wash bears E & W.
 33 25 Leave wash bears E & W. and over broken land.
 36 75 Mr. Kennedy's barn bears W. 3.50 chs. dist.
 39 10 Wagon road bears NW & SE, and through Eucalyptus grove.
 40 25 The corner to sections 7, 12, 13 & 18.

From the $\frac{1}{4}$ section corner I continue N

42 35 To a point 16 lks. E. of old corner to sections 1, 6, 7 & 12, which is a post marked and witnessed as described by the Surveyor General and which I marked S.G.F.R. on NE. face. This is the true point for corner No. 18 on boundary line of San Gabriel Forest Reserve, but as it falls on precipitous slope not a suitable place to mark, I run W. 11.00 chains and set a square hollow iron post filled with cement, 3 ft long with sides 4 ins. wide at the top, increasing to 12 ins. wide at the bottom, $1\frac{1}{2}$ ins. in the ground, for witness corner to corner No. 18 on Reservation boundary, marked

S.G.F.R. 18, T 1 N, S 6 on NE.

R 11 W, S 7 on SE.

R 12 W, S 12 on SW. and

S 1 on Nw. faces.

Dug pits 36 x 36 x 12 ins. N & S. of post 4 ft dist. and raise a md. of earth $1\frac{1}{2}$ ft high 5 ft base around post, alongside which I set a sandstone 21 x 16 x 11 ins. 16 ins. in the ground marked W.C. 11.00 chs. to farther mark witness corner.

From the true point for corner to sections 1, 6, 7 & 12, I run

S. $0^{\circ} 14'$ E. on a TRUE line between sections 7 & 12. Descend.

3 60 Head of ravine 150 ft below section corner course W. Ascend.
 8 60 Top of spur 225 ft above ravine bears E & W. Descend.
 13 60 Head of ravine 300 ft below top of spur, course W. and continue descent
 42 35 The $\frac{1}{4}$ section corner.

From the corner to sections 1, 6, 7 & 12, I run

WEST on a RANDOM line between sections 1 & 12.

40 00 Set temporary $\frac{1}{4}$ section corner.
78 50 To point 190 lks. N. of old corner to sections 1, 2, 11 & 12, which is a decayed post in earth mound with pits, the witness to corner being in poor order.
This being an unsuitable place to mark corner No. 19 on boundary of San Gabriel Forest Reservation on account of the precipitous character of the land, I run W. 15.50 chains and set a square hollow iron post filled with cement etc. 3 ft long, with sides 4 ins. wide at the top increasing to 12 ins. wide at the bottom, 12 ins. in the ground for witness corner to corner No. 19 on boundary marked S.G.F.R. 19 T 1 N S 1 on NE, R 12 W, S 12 on SE. S 11 on SW. and S 2 on NW. faces, dug pits 36 x 36 x 18 ins. N & E. of post 4 ft dist and raised an earth mound $1\frac{1}{2}$ ft high, 5 ft base around post, alongside which I set a sandstone 21 x 10 x 8 ins. 16 ins in the ground marked W C. 15.50 chs. to further mark this witness corner, from which bears a
Sycamore 30 ins. dia. N. $2\frac{1}{2}^{\circ}$ E. 120 lks. dist.
Marked WC. S.G.F.R. 19, T 1 N, S 1 BT.
Live oak 10 ind. dia. S. $39\frac{1}{2}^{\circ}$ W. 38 lks. dist.
marked WC. T 1 N, R 12 W, S 11 BT.
No other tree within limits.
From true corner to sections 1, 2, 11 & 12, I run

N. $88^{\circ} 37'$ E. on a TRUE line between sections 1 & 12.

39 25 Descend abruptly into deep canyon and across same course S.
The true point for $\frac{1}{4}$ section corner falls on almost perpendicular E. side of canyon, course S, not a suitable place to mark, I therefore continue N. $88^{\circ} 37'$ E. ascending and at
40 00 Set a sandstone 20 x 14 x 7 ins. 15 ins. in the ground for witness corner to $\frac{1}{4}$ section corner, marked WC. $\frac{1}{4}$ S. G. F. R. on N. face. Dug pits 18 x 18 x 12 ins. E & W. of stone 3 ft dist. and raised a mound of earth $1\frac{1}{2}$ ft high $3\frac{1}{2}$ ft base N. of corner. Witness corner set on top of spur 900 ft above bottom of canyon, bears N & S. Descend.
46 50 Gulch 20 lks. wide 400 ft below top of spur, course S. Ascend.
50 00 A cabin bears N. 50 lks. dist.
51 50 A cabin bears S. 110 lks. dist.
65 50 Mt. Wilson trail bears NE & SW.
67 50 Old post in stone mound on line, no marks legible.
73 50 Top of spur 790 ft above last gulch, bears N & S. Descend.
78 52 The corner to sections 1, 6, 7 & 12.

I find it impossible to run N. between sections 1 & 2 owing to precipitous bluffs and rugged mountains. I therefore go to the corner to sections 3, 4, 33 & 34 on N. boundary of the Tp. where I found a well preserved post marked and witnessed as described by the Surveyor General I set off $3^{\circ} 53'$ N. on the Decl. arc and at 12 h. 00 m. M. l.m.t. observe the sun on the meridian. The resulting Lat. is $34^{\circ} 12'$ N. To establish corner No. 21 on boundary of San Gabriel Forest Reserve at this point in place of the post, I set a square hollow iron post filled with cement etc. 3 ft long, the sides 4 ins. wide at the top increasing to 12 ins. wide at the bottom, 12 ins. in the ground, marked

S.G.F.R. 21, T 2 N, S 34 on NE.
R 12 W. S 3 on SE.
T 1 N, S 4 on SW. and
S 33 on NW. faces, dug pits 36 x 36 x 12 ins. N & S. of post 4 ft dist. and raised a mound of earth $1\frac{1}{2}$ ft high 5 ft base around post. Thence I run

N. $89^{\circ} 31'$ E. on a RANDOM land between sections 3 & 34.

38 25 To a point 65 lks. N. of old $\frac{1}{4}$ section corner which is a post set

firmly in the ground in a stone mound which I rebuild $1\frac{1}{2}$ ft high and 2 ft base.

The marks on post being partly obliterated I re-mark same
S. G. F. R. $\frac{1}{4}$ S. on N. face, from which bears a
Live Oak 10 ins. dia. S. $84\frac{1}{2}^{\circ}$ W. 70 lks. dist.
which I mark $\frac{1}{4}$ S. BT. Thence I run

N. 89° 31' W. on a TRUE line between sections 3 & 34. Ascend.

- .25 Top of spur bears NE & SW.
Top of dome of Mt. Lowe Hotel bears N. 80° 30' E.
The smoke stack on power house bears N. 53° 45' E. Descend.
- 17 75 Canyon 50 lks. wide 500 ft below top of spur, course S. 20° W.
22 25 Top of spur 100 ft above canyon bears N & S. Descend.
33 50 Sycamore canyon 100 lks. wide 300 ft below top of spur, course SW.
Hamlin's house and barn are in the mouth of this canyon about 7.00
chs. distant. Ascend.
- 37 60 Top of spur 100 ft above canyon bears N & S.
Top of dome of Mt. Lowe Hotel bears N. 74° 31' E.
The smoke stack of the power house bears N. 70° 51' E. Descend.
- 38 25 The corner to sections 3, 4, 33 & 34.
From the $\frac{1}{4}$ section corner I run
- EAST on a TRUE line between sections 3 & 34. Descend.
- 13 75 Cross Las Flores canyon 50 lks. wide 600 ft below $\frac{1}{4}$ section corner
course S. Ascend Mt. Lowe.
- 30 50 Top of spur of Mt. Lowe 1000 ft above canyon bears N & S. Descend.
33 50 Trail to Mt. Lowe Hotel bears S & NE.
Pavilion at foot of Incline Railway in Rubicon canyon bears S. 61°
E. about 20.00 chs. dist.
- 37 75 The true point for corner to sections 2, 3, 34 & 35, falling on slide
on steep SE. slope of Mt. Lowe, not a suitable place to mark at this
point which is 4.00 chs W. of true point, I mark a Live Oak tree 8
ins. dia.
W C. T 2 N, S 35 S.G.F.R. on NE.
✓ R 12 W, S 2 on SE.
T 1 N, S 3 on SW. and
S 34 on NW. sides with 2 notches on E. and 4 notches on W. sides
for witness corner to sections 2, 3, 34 & 35.
Dug pits 18 x 18 x 12 ins. in each section $5\frac{1}{2}$ ft dist. and raised an
earth mound around tree. Continue descent.
- 41 75 The true point for corner to sections 2, 3, 34 & 35.
- EAST on a TRUE line between sections 2 & 35. Continue descent.
- 12 00 Incline Railroad from Mt. Lowe Hotel to the Pavilion bears NW & SE.
37 10 Foot of descent 700 ft below section corner bears N & S.
Ascend abruptly.
- 40 00 The true point for $\frac{1}{4}$ section corner falls on steep mountain side,
impossible to mark, I therefore continue East.
- 59 15 Top of Grizzly Peak bears N & S.
Set a granite stone 24 x 17 x 11 ins. 18 ins in the ground for witness
to $\frac{1}{4}$ section corner, marked WC. $\frac{1}{4}$ on N. face and raised a stone mound
 $1\frac{1}{2}$ ft high 2 ft base N. of corner. Pits impracticable. Descend.
- 70 60 The corner to sections 1, 2, 35 & 36 not being a suitable place to
mark corner No. 20 on boundary of San Gabriel Forest Reservation on
account of the precipitous character of the land, I set at this point
a square hollow iron post filled with cement etc. 3 ft long the sides
4 ins. wide at the top increasing to 12 ins. wide at the bottom 12
ins. in the ground marked
S.G.F.R. 20, T 2 N, S 36 on Ne.
R 12 W, S 1 on SE.
T 1 N, S 2 on SW. and
S 35 on NW. faces, for witness corner to corner 20 in boundary
of San Gabriel Forest Reserve, and raised a stone mound $1\frac{1}{2}$ ft high 5
ft base around post. Pits impracticable. Alongside which I set a
granite stone 16 x 10 x 9 ins. 11 ins. in the ground marked WC.
- 80 00 Set a granite stone 22 x 10 x 10 ins. 16 ins. in the ground for

corner to sections 1, 2, 35 & 36, marked S.G.F.R. on N. face 1 notch on E. and 5 notches on W. edges and raised a mound of stone 2 ft base $1\frac{1}{2}$ ft high W. of corner. Pits impracticable.

It being impossible to chain the line between sections 1 & 2, I return to true point for corner to sections 1, 2, 11 & 12, and run WEST on offset line 20.85 chs. directly S. of point of Grizzly Bear Peak on which I cause a flag to be set, I run South 13.00 chs. thence a base E. 11.20 chs. on account of the rough and precipitous nature of the ground I find it impossible to measure a longer base as required by the manual, from which the flag bears N. $6^{\circ} 47'$ W. giving by calculation a distance of 94.16 chs. to flag, I chain back 13.00 chs. to offset line making the distance from line between sections 2 & 11 to line between sections 2 & 35 on N. boundary of Tp. 81.16 chs.

For W. $\frac{1}{4}$ S corner between sections 1, 2, see supplemental notes.

From the corner to sections 3, 4, 33 & 34, I run

N. $89^{\circ} 39'$ W. on a RANDOM line between sections 4 & 33.

40 37 To a point 53 lks. N. of $\frac{1}{4}$ section corner where I found a portion of an old stone mound but no other trace of corner. To re-establish same I set sandstone 20 x 12 x 10 ins. 15 ins. in the ground marked $\frac{1}{4}$ on N. face. Dug pits 18 x 18 x 12 ins. E & W. of stone 3 ft dist. and raised a mound of earth $1\frac{1}{2}$ ft high $3\frac{1}{2}$ ft base N. of corner, also marked stone S.G.F.R. on N. face. Thence I run

N. $89^{\circ} 36'$ E. on a TRUE line between sections 4 & 33. Descend.

2 97 Gulch 20 lks. wide, course S. 20° W. Ascend.
10 87 Top of spur 200 ft above $\frac{1}{4}$ section corner, bears N & S. Descend.
15 27 Wagon road bears N & S.
31 97 Gulch 5 lks. wide, course S. 10° W. 700 ft below top of spur. Ascend.
34 27 Mouth of tunnel bears N. 15 lks. dist.
37 50 Shaft bears N. 15 lks. dist.
38 97 Top of spur 200 ft above gulch bears N & S. Descend.
40 37 The corner to sections 3, 4, 33 & 34, in low sag between spurs 100 ft below top of spur.

(continue North $89^{\circ} 39'$ W. 40.00 chains to a point 77 links north of corner
From the $\frac{1}{4}$ section corner to sections 4, 5, 32 & 33, where I found a portion of an old post lying on the ground, some of the marks legible but no other trace of corner. To re-mark same I set a granite stone 22 x 14 x 10 ins. 16 ins. in the ground marked S.G.F.R. on N. face. 4 notches on E. and 2 notches on W. edges and raised a mound of stone 2 ft base $1\frac{1}{2}$ ft high W. of corner. Pits impracticable. Thence I run

N. $89^{\circ} 15'$ E. on a TRUE line between sections 4 & 33. Ascend.

1 57 Top of spur bears N & S. and descend.
5 20 Gulch 4 lks. wide, course S. Ascend.
7 67 Top of spur 250 ft above section corner bears N & S. Descend.
14 67 Gulch 25 lks. wide 170 ft below top of Spur, course S. Ascend.
21 37 Top of spur 400 ft above gulch, bears N & S. Descend.
25 07 Gulch 4 lks. wide, course S. 20° W. Ascend.
27 17 Wagon road on top of spur bears N & S. Descend.
32 37 Gulch 10 lks. wide, course S. and continue descent.
40 00 The $\frac{1}{4}$ section corner.

From the corner to sections 4, 5, 32 & 33, I run

N. $89^{\circ} 39'$ W. on a RANDOM line between sections 5 & 32.

40 13 To a point 195 lks. S. of $\frac{1}{4}$ section corner where I found traces of old earth mound and pits but no post. To re-establish corner I set a redwood post 3 ft long 3 ins. sq. 24 ins. in the ground marked S.G.F.R. $\frac{1}{4}$ S. on N. face from which bears a
Live Oak 8 ins. dia. N. 4° E. 112 lks. dist. marked
S.G.F.R. $\frac{1}{4}$ S. BT.
Live Oak 6 ins. dia. S. $89\frac{1}{2}^{\circ}$ W. 55 lks. dist. marked $\frac{1}{4}$ S BT.

Thence I run

S. 86° 52' E. on a TRUE line between sections 5 & 32. Descend.

- 3 03 Enter vineyard bears N & S.
- 8 73 Leave vineyard bears N & S.
- 11 03 Wagon road bears N & S.
- 11 93 Wire fence bears N & S.
- A house and barn bears N. about 20.00 chs.
- 21 73 A wire fence bears NE & S.
- 29 53 Gulch 4 lks. wide 300 ft below $\frac{1}{4}$ section corner, course S. Ascend.
- 34 03 Top of spur 170 ft above gulch bears N & S. Descend.
- 37 33 Gulch 10 lks. wide 100 ft below top of spur, course S. Ascend.
- 40 19 The corner to sections 4, 5, 32 & 33.

From the $\frac{1}{4}$ section corner I continue

N. 89° 39' W.

- 39 40 To point 73 lks. S. of corner to sections 5, 6, 31 & 32, where I found a badly decayed post in stone mound partly destroyed, no bearing tree as described in original notes. To re-establish corner I set a sycamore post 3 ft long 4 ins. sq. 24 ins. in the ground marked
S. G. F. R.
T 2 N, S 32 on NE.
R 12 W, S 5 on SE.
T 1 N, S 6 on SW. and
S 31 on NW. faces with 5 notches on E. and 1 notch on W. edges
from which bears a
Live Oak 4 ins. dia. S. 22° 20' E. 21 lks. dist.
marked T 1 N, R 12 W, S 5 BT.
Live Oak marked
T 1 N, R 12 W. S 6 BT.
Sycamore 6 ins. dia. N. 39° 34' W. 8 lks. dist.
marked T 2 N, R 12 W, S 31 S.G.F.R.BT.

No other tree within limits.

Raised a mound of stone 2 ft base $1\frac{1}{2}$ ft high W. of corner.

Pits impracticable. I destroyed old corner. Thence I run

S. 88° 35' E. on a TRUE line between sections 5 & 32.

Through Arroyo Seco.

- 6 63 Stream 2 lks. wide course SE.
- 9 43 Wagon road in bed of arroyo, bears NW & SE.
- 19 53 Leave arroyo bears NW & SE. Ascend.
- 22 03 A cluster of residences bears N. about 25.00 chs. dist.
- 24 43 A telephone line bears NW & SE. on mesa 75 ft above canyon and over mesa.
- 26 03 Wagon road bears NW & S.
- 28 43 Wagon road bears N & S. leave mesa and descend.
- 33 83 Stream in bottom of Millard canyon 4 lks. wide, course S. and across canyon.
- 37 00 Leave canyon and over broken land. Descending.
- 39 41 The $\frac{1}{4}$ section corner.

From the corner to sections 5, 6, 31 & 32. I run

N. 89° 39' W. on a RANDOM line between sections 6 & 31.

- 35 95 To a point 53 lks. N. of $\frac{1}{4}$ section corner which was a decayed post in a stone mound in bad condition. I destroyed old corner and to re-mark same, set a granite stone 20 x 12 x 10 ins. 15 ins. in the ground marked S.G.F.R. $\frac{1}{4}$ on N. face. Dug pits 18 x 18 x 12 ins. E & W. of stone 3 ft dist. and raised a mound of ~~stone~~ earth $1\frac{1}{2}$ ft high $3\frac{1}{2}$ ft base N. of corner. Thence I run

N. 89° 00' E. on a TRUE line between sections 6 & 31.

Descend over rough washes.

- 3 95 Gulch 4 lks. wide, course N. 60° W. Ascend.
11 95 Top of W. bank of Arroyo Seco, course SE. and descend into same.
35 95 The corner to sections 5, 6, 31 & 32.

From the $\frac{1}{4}$ section corner I continue

N. 89° 39' W.

- 39 85 To a point 44 lks. S. of corner to Tps. 1 & 2 N, Rs. 12 & 13 W. where I found a portion of an old stone mound. To re-mark corner and to establish corner No. 22 on boundary of San Gabriel Forest Reserve, I set a hollow, square, iron post filled with cement 3 ft long and sides 4 ins. wide at the top, increasing to 12 ins. at the bottom, 12 ins. in the ground, marked
S.G.F.R. 22, T 2 N, S 31 on NE.
R 12 W, S 6 on SE.
T 1 N, S 1 on SW. and R 13 on NW. S 36 on NW. faces
Dug pits 36 x 36 x 12 ins. N & E. of corner 4 ft dist. and re-build old mound of stones with earth $1\frac{1}{2}$ ft high 5 ft base around post.
Thence I run

S. 89° 01' E. on a TRUE line between sections 6 & 31.

Descend through field.

- 7 20 Wagon road bears NE & W.
10 40 Leave field cross dry bed of stream 10 lks. wide, Course S. and enter dense brush.
11 00 Same wagon road bears NW. & SE. and descend.
24 50 Top of spur 400 ft above township corner bears N & S. Descend
35 00 Wagon road bears NE & SW.
39 00 Gulch 4 lks. wide 300 ft below top of spur, course SW. and continue descent over rough washes.
39 86 The $\frac{1}{4}$ section corner.
-

J. Goldsworthy, Contract of 1875.

SOUTH between sections 4 & 5.

Var. 14° 15' E.

- 4 00 To bank of deep arroyo, course SW.
- 17 00 To SE. bank of same.
- 27 00 To point near intersection of the N. line of Ro. San Pascual.
Set temporary point.

From Station No. 8 of Ro. San Pascual, N. 86° E.

Var. 14° 15' E.

Retracing said Ro. line.

- 50 42 Intersect the line between sections 4 & 5, 36 lks. S. of my temp. corner. Set a post 2 x 4 ins. 4 ft long with charred stake on N. side 1 ft in ground and raised mound of earth and stone 4½ ft dia. with pits 18 in. sq. and 12 ins. deep for corner to fractional sections 4 & 5, making the length of this line 27.36 chains. By tabling up my connection at this point I found I had either made a misclosure or else the distance between stations 7 & 8 of Ro. San Pascual was too short and in order to test my work I run thence

N. 86° E.

Var. 14° 15' E.

- 80 58 Intersect the mound on the N. boundary of Ro. San Pascual on the line between sections 3 & 4. Thence I find that the distance between stations 7 & 8 of Ro. San Pascual is 152.50 chs. instead of 157.50 chs. as given in the Patent or 5.00 chs. too short.

SOUTH between sections 5 & 6.

September 15,
Var. 14° 15' E.

- 1 00 To base of spur, course SE.
- 15 00 To top of spur, course SW.
- 22 00 To base of hill, course E & W.
- 27 00 To Wm. Mith Rasneusson's house 10 chs. E. of line.
- 40 00 To ¼ section corner. Set 2 x 4 post 4 ft long with charred stake on S. side 1 ft in ground and raised mound of earth and stone 4½ ft dia. 2 ft high with pits 18 ins. sq. and 12 ins. deep.
- 46 00 To point near the intersection of N. boundary of Ro. San Pascual.

Retracing line Ro. San Pascual.

From Station No. 9 of Ro. San Pascual, retracing said Ro. line I run

N. 64° E.

Var. 14° 15' E.

- 1 80 To intersection of line between sections 5 & 6. At a point 60 lks. S. of my temporary point, set 2 x 4 post 4 ft long with charred stake on E. side, 1 ft in ground and raised mound of earth and stone 4 ft dia 2 ft high for a corner to fractional sections 5 & 6, making the whole length of this line 46.60 chains. Which completed the survey of all the surveyable land in this Township, the remainder being too rough and broken to survey.

John Goldsworthy,

U. S. Deputy Surveyor.

West Boundary

T 2 N, R 12 W, S.B.M.

Sept. 16th 7h A.M. 1. run to ~~set off~~ $34^{\circ} 12' N$, on the Lat. arc; $2^{\circ} 21' N$, on the decl. arc; and determine a true meridian with the solar, at the cor. to Tps. 1 and 2 N., Ranges 12 & 13 W., previously described.

From the corner to Tps. 1 and 2 N., Rs. 12 & 13 W. I run

NORTH on a RANDOM line along boundary.

After diligent search, being unable to find any trace of old corners along line, I return to the corner to Tps. 1 and 2 N. Rs. 12 & 13 W. and run

NORTH on a TRUE line between sections 31 & 36.

Through plowed field.

- 14 00 Leave field bears E & W. Ascend.
- 32 50 Top of spur 100 ft above Tp. corner bears E & W. Descend.
- 34 50 Ravine 10 lks. wide, 50 ft below top of spur, course E. Ascend.
- 39 00 Top of spur 120 ft above ravine, bears E & W. Descend.
- 40 00 Set a granite stone 20 x 8 x 4 ins. 15 ins. in the ground for $\frac{1}{4}$ section corner, marked S.G.F.R. on E. face and $\frac{1}{4}$ on W. face and raised a mound of stone $1\frac{1}{2}$ ft high 2 ft base W. of corner. Dug pits 18 x 18 x 12 ins. N & S. of corner 3 ft distant. Corner set in low sag 50 ft below top of spur. Ascend.
- 43 50 Top of spur 100 ft above $\frac{1}{4}$ section corner bears N. 80° E. and S. 80° W. Descend.
- 59 35 Ravine 20 lks. wide, 200 ft below top of spur, course E. Ascend.
- 68 00 Top of spur 300 ft above ravine bears E & W. Descend.
- 76 50 Canyon 15 lks. wide 250 ft below top of spur, course E. Ascend.
- 79 00 Wagon road bears E & W. on top of ascent, 75 ft above canyon. Descend.
- 80 00 Set a granite stone 36 x 18 x 10 ins. 27 ins. in the ground for corner to sections 25, 30, 31 & 36, marked with 1 notch on S and 5 notches on N. edges, and raised a stone mound 2 ft base $1\frac{1}{2}$ ft high W. of corner. Pits impracticable. Stone also marked S.G.F.R. on E face. Land mountainous. Soil 1st and 3rd rate. No timber. Dense undergrowth of chemical. Mountainous land 80.00 chains.

NORTH on a TRUE line between sections 25 & 30. Descend.

- 7 00 Canyon 10, lks wide 300 ft below section corner, course N. 70° E. Ascend.
- 12 00 Top of spur 200 ft above canyon, bears N. 10° W. & S. 10° E. Descend.
- 16 50 Canyon 50 lks. wide 175 ft below top of spur, course S. 55° E. Ascend.
- 29 00 Old Seledad road bears E & W.
- 40 00 Set a pine post 4 ft long 4 ins. sq. 24 ins. in the ground for $\frac{1}{4}$ section corner, marked $\frac{1}{4}$ S on W. face and S.G.F.R. on E. face, from which bears a
 - Pine 30 ins. dia. N. $64\frac{3}{4}^{\circ}$ E. 28 lks.
 - marked S.G.F.R. $\frac{1}{4}$ S. BT.
 No other tree within limits, raised a mound of stone $1\frac{1}{2}$ ft high 2 ft base W. of corner. Pits impracticable.
- 47 00 Top of ridge 700 ft above canyon, bears E & W. Descend.
- 70 00 Ravine 20 lks. wide, 500 ft below top of ridge, course E. Ascend.
- 80 00 Top of spur 300 ft above ravine, bears E & W.
 - Set a granite stone 20 x 10 x 8 ins. 15 ins. in the ground for corner to sections 19, 24, 25 & 30, marked S.G.F.R. on E. face with 2 notches on S. and 4 notches on N. edges, and raised a mound of stone $2\frac{1}{2}$ ft high 4 ft base, W. of corner. Pits impracticable.
 - Finding it impossible to convey iron post No. 23 to this point on account of rough mountains, I return to a point 61.00 chains S. of this point and set a square, hollow iron post, filled with cement etc. 3 ft long, the sides 4 ins. wide at the top increasing to 12 ins. wide at bottom, 12 ins. in the ground, marked S.G.F.R. 23. T 2 N, S 19 on NE. R 12 W. S 30 on SE. R 13 W. S 25 on SW. and S 24 on NW. faces.

Dug pits 36 x 36 x 12 ins. E & W. of post 4 ft dist. and raised an earth mound $1\frac{1}{2}$ ft high 5 ft base, around post, alongside which I set a sycamore post 4 ft long 4 ins. sq. 24 ins. in the ground, marked WC. 61.00 chains on N. face.
Land mountainous. Soil 3rd rate. Scattering Pine and Sycamore timber. Dense undergrowth of chaparral. Mountainous land 80.00 chains.
September 16, 1896.

West boundary Section 31, T 2 N., R 12 W.

I have re-examined and re-surveyed said line and find as follows: By new measurement, I make the North half of said line 40.14 chs. and the South half of said line 39.94 chs. This corresponds with my original measurement as near as two sets of chainmen can make it over such rough ground.
The Examiner found the course of the South half N. $0^{\circ} 21'$ E. and the North half N. $0^{\circ} 41'$ E. I made a careful examination and could not find the course otherwise than North and South, and will ask that it be reported upon by the Examiner.
At the $\frac{1}{4}$ section corner pits should have been noted in my field notes. Therefore on Page 87 of original notes, line 34, instead of "Pits impracticable" read Dug pits 18 x 18 x 12 ins. N & S. of corner 3 ft distant.
Upon re-examination I found earth and stone mound around Iron corner No. 23.

South Boundary of Section 31.

I re-measured the line and found the West half 39.83 chains. The land along this line is so extremely rough and broken, over cliffs and land-slides, that I regard this measurement as close as possible for two sets of chainmen to get, over such a rough line.
June 12, 1897.

June 14, 1897. At 7 h. 54 m. A.M., l.m.t., I set off $34^{\circ} 12'$ on the Lat. arc, $23^{\circ} 19'$ N. on the Decl. arc, and determine a true meridian with the solar at the corner to sections 5, 6, 31 & 32, on S. boundary of T 2 N, R 12 W.
Found both bearing trees to the corner to sections 5, 6, 31 & 32. although the Examiner reported but one. As the post originally set at this place was rather crooked, I set a new one, properly marked.

$\frac{1}{4}$ section corner between sections 5 & 32
on S. boundary of T 2 N, R 12 W.

The Examiner reported the true marked "S.G.F.R." This is a mistake on his part, as the Oak, which bears S. $89\frac{1}{2}^{\circ}$ W. is marked $\frac{1}{4}$ S BT., but is not marked S.G.F.R. as it is not inside the Reservation.

Corner No. 21.

I found mound around this corner.

Corner No. 17.

I found both bearing trees to corner No. 17, but did not find the marks "S.G.F.R." on but one of them, as stated in my field notes.
June 14, 1897.
