

FIELD NOTES

Subdivision

Section 32.

T. 2 N., R. 12 W.

Copied from Notes loaned by Mr. L. Friel.

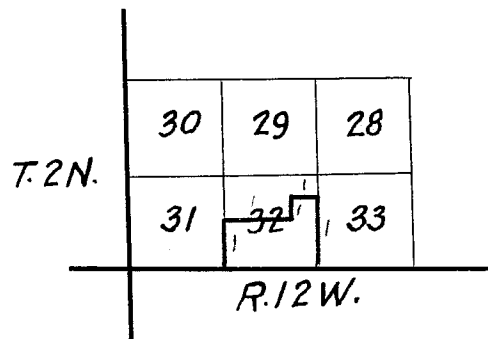

T. 2 N., R. 12 W., S.B.M.

A. W. Von Schmidt, Contract of August 7, 1880 and Special instructions of Feb. 25, 1881, Book 1232.

Survey commenced March 25, 1881.

Commenced at the corner to Sections 4, 5, 32 and 33 on the South boundary of the Township. Thence

NORTH between Sections 32 and 33. Var.  $14^{\circ} 45'$  E.

Ascend over broken ground.

35.00 Top of ascent. Ridge bears N.E. and descend.  
40.00 Set  $1/4$  section post 3 ins. dia. 4 ft. long 18 ins. in the ground,  
Raised mound of earth 18 ins. high, 2 pits 18 x 18 x 12 ins.  
55.00 Foot of descent and to Millard Creek.  
55.50 Across same, course S.W. and ascend steep mountain.  
60.00 Set a stone 6 x 8 x 14 ins. in the ground, 2 pits 18 x 18 x 12 ins.  
Find it impossible to proceed further, I therefore offset on subdivision line.

20.00 West over broken ground.  
Set post 3 ins. dia. 3 ft. long 12 ins. in the ground with 2 pits 18 x 18 x 12 ins. Thence

SOUTH on subdivision line.

20.00 Descending over broken ground.  
Set post 3 ins. dia. 4 ft. long 18 ins. in the ground between two large rocks.  
Millard Creek distant 5 chains East of this post bears South Thence

WEST on subdivision line.

19.40 Ascending from corner.  
20.00 Top of ascent. Ridge bears N. & S.  
Set post 3 ins. sq. 4 ft. long, 18 ins. in the ground, raised mound of earth 18 ins. high with two pits 18 x 18 x 12 ins. ALSO a stone 3 x 6 x 12 ins. side of staks.  
30.00 Foot of descent and to Negro Creek 20 lks. wide, course S.W.  
Ascend broken hills.  
42.00 Top of ascent. Ridge bears N. & S. Descend.  
60.00 Set post 4 x 4 inches sq. 4 ft. long, 18 ins. in the ground, made two pits 18 x 18 x 12 inches.  
Thence South

SOUTH between Sections 31 and 32.

40.00 Descending over broken ground.  
Intersects the South boundary of Township at the corner of Sections 5, 6, 31 and 32, T. 1 N. & 2 N., R. 12 W.

- - - - -