

FIELD NOTES

Certain lines in

T 5 N, R 8 W.
T 6 N, R 8 W.

S.B.M.

Copied from Notes loaned by Mr. L. Friel.

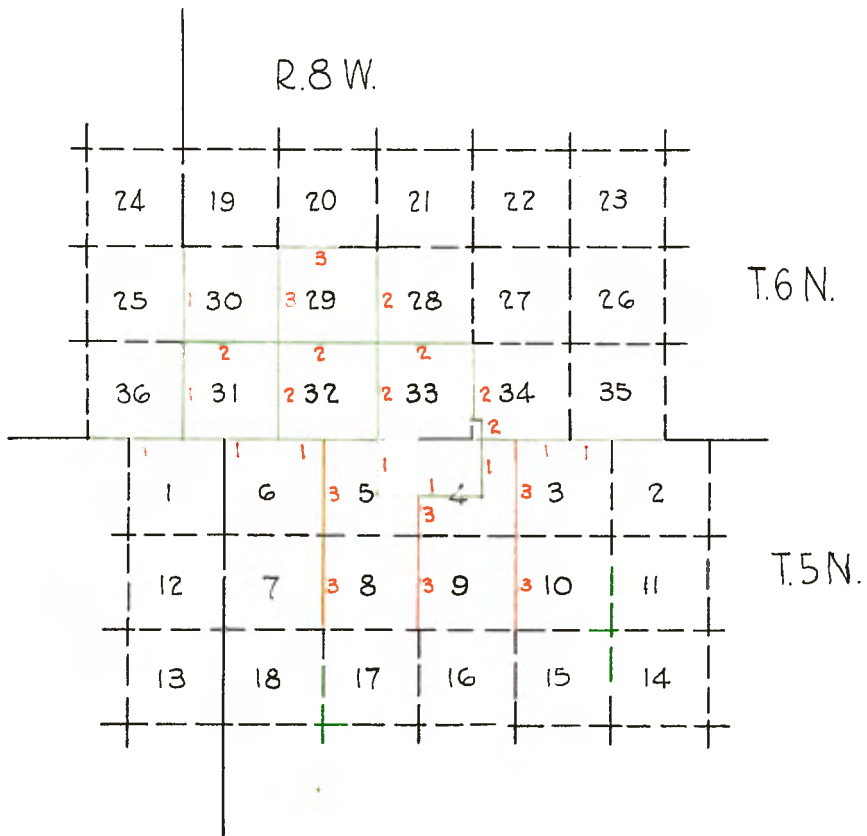

Norris 1853-5
Hancock 1855

First Correction Line.

T 6 N, R 8 W.

WEST on Second Mile. (South Boundary)

80.00 Set second mile post and mound. Three mounds distant 3/4, 1 & 1/2 mile S.

WEST on Third Mile.

40.00 Set 1/2 mile post and mound.

64.00 To foot of isolated mountain, the mile post not set, but made witness post and mound 16 chains East, thence S. on offset along foot of mountain through section 3.

20.00 Ascend and cross low points of hills.

40.00 To bottom, thence West.

16.00 Set 1/4 section post on west line of section 3, south of mountains.

WEST through section 4.

80.00 Set 1/4 section post on west line of section 4.

Thence on west line of section 4.

NORTH.

40.00 Set fourth mile post and mound on first correction line about 30 chs. west of mountain, which is about 1 mile from south to north and about 50 chs. from east to west.

We are about 7 miles from the foot of the mountains south and the ground has risen greatly from the level of the country bordering the Mohave.

WEST on Fifth Mile.

40.00 Set 1/2 mile post and mound.

80.00 Set fifth mile post and mound. Desert.

WEST, on Sixth Mile.

40.00 Set 1/2 mile post and mound.

80.00 Set post and mound corner to townships 5 & 6 North, Ranges 8 & 9 W. Desert.

T 6 N, R 9 W.

Var. 14° 10' E.

WEST on First Mile.

40.00 Set 1/2 mile post and mound.

80.00 Set first mile post and mound. Desert.

By Ralph W. Norris, Deputy Surveyor,
Contract October 12, 1853.

T 6 N, R 9 W, S.B.M.

EAST BOUNDARY.

Var. 14° 08' E.

80.00 NORTH on EAST BOUNDARY of Section 36.
Set chard. chalked & notched post corner to sections 25, 36, 30 & 31 mound, trench, pits etc. as per instructions. Land 3rd rate.

40.00 NORTH on EAST BOUNDARY of Section 25.
Set 1/4 sec. chrd. & chalked post, made mound, trench, pits, etc., as per instructions. Land 3rd rate. Some scrub and grass.

80.00 Set chrd., chalked & notched post corner to sections 24, 25, 19 & 30, made mound, pits, etc., as per instructions.
Soil sandy and 3rd rate. Scattering grass.

By R. W. Norris, Deputy Surveyor,
Contract of December 23, 1854.

NORTH between sections 33 & 34. Var. 14° 08' E.

Beginning at witness post in First Standard North 16 chains East of the true corner to 33 and 34, thence ran North 20 chains, thence West 16 chains to the true line between sections 33 & 34 at foot of mountain, thence North 20 chains.

Set charred post for $\frac{1}{4}$ section corner and made a mound with trench as per instructions.

80.00 Set a charred post for corner to sections 27, 28, 33 & 34, and made a mound with trench and pits as per instructions.
Land generally 2nd rate and open.

NORTH between sections 32 & 33. January 18, 1856.
Var. 14° 08' E.

40.00 Set a charred post for $\frac{1}{4}$ section corner and made a mound with trench and pits as per instructions.

80.01 Set a charred post for the corner to sections 28, 29, 32 & 33, and made a mound with trench and pits as per instructions.
Land, level and sandy with grass and bushes.

EAST on a Random line between sections 28 & 33. Var. 14° 08' E.

40.00 Set a post for temporary $\frac{1}{4}$ section corner.

80.30 Intersect the N & S. line 48 lks. N. of the corner to sections 27, 28, 33 & 34, from which corner I run

WEST and a true line between sections 28 & 33. Var. 13° 47' E.

40.15 Set charred post for the $\frac{1}{4}$ section corner and made a mound with pits and trench as per instructions.

80.30 The corner to sections 29, 28 32 & 33.
Land, level and sandy with grass and bushes.

NORTH between sections 28 & 29. Var. 14° 08' E.

35.01 The land is ascending and broken.

40.01 Set a charred post for the $\frac{1}{4}$ section corner and made a mound with trench and pits as per instructions.

80.01 Set a charred post for the corner to sections 20, 21, 28 & 29, and made a mound with trench and pits as per instructions.
Land, generally hilly with grass and palmetto.

NORTH between sections 31 & 32. January 19, 1856.
Var. 14° 08' E.

40.00 Set a charred post for the $\frac{1}{4}$ section corner and made a mound with trench and pits as per instructions.

80.00 Set a charred post for the corner to sections 29, 30, 31 & 32, and made a mound with trench and pits as per instructions.
Land level and sandy with grass and bushes.

EAST on a Random line between sections 29 & 32. Var. 14° 08' E.

40.00 Set a post for temporary $\frac{1}{4}$ section corner.

80.00 Intersect the N & S. line 47 lks. N. of post corner to sections 28, 29, 32 & 33, from which corner I run

WEST on a true line between sections 29 & 32. Var. 13° 48' E.

40.00 Set a charred post for $\frac{1}{4}$ section corner and made a mound with trench and pits as per instructions.

80.00 The corner to sections 29, 30, 31 & 32.
Land level and sandy with grass and bushes.

WEST on a Random line between sections 30 & 31. Var. 14° 08' E.

40.00 Set a post for temporary $\frac{1}{4}$ section corner.

79.92 Intersect the W. boundary of Tp. 47 lks. S. of corner to sections 30 and 31, from which corner I run.

EAST on a True line between sections 30 & 31. Var. 13° 48' E.

39.92 Set a charred post for the $\frac{1}{4}$ section corner and made a mound with trench and pits as per instructions.

79.92 The corner to sections 29, 30, 31 & 32.
Land, level and sandy with grass and palmetto.

40.00 NORTH between sections 29 & 30. Var. 14° 08' E.
Set a post for the $\frac{1}{4}$ section corner and made a mound with trench as per instructions.

80.00 Set a charred post for the corner to sections 19, 29, 20 & 30, and made a mound with trench and pits as per instructions.

40.00 EAST on a Random line between sections 20 & 29. Var. 14° 08' E.
Set a post for temporary $\frac{1}{4}$ section corner.

63.00 The ground is descending and broken.

80.30 Intersect N & S. line 46 lks. N. of corner to sections 20, 21, 28 & 29, from which corner I run.

40.15 WEST on a True line between sections 20 & 29. Var. 13° 48' E.
Set a charred post for $\frac{1}{4}$ sec. cor. and made mound with trench and pits as per instructions.

80.30 The cor. to secs. 19, 20, 29 & 30.
Land, level and sandy with grass and palmetto.

By Ralph W. Norris, Deputy Surveyor.
Under Contract of October 19, 1855.

T 5 N, R 8 W, S.B.M.

80.00 NORTH between sections 9 & 10. Var. 14° 08' E.
Set a post for corner to secs 3, 4, 9 & 10, raised mound with trench and pits as per instructions. Land, level. Soil 2nd rate, sand loam

40.00 NORTH between sections 3 & 4. Var. 14° 08' E.
Set a post for $\frac{1}{4}$ sec. cor. raised md with trench and pits as inst.

55.00 To base of spur (of S. point of mts. on N.)

57.00 To top of E. slope of spur.

60.00 To N. base of spur.

86.60 Intersected the 1st. Standard North, 869 chs. W. of the $\frac{1}{2}$ mile corner of the 45th. Standard mile as established by Col. R. Norris, and set post for C.C. of Secs. 3 & 4, raised mound with trench and pits as per instructions, at point of intersection. Soil 2nd rate generally. Tuesday Dec. 4.

80.00 NORTH between secs. 8 & 9. Var. 14° 08' E.
Set post for cor. to secs. 5, 4, 8 & 9, and raised mound with trench and pits as per instructions. Land, level. Soil 2nd rate sand loam.

40.00 NORTH between secs. 4 & 5. Var. 14° 08' E.
Set a post for $\frac{1}{4}$ sec. corner and raised mound with trench and pits as per instructions.

85.80 Intersected the 1st. Standard N. 770 lks. W. of the $\frac{1}{2}$ mile cor. of the 46th. mile Standard Corner as established by Col R. W. Norris, and set a post for C. cor. to sections 4 & 5, raised mound with trench and pits as per instructions at point of intersection.
Land level. Soil 2nd rate sand loam.

80.00 NORTH between secs. 7 & 8. Var. 14° 08' E.
Set post for cor. to secs. 5, 6, 7 & 8, raised md with trench and pits as per instructions. Land level. Soil 2nd rate.

40.00 NORTH between sections 5 & 6. Var. 14° 08' E.
Set post for $\frac{1}{4}$ sec. cor. and raised md with trench and pits as per instructions.

86.98 Intersected the 1st Standard North 786 lks. W. of the $\frac{1}{2}$ mile corner of the 47th. mile Standard corner as established by Col Norris and set a post for C. Corner of Sections 4 & 5, and raised mound with trench and pits as per instructions.
Land level. Soil 2nd rate generally. DEC 8,

By Henry Hancock, Deputy Surveyor,
Contract dated February 15, 1855.