

FIELD NOTES

T. 1 N., R. 14 W.

E. side Sections 1 & 12 (Norway 1875)  
 N. do 1 & 2 do

T. 2 N., R. 13 W.

Ranch Lines in Section 19 (Sickler 1902)

T. 2 N., R. 14 W.

Ranch & Section Lines in  
 Sections 20, 21, 22, 23, 24,  
 25, 26, 27, (Sickler 1902)

S. side Sections 35 & 36 (Norway 1875)

Copied from notes loaned by J.M. Tate

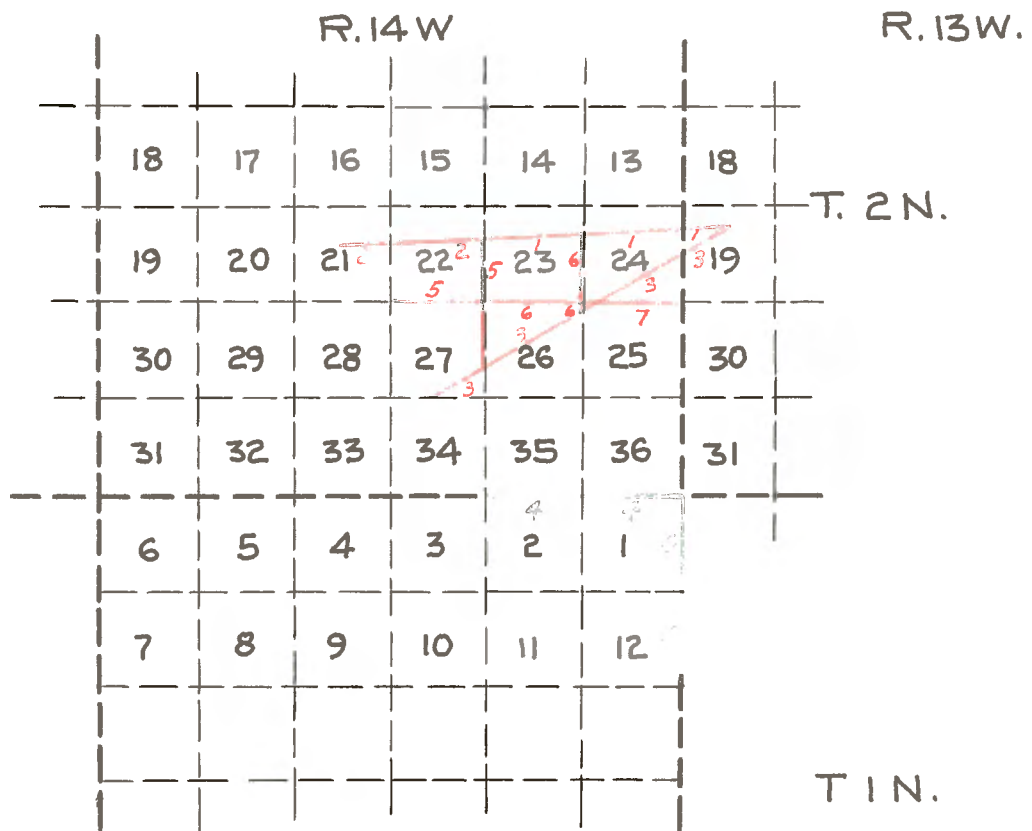

~~W.A. Sickler 1902~~

Field Notes N.&W. Bdy Twp C.S. 7848  
 So. Line Sec. 34 T. 2 N., R. 14 W. M:27 page 82

South Boundary of the Tujunga Rancho  
and the  
North Line of Sections (Fractional) 22, 23, 24  
T. 2 N., R. 14 W., S. B. M.

---

As it will be necessary for me to close my survey on the boundary lines of the Ranchos Tujunga and San Rafael, and as no intermediate corners or stations were established on these boundaries and but few of the original corners are standing, I shall proceed to re-survey as much of these boundaries as shall be necessary to close my surveys.

I commence at corner No. 13 of the Rancho Tujunga. The live oak and bearing trees have disappeared, but I am told by an old resident that the corner, as it now stands, has been there for many years and its location has been checked upon by surveys from other known corners and has been confirmed by the Courts. It is a redwood post 4" square, 1 foot above ground, marked T 13 on the West face, L C 1 on the East face, set in mound of earth and rock, 6 foot base, 1 1/2 feet high, from which a live oak 30" dia. bears N. 75° W., 159 links distant, marked T 13 W. C.

April 4, I set off angle 34° 15' on Lat arc and 5° 31' N. on Decl. arc and at 8h. 00m. A.M., l.m.t., I determine a true meridian with the solar at this corner from which I run S. 89° W. on RANDOM line along the South boundary of the Rancho Tujunga setting temporary stations at each 40 and 80 chains.

- 415 00 A point 7.50 chs. North of corner No. 14, which is a redwood post 4" square, 1 foot above ground, marked as described by the Surveyor General. In order that my stations may appear in consecutive order, I return to corner No. 13 and run S. 88° W. on TRUE line, over a succession of very steep spurs and ridges of the Tujunga mountains and through brush.
- 40 00 Set rock, 20x12x12, 14" deep, marked T 1/2 M on North face, raise a mound of rock, 3 feet base, 2 feet high, North of rock. Pits impracticable.
- 60 00 Wood road, course NE & SW.
- 80 00 Set rock 12x8x6, 8" deep, marked T 1 M on North face and S 24 on S face, raise a mound of rocks 2 ft base 1 1/2 ft. high, North of rock. Land mountainous. Soil 4th rate. No timber. Mountainous land 80 chs.
- 120 00 Set rock 20x12x8, 14" deep, marked T 1/2 M on North face, dug pits 18x18x12 on line each side, 3 ft. from rock, raised a mound of earth and rock 3 ft. base 1 1/2 ft. high, North of corner.
- 122 50 Through saddle 800 ft. above valley and cross to the south side of mountains and along the southerly slope. Land becomes more broken.
- 160 00 Set rock 24x16x5, 18" deep, marked T 2 M on North face and S 23 on South face. Raise a mound of rock 2 ft. base 1 1/2 ft. high N. of rock. Pits impracticable. Land mountainous. No soil or timber. Mountainous land 80 chains.
- 200 00 Set rock 20 x 10 x 8, 14" deep marked T 1/2 M on North face. Dug pits 18 x 18 x 12 on each side of rock on line, 3 ft. distant. Raise a mound of rocks 2 ft. base 1 1/2 ft. high North of rock.
- 240 00 Top of spur descending South, about 700 feet above valley. Set rock 20x12x8, 14" deep marked T 3/4 M on N face and S 22 on S face. Raise a mound of rocks 2 ft. base 1 1/2 ft. high N. of rock. Land mountainous. Soil rocky. Mountainous land 80 chains.
- 272 00 Cross highest ridge on line, 1000 feet above valley, course NE & SW.
- 280 00 Set rock 20x12x8, 14" deep marked T 1/2 M on North face. Dug pits 18x18x12, on line on each side of rock 3 ft. distant. Raise a mound of rock 3 1/2 ft. base 1 1/2 ft. high North of rock. This rock is on side of mountain facing North.
- 291 50 Deep canyon 50 lks. wide, course SW. 100 feet above valley.
- 315 00 Through low saddle 500 feet above valley, to North side of range.

320 00 Set rock 18x29x10, 12" deep marked T 4 M on North and S 21 on South faces, dug pits 18x18x12, on line on each side of rock, 3 ft. distant. earth mound 3½ ft. base 1½ ft. high North of rock. Land mountainous. Soil rocky. No timber. Mountainous land 80 chains.

360 00 Set rock 16x10x8, 11" deep marked T ½ M on North face, dug pits 18x18x12, on line each side of rock, 3 ft. distant. Mound of rock 3½ ft. base 1½ ft. high North of rock.

386 00 Top of peak 300 feet above valley.

400 00 Set redwood post 3 ft. long, 4" sq. 24" in the ground, marked T 5 M on North and S 20 on South faces. Mound of rocks 2 ft. base 1½ ft. high, North of post. Pits impracticable. Land mountainous. No timber. Soil rocky. Mountainous land 80 chs.

411 00 Road to Tujunga, course N. & S., in low pass.

415.19 Corner No. 14 of the Rancho Tujunga.  
Land mountainous. Soil rocky. Mountainous land 15 chains.

Wm. A. Sickler, April 1902.

North Boundary of the Rancho San Rafael  
 passing through  
Sections 24, 25, 26, 27 of T. 2 N., R. 14 W., S.E.M.

Commencing at corner No. 13 of the Rancho Tujunga, which is corner No. 1 of the Rancho San Rafael, I run S. 68° W. on a BLANK line on the North boundary of the Rancho San Rafael to corner No. 5, and find that to be the correct course. I then run from corner No. 5 on a TRUE line.

April 9, at 5h. 00m. A.M., l.m.t., I set off 34° 14' on Lat arc 7° 25' on Decl. arc and determine a true meridian at corner No. 5 of the Rancho San Rafael, which is a mound of rocks on a sharp red peak. The post had disappeared and I set a rock 18x18x6, 12" deep marked S R No. 5, 1 ft. North of mound. Thence I run N. 68° E. on a TRUE line along the North boundary of the Rancho San Rafael, over sharp ridges and through brush.

- 35 00 Ridge, course NE. & SW.  
 40 00 Set rock 20x8x12, 14" deep, marked S R 1/2 M on South face. Mound of rocks 2 ft. high 3 ft. base, South of corner. Pits impracticable. In head of deep canyon, course North. Ascend steep side of ridge.  
 46 00 Top of ridge course NE. & SW.  
 52 00 Canyon 100 feet deep, course NE.  
 57 00 Top of high ridge 100 ft. above canyon.  
 64 00 Cross ravine 25 lks. wide, course North, with water in pools. Ascend through dense brush.  
 70 00 Top of spur, descending North.  
 78 00 Cross timbered ravine 50 lks. wide, course North.  
 80 00 Set rock 19x8x4, 13" deep marked S R 1 M on South, S 26 on North faces. Mound of rocks 3 ft. base 2 ft. high, South of corner. Pits impracticable. This corner is on the South slope of steep mountain. Land mountainous and cut with deep canyons. Soil 4th rate. Oak timber along ravines. Mountainous land 80 acs.  
 94 00 Top of high ridge 1000 ft. above valley, course NW. & SE. Descend through dense brush over ridges and canyons.  
 120 00 Set rock 18x20x10, 12" deep, marked S R 1/2 M on South face, from which a live oak 6" dia. bears S. 60° E. 35 lks. distant, marked S R 1/2 M BT. Mound of rocks 2 ft. base 1 1/2 ft. high South of corner.  
 132 50 Creek in canyon 50 lks. wide, water in pools, course North.  
 155 00 Ravine 60 lks. wide, course NW., descending the Berdugo Mts. from the Tujunga Mts., water in pools. Ascend through dense brush along southerly slope.  
 160 00 Set rock 20x12x8, 14" deep marked S R 2 M on South and S 25 on North faces from which a sycamore 8" dia. bears N. 86° W. 47 lks. distant, marked S R 2 M BT. Another sycamore 6" dia. bears S. 3° E. 60 lks. distant, marked S R 2 M BT.  
 163 00 Same ravine 100 lks. wide, course SW.  
 167.50 Same ravine, course E. & W.  
 180 00 North branch of same ravine, course SW., and ascend through dense brush.  
 200 00 Set rock 18x10x6, 12" deep, marked S R 1/2 M on South face. Dug pits 18x18x12, on line each side, 3 ft. from rock. Mound of earth 1 1/2 ft. high South of corner. Still ascending along slope of Tujunga Mts.  
 240 00 A boulder 2 ft. sq. 1 ft. above ground for 3rd mile, I marked S R 3 M on South and S 19 on North faces. Raised mound of rocks South of the corner. Pits impracticable. Land mountainous. Soil rocky. Dense brush. Mountainous land 160 acs.  
 270 00 Summit of Tujunga Mountain, course SE & NW.  
 280 00 Set rock 12x8x6, 8" deep marked S R 1/2 M on South face. Raise mound South of corner.  
 302 90 Corner No. 13 Rancho Tujunga, No. 1 Rancho La Canada and No. 1 Rancho San Rafael. Land mountainous. Soil rocky. Mountainous land 62.90 acs.

Wm. A. Sickler, April 11, 1902.

Exterior Boundaries of T. 1 N., R. 14 W., S. E. M.

From the established corner to Sections 34, 35, 2 and 3 on North boundary of the Township, I run EAST on TRUE line on North boundary of Section 2. Var.  $14\frac{1}{4}^{\circ}$  E.

15 51 Find no corner as reported in former survey. Ascend brushy hill.  
40 00 Set redwood post 3 x 3, 3 ft. long in mound and pits on side hill facing west as per instructions, for  $\frac{1}{4}$  section corner.  
80 00 Set redwood post 4 x 4, 3 ft. long in earth mound as per instructions for corner to Secs. 1, 2, 35 and 36.  
Land rolling hills. Soil 2nd rate, some brush.

-----

EAST on North boundary of Section 1. Var.  $14\frac{1}{4}^{\circ}$  E.  
18 00 Cross ravine 50 lks. wide, course SW.  
40 00 Set post 3 x 3, 3 ft. long in rock mound on side hill facing SW as per instructions, for  $\frac{1}{4}$  section corner.  
80 00 Set post 4 x 4,  $3\frac{1}{2}$  ft. long, in large rock mound, as per instructions for corner to Tps. 1 and 2 N., Rs. 13 and 14 W.  
Land rolling hills. Soil 1st and 2nd rate.

-----

NORTH on East boundary of Section 12. Var.  $14\frac{1}{4}^{\circ}$  E.

From corner established for witness to corner of Sections 1 & 12, 6 and 7, on East boundary of Township, being 71.14 chains North of corner to Sections 12, 13, 7 and 18, I run NORTH on East boundary of Section 12. Var.  $14\frac{1}{4}^{\circ}$  E.

Ascending.  
80 00 Counting the distance from corner to sections 12, 13, 7 and 18, I set post for temporary corner to Sections 7, 6, 1 and 12.

-----

NORTH on East boundary of Section 1. Var.  $14\frac{1}{4}^{\circ}$  E.

Ascending along summit of divide.  
40 00 Set temporary post for  $\frac{1}{4}$  section corner.  
81 78 Intersect the North boundary of the Township, 40 lks. East of corner to Tps. 1 and 2 N., Rs. 13 and 14 West., and from this corner I run

S.  $17^{\circ}$  E. on a TRUE line on East boundary of Section 1. Var.  $14\frac{1}{4}^{\circ}$  E.

41 78 Set post 3 x 3, 3 ft. long, in rock mound, as per instructions, for  $\frac{1}{4}$  section corner.  
62 50 Cross gulch 50 lks. wide, course SE.  
81 78 Set post 4 x 4,  $3\frac{1}{2}$  ft. long, in place of post set for temporary corner in running North, in rock mound, as per instructions for corner to Sections 1, 12, 6 and 7.  
Land rolling. Brush in places. Soil good and 2nd rate.

Wm. H. Norway September 14, 1875

Subdivision Lines  
of  
T.2 N., R.14 W., S.E.M.

April 13, 1902, at 8h. Am. l.m.t., I set off  $34^{\circ} 15'$  on the Lat. arc  $8^{\circ} 53'$  N. on the Decl arc and determined the true meridian at the corner to sections 21, 22, 27 and 28. This corner is a rock set firmly in the ground with 2 notches on the South and three notches on the east edges. There is a mound of rock with 2 ft. base  $1\frac{1}{2}$  ft. high W. of rock from which E. M. Wilk's house bears N.  $32^{\circ} 15'$  E. 416 lks. distant.

An elder tree 8 in. dia. bears S.  $61^{\circ}$  E. 32 lks. marked T 2 N R 14 W S 27 BT. The elder bearing tree made in the original survey has disappeared. Thence I run

EAST on TRUE line between Sections 22 and 27.

Over level ground alongside vineyard.

20 00

Leave vineyard and enter dense undergrowth of cactus.

40 00

Set rock  $30 \times 12 \times 8$ , 20" deep for  $\frac{1}{4}$  section corner marked  $\frac{1}{4}$  on N. face from which a live oak 12" dia. bears N.  $82^{\circ}$  W. 36 lks. marked  $\frac{1}{4}$  S 22 BT

Raise a mound of rocks 3 ft. base 2 ft. high N. of corner

41 00

Leave valley and enter broken hills covered with dense undergrowth of brush.

80 00

Set rock  $18 \times 8 \times 8$ , 12" deep for corner to sections 22, 23, 26 and 27, marked with 2 notches on S. and 2 notches on E edges, from which a live oak 20" dia. bears N.  $62^{\circ}$  W. 95 lks. marked T 2 N R 14 W S 22 BT

Mound of rock 2 ft. base  $1\frac{1}{2}$  ft. high W. of corner.

Pits impracticable. Land mountainous. Soil 1st and 3rd rate.

No timber. Mountainous land or covered with dense undergrowth 60 chs.

-----

NORTH on TRUE line between Sections 22 and 23.

Descend abruptly through brush.

4 00

Road, course E & W. enter valley 75 feet below corner

9 50

Leave valley and ascend the rough side of Tujunga Mountain.

39 10

Intersect S. boundary of Rancho Tujunga at a point from which T 3 M bears S.  $88^{\circ}$  W. 15 chs. Set rock  $24 \times 14 \times 10$ , 18" deep in the ground for closing corner of fractional sections 22 and 23, marked C C on S and T on N faces.

Dug pits crosswise on each line  $30 \times 24 \times 12$ , E & W 3 feet and  $24 \times 18 \times 12$ , S of rock 7 ft. distant and raise a mound of rock and earth 3 ft. base and  $1\frac{1}{2}$  ft. high S. of corner.

Land mountainous and valley. Soil 4th rate. No timber.

Mountainous land 29.60 chains.

-----

April 14, at 8h. Am. A.M., l.m.t., I set off  $34^{\circ} 15'$  on Lat arc,  $9^{\circ} 15'$  N. on Decl arc and determine the true meridian at the corner to sections 22, 23, 26 and 27 and run thence

SOUTH on TRUE line between Sections 26 and 27.

Ascend steep side of Berdugo Mountain.

5.75

Top of ridge 200 ft. above corner, course E. Descend.

9 00

Gulch 100 feet below ridge, course E. Ascend.

15 00

Ridge 400 ft. above gulch, course E. & W. Descend.

20 50

Ravine 500 ft. below ridge, course E.

40 00

Set rock  $22 \times 10 \times 6$ , 14" deep for  $\frac{1}{4}$  section corner, marked  $\frac{1}{4}$  on W. face from which a live oak 30" dia. bears N.  $54^{\circ}$  E. 26 lks. marked  $\frac{1}{4}$  S. 26 BT. Raise a mound of rocks 3 ft. base, 2 ft. high W. of corner.

Pits impracticable.

45 25

Intersect N. boundary of Rancho San Rafael at point from which S R  $\frac{1}{2}$  M bears S.  $68^{\circ}$  W. 19 chs.

Set rock  $18 \times 10 \times 6$ , in ground for closing corner to fractional sections 26 and 27 marked C C on N and S R on S faces. Raise a mound of

rocks 3½ ft. base 2½ ft. high N. of corner.  
Land mountainous. Soil 4th rate. No timber.  
Mountainous land 45.25 chs.

-----

EAST on TRUE line between sections 23 and 26.  
From corner to sections 22, 23, 26 and 27.  
Ascend through dense brush.

15 00  
39 30  
40 00

Top of spur 300 ft. above corner, course SW. Descend.  
Enter ravine, course NW 500 ft. below top of spur.  
Set rock 20x10x8, 14" deep for ¼ corner, marked ¼ on N. face  
from which

A Live Oak tree 6" dia. bears N. 56½° W. 46 lks. distant,  
marked ¼ S 23 BT. A rock 24" sq. 20" above ground bears  
S. 47° E. lks., marked ¼ S 26 BR.

43 00  
64 68  
80 00

Leaves ravine and ascends.  
Top of spur descending E 400 ft. above ravine.  
Set a rock 16x18x4, 12" deep for corner to sections 23, 24, 25 and  
26, marked with two notches on S and one notch on E edges, from  
which a ledge 25 ft. long 8 ft. high bears N. 45° E. 11 lks. marked  
T 2 N R 14 W S 24 BR.  
Raise a mound of rock 2 ft. base and 1½ ft. high W. of corner.  
Land mountainous. Soil 4th rate. Scattering oak timber in ravine.  
Mountainous land 80 chs.

April 14, 1902.

-----

April 15, at 8h. Am. A.M., 1.m.t., I set off 34° 15' on Lat arc,  
9° 36' N. on Decl arc, and determine the true meridian with the  
solar at the corner to sections 23, 24, 25 and 26, and run

NORTH on TRUE line between sections 23 and 24.  
Ascend rough mountain.

15 00  
32 00  
40 00

Top of spur 800 ft. above ravine.  
Ravine 50 lks. wide, course west. Ascend.  
Set rock 14x12x5, 9" deep for ¼ section corner, marked ¼ on W. face  
from which

A live oak 8" dia. bears S. 20° E. 75 lks. marked ¼ S 24 BT.  
Raise a mound of rock 3 ft. base 2 ft. high W. of corner.  
Pits impracticable.

41 75

Intersect South boundary of Rancho Tujunga at a point from which  
T 2 M bears S. 88° W. 14.90 chs.  
Set a rock 20x10x6, 14" deep for closing corner to fractional sections  
23 and 24, marked ¼ on N and O O on S faces.  
Raise a mound of rocks 3 ft. base, 2 ft. high S. of corner.  
Pits impracticable. This corner is on side of gulch 30 lks. W. of  
bottom.  
Land mountainous. No Soil. Mountainous land 41.75 chs.

-----

From the corner to sections 23, 24, 25 and 26.  
SOUTH on TRUE line between sections 25 and 26.  
Descend rough mountain.

8 00  
12 50

Ravine 100 lks. wide, 250 ft. below corner, course W. Ascending.  
Intersect N boundary of Rancho San Rafael at a point from which  
S R 2 M bears N 68° E. 14.40 chs.  
Set a post 3 ft. long 3" sq. 24" in the ground for closing corner  
to fractional sections 25 and 26 marked

O O 5 2 N, on North  
R 14 W S 25 on East  
S 26 on West and  
S R on South, faces. From which

A live oak,  
T 2 N R 14 W O O BT. Dug pits 24x18x12, N. 68° E. and S. 68° W.  
3 feet and 30x24x12, N. of post, 7 ft. distant.  
Raise mound of rock 3 ft. base 1½ ft. high N. of corner.  
Land mountainous. Soil 4th rate. Mountainous land 12.50 chs.

-----

From corner to sections 23, 24, 25 and 26.  
EAST on TRUE line between Sections 24 and 25.

- Along South slope of rough mountain.
- 29 00 Top of ridge, course E & W. about 250 feet above creek which passes around East base.
- 30 90 Intersect northerly boundary of Rancho San Rafael at a point from which S R 2 M bears S. 68° W. 19.20 chs.  
Set rock 20x6x4, 14" deep for closing corner to fractional section 24 and 25, marked S R on E. and O O on W. faces.  
Raised mound of rocks 2 ft. base 1½ ft. high W. of corner from which a rock 14x8x6, in rock mound on top of ridge bears W. 200 lks. this is on a very steep side bluff about 100 lks. W. of corner.

Note: In order to assist in establishing the relation between the subdivision and the range line I continued this line to E. side of Township.

- 31 90 Creek 50 lks. wide, water in pools, course SW.
- 41 00 Top of ridge 300 ft. above creek, course SW. & NE., thence along slope of mountain.
- 50 20 Intersect range line for establishment of which see notes of re-survey of exterior at point 8.35 chs. N. of corner, Norway mentions as being 75 chs. N. of corner to sections 25, 30, 31 and 36, which would make 335 lks. N. of point where he established corner to sections 19, 24, 25 and 30, marked  
A buckthorn tree 4" dia.  
O O T 2 N S 25 on SW.  
R 14 W S 24 on N W. sides with 4 notches on N and 2 notches on S sides.  
Raise a mound of rocks around tree. Pits impracticable.  
Land mountain and covered with brush and rock.  
Mountainous land 80.20 chs.